

COUNTY	ROUTE	SECTION	TOTAL SHEETS	SHEET NO.
ADAMS	FAS 591	05-00192-00-RS	11	1

INDEX OF SHEETS:

<u>SHEET NO.</u>	<u>SHEET</u>
1	TITLE SHEET
2	SUMMARY OF QUANTITIES
	GENERAL NOTES
3	TYPICAL CROSS SECTIONS
4-10	PLAN SHEETS
11	SIDE ROAD & ENTRANCE DETAILS
	BUTT JOINT DETAIL
STANDARD 701301-02	
STANDARD 701306-01	
STANDARD 702001-05	
STANDARD BLR 24-1	

STATE OF ILLINOIS
DEPARTMENT OF TRANSPORTATION
DIVISION OF HIGHWAYS
PLANS FOR PROPOSED
SURFACE TRANSPORTATION/RURAL PROGRAM
LOCAL AGENCY PAVEMENT PRESERVATION

(C.H. 5) FAS 591 SECTION 05-00192-00-RS ADAMS COUNTY
PROJECT NO. RS-591(104) JOB NO. C-96-211-05

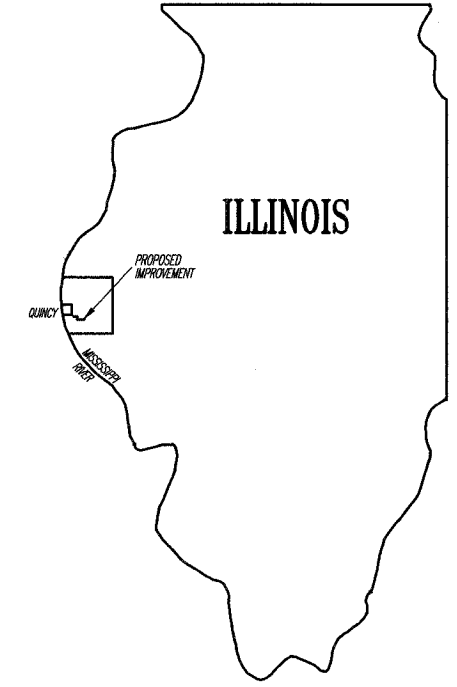

PROPOSED IMPROVEMENT MARKED THUS —

THESE PLANS WERE PREPARED BY ME OR BY A FULL-TIME MEMBER OF MY STAFF WORKING UNDER MY PERSONAL SUPERVISION.

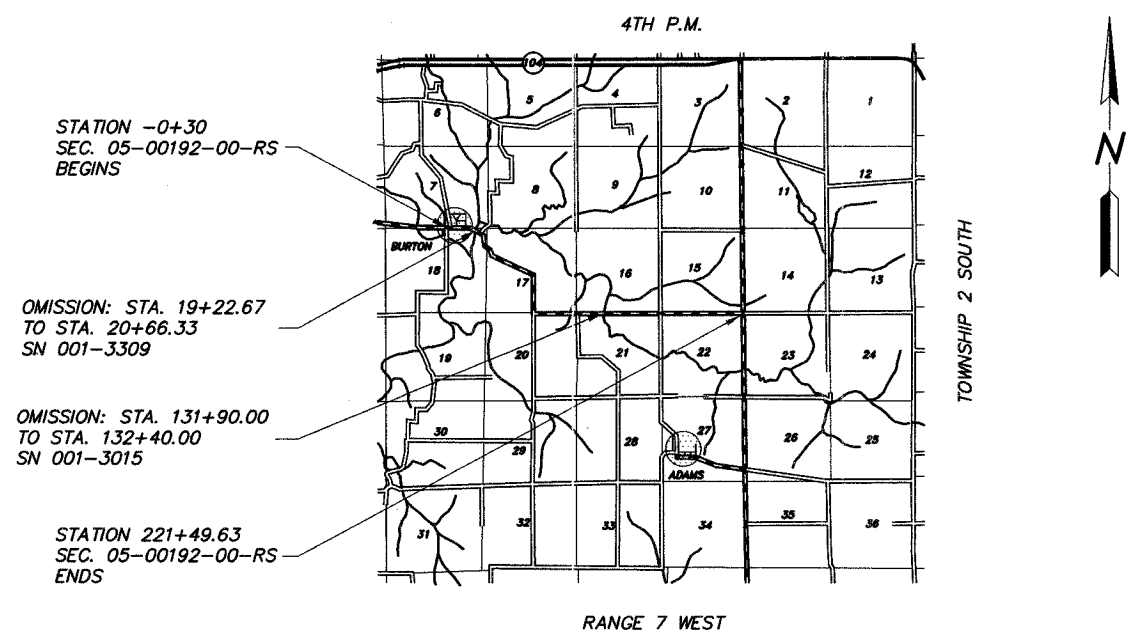

LOCATION MAP

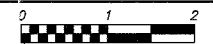

FUNCTIONAL CLASS: MAJOR COLLECTOR (NON-URBAN)
ADT = 300

SUBMITTED BY Richard A. Klump DATE 4-14-05
COUNTY ENGINEER
LICENSE NO. 062-032961
LIC. EXPIRES 11/30/2005

APPROVED <u>April 14</u> 2005	
<u>Richard A. Klump</u>	COUNTY ENGINEER
PASSED <u>April 19</u> 2005	
<u>J.R. Jany</u>	DISTRICT ENGINEER OF CONSTRUCTION
PASSED <u>APRIL 19</u> 2005	
<u>Tom Lind</u>	DISTRICT ENGINEER OF LOCAL ROADS AND STREETS
APPROVED <u>April 19</u> 2005	
<u>Christine M. Reed</u>	DEPUTY DIRECTOR OF HIGHWAYS REGION FOUR ENGINEER
STATE OF ILLINOIS DEPARTMENT OF TRANSPORTATION	

PROPOSED IMPROVEMENT CONSISTS OF PLACING 2" POLYMERIZED BITUMINOUS CONCRETE SURFACE COURSE, SUPERPAVE, MIX "C", N50 ON THE EXISTING 22' ROADWAY WITH OTHER MISCELLANEOUS CONSTRUCTION

UTILITIES:

J.U.L.I.E.	1-800-892-0123
AMERITECH	QUINCY, IL
ADAMS RURAL ELECTRICAL CO-OP	CAMP POINT, IL
AMEREN CIPS	QUINCY, IL
CLAYTON-CAMP POINT WATER DISTRICT	CAMP POINT, IL
NICOR GAS	CARTHAGE, IL

GROSS LENGTH:
STA. -0+30 TO STA. 221+49.63 = 22,179.63 FT.

OMISSIONS:
STA. 19+22.67 TO STA. 20+66.33 = 143.66 FT.
STA. 131+90.00 TO STA. 132+40.00 = 50.00 FT.
TOTAL OMISSIONS: 193.66 FT.

NET LENGTH TO BE IMPROVED: 21,985.97 FT. = 4.164 MILES