

EDWIN H. BOSTON
SE 1/4, NW 1/4, SEC 33, T. 12 N., R. 6 W., 3RD P.M.

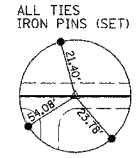

C.H.	SECTION	COUNTY	TOTAL SHEETS	SHEET NO.
12	00-00075-00-FF	MACOUPIN	37	13
STA. 35+00.00		TO STA. 51+00.00		
FED. ROAD DIST. NO.		ILLINOIS FED. AID PROJECT		

P.I. STA. 50+03.39
P.K. NAIL FOUND
S.W. COR., N.W. 1/4, SEC. 33, T. 12 N., R. 6 W., 3RD P.M.

CURVE DATA
P.I. STA. 50+03.39
 $\Delta = 0^\circ 00' 00''$ (LT)
NO CURVE

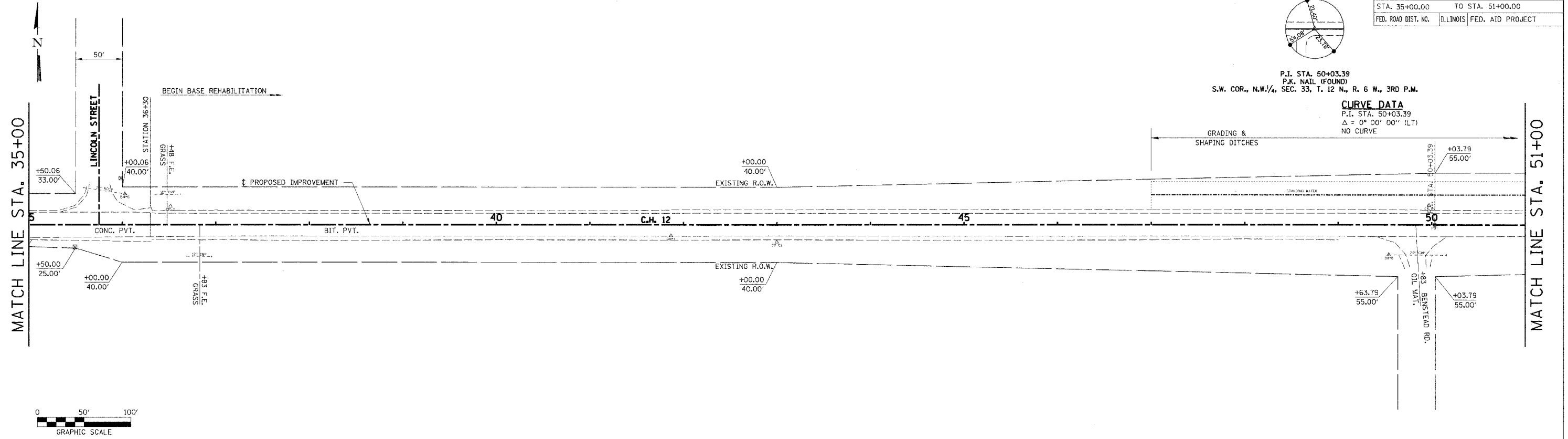

ALBERT J. VALVERT
SW 1/4, SEC 33, T. 12 N., R. 6 W., 3RD P.M.

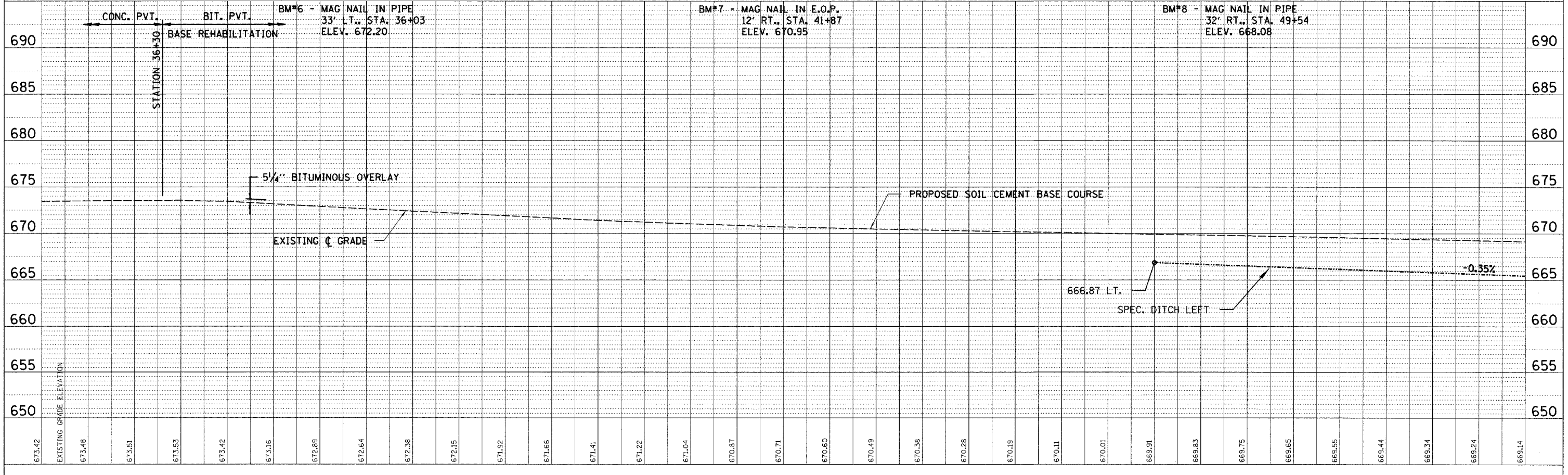

PLAN	DATE	BY
APPROVED	07/24/04	A. WENZ
NOTED		
NO. 000000		

PROFILE	DATE	BY
APPROVED		
NOTED		
NO. 000000		