

F.A. RTE.	SECTION	COUNTY	TOTAL SHEETS	SHEET NO.
	03-06118-00-BR	MORGAN	15	3
STA.	10+75	TO STA.	13+75	
FED. ROAD DIST. NO.	ILLINOIS	FED. AID PROJECT		

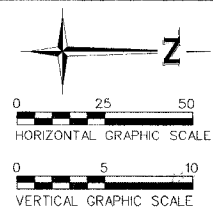

- BM #1314-1: EXISTING USGS BENCHMARK DISK IN TOP SOUTHWEST WINGWALL OF EXISTING BRIDGE OVER SANDY CREEK STAMPED "V.P.T. 1979" EL 585.28
- BM #1314-2: CUT CHISELED "□" ON CONCRETE INLET AT THE NOTRWEST CORNER OF MASSEY LANE AND FRICKE LANE 460'± NORTH OF C BRIDGE OVER SANDY CREEK EL 582.37
- BM #1314-3: SET YELLOW BENCHMARK SPIKE NAIL IN GATE POST SOUTH SIDE OF FIELD ENTRANCE ON EAST SIDE OF MASSEY LANE 500'± SOUTH OF C BRIDGE OVER SANDY CREEK EL 594.38

LOUIS BURMEISTER SECTION 12, T. 14 N., R. 11 W., 3RD P.M.

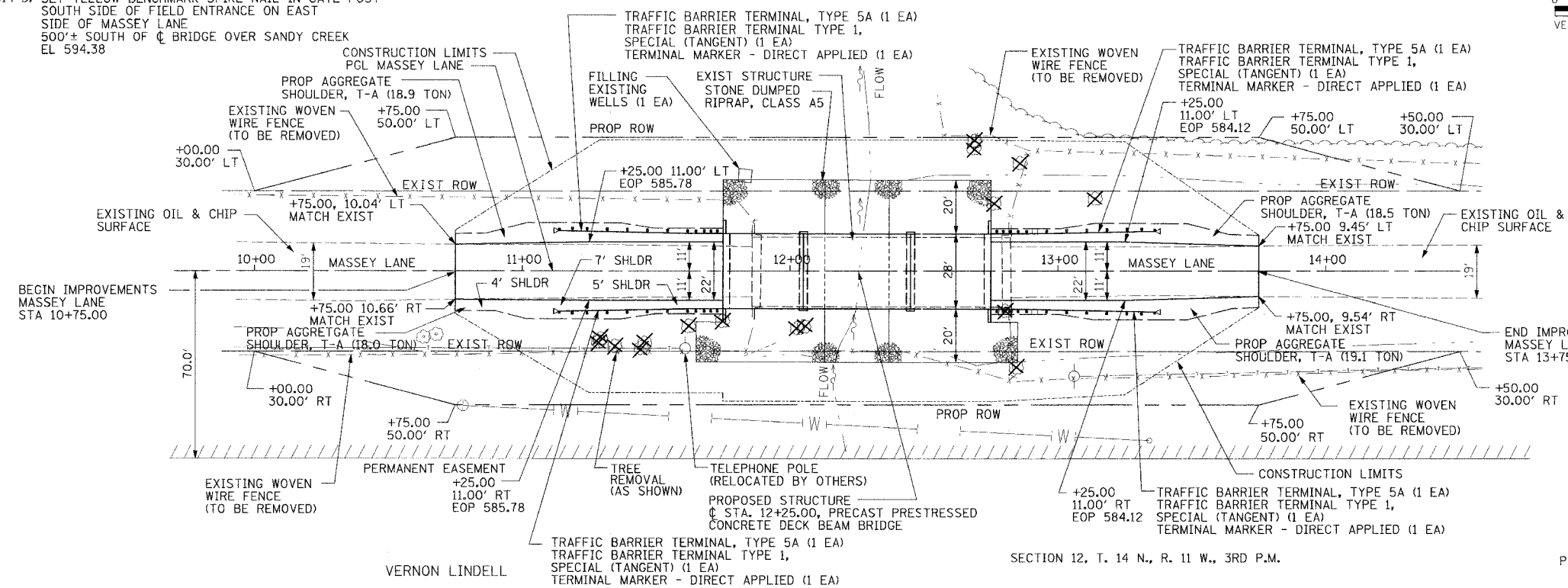

- NOTES**
- THE EXISTING WOVEN WIRE FENCE SHALL BE REMOVED ON EACH SIDE OF MASSEY LANE INSIDE THE LIMITS OF THE PROPOSED RIGHT OF WAY. THE REMOVAL OF THE EXISTING WOVEN WIRE FENCE SHALL NOT BE MEASURED FOR PAYMENT. THE REMOVAL OF THE WOVEN WIRE FENCE SHALL BE INCLUDED WITH CLEARING.
  - THE PERMANENT EASEMENT IS OWNED BY THE SCOTT-MORGAN-GREENE WATER COOPERATIVE.

- LEGEND**
- EXIST TREE TO REMAIN
  - ✗ EXIST TREE TO BE REMOVED

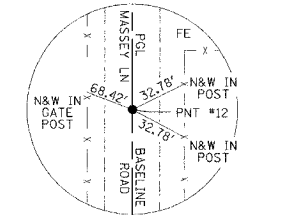

PNT #12 MAG NAIL STA. 8+34.29 (N. 5000.00, E. 5000.00) PNT #11 MAG NAIL STA. 16+34.29 (N. 5800.00, E. 5000.00)

DATE	BY	REVISION

DATE	BY	REVISION

