

RTE.	SECTION	COUNTY	TOTAL SHEETS	SHEET NO.
C.H. 40	*	SANGAMON	33	24
PROJECT * 00-00021-02-BR				

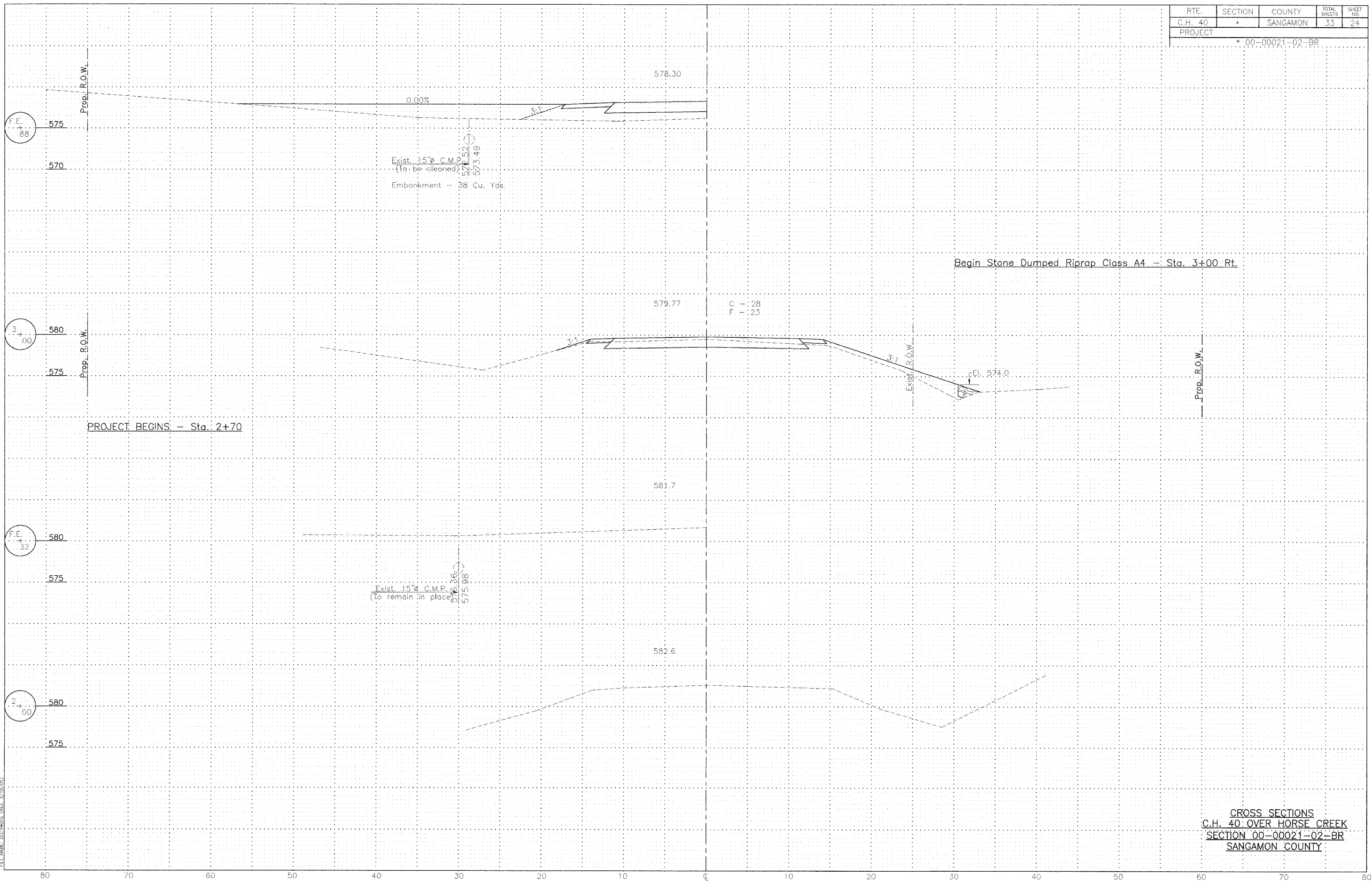

PROJECT BEGINS - Sta. 2+70

Begin Stone Dumped Riprap Class A4 - Sta. 3+00 Rt.

C = 28
F = 23

Exist. 15% C.M.P.
(To be cleaned)
Embankment - 38 Cu. Yds.

Exist. 15% C.M.P.
(To remain in place)

CROSS SECTIONS
C.H. 40: OVER HORSE CREEK
SECTION 00-00021-02-BR
SANGAMON COUNTY

FILE NAME: SSC04005 (REV. 3/10/02)