

| RTE. | SECTION | COUNTY | TOTAL SHEETS | SHEET NO. |
|---------|---------|----------|--------------|-----------|
| C.H. 40 | * | SANGAMON | 33 | 7 |

* 00-00021-02-BR

Existing Structure: Four Span Reinforced Concrete Deck on Steel Stringers.
 Concrete Pile Bent Abutments and Piers. ±162'-9" Bk.-Bk.
 Abutments, ±24'-4" Out-Out. Deck. Concrete Railings.
 45° Skew Rt. Forward. Existing Structure No. 084-3015
 Estimated Quantity to be Removed: Structural Steel - 103,480 Lbs
 Concrete Structures - 201 Cu. Yds.

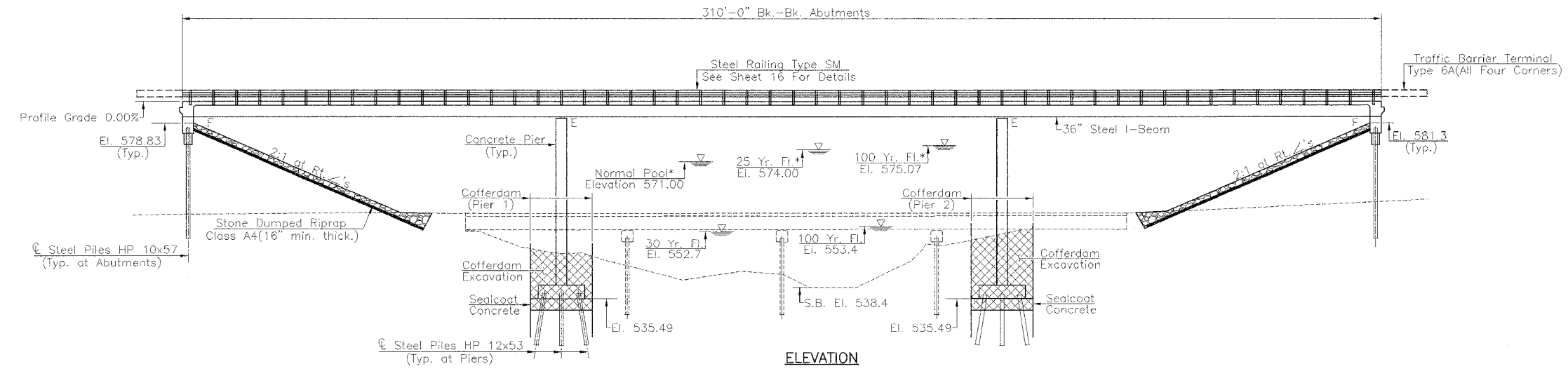

* Hunter Lake Surface Elevations

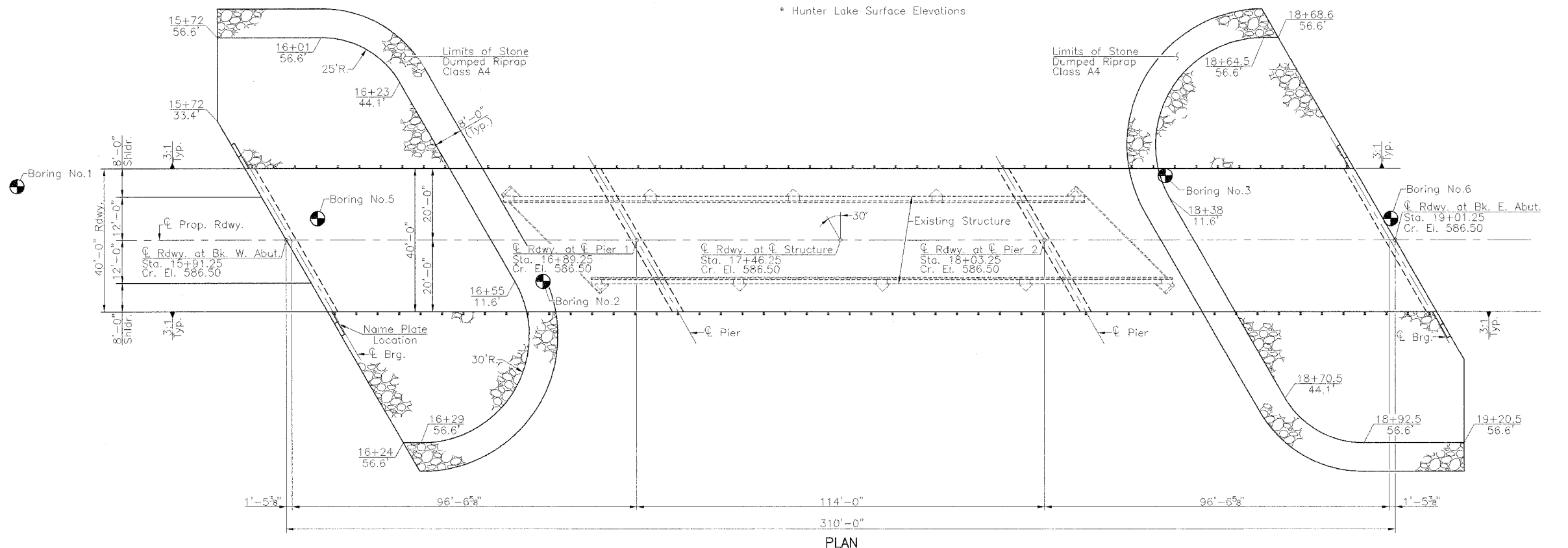

WATERWAY INFORMATION - HORSE CREEK

Drainage Area = 74.1 Sq. Miles Low Grade Elev. = 577.07 @ Sta. 5+70

| Flood | Freq. Yr. | Q C.F.S. | Opening Sq. Ft. | | Nat. H.W.E. | Head-Ft. | | Headwater El. | |
|----------------|------------------------|----------|-----------------|-------|-------------|----------|-------|---------------|-------|
| | | | Exist. | Prop. | | Exist. | Prop. | Exist. | Prop. |
| Design | 30 | 4881 | 662 | 887 | 552.7 | 0.3 | 0.2 | 553.0 | 552.9 |
| Base | 100 | 6433 | 705 | 968 | 553.4 | 0.7 | 0.5 | 554.1 | 553.9 |
| Exist. Overtop | Greater than 500 Years | | | | | | | | |
| Prop. Overtop | Greater than 500 Years | | | | | | | | |
| Max. Calc. | 500 | 8417 | 748 | 1069 | 554.2 | 1.3 | 0.9 | 555.5 | 555.1 |

WATERWAY INFORMATION - HUNTER LAKE

Drainage Area = 74.1 Sq. Miles Low Grade Elev. = 577.07 @ Sta. 5+70

| Flood | Freq. Yr. | Q C.F.S. | Opening Sq. Ft. | | Nat. H.W.E. | Head-Ft. | | Headwater El. | |
|----------------|------------------------|----------|-----------------|-------|-------------|----------|-------|---------------|-------|
| | | | Exist. | Prop. | | Exist. | Prop. | Exist. | Prop. |
| Design | 25 | 4781 | 998 | 1150 | 574.0 | N/A | 0.0 | N/A | 574.0 |
| Base | 100 | 6433 | 1117 | 1291 | 575.1 | N/A | 0.0 | N/A | 575.1 |
| Exist. Overtop | Greater than 500 Years | | | | | | | | |
| Prop. Overtop | Greater than 500 Years | | | | | | | | |

HORSE CREEK
 BUILT 200 BY
 SANGAMON COUNTY
 SECTION 00-00021-02-BR
 STA. 17+46.25
 STR. NO. 084-3415 LOADING HS20
NAME PLATE
 (Standard 515001)

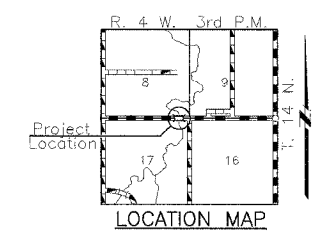

GENERAL PLAN & ELEVATION
C.H. 40 OVER HORSE CREEK
SECTION 00-00021-02-BR
SANGAMON COUNTY