

POINT	FAP 322 (US 51)		TR 193		ELEVATION
	STATION	OFFSET	STATION	OFFSET	
A1	741+01.59	49.00' LT	19+71.73	96.43' RT	627.70
A2	741+15.67	49.57' LT	19+68.04	82.83' RT	627.64
A3	741+29.66	51.27' LT	19+63.28	69.57' RT	627.57
A4	741+43.47	54.08' LT	19+57.46	56.73' RT	627.47
A5	741+57.00	58.00' LT	19+50.63	44.41' RT	627.31
A6	741+70.18	63.00' LT	19+42.83	32.67' RT	627.10
A7	741+78.46	67.50' LT	19+36.61	25.59' RT	626.94
A8	741+85.75	73.47' LT	19+29.17	19.81' RT	626.78
A9	741+91.80	80.70' LT	19+20.77	15.52' RT	626.61
A10	741+96.38	88.94' LT	19+11.72	12.89' RT	626.45
A11	741+99.33	97.89' LT	19+02.34	12.00' RT	626.28

POINT	FAP 322 (US 51)		TR 193		ELEVATION
	STATION	OFFSET	STATION	OFFSET	
E1	740+69.66	25.00' LT	20+02.22	122.23' RT	627.79
E2	741+34.18	1.40' LT	20+10.89	54.08' RT	627.15
E3	741+29.73	12.68' RT	20+25.60	55.28' RT	627.35
E4	741+22.54	13.00' RT	20+27.52	62.22' RT	627.39
E5	742+56.10	13.00' LT	19+72.48	62.22' LT	626.99
E6	742+48.91	12.68' LT	19+74.40	55.28' LT	627.00
E7	742+44.47	1.40' RT	19+89.11	54.08' LT	626.82
E8	743+08.98	25.00' RT	19+97.78	122.23' RT	627.07
E9	741+95.02	25.00' LT	19+74.36	CL	627.42
E10	741+83.62	25.00' RT	20+25.64	CL	627.45

POINT	FAP 322 (US 51)		TR 193		ELEVATION
	STATION	OFFSET	STATION	OFFSET	
D1	740+68.29	61.00' RT	20+86.38	104.45' RT	627.56
D2	740+87.69	63.96' RT	20+84.95	84.87' RT	627.44
D3	741+05.32	72.58' RT	20+89.44	65.77' RT	627.21
D4	741+19.58	86.07' RT	20+99.42	48.87' RT	626.83
D5	741+29.16	103.20' RT	21+13.99	35.72' RT	626.38
D6	741+33.19	122.40' RT	21+31.82	27.52' RT	625.89
D7	741+33.80	144.75' RT	21+53.47	21.96' RT	625.40
D8	741+33.17	167.10' RT	21+75.40	17.61' RT	624.98
D9	741+31.28	189.38' RT	21+97.54	14.50' RT	624.63
D10	741+28.15	211.51' RT	22+19.82	12.63' RT	624.27
D11	741+23.80	233.44' RT	22+42.17	12.00' RT	623.90

POINT	FAP 322 (US 51)		TR 193		ELEVATION
	STATION	OFFSET	STATION	OFFSET	
B1	742+54.85	233.44' LT	17+57.83	12.00' LT	623.45
B2	742+50.49	211.51' LT	17+80.18	12.63' LT	623.87
B3	742+47.36	189.38' LT	18+02.46	14.50' LT	624.28
B4	742+45.48	167.10' LT	18+24.60	17.61' LT	624.70
B5	742+44.84	144.75' LT	18+46.53	21.96' LT	625.14
B6	742+45.45	122.40' LT	18+68.18	27.52' LT	625.64
B7	742+49.49	103.20' LT	18+86.01	35.72' LT	626.08
B8	742+59.07	86.07' LT	19+00.58	48.87' LT	626.43
B9	742+73.32	72.58' LT	19+10.56	65.77' LT	626.71
B10	742+90.95	63.96' LT	19+15.05	84.87' LT	626.83
B11	743+10.36	61.00' LT	19+13.62	104.45' LT	626.83

F.A.P. RTE.	SECTION	COUNTY	TOTAL SHEETS	SHEET NO.
322	11-10	CHRISTIAN	310	104

STA. TO STA.
FED. ROAD DIST. NO. ILLINOIS FED. AID PROJECT

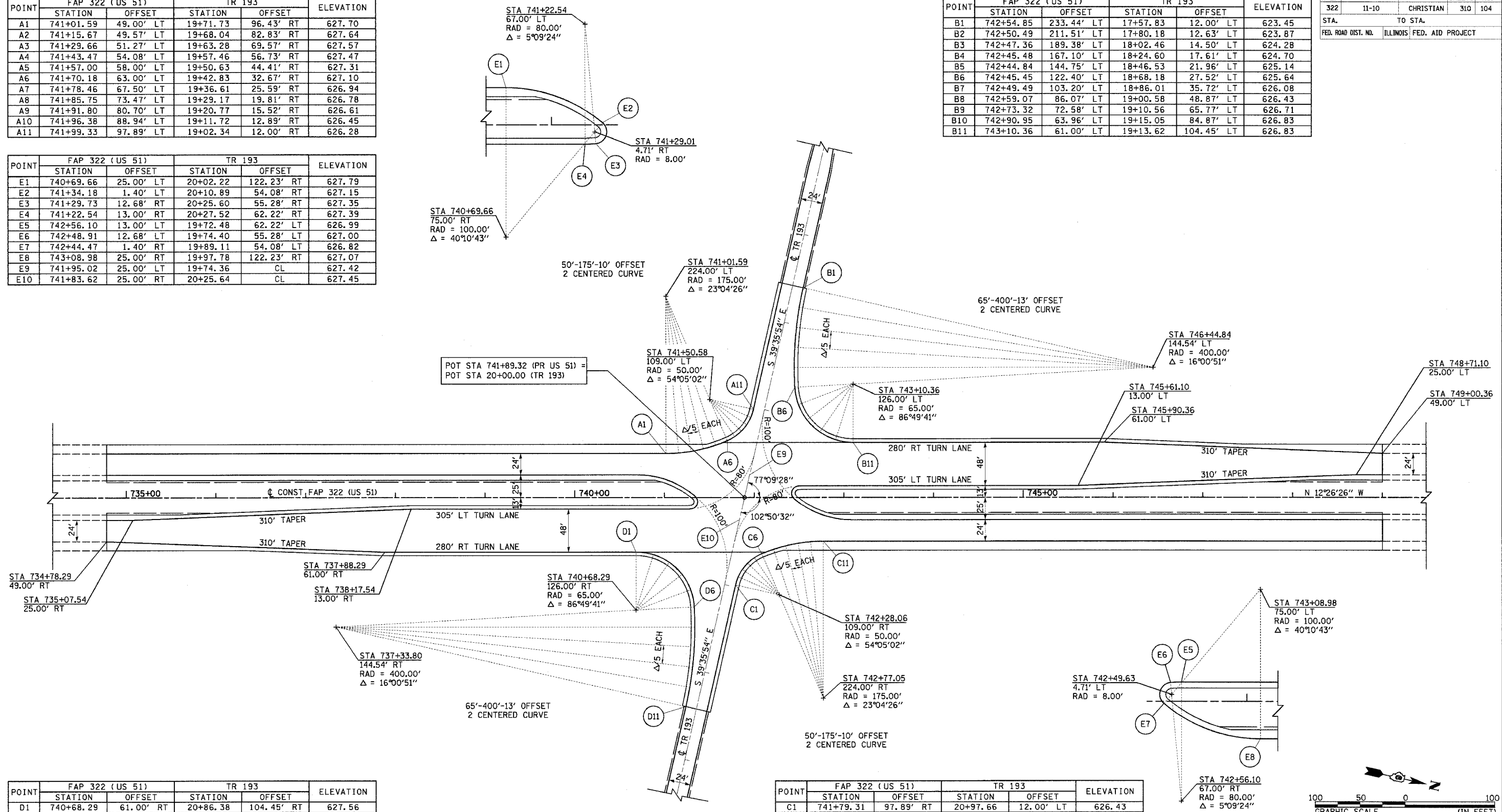

NOTES:
ALL STATIONS, OFFSETS, AND ELEVATIONS SHOWN ARE FOR FINAL PAVING.
SEE SHEETS 54 AND 72 FOR PLAN AND PROFILES.

POINT	FAP 322 (US 51)		TR 193		ELEVATION
	STATION	OFFSET	STATION	OFFSET	
C1	741+79.31	97.89' RT	20+97.66	12.00' LT	626.43
C2	741+82.27	88.94' RT	20+88.28	12.89' LT	626.58
C3	741+86.85	80.70' RT	20+79.23	15.52' LT	626.73
C4	741+92.89	73.47' RT	20+70.83	19.81' LT	626.86
C5	742+00.18	67.50' RT	20+63.39	25.59' LT	626.97
C6	742+08.47	63.00' RT	20+57.17	32.67' LT	627.06
C7	742+21.64	58.00' RT	20+49.37	44.41' LT	627.15
C8	742+35.18	54.08' RT	20+42.54	56.73' LT	627.19
C9	742+48.99	51.27' RT	20+36.72	69.57' LT	627.21
C10	742+62.97	49.57' RT	20+31.96	82.83' LT	627.20
C11	742+77.05	49.00' RT	20+28.28	96.43' LT	627.17

REVISIONS	
NAME	DATE

ILLINOIS DEPARTMENT OF TRANSPORTATION
GEOMETRIC DETAILS
TR 193
FAP 322 (US 51)
SECTION 11-1
CHRISTIAN COUNTY

SCALE: 1"=50'
DATE 3/18/05

DRAWN BY BGJ
CHECKED BY SEB

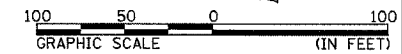

3/29/2005