

F.A.P. RTE.	SECTION	COUNTY	TOTAL SHEETS	SHEET NO.
322	11-1	CHRISTIAN	310	89
STA. 821+00		TO STA. 836+00		
FED. ROAD DIST. NO.		ILLINOIS	FED. AID PROJECT	

STATE OF ILLINOIS
DEPARTMENT OF TRANSPORTATION

NW 1/4 SEC 24, T13 N, R1 E, 3RD PM

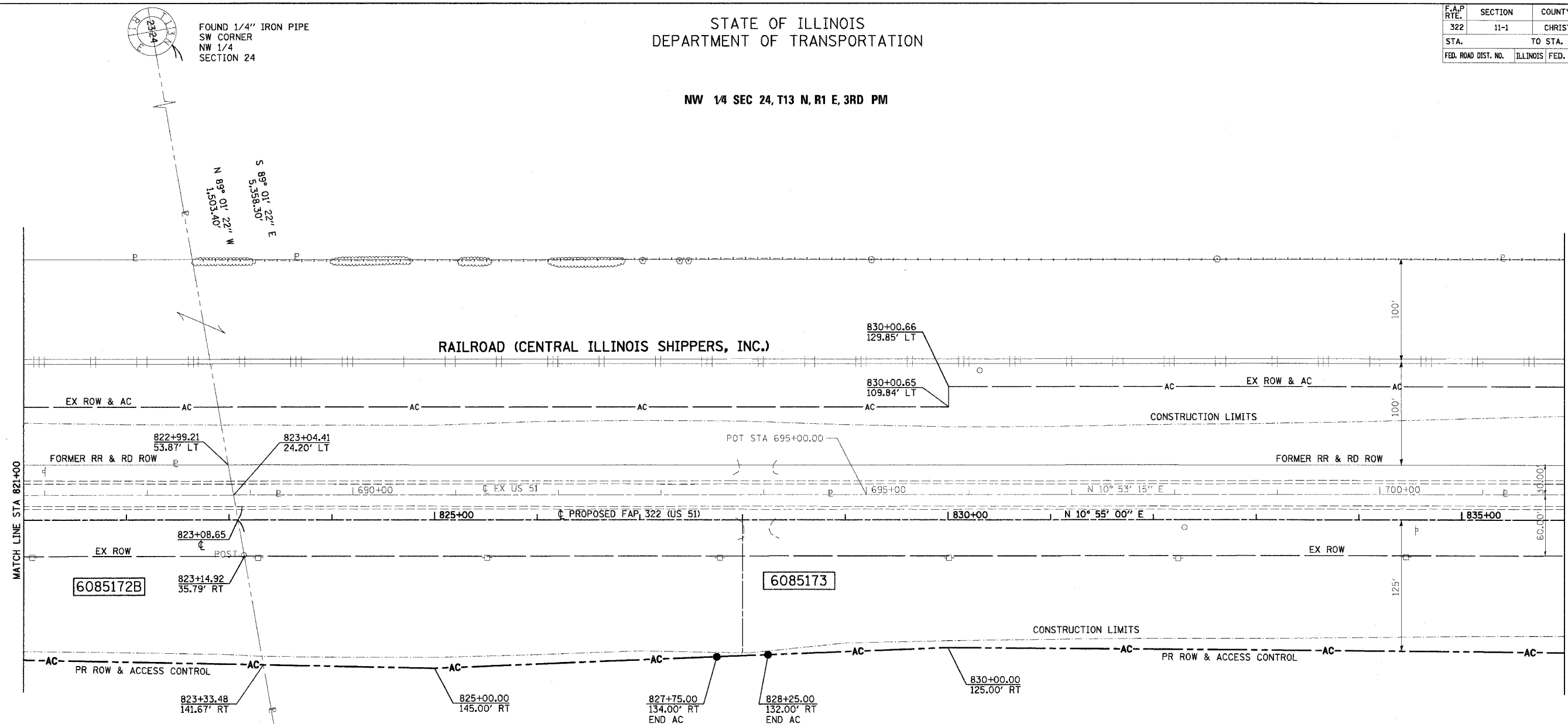

MATCH LINE STA 821+00

MATCH LINE STA 836+00

6085172B

6085173

REMAINING AREA THIS SIDE = 80.499 ACRES

PARCEL NO 6085172B
IRENE MORRISON TRUST
SEE TABULATIONS ON SHEET 7

PARCEL NO 6085173
VIVIAN WENDLING

TOTAL AREA = 73.133 ACRES
REQUIRED ROW AREA = 3.000 ACRES
EXISTING ROW AREA = 1.858 ACRES
TOTAL ROW AREA = 4.858 ACRES
REMAINING AREA = 68.275 ACRES

NW 1/4 SEC 24, T13 N, R1 E, 3RD PM

NOTES:
BEARINGS ARE BASED ON THE ILLINOIS STATE PLANE
COORDINATE SYSTEM, NAD83 1986 - WEST ZONE
SURVEYED IN ENGLISH.

PLAT DISTANCES AND STATIONING ARE IN GRID ENGLISH.
TO CONVERT TO GROUND DIVIDE BY GRID FACTOR.
GRID FACTOR = 1.00003150

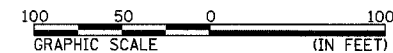

RIGHT OF WAY PLANS

ROUTE F.A.P. 322 (US 51)
SECTION 11-1
PROJECT
COUNTY CHRISTIAN
JOB NO. R-96-008-95
STA 821+00 TO STA 836+00
SCALE 1 = 50'

SHEET NO. 11 OF 24

4/8/03:41 PM
3/29/2005
p:\011\area\1102\24\area\plan\1102\24\plan\1102\24.dgn