

STATE OF ILLINOIS
DEPARTMENT OF TRANSPORTATION

F.A.P. RTE.	SECTION	COUNTY	TOTAL SHEETS	SHEET NO.
322	11-1	CHRISTIAN	310	88
STA.		TO STA.		
FED. ROAD DIST. NO.		ILLINOIS FED. AID PROJECT		

PARCEL NO 6085172D
IRENE MORRISON TRUST
SEE TABULATIONS ON SHEET 7

SW 1/4 SEC 24, T13 N, R1 E, 3RD PM

REMAINING AREA THIS SIDE = 24.479 ACRES

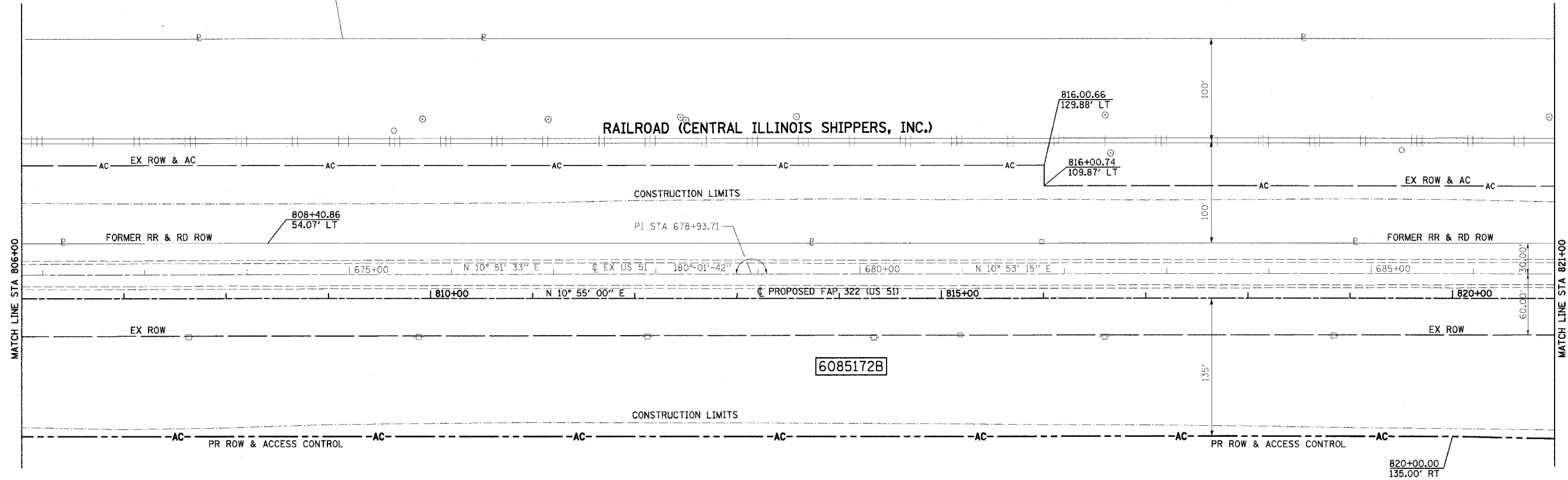

REMAINING AREA THIS SIDE = 80.499 ACRES

PARCEL NO 6085172B
IRENE MORRISON TRUST
SEE TABULATIONS ON SHEET 7

SW 1/4 SEC 24, T13 N, R1 E, 3RD PM

NOTES:
BEARINGS ARE BASED ON THE ILLINOIS STATE PLANE COORDINATE SYSTEM, NAD83 1986 - WEST ZONE SURVEYED IN ENGLISH.
PLAT DISTANCES AND STATIONING ARE IN GRID ENGLISH. TO CONVERT TO GROUND DIVIDE BY GRID FACTOR. GRID FACTOR = 1.00003150

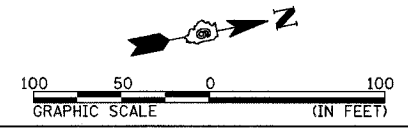

RIGHT OF WAY PLANS	
ROUTE	F.A.P. 322 (US 51)
SECTION	11-1
PROJECT	
COUNTY	CHRISTIAN
JOB NO.	R-96-008-95
STA	806+00 TO STA 821+00
SCALE	1 = 50'
SHEET NO. 10 OF 24	