

F.A.P. RTE.	SECTION	COUNTY	TOTAL SHEETS	SHEET NO.
322	11-10	CHRISTIAN	310	47
STA.		TO STA.		
FED. ROAD DIST. NO.		ILLINOIS FED. AID PROJECT		

DETAIL "C"
STAGE 1 - TR 185

DETAIL "D"
STAGE 1 - TR 169 / CH 17

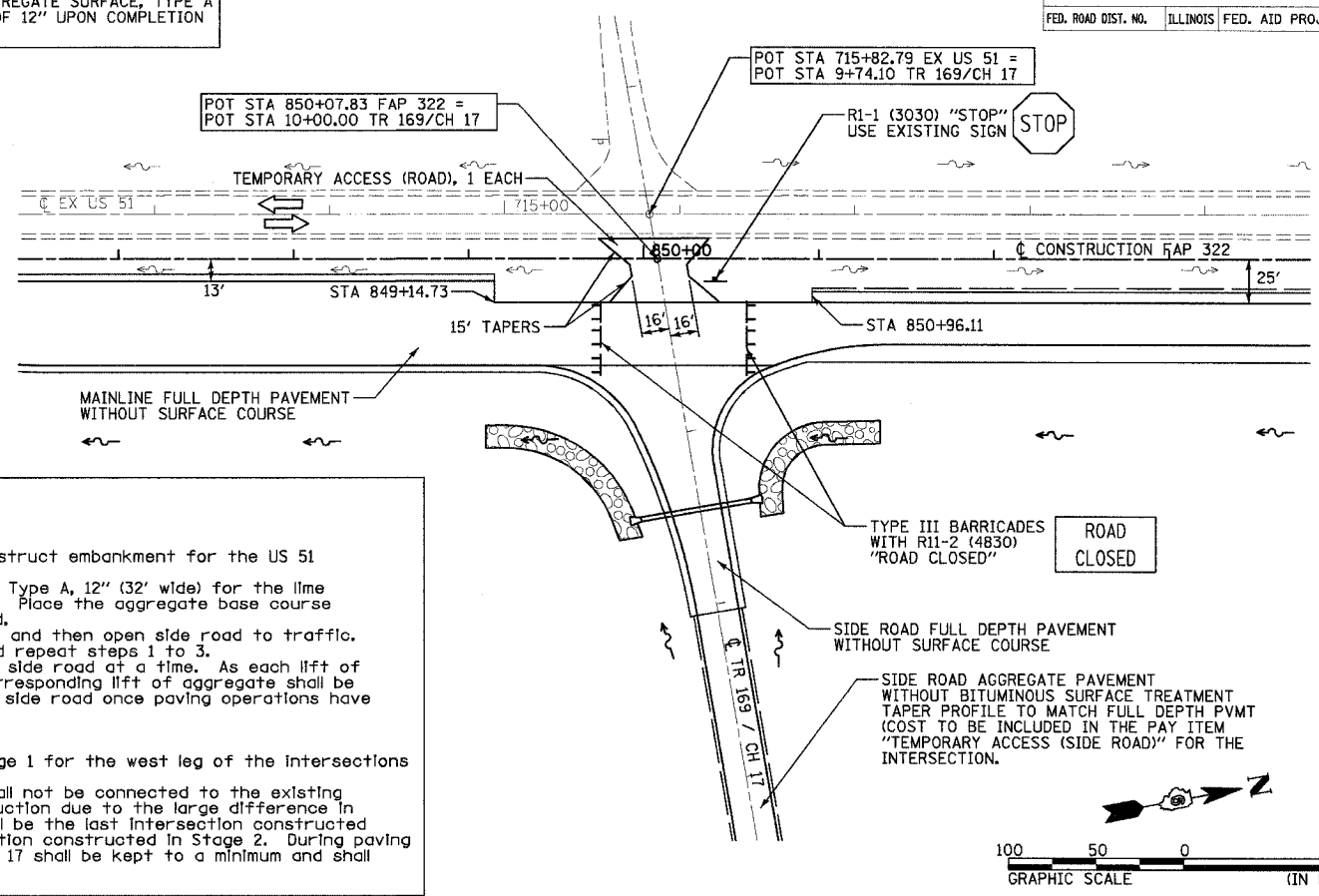
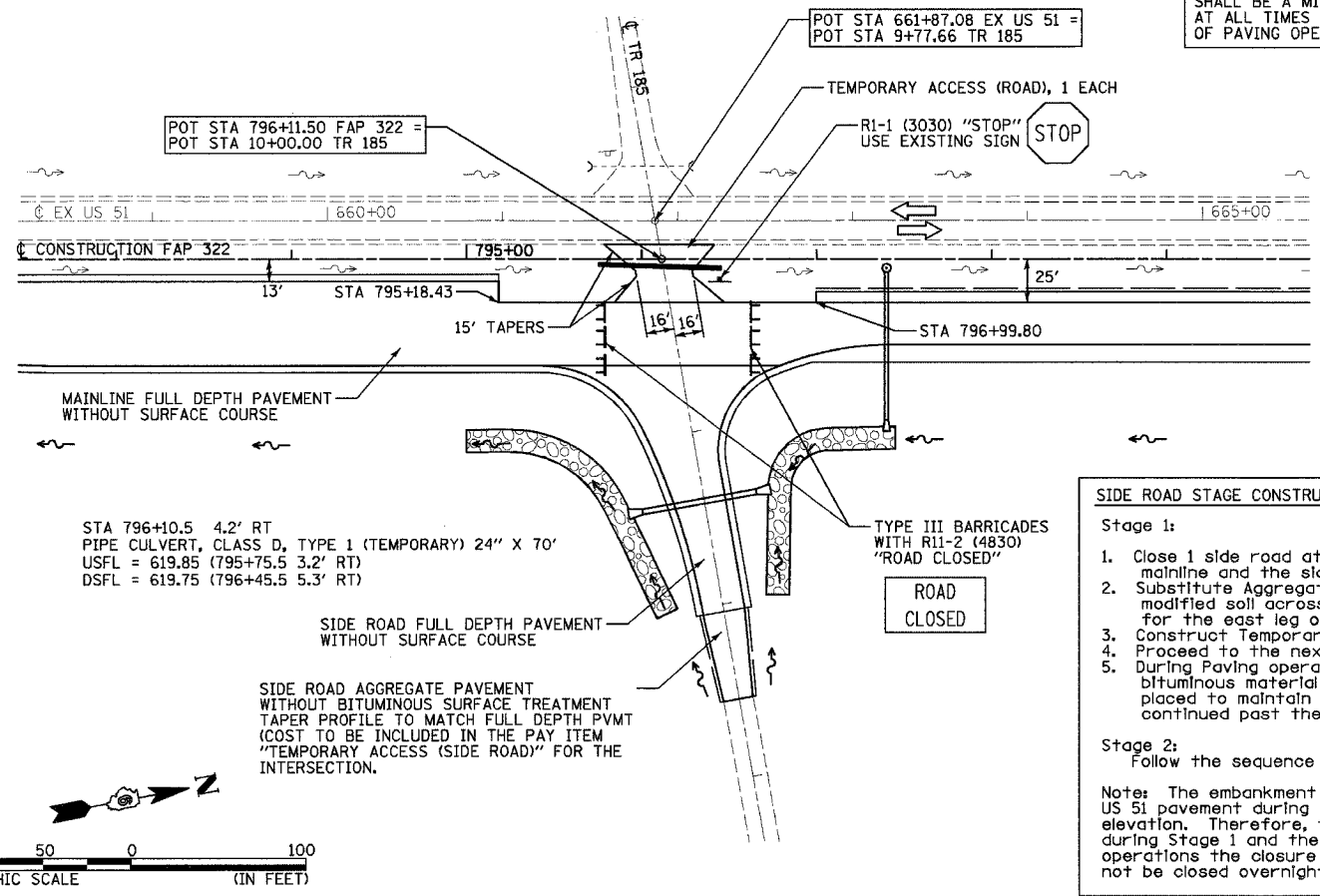

TEMPORARY ACCESS (ROAD) SHALL BE A MINIMUM OF 6" AGGREGATE SURFACE, TYPE A AT ALL TIMES AND A MINIMUM OF 12" UPON COMPLETION OF PAVING OPERATIONS.

SIDE ROAD STAGE CONSTRUCTION

Stage 1:

1. Close 1 side road at a time to construct embankment for the US 51 mainline and the side road.
2. Substitute Aggregate Base Course, Type A, 12" (32' wide) for the lime modified soil across US 51 mainline. Place the aggregate base course for the east leg of the side road.
3. Construct Temporary Access (Road) and then open side road to traffic.
4. Proceed to the next side road and repeat steps 1 to 3.
5. During Paving operations close one side road at a time. As each lift of bituminous material is placed a corresponding lift of aggregate shall be placed to maintain traffic on the side road once paving operations have continued past the intersection.

Stage 2:

Follow the sequence detailed in Stage 1 for the west leg of the intersections

Note: The embankment for TR 151A shall not be connected to the existing US 51 pavement during Stage 1 construction due to the large difference in elevation. Therefore, the TR 151A shall be the last intersection constructed during Stage 1 and the first intersection constructed in Stage 2. During paving operations the closure of TR 169 / CH 17 shall be kept to a minimum and shall not be closed overnight.

POT STA 796+11.50 FAP 322 =
POT STA 10+00.00 TR 185

POT STA 661+87.08 EX US 51 =
POT STA 9+77.66 TR 185

TEMPORARY ACCESS (ROAD), 1 EACH

R1-1 (3030) "STOP" USE EXISTING SIGN

15' TAPERS

STA 795+18.43

16' 16'

STA 796+99.80

25'

CONSTRUCTION FAP 322

EX US 51

660+00

795+00

665+00

MAINLINE FULL DEPTH PAVEMENT WITHOUT SURFACE COURSE

TYPE III BARRICADES WITH R11-2 (4830) "ROAD CLOSED"

ROAD CLOSED

SIDE ROAD FULL DEPTH PAVEMENT WITHOUT SURFACE COURSE

SIDE ROAD AGGREGATE PAVEMENT WITHOUT BITUMINOUS SURFACE TREATMENT TAPER PROFILE TO MATCH FULL DEPTH PAVEMENT (COST TO BE INCLUDED IN THE PAY ITEM "TEMPORARY ACCESS (SIDE ROAD)" FOR THE INTERSECTION.

STA 796+10.5 4.2' RT
PIPE CULVERT, CLASS D, TYPE 1 (TEMPORARY) 24" X 70'
USFL = 619.85 (795+75.5 3.2' RT)
DSFL = 619.75 (796+45.5 5.3' RT)

POT STA 850+07.83 FAP 322 =
POT STA 10+00.00 TR 169/CH 17

TEMPORARY ACCESS (ROAD), 1 EACH

R1-1 (3030) "STOP" USE EXISTING SIGN

15' TAPERS

STA 849+14.73

16' 16'

STA 850+96.11

25'

CONSTRUCTION FAP 322

EX US 51

715+00

850+00

MAINLINE FULL DEPTH PAVEMENT WITHOUT SURFACE COURSE

TYPE III BARRICADES WITH R11-2 (4830) "ROAD CLOSED"

ROAD CLOSED

SIDE ROAD FULL DEPTH PAVEMENT WITHOUT SURFACE COURSE

SIDE ROAD AGGREGATE PAVEMENT WITHOUT BITUMINOUS SURFACE TREATMENT TAPER PROFILE TO MATCH FULL DEPTH PAVEMENT (COST TO BE INCLUDED IN THE PAY ITEM "TEMPORARY ACCESS (SIDE ROAD)" FOR THE INTERSECTION.

POT STA 715+82.79 EX US 51 =
POT STA 9+74.10 TR 169/CH 17

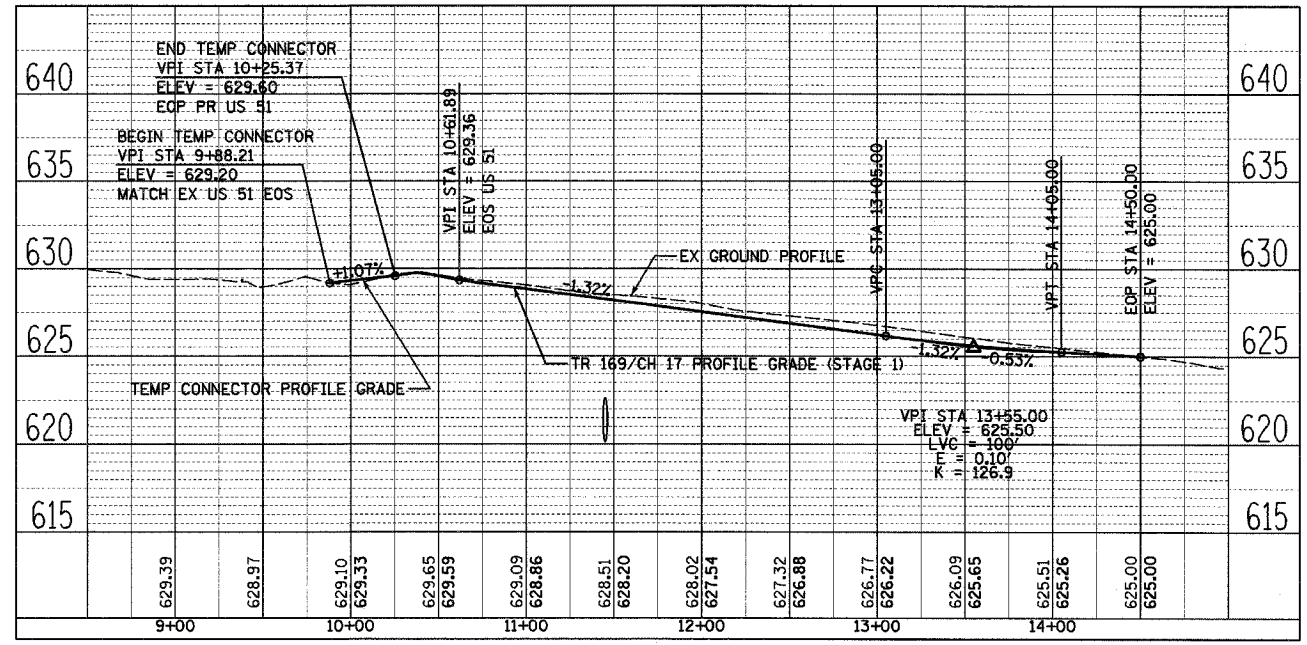
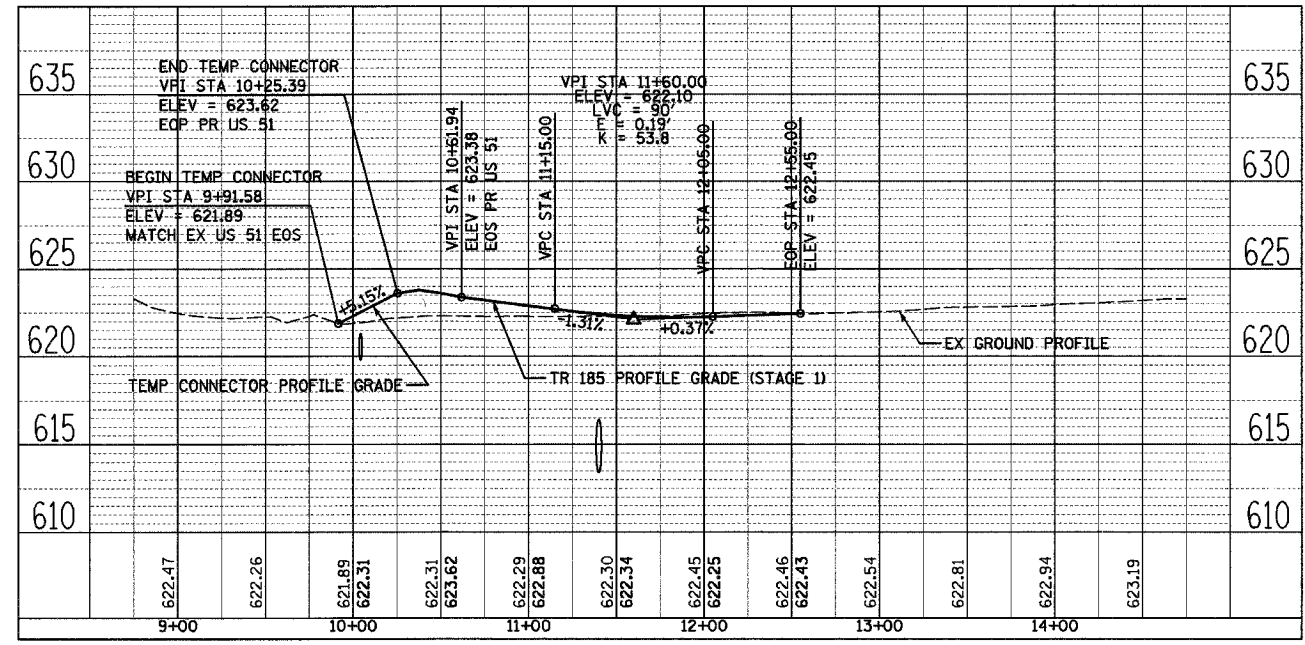

TRAFFIC CONTROL SET UP FOR DETAIL "C" AND DETAIL "D" WILL NOT BE MEASURED AND PAID FOR SEPARATELY. THE COST WILL BE CONSIDERED TO BE INCLUDED IN THE CONTRACT UNIT BID PRICES OF THE TRAFFIC CONTROL AND PAY ITEMS INCLUDED IN THE CONTRACT. THE TEMPORARY SIGNS, BARRICADES, AND DRUMS WILL REMAIN THE PROPERTY OF THE CONTRACTOR. TEMPORARY PAVEMENT STRIPING SHALL BE PAID FOR SEPARATELY.

REVISIONS	
NAME	DATE

ILLINOIS DEPARTMENT OF TRANSPORTATION
TRAFFIC CONTROL AND STAGING
DETAILS "C" AND "D"
FAP 322 (US 51)
SECTION 11-1
CHRISTIAN COUNTY

SCALE: 1"=50'
DATE: 3/17/05
DRAWN BY: SEB
CHECKED BY: EBB

3/17/2005