

ROUTE NO.	SECTION	COUNTY	TOTAL SHEETS	SHEET NO.
CH 31	*	MACON	162	19
FED. ROAD DIST. NO.		ILLINOIS	PROJECT	

\* 02-00175-00-PV

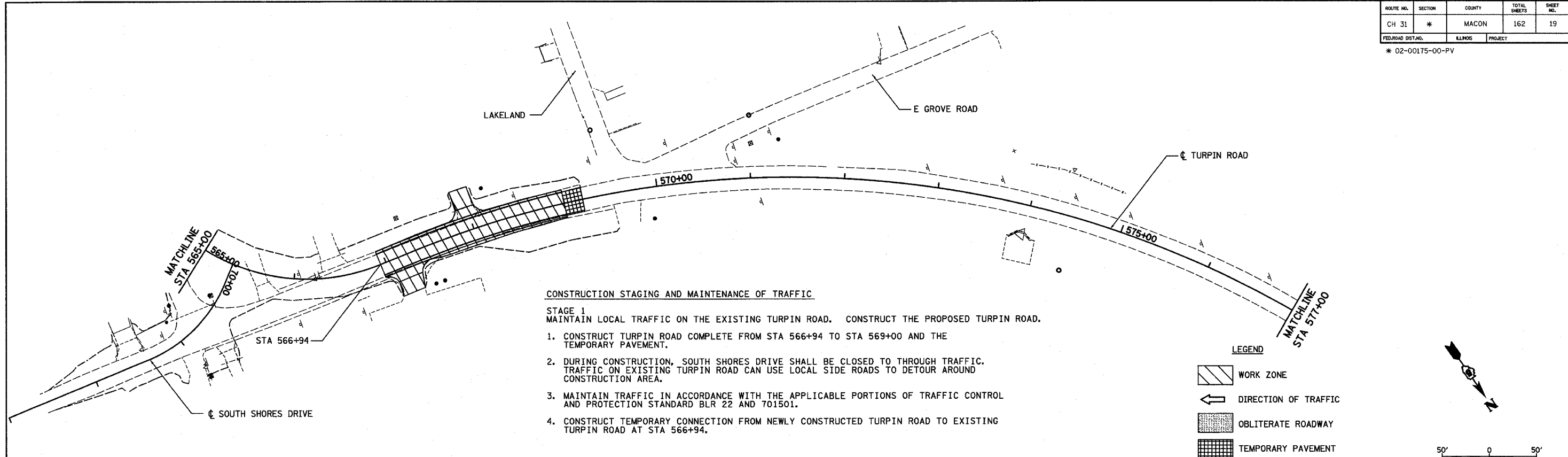

**CONSTRUCTION STAGING AND MAINTENANCE OF TRAFFIC**

STAGE 1  
 MAINTAIN LOCAL TRAFFIC ON THE EXISTING TURPIN ROAD. CONSTRUCT THE PROPOSED TURPIN ROAD.

1. CONSTRUCT TURPIN ROAD COMPLETE FROM STA 566+94 TO STA 569+00 AND THE TEMPORARY PAVEMENT.
2. DURING CONSTRUCTION, SOUTH SHORES DRIVE SHALL BE CLOSED TO THROUGH TRAFFIC. TRAFFIC ON EXISTING TURPIN ROAD CAN USE LOCAL SIDE ROADS TO DETOUR AROUND CONSTRUCTION AREA.
3. MAINTAIN TRAFFIC IN ACCORDANCE WITH THE APPLICABLE PORTIONS OF TRAFFIC CONTROL AND PROTECTION STANDARD BLR 22 AND 701501.
4. CONSTRUCT TEMPORARY CONNECTION FROM NEWLY CONSTRUCTED TURPIN ROAD TO EXISTING TURPIN ROAD AT STA 566+94.

STAGE 1

STAGE 2

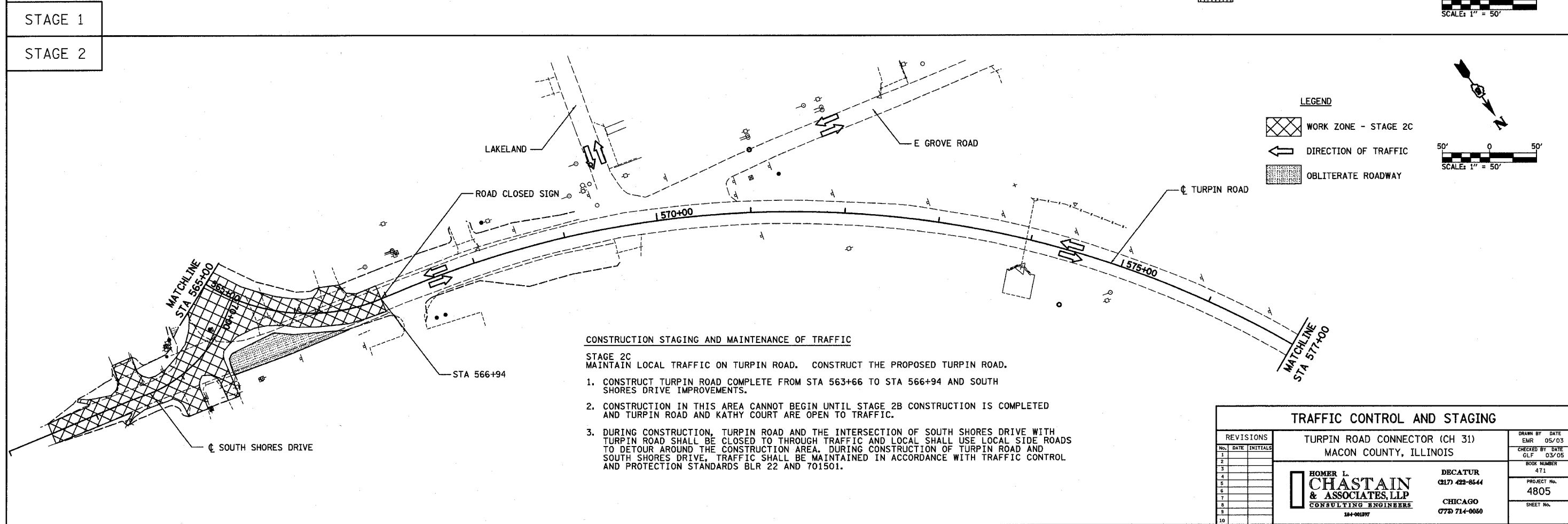

**CONSTRUCTION STAGING AND MAINTENANCE OF TRAFFIC**

STAGE 2C  
 MAINTAIN LOCAL TRAFFIC ON TURPIN ROAD. CONSTRUCT THE PROPOSED TURPIN ROAD.

1. CONSTRUCT TURPIN ROAD COMPLETE FROM STA 563+66 TO STA 566+94 AND SOUTH SHORES DRIVE IMPROVEMENTS.
2. CONSTRUCTION IN THIS AREA CANNOT BEGIN UNTIL STAGE 2B CONSTRUCTION IS COMPLETED AND TURPIN ROAD AND KATHY COURT ARE OPEN TO TRAFFIC.
3. DURING CONSTRUCTION, TURPIN ROAD AND THE INTERSECTION OF SOUTH SHORES DRIVE WITH TURPIN ROAD SHALL BE CLOSED TO THROUGH TRAFFIC AND LOCAL SHALL USE LOCAL SIDE ROADS TO DETOUR AROUND THE CONSTRUCTION AREA. DURING CONSTRUCTION OF TURPIN ROAD AND SOUTH SHORES DRIVE, TRAFFIC SHALL BE MAINTAINED IN ACCORDANCE WITH TRAFFIC CONTROL AND PROTECTION STANDARDS BLR 22 AND 701501.

REVISIONS		TURPIN ROAD CONNECTOR (CH 31) MACON COUNTY, ILLINOIS		DRAWN BY	DATE
1				EMR	05/03
2				CHECKED BY	DATE
3				GLF	03/05
4				BOOK NUMBER	471
5				PROJECT No.	4805
6				SHEET No.	
7					
8					
9					
10					

**HOMER L.  
CHASTAIN  
& ASSOCIATES, LLP**  
CONSULTING ENGINEERS

184-061977

DECATUR  
317) 422-8544

CHICAGO  
773) 714-0050