

F.A.P. RTE.	SECTION	COUNTY	TOTAL SHEETS	SHEET NO.
310	(38-1) RS	MCDONOUGH	83	53
STA. 278+00 TO STA. 291+00				
FED. ROAD DIST. NO.		ILLINOIS FED. AID PROJECT		

T6N R2W 4th P.M. (MACOMB TWP.)
SECTION 18

T6N R2W 4th P.M. (MACOMB TWP.)
SECTION 19

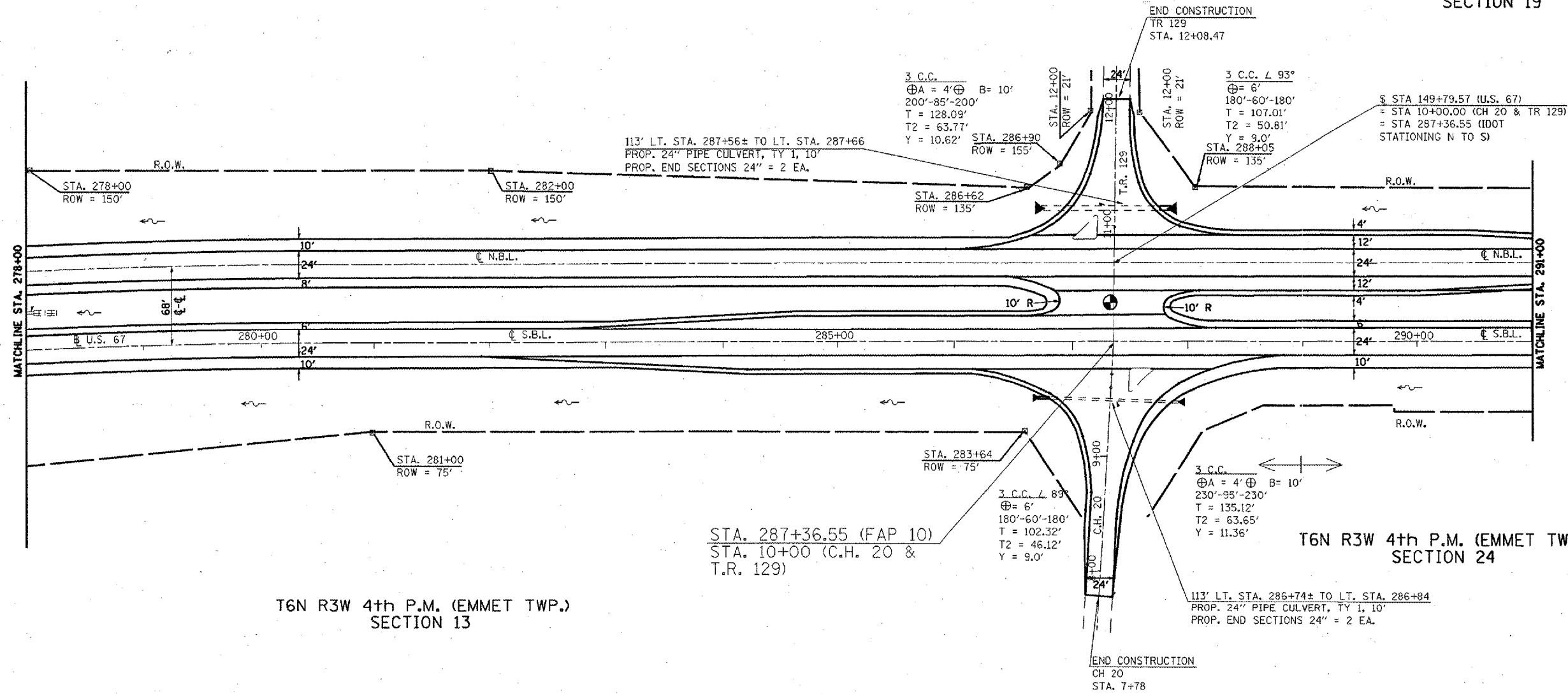

T6N R3W 4th P.M. (EMMET TWP.)
SECTION 13

T6N R3W 4th P.M. (EMMET TWP.)
SECTION 24

NOTE: MEDIAN CROSSOVER AND SIDE ROAD PAVEMENT TO BE TREATED THE SAME AS THE TURN LANE PAVEMENT.

EXISTING LEGEND

PROPOSED LEGEND

- | | |
|------------------------|--------------------------|
| CONCRETE REVETMENT MAT | GUARDRAIL |
| R.O.W. MARKER | DITCH CHECK |
| SUMMIT | END SECTION REPLACEMENT |
| EXIST. DITCH CHECK | PIPE CULVERT REPLACEMENT |
| PAVED DITCH | DITCH GRADING |
| EXIST. GUARDRAIL | INLET PROTECTION |
| | RIPRAP A-5 |
| | AGGREGATE DITCH |

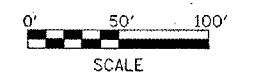

REVISIONS	
NAME	DATE

ILLINOIS DEPARTMENT OF TRANSPORTATION
PROPOSED PLAN SHEET
STA. 278+00 TO 291+00

SCALE: VERT. 1" = 50'
HORIZ. 1" = 50'
DATE: ##DATE##

DRAWN BY: CADD
CHECKED BY: