

F.A.P. RTE.	SECTION	COUNTY	TOTAL SHEETS	SHEET NO.
310	C38-1) RS	MCDONOUGH	83	28
STA. 113+00 TO STA. 128+00				
FED. ROAD DIST. NO.		ILLINOIS FED. AID PROJECT		

T7N R2W 4th P.M. (WALNUT GROVE TWP.)
SECTION 31

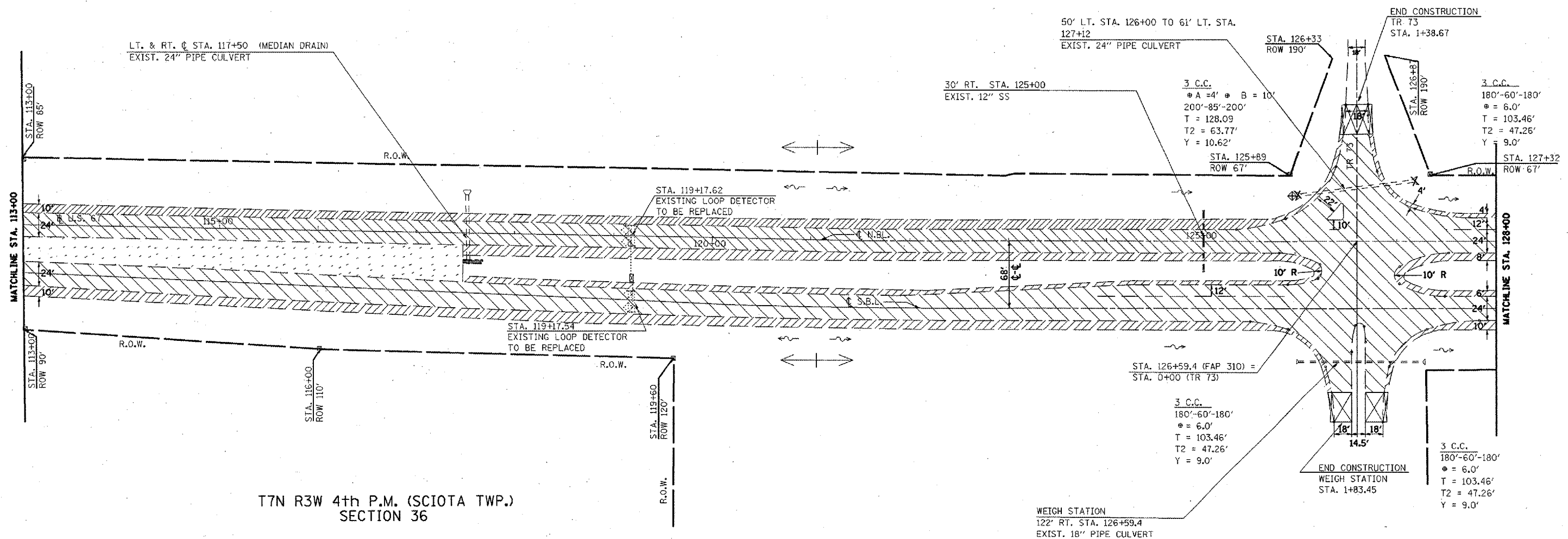

T7N R3W 4th P.M. (SCIOTA TWP.)
SECTION 36

EXISTING LEGEND

- CONCRETE REVETMENT MAT
- R.O.W. MARKER
- SUMMIT
- EXIST. DITCH CHECK
- PAVED DITCH
- EXIST. GUARDRAIL

REMOVAL LEGEND

- GUARDRAIL REMOVAL
- CULVERT REMOVAL
- BUTT JOINT
- SHOULDER MILLING
- MEDIAN MILLING
- PAVEMENT MILLING
- END SECTION REMOVAL
- PAVED DITCH REMOVAL



REVISIONS	
NAME	DATE

ILLINOIS DEPARTMENT OF TRANSPORTATION
**EXISTING & REMOVAL
 PLAN SHEET**
 STA. 113+00 TO 128+00
 SCALE: VERT. 1" = 50'
 HORIZ. SCALE: 1" = 50'
 DATE ##DATE##
 DRAWN BY CADD
 CHECKED BY