

F.A.P. RTE.	SECTION	COUNTY	TOTAL SHEETS	SHEET NO.
310	(38-1) RS	MCDONOUGH	83	1

STATE OF ILLINOIS
DEPARTMENT OF TRANSPORTATION
DIVISION OF HIGHWAYS

PLANS FOR PROPOSED FEDERAL AID HIGHWAY

FAP 310 ROUTE (U.S. 67)
SECTION (38-1) RS
PROJECT: NHF-0310(090)
MCDONOUGH COUNTY
C-94-340-96

INDEX OF SHEETS

- 1 COVER SHEET, INDEX OF SHEETS
- 2 - 3 COMMITMENTS, GENERAL NOTES, PLAN NOTES
- 4 - 8 SUMMARY OF QUANTITIES
- 9 - 16 TYPICAL SECTIONS
- 17 - 26 SCHEDULES OF QUANTITIES
- 27 - 40 EXISTING & REMOVAL PLAN SHEETS
- 41 - 54 PROPOSED PLAN SHEETS
- 55 - 68 PAVEMENT MARKING PLAN SHEETS
- 69 EROSION CONTROL AGGREGATE DITCH CHECK
- 70 - 71 BUTT JOINTS
- 72 - 73 RURAL ENTRANCES FOR "3R" PROJECTS
- 74 RURAL SIDEROADS FOR "3R" PROJECTS
- 75 BITUMINOUS SURFACE REMOVAL (COLD MILLING)
- 76 - 77 PRECAST CONCRETE BOX CULVERTS (SPECIAL),
END SECTION (SPECIAL), & DROP BOX
END SECTIONS (SPECIAL)
- 78 PIPE CULVERT EXTENSION COLLAR (WITH END SECTION)
- 79 - 80 GUARDRAIL EROSION CONTROL TREATMENTS
- 81 PERMANENT SURVEY TIE &
PERMANENT SURVEY MARKERS
- 82 - 83 TYPICAL PAVEMENT MARKINGS

PROJECT ENGR.: Maureen Addis 309671-3454

DESIGNER: Pattie Conover 309671-3475

D-94-047-96

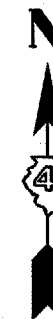
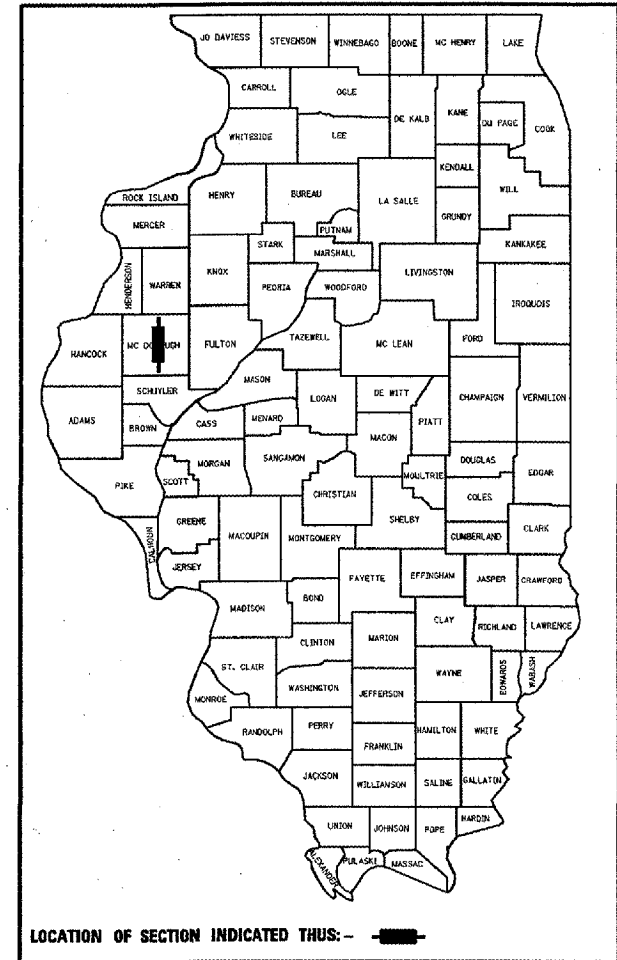

HIGHWAY STANDARDS

280001-02	701106-01
482011-01	701400-02
542101	701401-03
542201	701406-04
542301	701426-02
630001-05	702001-05
635001	780001-01
635006	781001-02
635011-01	886001
701101-01	886006

ADT 8700 (2003)
SU = 5.2%
MU = 6.3%
OTHER PRINCIPAL ATERIAL
DESIGN (POSTED) SPEED : 65 MPH
CLASS II TRUCK ROUTE

PROJECT BEGINS
STA 106+21.98

PROJECT ENDS
STA 296+70

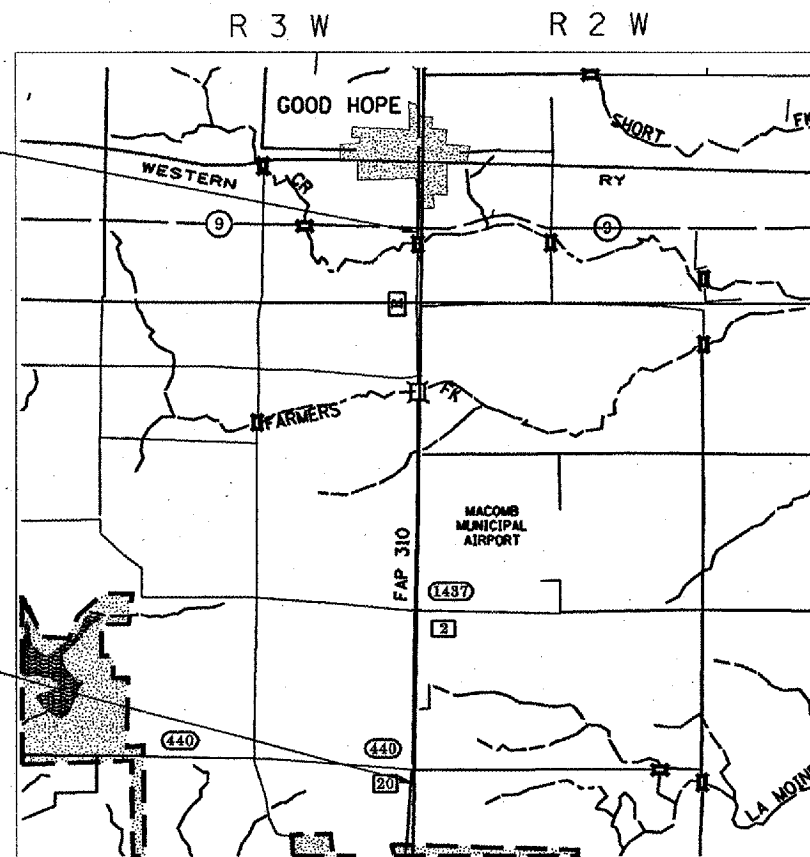

MAP NOT TO SCALE

GROSS LENGTH OF PROJECT = 3.61 MILES
NET LENGTH OF PROJECT = 3.60 MILES

MILLING, RESURFACING 4.5",
DRAINAGE IMPROVEMENTS,
EROSION CONTROL,
STRIPING

BRIDGE OMISSION
S.N. 055-0027
SB STA 153+17.98 - 154+22.56
S.N. 055-0003
NB STA 152+68.15 - 153+20.11



STATE OF ILLINOIS
DEPARTMENT OF TRANSPORTATION
DIVISION OF HIGHWAYS

SUBMITTED *May 13, 2005*

Victor Mader
DISTRICT ENGINEER

Mike Herr
ENGINEER OF DESIGN AND ENVIRONMENT

Victor Mader
DIRECTOR, DIVISION OF HIGHWAYS

SUPERPAVE PROJECT

QC/QA BITUMINOUS

PRINTED BY THE AUTHORITY
OF THE STATE OF ILLINOIS

J.U.L.I.E.
JOINT UTILITY LOCATION INFORMATION FOR EXCAVATION
1-800-892-0123

CONTRACT NO. 88757
CATALOG NO. 031501-00D