

FAS ROUTE NO	SEC	COUNTY	TOTAL SHEETS	SHEET NO
-	*	LEE	20	7

ILLINOIS PROJECT TE-D2(115)

* 01-P4000-00-BT

PI Sta = 108+87.90 N = 257.81 E = 319.97 I = 07°35'40"L CIRCULAR Da = 38°11'50" Dc = 38°56'33" T = 9.96 R = 150.00 L = 19.88 C = 19.87 E = 0.33 M = 0.33	PI Sta = 109+98.59 N = 272.35 E = 429.72 I = 05°24'00"R CIRCULAR Da = 09°52'23" Dc = 09°53'07" T = 27.37 R = 580.32 L = 54.70 C = 54.67 E = 0.64 M = 0.64	PI Sta = 110+48.92 N = 273.99 E = 480.07 I = 13°10'09"L CIRCULAR Da = 28°44'40" Dc = 29°03'17" T = 23.01 R = 199.33 L = 45.82 C = 45.71 E = 1.32 M = 1.31	PI Sta = 110+91.68 N = 285.13 E = 521.56 I = 11°23'34"R CIRCULAR Da = 28°38'52" Dc = 28°57'18" T = 19.95 R = 200.00 L = 39.77 C = 39.70 E = 0.99 M = 0.99
--	---	---	---

NOTE:
DECORATIVE LIGHT POLES, FIXTURES AND ELECTRIC CABLE SHALL BE INSTALLED BY OTHERS. CONTRACTOR SHALL VERIFY BOLT PATTERN IN LIGHT POLE FOUNDATION WITH THE PROJECT ENGINEER.

SEE SHEET 14 FOR TOP OF RETAINING WALL ELEVATIONS.

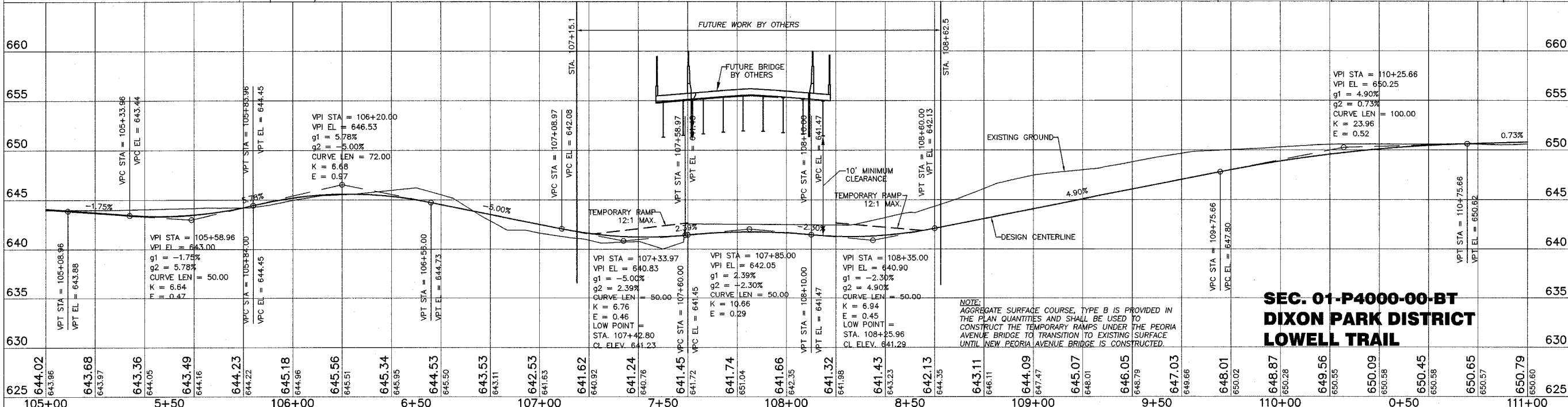
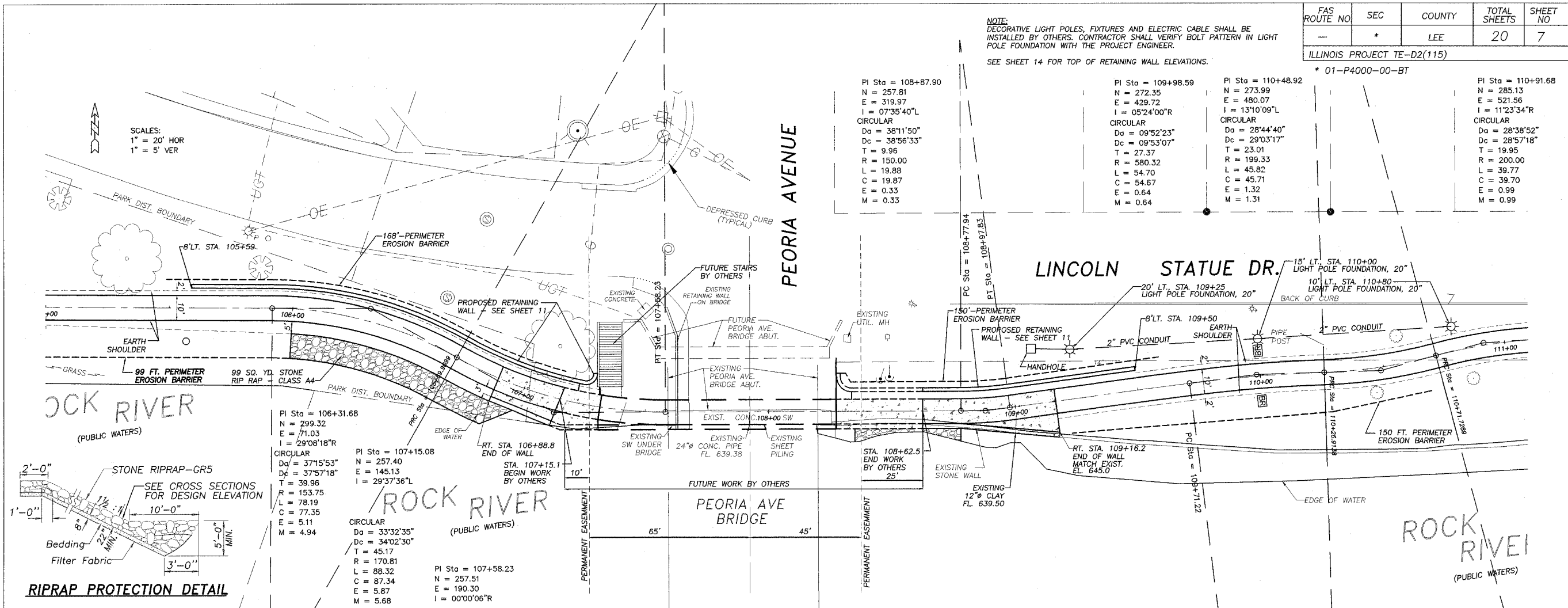

**SEC. 01-P4000-00-BT
DIXON PARK DISTRICT
LOWELL TRAIL**

DATE: 11/20/2003

WENDLER ENGINEERING SERVICES, INC.
Structural & Civil Engineers—Land Surveying—Environmental Services
Illinois Professional Design Firm No. 184-000848

1968 - 2003
35th ANNIVERSARY