

F.A.U. RTE.	SECTION	COUNTY	TOTAL SHEETS	SHEET NO.
2556	00-0070-00-FP	COOK	98	19
FED. ROAD DIST. NO. 1 ILLINOIS FED. AID PROJECT				
CONTRACT No. 83799				

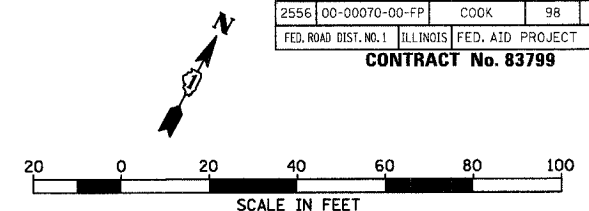

PROP. CURVE WALNUT2
 PI STA. = 18+56.47
 $\Delta = 27^\circ 45' 36''$ (RT)
 $D = 16^\circ 22' 13''$
 $R = 350.00'$
 $T = 86.49'$
 $L = 169.58'$
 $E = 10.53'$
 P.C. STA = 17+69.98
 P.T. STA = 19+39.56

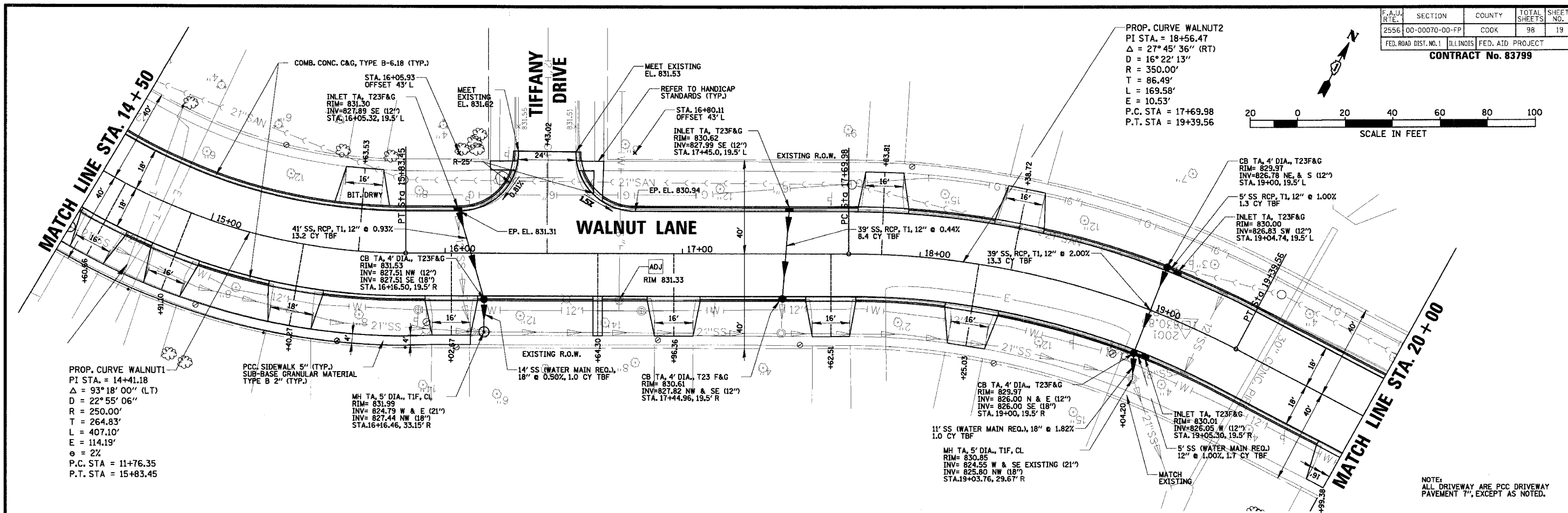

PROP. CURVE WALNUT1
 PI STA. = 14+41.18
 $\Delta = 93^\circ 18' 00''$ (LT)
 $D = 22^\circ 55' 06''$
 $R = 250.00'$
 $T = 264.83'$
 $L = 407.10'$
 $E = 114.19'$
 $\theta = 2\%$
 P.C. STA = 11+76.35
 P.T. STA = 15+83.45

NOTE:
 ALL DRIVEWAY ARE PCC DRIVEWAY
 PAVEMENT 7", EXCEPT AS NOTED.

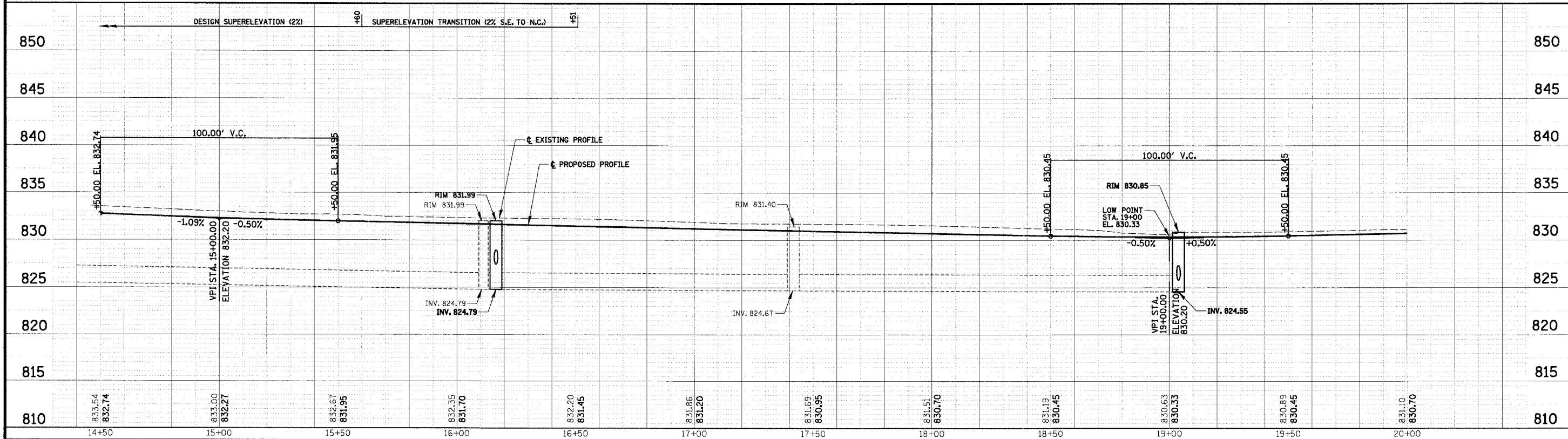

CHRISTOPHER B. BURKE ENGINEERING LTD.
 9575 West Higgins Road, Suite 600
 Rosemont, Illinois 60018
 (847) 823-0500

CLIENT: **VILLAGE OF SCHAUMBURG**
 Engineering Department
 101 Schaumburg Court
 Schaumburg, IL. 60193-7806

NO.	DATE	NATURE OF REVISION	CHKD.
1	04/05/2005	DESIGN	GS
2		DRAWING	GS
3		CHECKED	JGS
4		SCALE: 1" = 20' HOR. / 1" = 5' VERT.	
5		DATE: 04/05/2005	

WALNUT LANE PLAN AND PROFILE
 STA. 14+50 TO STA. 20+00
 C-91-108-04

PROJECT NO. 01-434
 SHEET 19 OF 98
 DRAWING NO. **19**