

ROUTE NO.	SECTION	COUNTY	TOTAL SHEETS	SHEET NO.
2722	03-00118-00-RS	COOK	34	1
ILLINOIS PROJECT M-8003 (462)				
CONTRACT NO. 83796				

STATE OF ILLINOIS
DEPARTMENT OF TRANSPORTATION
DIVISION OF HIGHWAYS
PLANS FOR PROPOSED
FEDERAL AID PROJECT
LOCAL AGENCY PAVEMENT PRESERVATION (LAPP)
FAU ROUTE 2722 (MAPLE AVENUE)
BROOKFIELD AVENUE TO 31st STREET
SECTION NO. 03-00118-00-RS
PROJECT M-8003 (462)
VILLAGE OF BROOKFIELD
COOK COUNTY
JOB NO. C-91-063-05



LOCATION OF SECTION INDICATED THUS:

TRAFFIC DATA

2005 ADT = 10,300
 POSTED SPEED LIMIT: 25 MPH

LOCATION MAP

TOWNSHIP 39 NORTH, RANGE 12 EAST, PROVISO TOWNSHIP

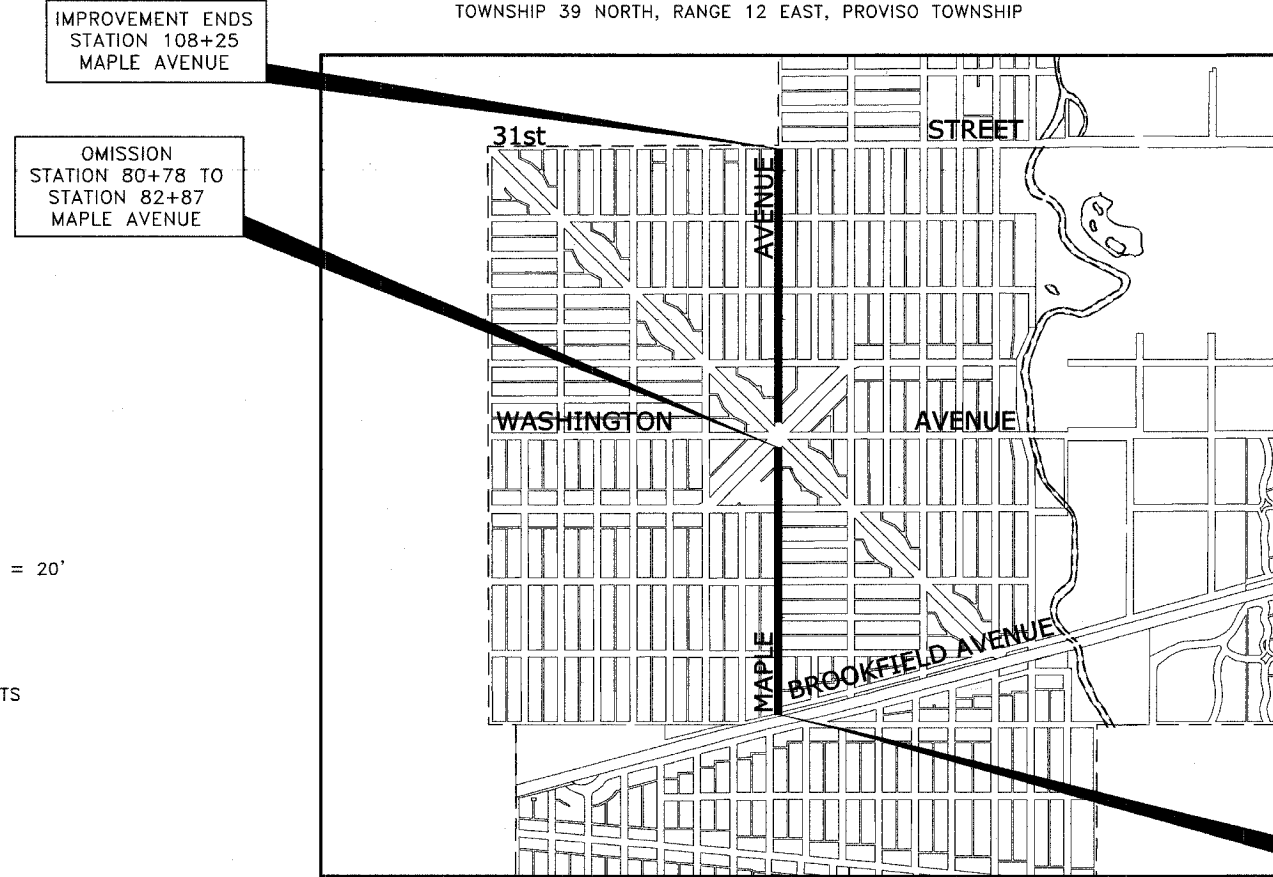

IMPROVEMENT ENDS
 STATION 108+25
 MAPLE AVENUE

OMISSION
 STATION 80+78 TO
 STATION 82+87
 MAPLE AVENUE



IMPROVEMENT BEGINS
 STATION 55+98
 MAPLE AVENUE

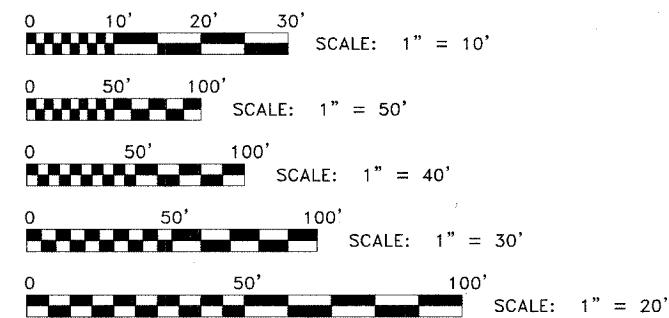

FULL SIZE PLANS HAVE BEEN PREPARED USING STANDARD ENGINEERING SCALES. REDUCED SIZED PLANS WILL NOT CONFORM TO STANDARD SCALES. IN MAKING MEASUREMENTS ON REDUCED PLANS, THE ABOVE SCALES MAY BE USED.

CONTRACT NO. **83796**

MAP SCALE : 1" = 800'

- AREA OF IMPROVEMENT

GROSS LENGTH OF IMPROVEMENT = 5,227 FT. = 0.990 MI.
 NET LENGTH OF IMPROVEMENT = 5,018 FT. = 0.950 MI.



FOR INDEX OF SHEETS SEE SHEET NO. 2

Derek S. Trichel



DATE SIGNED: 04-13-05
 LICENSE EXPIRES: 11-30-05

APPROVED: April 13, 2005
Derek S. Trichel
 LOCAL AGENCY OFFICIAL

PASSED: April 14, 2005
[Signature]
 ENGINEER OF LOCAL ROADS & STREETS

APPROVED: April 14, 2005
[Signature]
 DISTRICT ENGINEER

STATE OF ILLINOIS
 DEPARTMENT OF TRANSPORTATION

(PRINTED BY AUTHORITY OF THE STATE OF ILLINOIS)

FEDERAL AID PROGRAM ENGINEER : CHARLES RIDDLE, P.E.
 PHONE : (847) 705-4406
 FEDERAL AID DESIGN ENGINEER : EDWIN HANCOCK ENGINEERING COMPANY
 CONSULTANT : 9933 ROOSEVELT ROAD PHONE : (708)865-0300
 WESTCHESTER, ILLINOIS 60154