

F.P. NO.	SECTION	COUNTY	TOTAL SHEETS	SHEET NO.
345	00-00086-00-TL	DUPAGE	58	33
STA.	TO STA.			
FED. ROAD DISTRICT	ILLINOIS	FED. AID PROJECT		
CONTRACT NO. 83794				

INTERCONNECT SCHEMATIC LEGEND

- | | | | | |
|---|--|--|--|--|
| EXISTING INTERSECTION CONTROLLER | | PROPOSED SAMPLING (SYSTEM) PREFORMED DETECTORS | | |
| RELOCATED INTERSECTION CONTROLLER | | EXISTING FIBER OPTIC CABLE IN CONDUIT, NO. 62.5/125, MM12F SM12F | | |
| PROPOSED INTERSECTION CONTROLLER | | PROPOSED FIBER OPTIC CABLE IN CONDUIT NO. 62.5/125, MM12F SM12F | | |
| EXISTING MASTER CONTROLLER | | EXISTING INTERCONNECT CABLE - NO. 62.5/125, MM24F SM12F | | |
| PROPOSED MASTER CONTROLLER | | PROPOSED INTERCONNECT CABLE - NO. 62.5/125, MM24F SM12F | | |
| MASTER MASTER CONTROLLER | | EXISTING INTERCONNECT CABLE - NO. 18 3 PAIR TWISTED, SHIELDED | | |
| EXISTING INTERSECTION & SAMPLING (SYSTEM) DETECTORS | | PROPOSED INTERCONNECT CABLE - NO. 62.5/125, MM24F SM12F | | |
| PROPOSED INTERSECTION & SAMPLING (SYSTEM) DETECTORS | | EXISTING INTERCONNECT CABLE - NO. 18 3 PAIR TWISTED, SHIELDED | | |
| EXISTING INTERSECTION DETECTORS | | PROPOSED INTERCONNECT CABLE - NO. 18 3 PAIR TWISTED, SHIELDED | | |
| PROPOSED SAMPLING (SYSTEM) DETECTORS | | EXISTING LOOP DETECTOR CABLE - 2/C TWISTED, SHIELDED | | |
| EXISTING SAMPLING (SYSTEM) DETECTORS | | PROPOSED LOOP DETECTOR CABLE - 2/C TWISTED, SHIELDED | | |
| PROPOSED SAMPLING (SYSTEM) DETECTORS | | EXISTING ELECTRIC CABLE 1/C (AS SPECIFIED) | | |
| EXISTING SAMPLING (SYSTEM) DETECTORS | | PROPOSED ELECTRIC CABLE 1/C (AS SPECIFIED) | | |
| EXISTING SAMPLING (SYSTEM) DETECTORS | | EXISTING TELEPHONE CONNECTION | | |
| PROPOSED SAMPLING (SYSTEM) DETECTORS | | PROPOSED TELEPHONE CONNECTION | | |
| EXISTING SAMPLING (SYSTEM) DETECTORS | | | | |
| PROPOSED SAMPLING (SYSTEM) DETECTORS | | | | |
| EXISTING SAMPLING (SYSTEM) DETECTORS | | | | |
| PROPOSED SAMPLING (SYSTEM) DETECTORS | | | | |
| EXISTING SAMPLING (SYSTEM) DETECTORS | | | | |
| PROPOSED SAMPLING (SYSTEM) DETECTORS | | | | |
| EXISTING SAMPLING (SYSTEM) DETECTORS | | | | |
| PROPOSED SAMPLING (SYSTEM) DETECTORS | | | | |

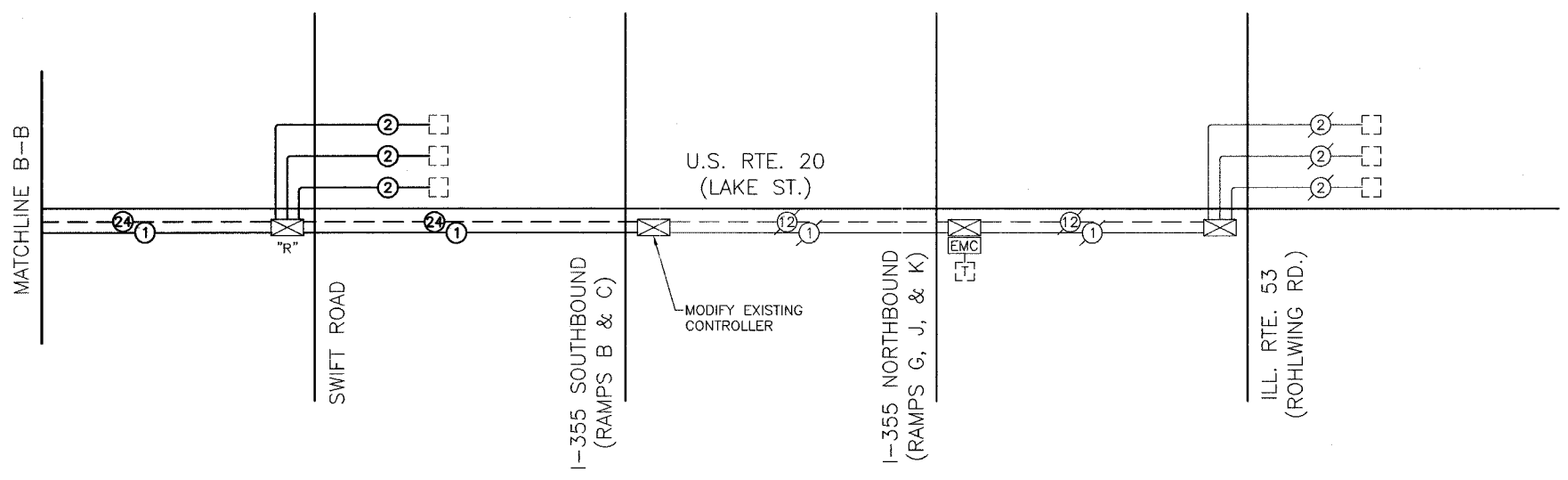
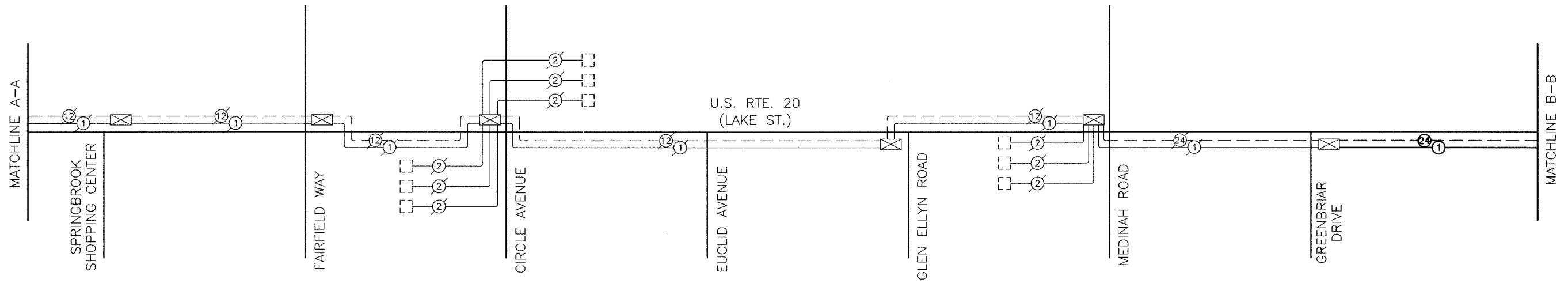
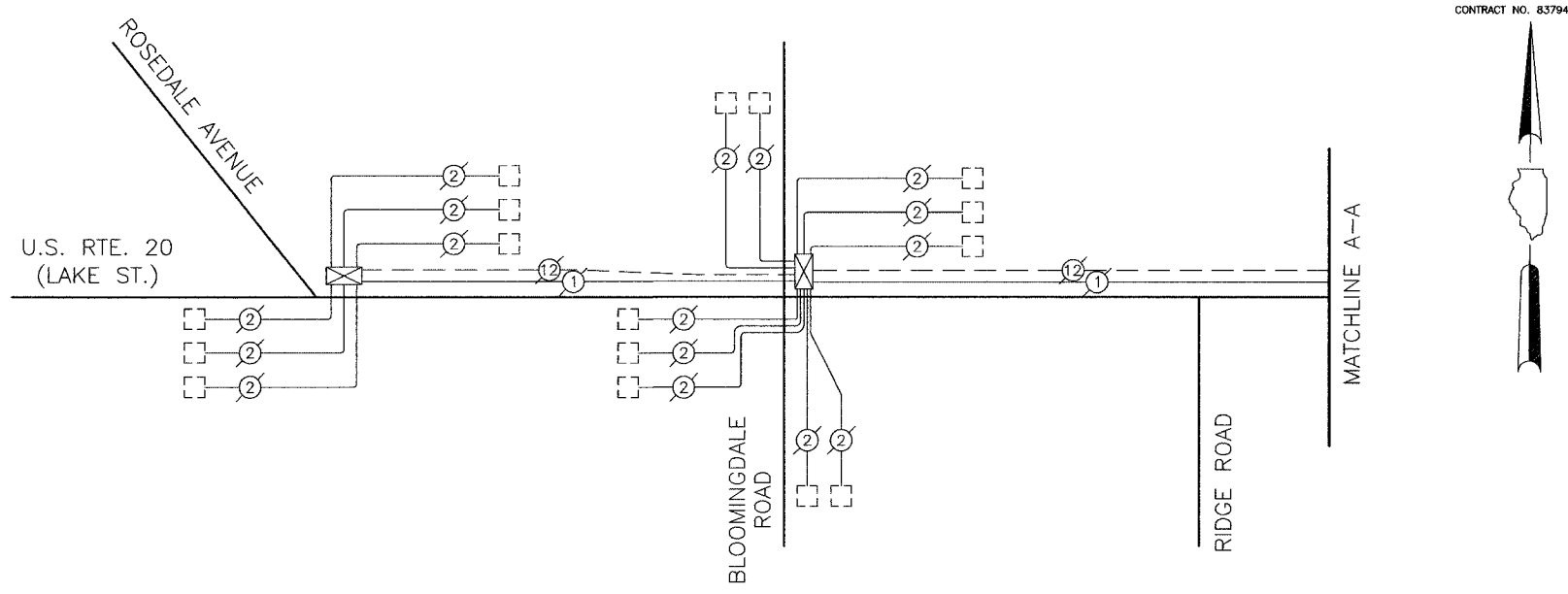

INTERCONNECT SCHEDULE OF QUANTITIES

DESCRIPTION	UNIT	QNTY.
CONDUIT IN TRENCH, 2" DIA., GALVANIZED STEEL	FOOT	738
TRENCH AND BACKFILL FOR ELECTRICAL WORK	FOOT	738
MAINTENANCE OF EXISTING TRAFFIC SIGNAL INSTALLATION	EACH	2
DRILL EXISTING HANDHOLE	EACH	2
MODIFY EXISTING CONTROLLER	EACH	1
ELECTRIC CABLE IN CONDUIT, TRACER NO. 14 1C	FOOT	2876
FIBER OPTIC CABLE IN CONDUIT, NO. 62.5/125, MM12F SM12F	FOOT	2934
RE-OPTIMIZE TRAFFIC SIGNAL SYSTEM	L SUM	1

REVISIONS	
NAME	DATE

VILLAGE OF ADDISON
INTERCONNECT SCHEMATIC
 U.S. RTE. 20 (LAKE ST.)
 ROSEDALE AVENUE TO
 ILL. RTE. 53 (ROHLWING RD.)

SCALE: NOT TO SCALE
 DATE: 4/1/2005

DRAWN BY: BRD
 DESIGNED BY: BRD
 CHECKED BY: KMM