

F.A.P.	COUNTY	SECTION	COUNTY	TOTAL
ROUTE	99-00243	00-PV	KANE	SHTS.
336	CONTRACT NO.	83782		268
CROSS SECTION STA. 360+47.5 TO STA. 361+00				
F.H.W.A. REG. 5 ILLINOIS PROJECT F-0336				

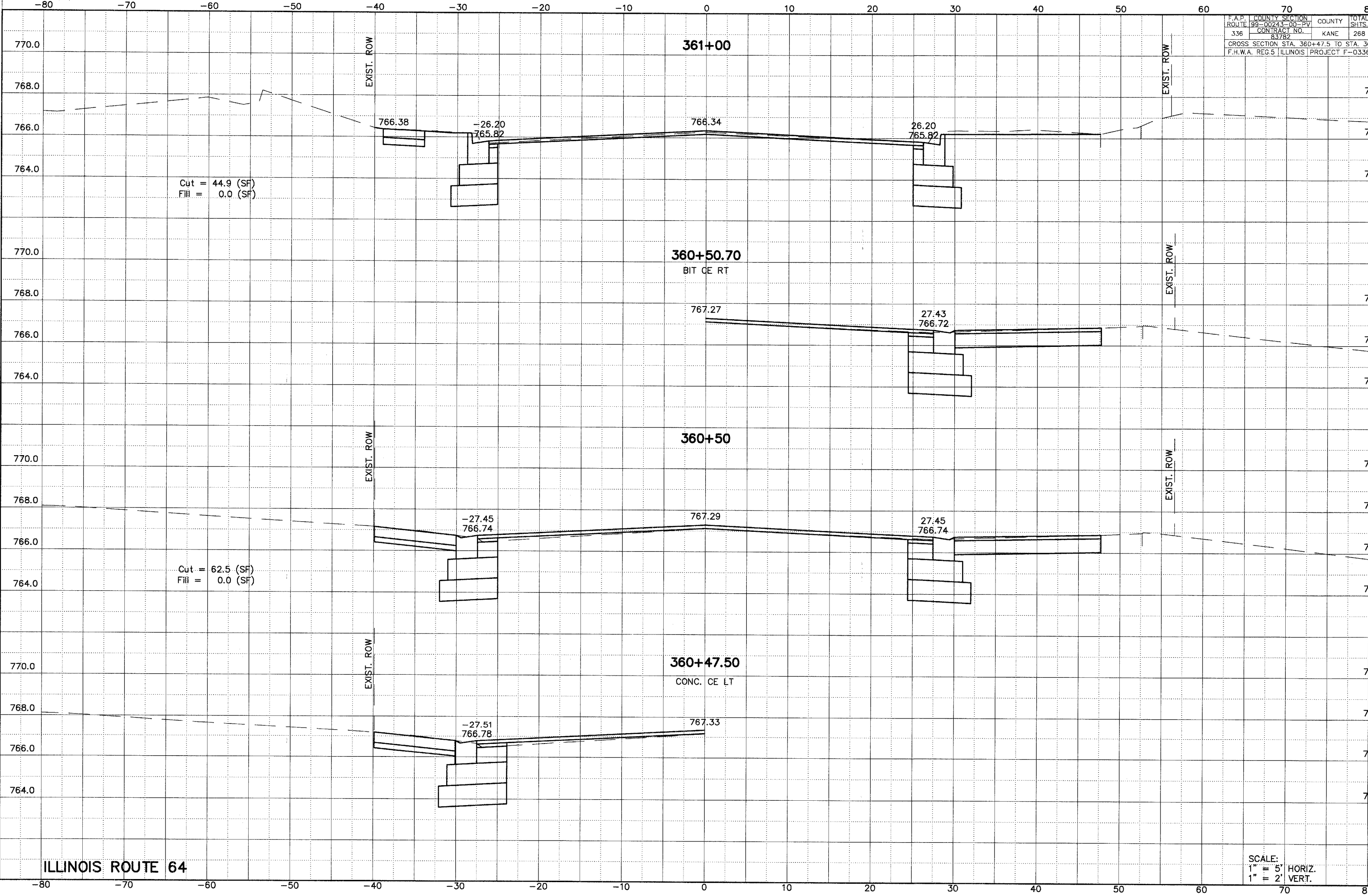

ILLINOIS ROUTE 64

SCALE:
 1" = 5' HORIZ.
 1" = 2' VERT.