

F.A.P. ROUTE	COUNTY SECTION	COUNTY	TOTAL SHTS.
336	99-00243-00-PV	KANE	268
CONTRACT NO.		PROJECT	
83782		F-0336	
CROSS SECTION STA. 358+00 TO STA. 358+00			
F.H.W.A. REG. 5 ILLINOIS PROJECT F-0336			

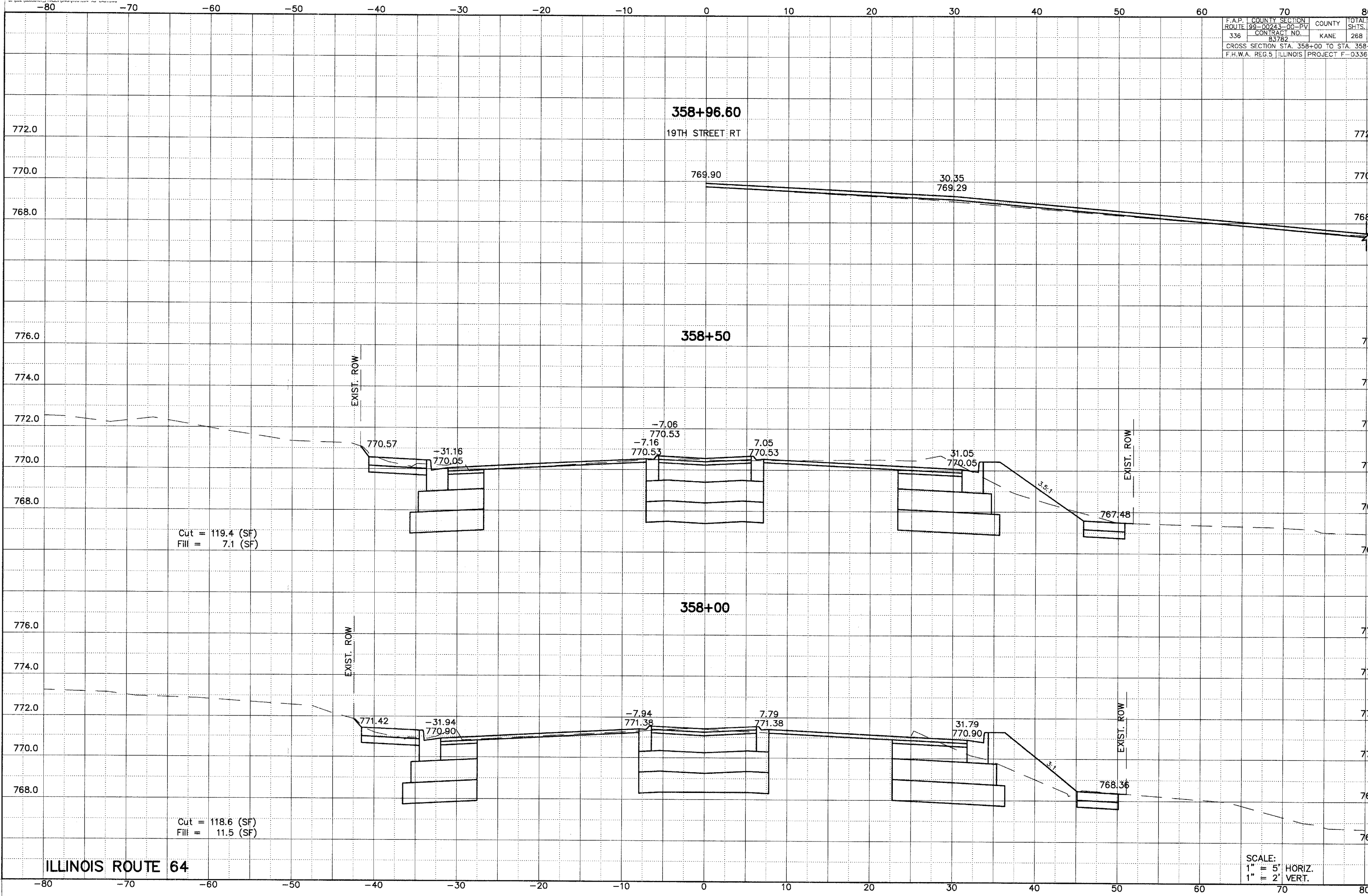

ILLINOIS ROUTE 64

SCALE:
1" = 5' HORIZ.
1" = 2' VERT.