

F.A.P. COUNTY SECTION	TOTAL SHEETS
ROUTE 99-00243-00-PV	288
CONTRACT NO. 83782	28
CROSS SECTION STA. 351+00 TO STA. 352+00	
F.H.W.A. REG.5 ILLINOIS PROJECT F-0336(00)	

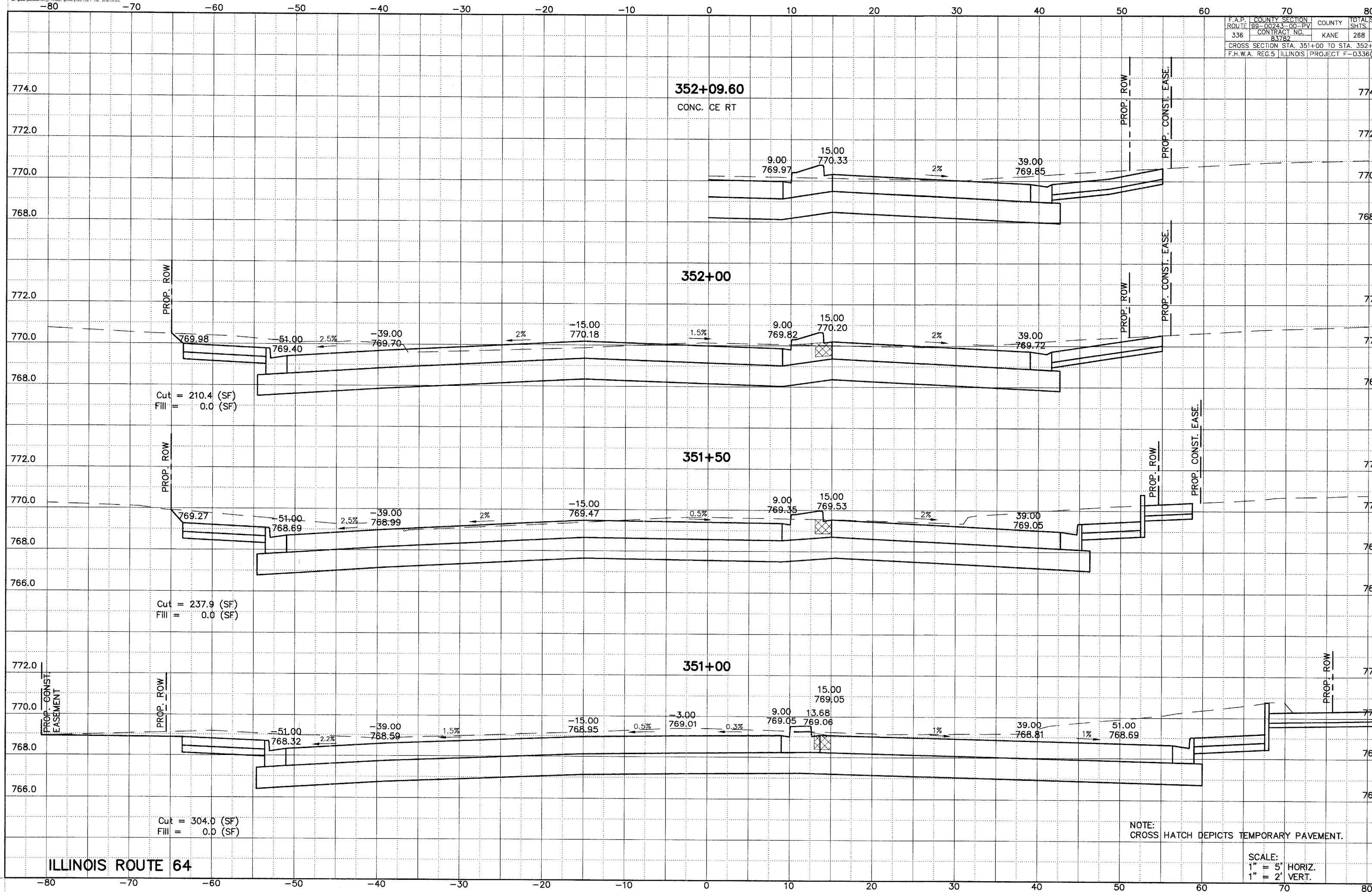

ILLINOIS ROUTE 64

NOTE: CROSS HATCH DEPICTS TEMPORARY PAVEMENT.

SCALE:
1" = 5' HORIZ.
1" = 2' VERT.