

F.A.P. ROUTE	COUNTY SECTION	COUNTY	TOTAL SHEETS
99-00243-00-PV	83782	KANE	268
CROSS SECTION STA. 346+50 TO STA. 347+50		PROJECT F-0336(0)	

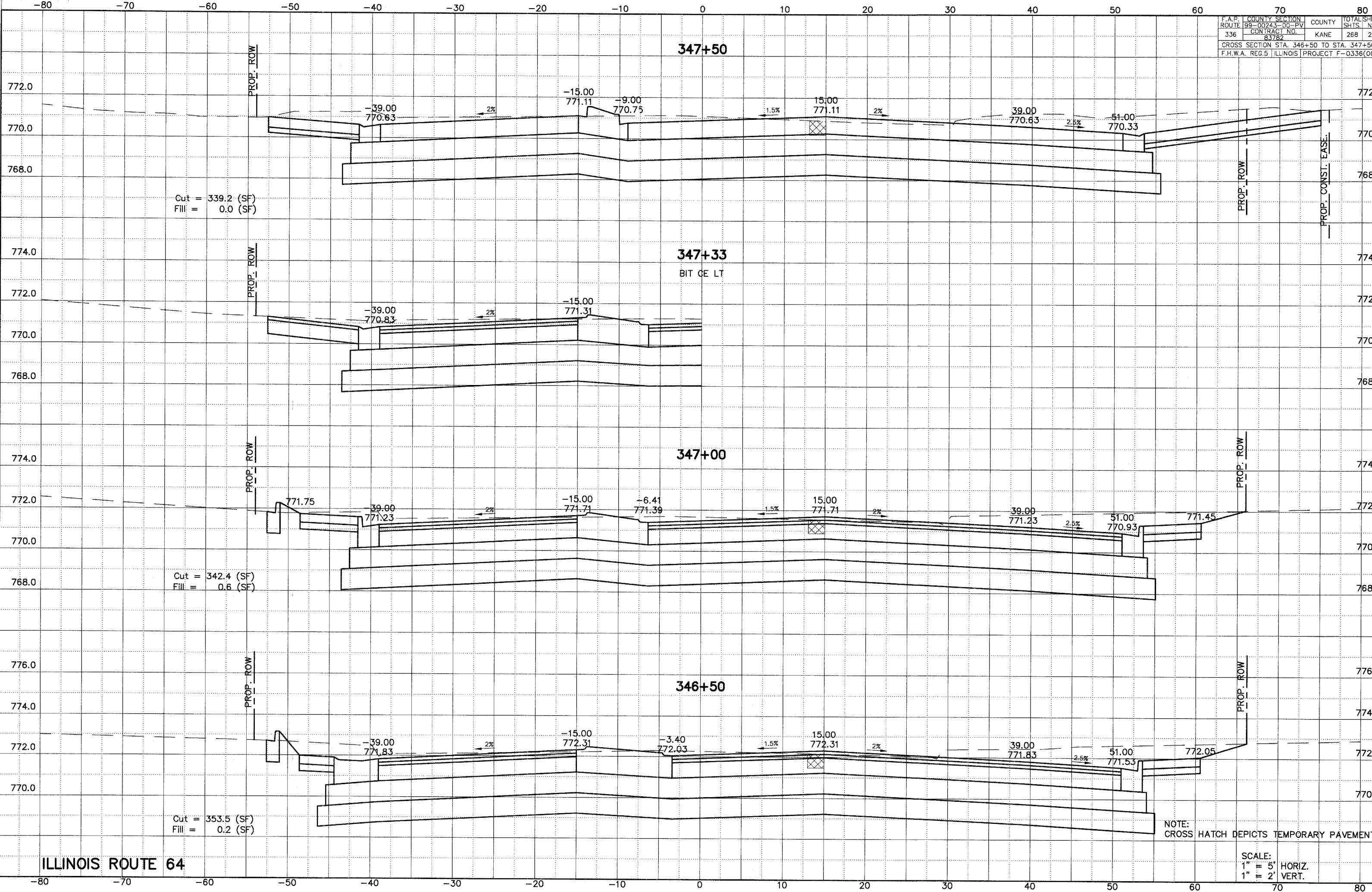

ILLINOIS ROUTE 64

NOTE: CROSS HATCH DEPICTS TEMPORARY PAVEMENT

SCALE:
 1" = 5' HORIZ.
 1" = 2' VERT.