

F.A.P.	COUNTY SECTION	COUNTY	TOTAL SHEETS
ROUTE 99-00243-00-PV		KANE	288
336	CONTRACT NO. 83782		24
CROSS SECTION STA. 339+50 TO STA. 340+50			
F.H.W.A. REG.5 ILLINOIS PROJECT F-0336(00)			

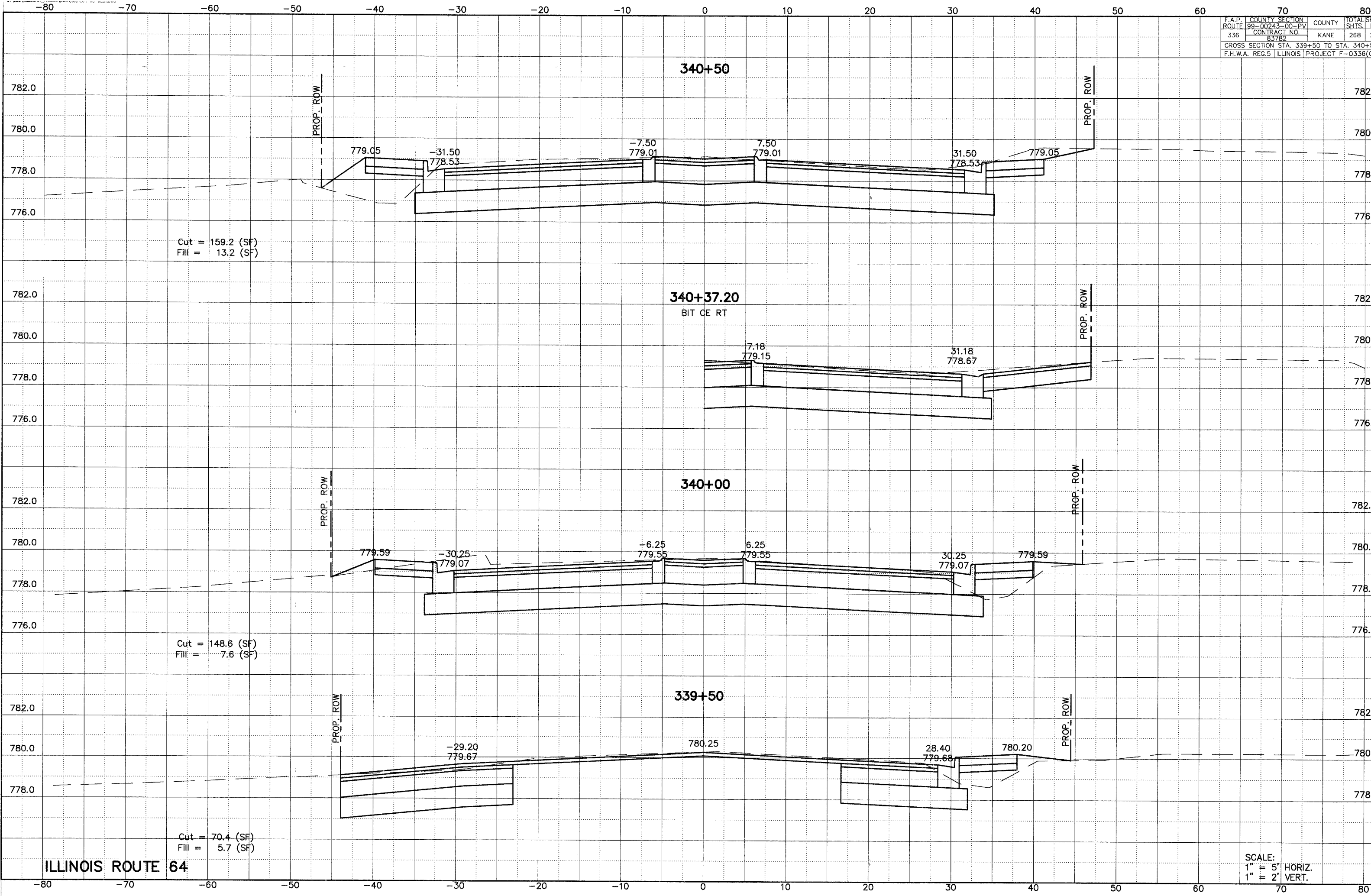

Cut = 159.2 (SF)  
Fill = 13.2 (SF)

Cut = 148.6 (SF)  
Fill = 7.6 (SF)

Cut = 70.4 (SF)  
Fill = 5.7 (SF)

ILLINOIS ROUTE 64

SCALE:  
1" = 5' HORIZ.  
1" = 2' VERT.