

F.A.P.	COUNTY SECTION	COUNTY	TOTAL SH.
ROUTE 99-00243-00-PV		KANE	268
336	CONTRACT NO.	83782	2
CROSS SECTION STA. 31+00 TO STA. 32+50			
F.H.W.A. REG. 5 ILLINOIS PROJECT F-03360			

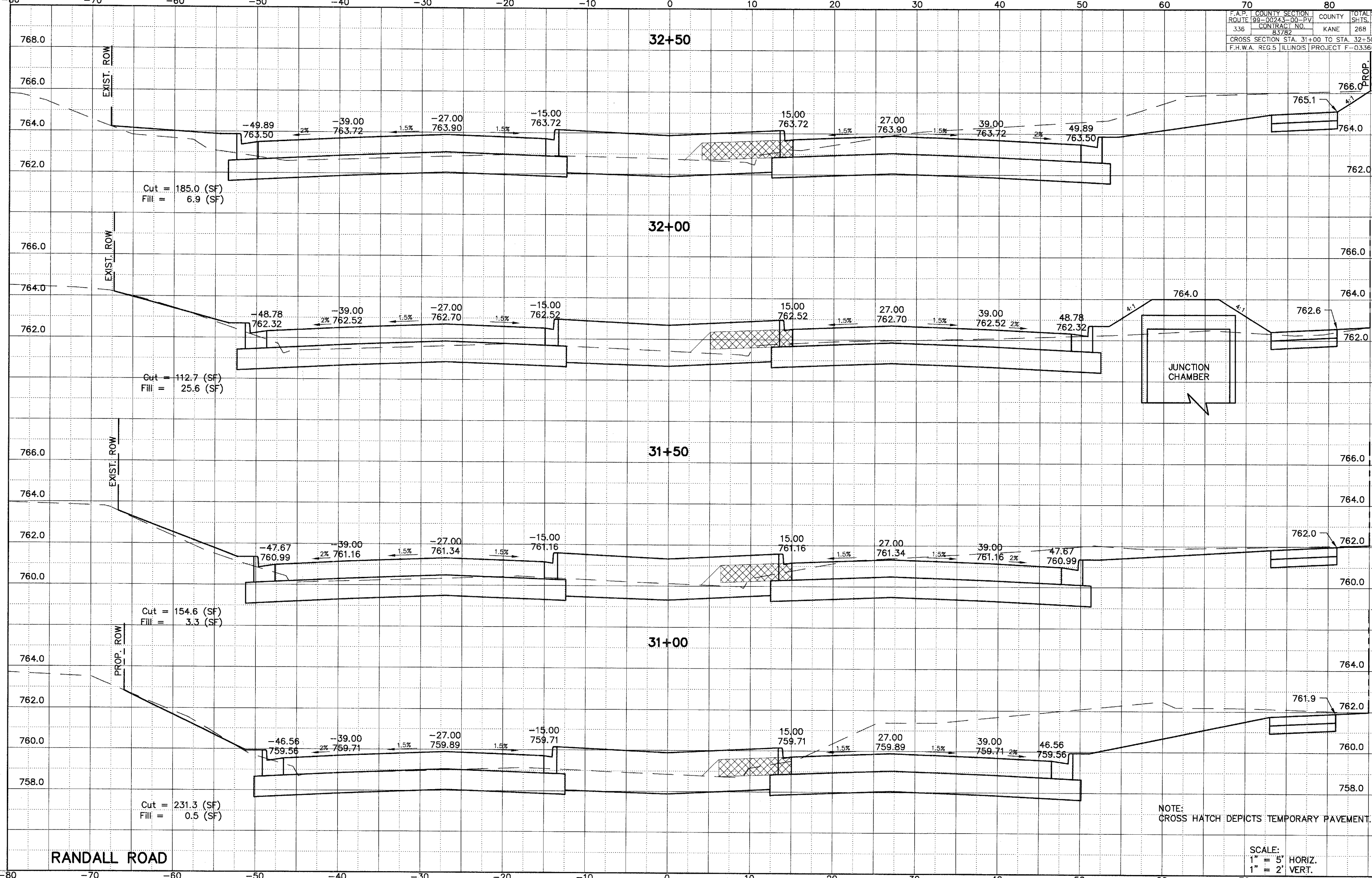

JUNCTION CHAMBER

NOTE: CROSS HATCH DEPICTS TEMPORARY PAVEMENT.

RANDALL ROAD

SCALE:
1" = 5' HORIZ.
1" = 2' VERT.