

PROPOSED TEMP. ANTENNA LOCATION FOR WIRELESS EQUIPMENT USED TO MAINTAIN EXISTING SYSTEM INTERCONNECT DURING CONSTRUCTION. (ALL COSTS INCIDENTAL TO "MAINTAIN EXISTING SYSTEM INTERCONNECT".)

FOR TEMP. SIGNAL (WIRELESS) INTERCONNECT SCHEMATIC SEE SHEET NO. TS-15.

INTERCONNECT PLAN LEGEND

EXISTING	PROPOSED	
		CONTROLLER
		HANDHOLE
		DOUBLE HANDHOLE
		HEAVY DUTY HANDHOLE
		G.S. CONDUIT IN TRENCH (T) OR PUSHED (P)
		DETECTOR LOOP
		UNIT DUCT
		SYSTEM
		INTERSECTION
		VIDEO DETECTION ZONE
		YAGI ANTENNA

F.A.P. ROUTE	COUNTY SECTION	COUNTY	TOTAL SHEETS
99-00243-00-PV		KANE	268
336	83782		13

PROPOSED SYSTEM INTERCONNECT PLAN
F.H.W.A. REG.5 ILLINOIS PROJECT F-0336/00

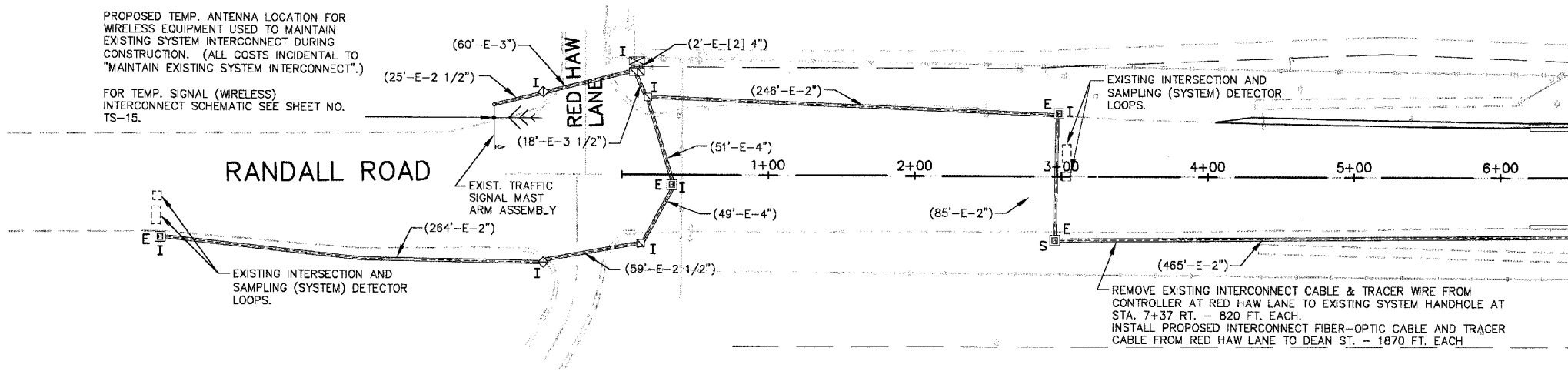

MATCH LINE STA. 6+50 SEE BELOW

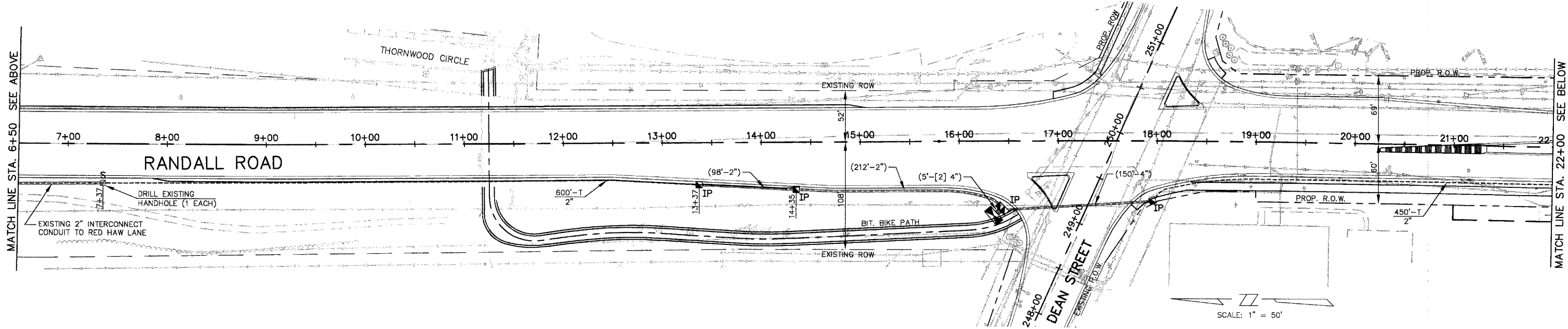

MATCH LINE STA. 6+50 SEE ABOVE

MATCH LINE STA. 22+00 SEE BELOW

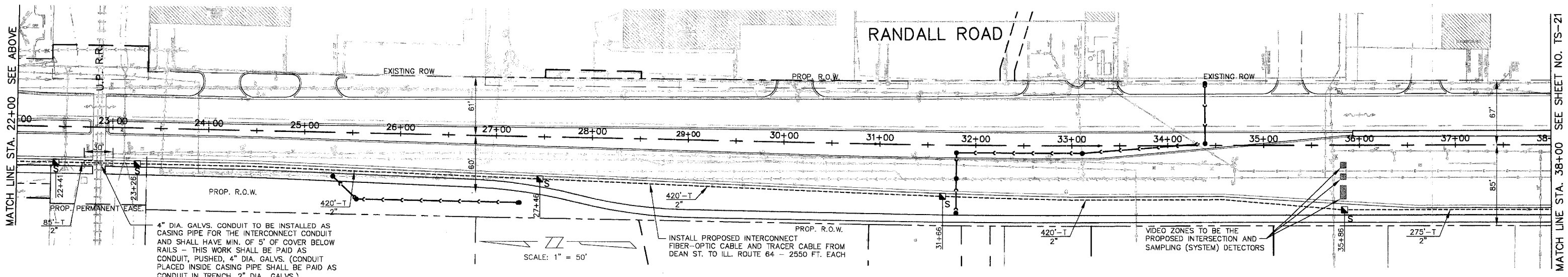

MATCH LINE STA. 22+00 SEE ABOVE

MATCH LINE STA. 38+00 SEE SHEET NO. TS-21

4" DIA. GALVS. CONDUIT TO BE INSTALLED AS CASING PIPE FOR THE INTERCONNECT CONDUIT AND SHALL HAVE MIN. OF 5' OF COVER BELOW RAILS - THIS WORK SHALL BE PAID AS CONDUIT, PUSHED, 4" DIA. GALVS. (CONDUIT PLACED INSIDE CASING PIPE SHALL BE PAID AS CONDUIT IN TRENCH, 2" DIA., GALVS.)

INSTALL PROPOSED INTERCONNECT FIBER-OPTIC CABLE AND TRACER CABLE FROM DEAN ST. TO ILL. ROUTE 64 - 2550 FT. EACH

DIVISION OF TRANSPORTATION	
PROPOSED SYSTEM INTERCONNECT PLAN (STA. 7+00 TO STA. 38+00)	
SHEET 1 OF 3	
RANDALL ROAD	
NAME	DATE
REVISIONS	

SCALE: 1" = 50'
DATE: SEPTEMBER 23, 2004

DRAWN BY: JMH
DESIGNED BY: DMH
CHECKED BY: JRL