

**RANDALL ROAD  
 C CURVE #4**

RADIUS = 20000.00'  
 ARC LENGTH = 579.00'  
 CHORD LENGTH = 578.98'  
 TANGENT LENGTH = 289.52'  
 DEGREE OF CURVE = 00'-17"-11"  
 MID ORDINATE = 2.10'  
 EXTERNAL SECANT = 2.10'  
 INCLUDED ANGLE = 01'-39"-31"  
 PC = 61+19.52  
 PT = 66+98.52

**DRAINAGE STRUCTURE TABLE STA. 56+50 TO STA. 61+50**

NO.	STA.	OFFSET	STRUCTURE TYPE/SIZE				FRAME & GRATE	RIM ELEV. EPI/FR	INVERT (N)	INVERT (S)	INVERT (E)	INVERT (W)
			MH	CB	INL	OTHER						
219	57+10	66' RT	A 7				1C	786.40	772.01	772.01	781.25	
220	57+20	45.69' LT		A 2			24	786.53			783.40	
221	57+20	59.23' RT		A 4			24	786.24		782.33	781.36	
222	58+50	66' RT	A 7				1C	788.00	772.36	772.36		
222A	58+57	32.5' RT	A 5				1C	787.28	783.12	777.83 EX SW 783.28		
223	58+52	37.33' RT		A 4			24	787.19		783.19		
224	59+50	32' RT		A 4			24	787.72	783.72			
225	58+90	66.6' RT		A 4			11V	788.10		783.75		
226	60+98	32' RT		A 2			24	788.40		785.40		

**PIPE TABLE STA. 56+50 TO STA. 61+50**

PIPE NO.	PIPE LOCATION		DESCRIPTION	DIA (IN)	L (FT)	S (%)	TRENCH BACKFILL	
	FROM STR #	TO STR #					L (FT)	VOL (CY)
S200	219	218	SS 3 RCCP CL IV	42	90	0.25	90	253.1
S201	220	221	SS 1 RCCP CL IV	12	107	1.00	107	14.1
S202	221	219	SS 2 RCCP CL IV	12	11	1.00	11	7.3
S203	222	219	SS 3 RCCP CL IV	42	140	0.25	140	391.5
S204	222A	222	SS 3 RCCP CL IV	36	34	0.50	24	84.8
S205	223	222A	SS 1 RCCP CL IV	12	7	1.00	7	0.9
S206	224	222A	SS 2 RCCP CL IV	12	93	1.00	93	12.3
S206A	225	222A	SS 1 RCCP CL IV	12	47	1.00	20	6.0
S207	226	EX	SS 1 DI CL 52	10	9	0.56		

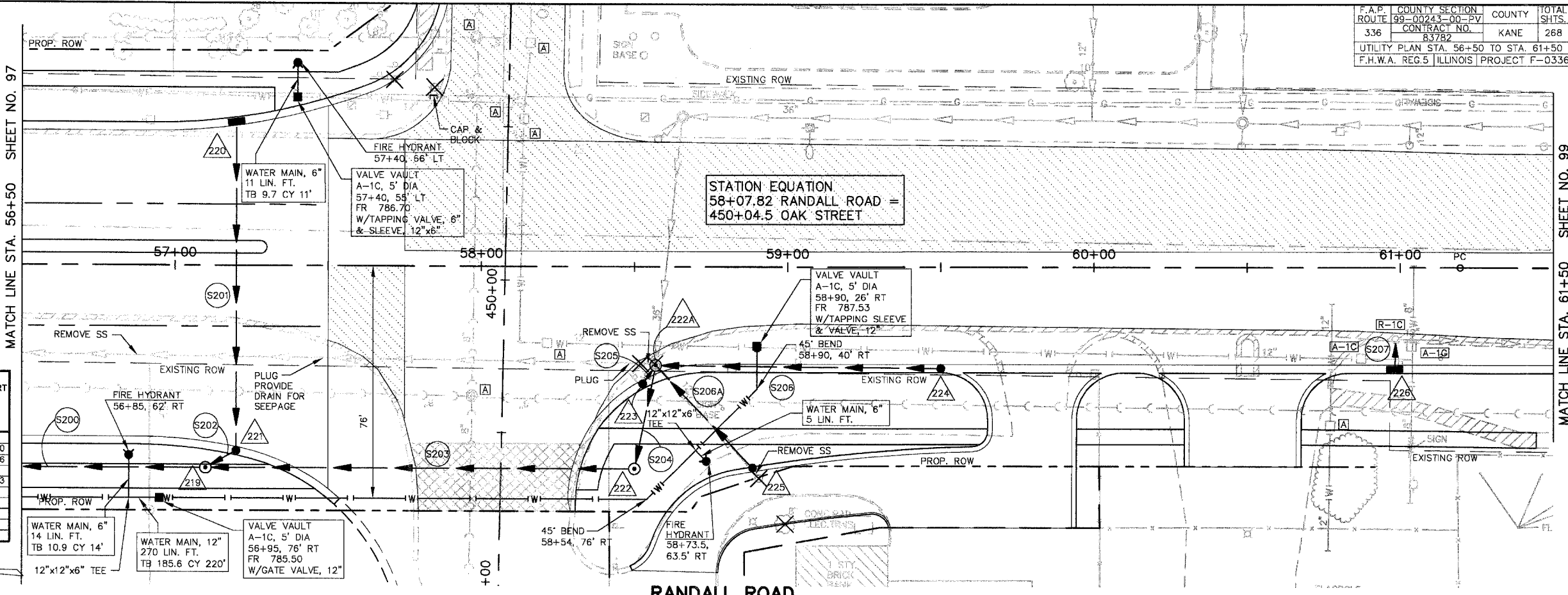

SCALE: 1" = 20'

