

KANE COUNTY CLERK'S OFFICE

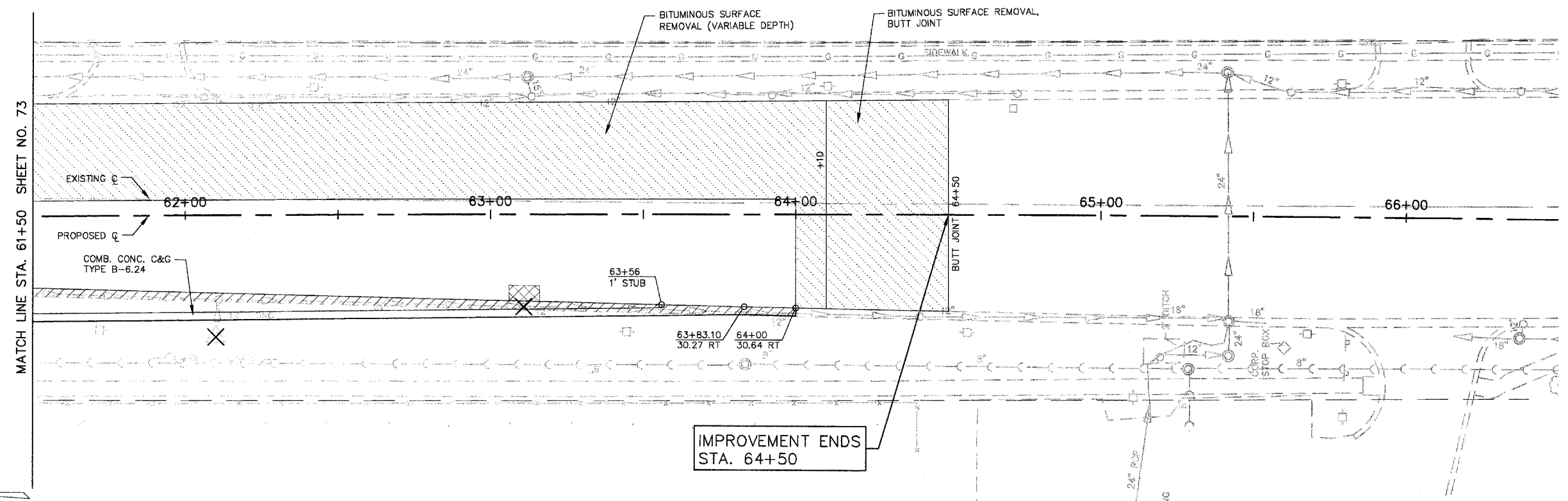

SCALE: 1" = 20'

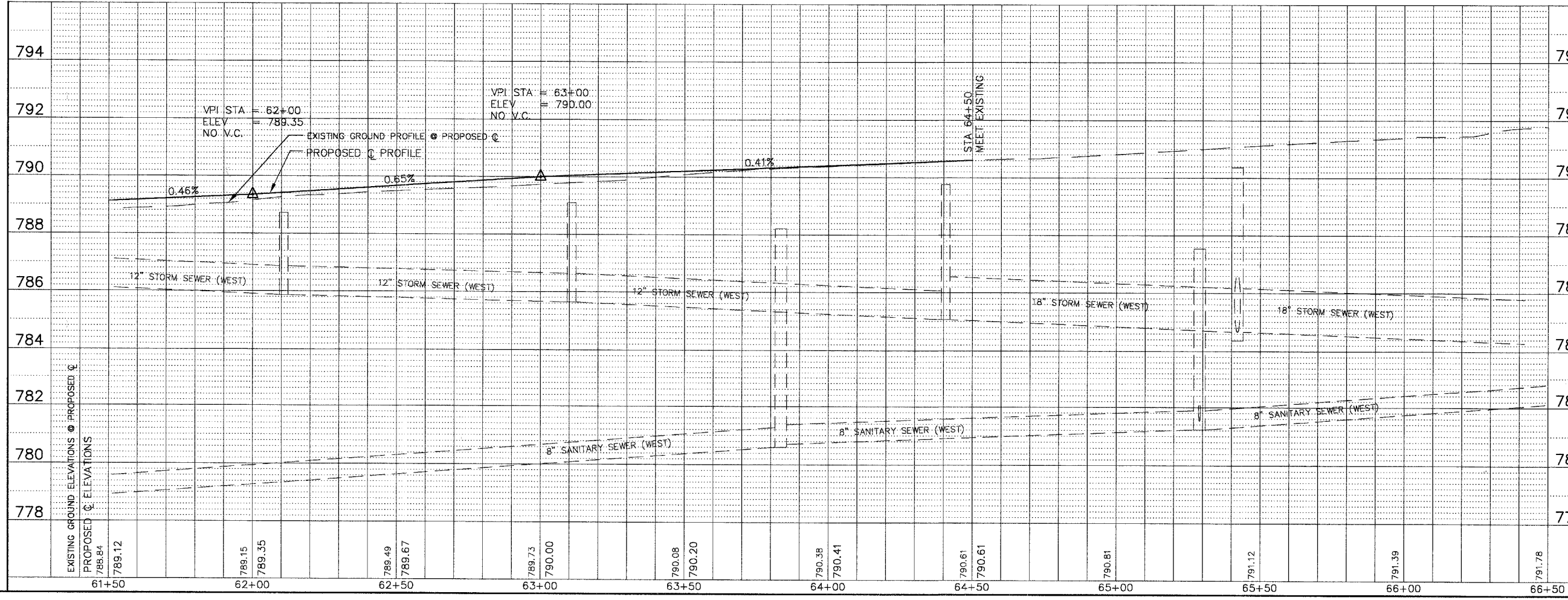

Station	Existing Ground Elevation	Proposed C Elevation
61+50	788.84	789.12
62+00	789.15	789.35
62+50	789.49	789.67
63+00	789.73	790.00
63+50	790.08	790.20
64+00	790.38	790.41
64+50	790.61	790.61
65+00	790.81	
65+50	791.12	
66+00	791.39	
66+50	791.78	