

**RANDALL ROAD
 C CURVE #3**

INCLUDED ANGLE = 00°-36'-46"
 RADIUS = 4000.00'
 TANGENT LENGTH = 21.39'
 ARC LENGTH = 42.79'
 CHORD LENGTH = 42.79'
 EXTERNAL SECANT = 0.05'
 MID ORDINATE = 0.06'
 DEGREE OF CURVE = 01°-25'-57"

PC = 45+43.70
 PT = 45+86.48

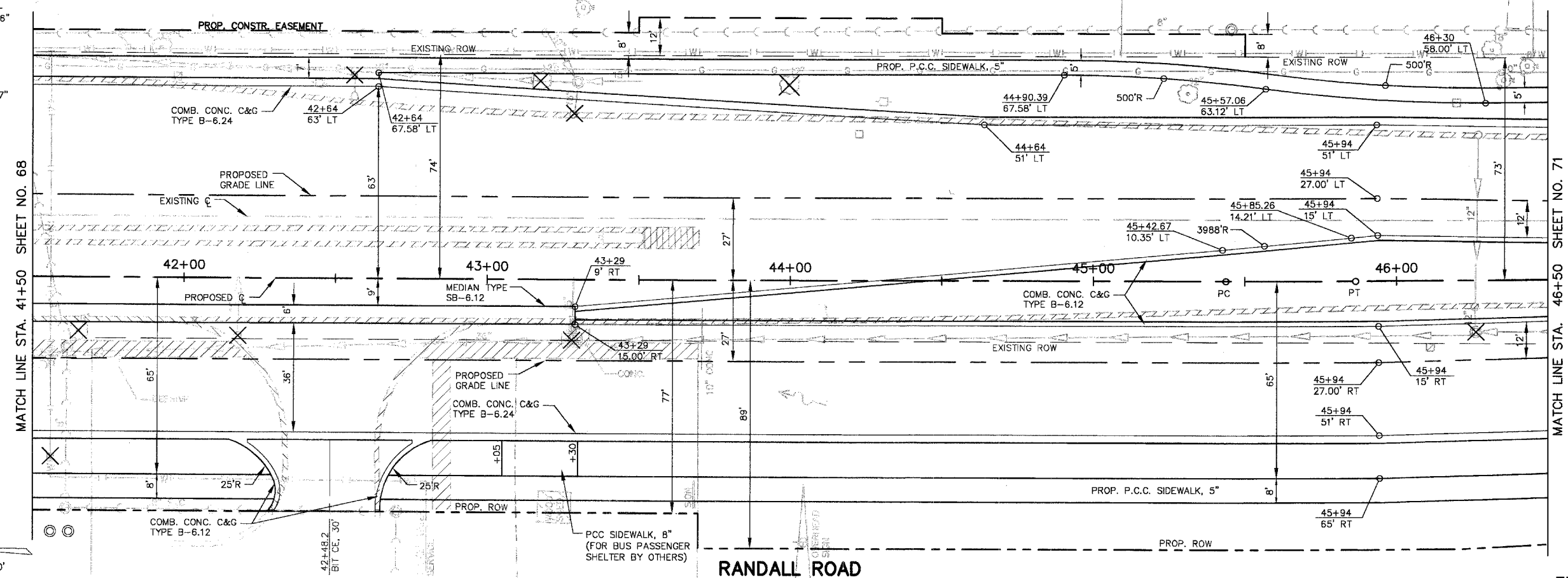

SCALE: 1" = 20'

