

F.A.P. ROUTE	COUNTY SECTION	COUNTY	TOTAL SHEETS
336	99-00243-00-PV	KANE	268
CONTRACT NO. 83782		STAGE 3 RANDALL ROAD	
F.H.W.A. REG.5 ILLINOIS PROJECT F-0336(

LEGEND

- TRAFFIC CONTROL DEVICE W/ STEADY BURN LIGHT - OR - (BARRICADE, DRUM VERTICAL PANEL)
- ▨ LIMITS OF CONSTRUCTION
- ▨ CONCRETE PAVEMENT JOINTS
- ➔ DIRECTION OF TRAFFIC MOVEMENT
- ▨ TEMPORARY PAVEMENT
- ⊥ TYPE III BARRICADE
- - - PROPOSED ROW
- - - PROP. TEMP. CONST. EASEMENT

TEMPORARY CONCRETE BARRIER
LOCATION: STA. 8+60 RT TO 13+50 RT
QUANTITY STAGE 3: 490' L.F.

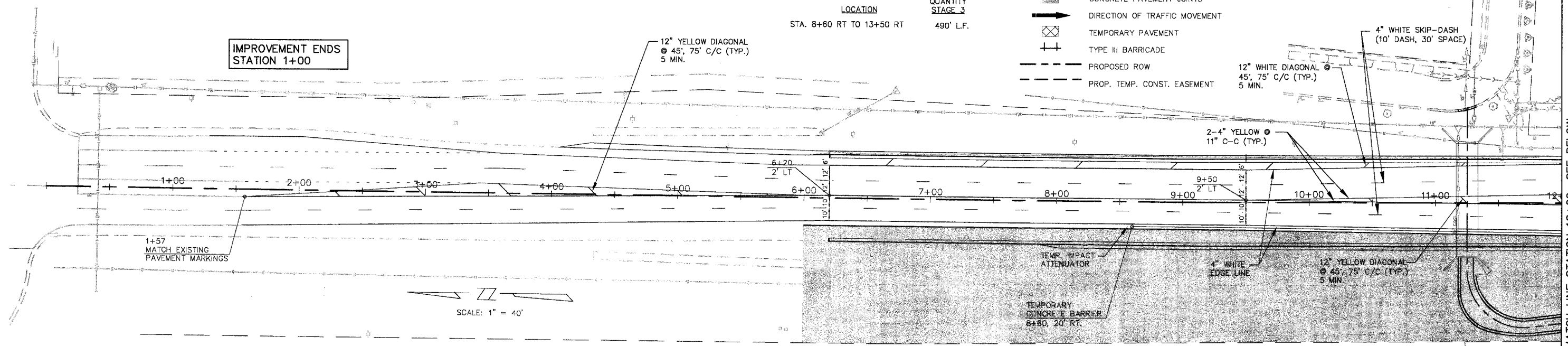

**RANDALL ROAD
STAGE 3**

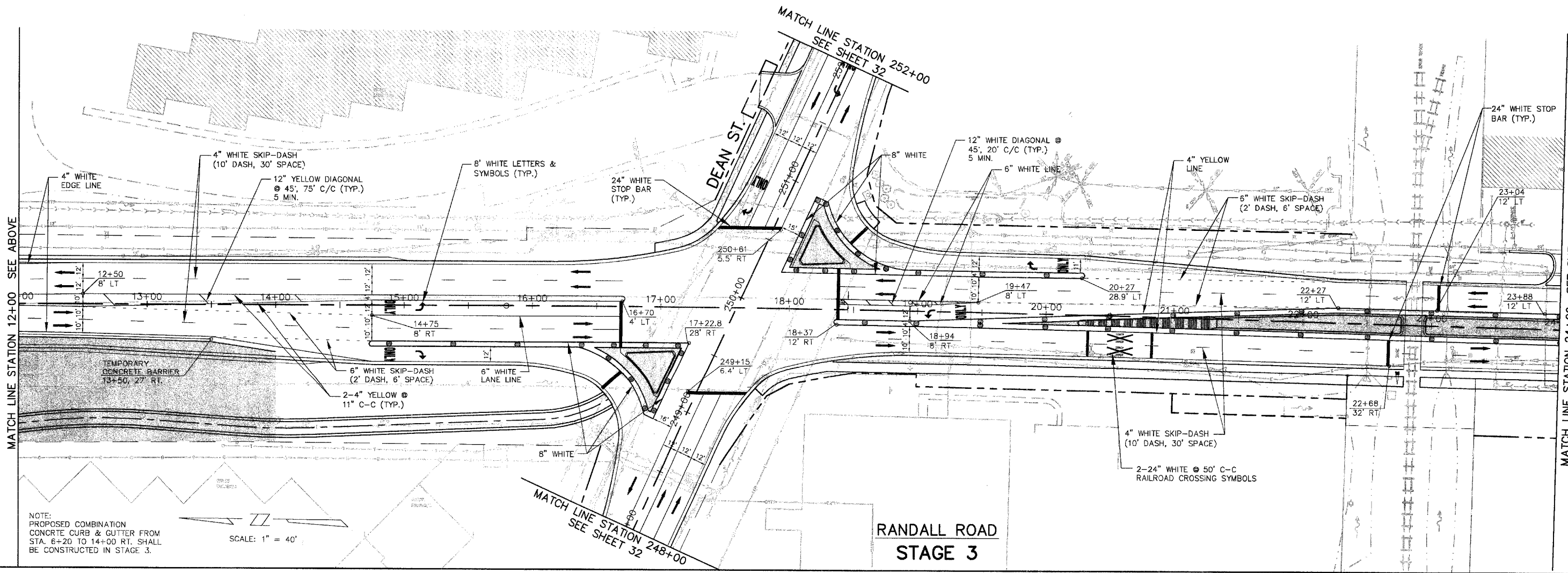

**RANDALL ROAD
STAGE 3**

NOTE:
PROPOSED COMBINATION CONCRETE CURB & GUTTER FROM STA. 6+20 TO 14+00 RT. SHALL BE CONSTRUCTED IN STAGE 3.