

F.A.U. RTE.	SECTION	COUNTY	TOTAL SHEETS	SHEET NO.
2652	00-00069-00-PV	DUPAGE	146	27
STA. 10+70.70		TO STA. 66+16.00		
FED. ROAD DIST. NO.	ILLINOIS	FED. AID PROJECT		
CONTRACT NO. 83781				

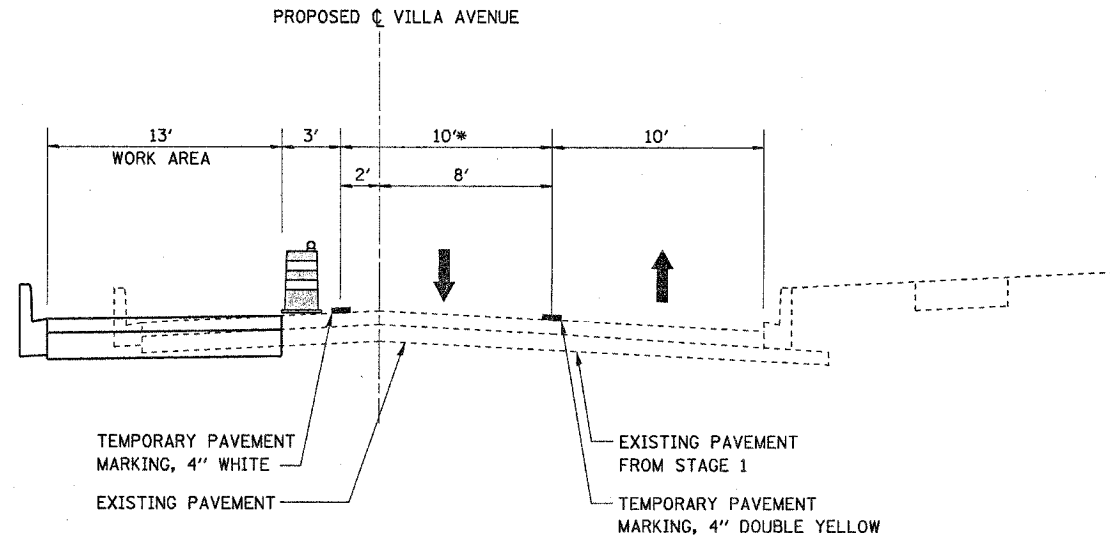

**STAGE 2: MADISON STREET TO NORTH OF MADISON STREET**

STA 63+00.00 TO STA 66+16.00

**NOTE:**

\* CENTER PAVEMENT TO BE CONSTRUCTED IN SUBSTAGES.

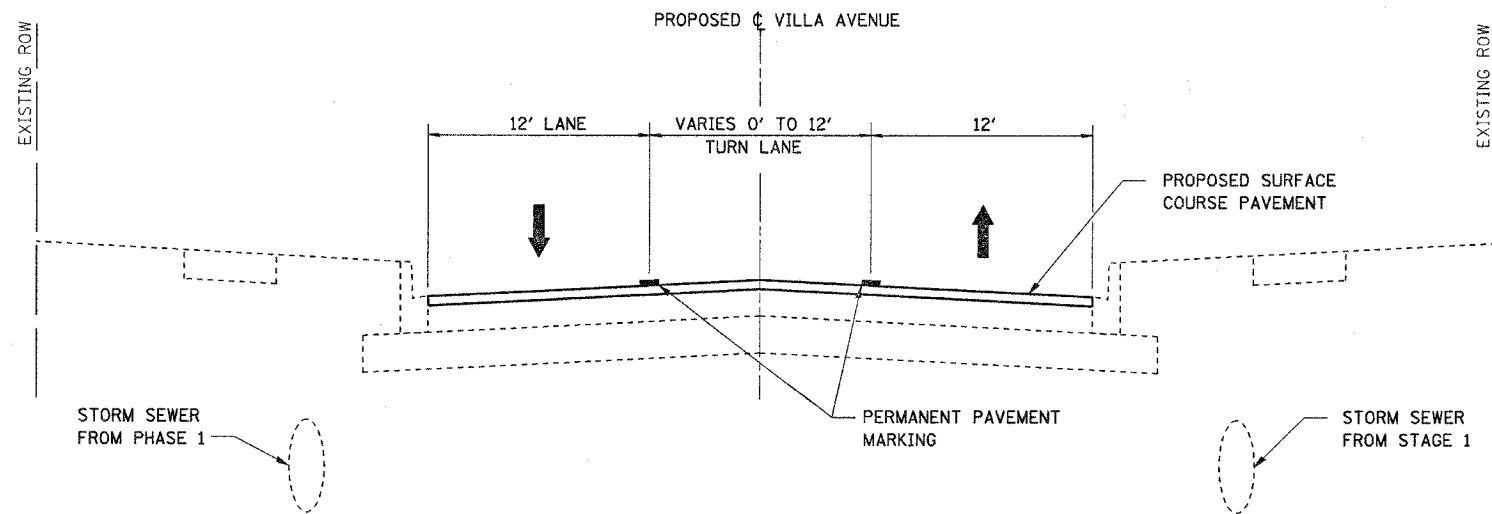

**STAGE 3: ROOSEVELT ROAD TO NORTH OF MADISON STREET**

STA 10+70.70 TO STA 66+16.00

1. COMPLETE PERMANENT LANDSCAPING AND REMOVE TEMPORARY EROSION CONTROL DEVICES.
2. PLACE SURFACE COURSE AND MAINTAIN TRAFFIC IN BOTH DIRECTIONS.
3. PLACE PERMANENT PAVEMENT MARKING AND SIGNING.



REVISIONS	
NAME	DATE

VILLAGE OF VILLA PARK, ILLINOIS  
**SUGGESTED MAINTENANCE OF TRAFFIC TYPICAL SECTIONS**  
**SOUTH VILLA AVENUE**  
**SHEET 3 OF 10**

SCALE: NONE  
 DATE: 11-NOV-2004

DRAWN BY: E.D.  
 CHECKED BY: J.T.G.

DATE	
BY	
REVISIONS	
PLANNED	
ALIGNED	
CHECKED	
NO. 1	
NO. 2	
NO. 3	
NO. 4	
NO. 5	

DATE	
BY	
REVISIONS	
PROFILING	
PLANNED	
CHECKED	
NO. 1	
NO. 2	
NO. 3	
NO. 4	
NO. 5	