

F.A.U. RTE.	SECTION	COUNTY	TOTAL SHEETS	SHEET NO.
2652	00-00069-00-PV	DUPAGE	146	21
STA. 10+70.70 TO STA. 66+16.00		ILLINOIS FED. AID PROJECT		
CONTRACT NO. 83781				

PLAN	SURVEYED	BY	DATE
NOTE BOOK NO.	ALIGNED		
	CHECKED		
	BY		
	DATE		

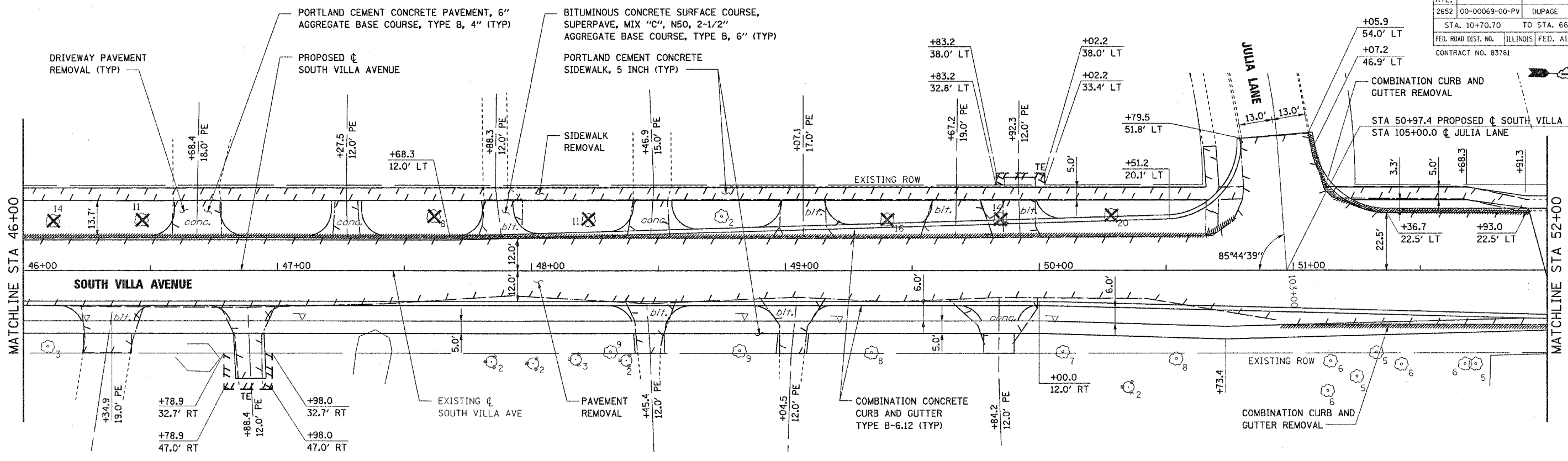

NOTE:
 ALL PROPOSED ENTRANCES TO BE REPLACED IN KIND.
 AGGREGATE ENTRANCES TO BE REPLACED WITH BITUMINOUS MATERIALS

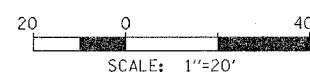

PROFILE	SURVEYED	BY	DATE
NOTE BOOK NO.	ALIGNED		
	CHECKED		
	BY		
	DATE		

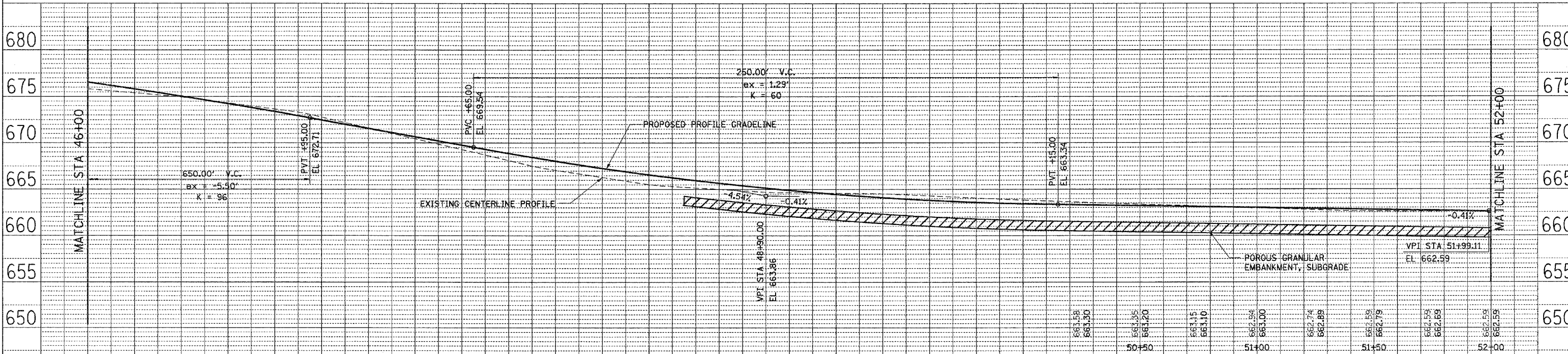

EXIST ELEV	PROP. ELEV	STATION	EXIST ELEV	PROP. ELEV	STATION	EXIST ELEV	PROP. ELEV	STATION	EXIST ELEV	PROP. ELEV	STATION	EXIST ELEV	PROP. ELEV	STATION	EXIST ELEV	PROP. ELEV	STATION	EXIST ELEV	PROP. ELEV	STATION
675.83	676.56	46+00	675.83	676.56	46+00	675.83	676.56	46+00	675.83	676.56	46+00	675.83	676.56	46+00	675.83	676.56	46+00	675.83	676.56	46+00
675.28	675.64	46+50	675.28	675.64	46+50	675.28	675.64	46+50	675.28	675.64	46+50	675.28	675.64	46+50	675.28	675.64	46+50	675.28	675.64	46+50
674.64	674.65	47+00	674.64	674.65	47+00	674.64	674.65	47+00	674.64	674.65	47+00	674.64	674.65	47+00	674.64	674.65	47+00	674.64	674.65	47+00
673.80	673.60	47+50	673.80	673.60	47+50	673.80	673.60	47+50	673.80	673.60	47+50	673.80	673.60	47+50	673.80	673.60	47+50	673.80	673.60	47+50
672.77	672.49	48+00	672.77	672.49	48+00	672.77	672.49	48+00	672.77	672.49	48+00	672.77	672.49	48+00	672.77	672.49	48+00	672.77	672.49	48+00
671.31	671.35	48+50	671.31	671.35	48+50	671.31	671.35	48+50	671.31	671.35	48+50	671.31	671.35	48+50	671.31	671.35	48+50	671.31	671.35	48+50
669.85	670.22	49+00	669.85	670.22	49+00	669.85	670.22	49+00	669.85	670.22	49+00	669.85	670.22	49+00	669.85	670.22	49+00	669.85	670.22	49+00
668.39	669.09	49+50	668.39	669.09	49+50	668.39	669.09	49+50	668.39	669.09	49+50	668.39	669.09	49+50	668.39	669.09	49+50	668.39	669.09	49+50
667.08	668.05	50+00	667.08	668.05	50+00	667.08	668.05	50+00	667.08	668.05	50+00	667.08	668.05	50+00	667.08	668.05	50+00	667.08	668.05	50+00
666.09	667.11	50+50	666.09	667.11	50+50	666.09	667.11	50+50	666.09	667.11	50+50	666.09	667.11	50+50	666.09	667.11	50+50	666.09	667.11	50+50
665.30	666.27	51+00	665.30	666.27	51+00	665.30	666.27	51+00	665.30	666.27	51+00	665.30	666.27	51+00	665.30	666.27	51+00	665.30	666.27	51+00
664.92	665.54	51+50	664.92	665.54	51+50	664.92	665.54	51+50	664.92	665.54	51+50	664.92	665.54	51+50	664.92	665.54	51+50	664.92	665.54	51+50
664.63	664.91	52+00	664.63	664.91	52+00	664.63	664.91	52+00	664.63	664.91	52+00	664.63	664.91	52+00	664.63	664.91	52+00	664.63	664.91	52+00
664.56	664.38	52+50	664.56	664.38	52+50	664.56	664.38	52+50	664.56	664.38	52+50	664.56	664.38	52+50	664.56	664.38	52+50	664.56	664.38	52+50
664.41	663.96	53+00	664.41	663.96	53+00	664.41	663.96	53+00	664.41	663.96	53+00	664.41	663.96	53+00	664.41	663.96	53+00	664.41	663.96	53+00
664.11	663.64	53+50	664.11	663.64	53+50	664.11	663.64	53+50	664.11	663.64	53+50	664.11	663.64	53+50	664.11	663.64	53+50	664.11	663.64	53+50
663.83	663.42	54+00	663.83	663.42	54+00	663.83	663.42	54+00	663.83	663.42	54+00	663.83	663.42	54+00	663.83	663.42	54+00	663.83	663.42	54+00



REVISIONS	
NAME	DATE

VILLAGE OF VILLA PARK, ILLINOIS
PLAN AND PROFILE
SOUTH VILLA AVENUE
 SHEET 7 OF 10
 STA 46+00 TO STA 52+00

SCALE: HORIZ: 1"=20'
 VERT: 1"=5'
 DATE: 11-NOV-2004

DRAWN BY: E.D.
 CHECKED BY: J.T.G.