

F.A. RTE.	SECTION	COUNTY	TOTAL SHEETS	SHEET NO.
1622	03-00066-01-RP	COOK	11	1

CONTRACT NUMBER: 83778

FOR INDEX OF SHEETS, SEE SHEET NO. 2
 FOR HIGHWAY STANDARDS, SEE SHEET NO. 2

STATE OF ILLINOIS
DEPARTMENT OF TRANSPORTATION
DIVISION OF HIGHWAYS
PLANS FOR PROPOSED
F.A.U. ROUTE 1622 (183RD STREET)
FEDERAL AID PROJECT
FROM CRAWFORD AVENUE (FAU 3778) TO KEDZIE AVENUE (FAU 2831)
PROJECT: M-8003(454)
SECTION: 03-00066-01-RP
JOB NO.: C-91-013-05
CONCRETE PAVEMENT PATCHING - EASTBOUND LANES
VILLAGE OF HAZEL CREST, ILLINOIS
COOK COUNTY



TRAFFIC DATA
 183RD STREET
 POSTED SPEED: 35 M.P.H.
 DESIGN SPEED: 35 M.P.H.
 2004 ADT: 9,202

PROJECT:
 LOCATION: 183RD STREET
 BEGIN CONSTRUCTION STA 18+32

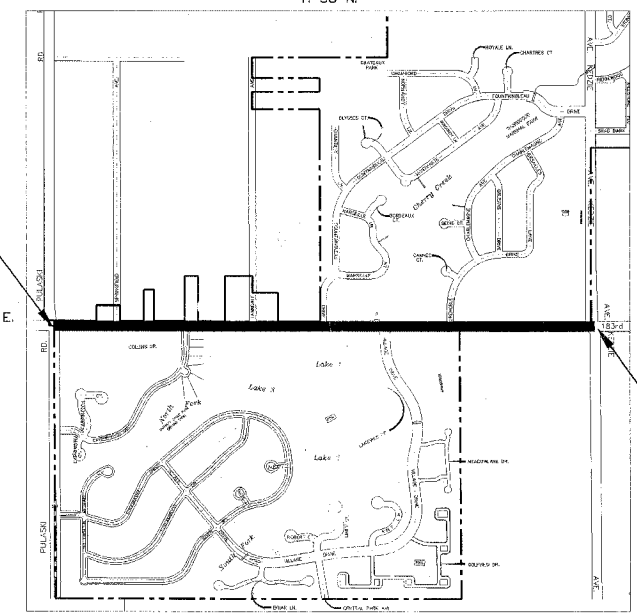

LOCATION MAP
 GROSS AND NET LENGTH OF PROJECT = 5238 L.F. OR .99 MILES



BAXTER & WOODMAN, INC.
 STATE OF ILLINOIS - PROFESSIONAL DESIGN FIRM
 LICENSE NO. - 184-001121 - EXPIRES 4/30/2005

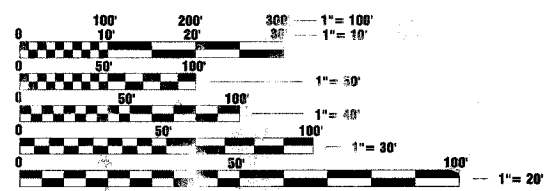

FULL SIZE PLANS HAVE BEEN PREPARED USING STANDARD ENGINEERING SCALES. REDUCED SIZED PLANS WILL NOT CONFORM TO STANDARD SCALES. IN MAKING MEASUREMENTS ON REDUCED PLANS, THE ABOVE SCALES MAY BE USED.

J.U.L.I.E.
 JOINT UTILITY LOCATION INFORMATION FOR EXCAVATION
 1-800-892-0123

Louis D. Hausman 12/2/04
 LICENSE EXPIRES 11-30-05
 PROJECT MANAGER
Melvin C. Uebloch
 PROJECT ENGINEER

STATE OF ILLINOIS
DEPARTMENT OF TRANSPORTATION
DIVISION OF HIGHWAYS

SUBMITTED 20

William DeFranko
 LOCAL AGENCY REPRESENTATIVE

February 24, 20 05
Robert Riedel
 LOCAL ROADS ENGINEER

February 24, 20 05
Diana O'Keefe/AP
 DISTRICT ENGINEER

PRINTED BY THE AUTHORITY
OF THE STATE OF ILLINOIS

CONTRACT NO. 83778

Burlington, Wisconsin 262.763.7834
 Crystal Lake, Illinois 815.459.1260
 El Kalb, Illinois 315.787.3111
 Mokena, Illinois 708.478.2090
 Grayslake, Illinois 847.223.5088

PROJECT NO.: 040631 DATE: 02-22-05

(OFFICE WHICH PREPARED PLANS)

FEDERAL AID DESIGN ENGINEER: CHAD RIDDLE (847) 705-4406 SCHAUMBURG, IL
 COPYRIGHT © 2004 BY BAXTER & WOODMAN, INC. ALL RIGHTS RESERVED. NO PART OF THESE DRAWINGS MAY BE REPRODUCED, OR OTHERWISE REVISED WITHOUT WRITTEN PERMISSION OF BAXTER & WOODMAN, INC.

INDEX	
TITLE	SHEET NO.
COVER SHEET	1
INDEX OF SHEETS	2
GENERAL NOTES	2
SUMMARY OF QUANTITIES	2
HIGHWAY STANDARDS	2
SCHEDULE OF MATERIALS	3
TYPICAL SECTIONS	4
ABBREVIATIONS	4
LEGEND	4
GEOMETRIC PLAN	5 - 6
DISTRICT 1 TRAFFIC CONTROL AND PROTECTION	7 - 8
DISTRICT 1 TYPICAL APPLICATION RAISED REFLECTIVE PAVEMENT MARKERS	9
DISTRICT 1 TYPICAL PAVEMENT MARKINGS	10
DISTRICT 1 CURB AND GUTTER REMOVAL AND REPLACEMENT	11

SUMMARY OF QUANTITIES					
CODE NUMBER	PAY ITEM	UNIT	TOTAL QUANTITY	CONSTRUCTION TYPE CODE	
				J000	Y031-1F
20201550	SUB-BASE GRANULAR MATERIAL, TYPE B	CU YD	2	2	
44200970	CLASS B PATCHES, TYPE II, 10"	SQ YD	1331	1331	
44200974	CLASS B PATCHES, TYPE III, 10"	SQ YD	117	117	
44200976	CLASS B PATCHES, TYPE IV, 10"	SQ YD	152	152	
44201294	CLASS B PATCH - EXPANSION JOINT	FOOT	77	77	
44213100	PAVEMENT FABRIC	SQ YD	269	269	
60255500	MANHOLES TO BE ADJUSTED	EACH	1	1	
60266600	VALVE BOXES TO BE ADJUSTED	EACH	1	1	
60300105	FRAMES AND GRATES TO BE ADJUSTED	EACH	8	8	
67100100	MOBILIZATION	LSUM	1	1	
70102625	TRAFFIC CONTROL AND PROTECTION, STANDARD 701606	LSUM	1	1	
70102635	TRAFFIC CONTROL AND PROTECTION, STANDARD 701701	LSUM	1	1	
70102640	TRAFFIC CONTROL AND PROTECTION, STANDARD 701801	LSUM	1	1	
78001110	PAINT PAVEMENT MARKING LINE - 4"	FOOT	1129	1129	
78100100	RAISED REFLECTIVE PAVEMENT MARKERS	EACH	6	6	
**88600600	DETECTOR LOOP REPLACEMENT	FOOT	110		110
XX003560	CURB AND GUTTER REMOVAL AND REPLACEMENT	FOOT	535	535	

** DENOTES SPECIALTY ITEM

GENERAL NOTES

- ALL PROPOSED WORK SHALL BE DONE IN ACCORDANCE WITH THE ILLINOIS DEPARTMENT OF TRANSPORTATION STANDARD SPECIFICATIONS FOR ROAD AND BRIDGE CONSTRUCTION, ADOPTED JANUARY 1, 2002 AND SUPPLEMENTAL SPECIFICATIONS THERETO CURRENTLY IN EFFECT.
- THE CONTRACTOR SHALL PROTECT AND CAREFULLY PRESERVE ALL SECTION OR SUBSECTION MONUMENTS OR PROPERTY OR REFERENCE MARKERS UNTIL THE OWNER, HIS AGENT OR AN AUTHORIZED SURVEYOR HAS WITNESSED OR OTHERWISE REFERENCED THEIR LOCATIONS.
- THE CONTRACTOR SHALL BE RESPONSIBLE FOR CONTACTING THE OWNERS OF ALL EXISTING UTILITIES SO THAT THE UTILITIES AND THEIR APPURTENANCES MAY BE LOCATED AND ADJUSTED OR MOVED, IF NECESSARY, PRIOR TO THE START OF CONSTRUCTION OPERATIONS. THE CONTRACTOR SHALL COOPERATE WITH ALL UTILITY OWNERS AS PROVIDED IN THE STANDARD SPECIFICATIONS. UTILITY LOCATIONS ARE APPROXIMATE. THE CONTRACTOR SHALL USE CAUTION WHERE THERE ARE POTENTIAL CONFLICTS. PRIOR TO THE CONSTRUCTION OF THE STORM SEWER, THE CONTRACTOR SHALL NOTIFY THE VILLAGE TO LOCATED EXISTING WATER MAIN, WATER SERVICES, SANITARY SEWER, AND SANITARY SEWER SERVICES WHERE THE PROPOSED STORM SEWER WILL CROSS.
- THE CONTRACTOR SHALL BE RESPONSIBLE FOR THE PROTECTION OF ALL UNDERGROUND OR SURFACE UTILITIES EVEN THOUGH THEY MAY NOT BE SHOWN ON THE PLANS. ANY UTILITY THAT IS DAMAGED DURING CONSTRUCTION SHALL BE REPAIRED TO THE SATISFACTION OF THE ENGINEER OR THE OWNER OR REPLACED. THIS WORK SHALL BE AT THE CONTRACTOR'S EXPENSE.
- ALL AGGREGATE USED ON THIS PROJECT SHALL BE CRUSHED MATERIAL.
- ALL SAW CUTTING SHALL BE INCLUDED IN THE COST OF THE ITEM BEING REMOVED.
- THE CONTRACTOR SHALL MAINTAIN POSITIVE DRAINAGE TO STRUCTURES AT ALL TIMES WHILE MAINTAINING EROSION AND SEDIMENTATION CONTROL.
- DURING CONSTRUCTION STAGING OPERATIONS, THE HAZEL CREST POLICE AND FIRE DEPARTMENTS SHALL BE NOTIFIED IN WRITING 48 HOURS PRIOR TO LANE CLOSURES. EMERGENCY ACCESS SHALL BE ALLOWED AT ALL TIMES.
- THE CONTRACTOR SHALL REPLACE ALL STREET SIGNS REMOVED DURING CONSTRUCTION AS NEAR AS POSSIBLE TO THEIR ORIGINAL LOCATION OR AS DETERMINED BY THE ENGINEER. THIS WORK SHALL BE CONSIDERED INCIDENTAL TO THE CONTRACT.
- BARRICADES: THE CONTRACTOR SHALL PROVIDE AND INSTALL TWO (2) WEIGHTED SAND BAGS ON EACH TYPE I OR TYPE II BARRICADE USED-ONE (1) WEIGHTED SAND BAG ACROSS EACH BOTTOM RAIL.
- ANY MAILBOXES IN CONFLICT WITH THE PROPOSED CONSTRUCTION SHALL BE REMOVED AND REPLACED IN ACCORDANCE WITH VILLAGE AND POSTMASTER STANDARDS AS INCIDENTAL TO CONSTRUCTION. MAIL SERVICE SHALL BE MAINTAINED AT ALL TIMES.
- ALL DOWEL BARS AND TIE BARS SHALL BE INCLUDED IN THE COST OF CLASS B PATCHING OF THE TYPE AND THICKNESS SPECIFIED, AND THE CURB AND GUTTER.
- RESTORE GRASSED AREAS DISTURBED BY CONSTRUCTION WITH A MINIMUM 18" WIDE STRIP OF SODDING, SALT TOLERANT IN ACCORDANCE WITH SECTIONS 211 AND 252 UNLESS OTHERWISE NOTED OR DETERMINED BY THE ENGINEER.
- P.C.C. PAVEMENT ROUND OUTS SHALL BE CONSIDERED INCIDENTAL TO THE COST OF PATCHING.
- A NOMINAL QUANTITY OF SUBBASE GRANULAR MATERIAL HAS BEEN ADDED TO THE PLANS IN THE EVENT OF ADDITIONAL REMOVAL OF POOR SUB BASE BENEATH THE PAVEMENT OR CURB. THE ACTUAL NEED FOR THESE ITEMS SHALL BE DETERMINED IN THE FIELD BY THE ENGINEER.
- ALL CLASS B PATCHES, TYPE III AND TYPE IV, MUST BE REINFORCED WITH PAVEMENT FABRIC.
- ALL PATCH LOCATIONS AND DIMENSIONS ARE APPROXIMATE. ACTUAL VALUES ARE TO BE DETERMINED BY ENGINEER IN THE FIELD.

HIGHWAY STANDARDS LIST

000001-04	STANDARD SYMBOLS, ABBREVIATIONS AND PATTERNS
420001-05	PAVEMENT JOINTS
420111-01	PCC PAVEMENT ROUNDOUTS
420701-01	PAVEMENT FABRIC
442101-05	CLASS B PATCHES
606001-02	CONCRETE CURB TYPE B AND COMBINATION CURB AND GUTTER
701606-04	URBAN LANE CLOSURE, MULTILANE 2W WITH MOUNTABLE MEDIAN
701701-04	URBAN LANE CLOSURE, MULTILANE INTERSECTION
701801-03	LANE CLOSURE MULTILANE, 1W OR 2W CROSSWALK OR SIDEWALK CLOSURE
702001-05	TRAFFIC CONTROL DEVICES
780001-01	TYPICAL PAVEMENT MARKINGS
781001-02	TYPICAL APPLICATIONS RAISED REFLECTIVE PAVEMENT MARKERS
886001	DETECTOR LOOP INSTALLATIONS
886006	TYPICAL LAYOUTS FOR DETECTION LOOPS

COPYRIGHT © 2005 BY BAXTER & WOODMAN, INC.
 STATE OF ILLINOIS - PROFESSIONAL ENGINEER
 LICENSE NO. 031-001011 - EXPIRES 1/31/2008

CONSULTANTS	REV. NO.	DATE	DESCRIPTION
	1	01/27/05	PER IDOT REVIEW
	2	02/22/05	PER IDOT REVIEW

* REFER TO EQUIPMENT MANUFACTURER'S SHOP DRAWINGS DRAWING FILE:10631-SH2-1EAS1REVISED.DWG PLOTTED BY: MCU 22/FEB/05 08:21



Baxter & Woodman
 Crystal Lake, Illinois 815.469.1280
 Burlington, Wisconsin 262.763.7834
 Mokena, Illinois 708.478.2090
 DeKalb, Illinois 815.787.3111
 Grayslake, Illinois 847.223.5088

VILLAGE OF HAZEL CREST, ILLINOIS
183RD STREET PAVEMENT REHABILITATION
EASTBOUND LANES
SECTION NO.: 03-00066-01-RP

SUMMARY OF QUANTITIES,
GENERAL NOTES, INDEX OF SHEETS
AND HIGHWAY STANDARDS

DESIGNED BY	SCALE
MCU	NONE
DRAWN BY	PROJECT NO.
MCU	040631
CHECKED BY	SHEET NO.
LDH	
DATE	
7/07/04	2 OF 11

LEGEND

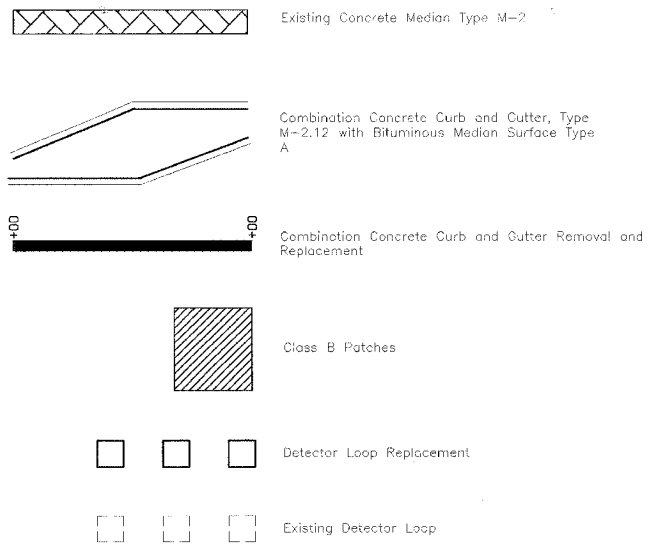

ABBREVIATIONS

- | | | | |
|------------|------------------------------|------|---------------------------------------|
| CONC | PORTLAND CEMENT CONCRETE | R | STRUCTURE TO BE RECONSTRUCTED |
| BIT | BITUMINOUS PAVEMENT | A | STRUCTURE TO BE ADJUSTED |
| GR | GRAVEL | ▲ | CENTRAL ANGLE |
| CMP | CORRUGATED METAL PIPE | D= | DEGREE OF CURVE |
| FH | FIRE HYDRANT | T= | TANGENT LENGTH |
| CI | CAST IRON | L= | CURVE LENGTH |
| DI | DUCTILE IRON | R= | RADIUS OF CURVE |
| F-F | FACE-TO-FACE | E= | EXTERNAL DISTANCE |
| E-E | EDGE-TO-EDGE | SE= | SUPERELEVATION (FT. PER FT. OF WIDTH) |
| B-B | BACK-TO-BACK | X= | EXTERNAL DISTANCE OF VERTICAL CURVE |
| B-B | BACK-TO-BACK | | |
| E-F | EDGE OF PAVEMENT-TO-FENCE | | |
| R.O.W.-B/W | RIGHT OF WAY-TO-BACK OF WALL | PC | POINT OF CURVATURE |
| BM | BENCH MARK | PI | POINT OF INTERSECTION |
| INV EL | INVERT ELEVATION | PT | POINT OF TANGENCY |
| CL EL | CENTERLINE ELEVATION | POT | POINT ON TANGENCY |
| P | POINT | PCC | POINT OF COMPOUND CURVATURE |
| G | GUTTER | PRC | POINT OF REVERSE CURVATURE |
| C | CURB | VC | VERTICAL CURVE |
| BC | BACK OF CURB | N&W | NAIL AND WASHER |
| E | EDGE | TCE | TEMPORARY CONSTRUCTION EASEMENT |
| EOP | EDGE OF PAVEMENT | E.F. | EXTERIOR FACE |
| PL | PROPERTY LINE | BW | BOTTOM OF WALL |
| ROW | RIGHT OF WAY | TW | TOP OF WALL |
| FL | FLOW LINE | DL | DITCH LINE |
| TF | TOP OF FRAME | C&G | COMBINATION CURB & GUTTER |
| TC | TOP OF CURB OR CONCRETE | R&R | REMOVE AND REPLACE |
| WB | WESTBOUND | | |
| EB | EASTBOUND | | |

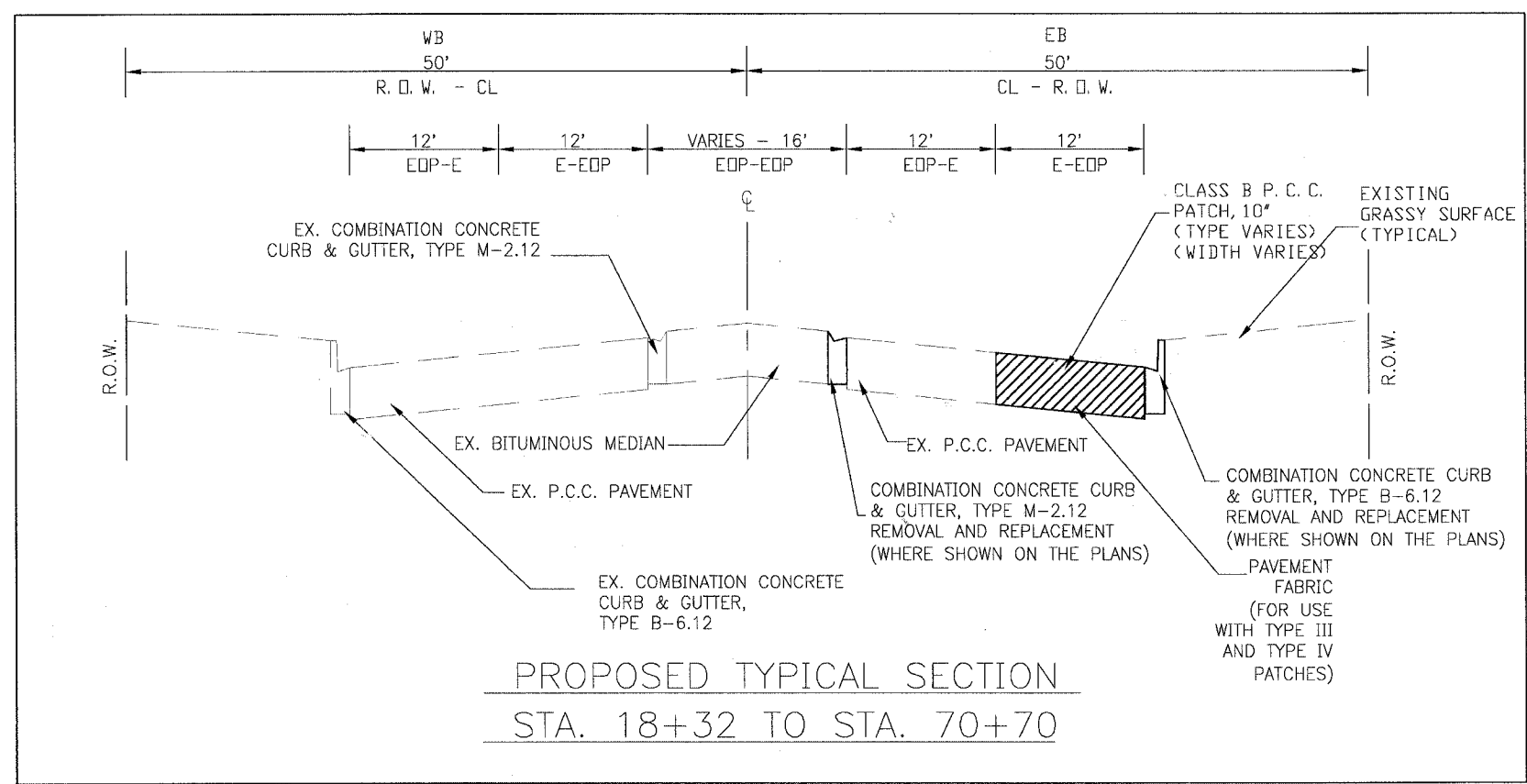

COPYRIGHT © 2005 BY BAXTER & WOODMAN, INC.
 STATE OF ILLINOIS - PROFESSIONAL ENGINEER
 LICENSE NO. 042-000000-000000-000000

CONSULTANTS	REV. NO.	DATE	DESCRIPTION
	1	01/27/05	PER IDOT REVIEW
	2	02/22/05	PER IDOT REVIEW

* REFER TO EQUIPMENT MANUFACTURER'S SHOP DRAWINGS DRAWING FILE#0631SH2-4EASTREVISED.DWG PLOTTED BY: MCU 22/FEB/05 08:23

BAXTER & WOODMAN
Consulting Engineers

Baxter & Woodman
Crystal Lake, Illinois 815.459.1260
Burlington, Wisconsin 262.763.7934
Mokena, Illinois 708.478.2090
DeKalb, Illinois 815.787.3111
Craylake, Illinois 847.228.5088

VILLAGE OF HAZEL CREST, ILLINOIS
183RD STREET PAVEMENT REHABILITATION
EASTBOUND LANES
SECTION NO.: 03-00066-01-RP

TYPICAL SECTIONS, ABBREVIATIONS AND LEGEND

DESIGNED BY	SCALE
MCL	NONE
DRAWN BY	PROJECT NO.
MCL	040631
CHECKED BY	SHEET NO.
IDH	
DATE	
7/07/04	4 OF 11

FA ROUTE NO.	SECTION	COUNTY	TOTAL SHEETS	SHEET NO.
1622	03-00066-01-RP	COOK	11	5
ILLINOIS PROJECT:				
CONTRACT NUMBER: 83778				

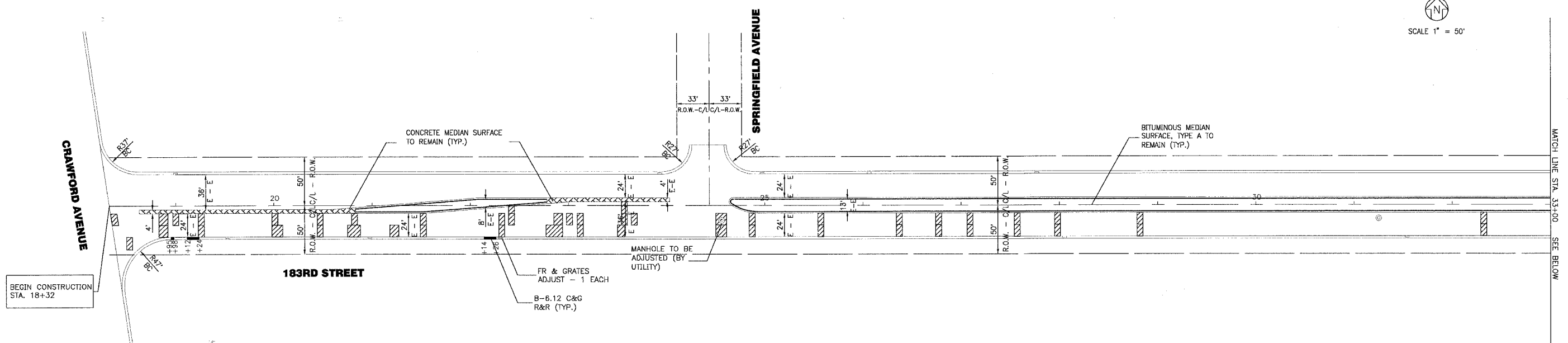
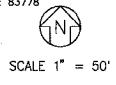

CURB REMOVAL AND PATCH STATIONS ARE APPROXIMATE. FINAL QUANTITIES WILL BE MARKED IN THE FIELD AND MEASURED BY THE ENGINEER.

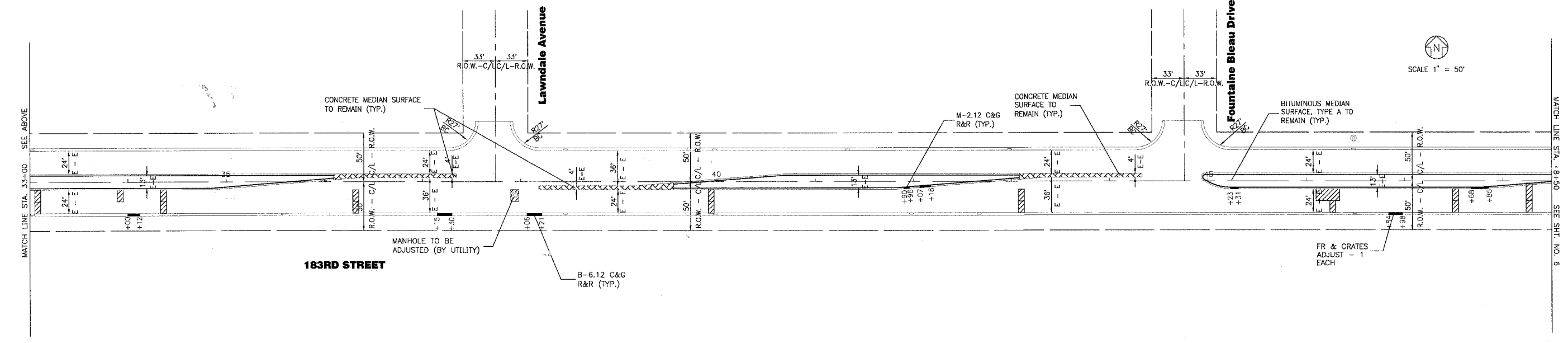

COPYRIGHT © 2005 BY DEXTER & WOODMAN, INC.
 STATE OF ILLINOIS - PROFESSIONAL ENGINEERING
 LICENSE NO. 120-0712 EXP. 01/31/2008

CONSULTANTS	REV. NO.	DATE	DESCRIPTION
	1	01/27/05	PER IDOT REVIEW
	2	02/22/05	PER IDOT REVIEW

DRAWING FILE: 183RDHAZELPATCHEB-REV1		PLOTTED BY: MCU		22/FEB/05 08:26	
--------------------------------------	--	-----------------	--	-----------------	--



Baxter & Woodman
 Crystal Lake, Illinois 815.459.1280
 Burlington, Wisconsin 262.783.7834
 Mokena, Illinois 708.478.2090
 DeKalb, Illinois 815.787.3111
 Grayslake, Illinois 847.223.5088

VILLAGE OF HAZEL CREST, ILLINOIS
183RD STREET PAVEMENT REHABILITATION
EASTBOUND LANES
SECTION NO.: 03-00066-01-RP

183RD STREET
STA. 18+32 TO STA. 48+50
GEOMETRIC PLAN

DESIGNED BY	MCU	SCALE	1"=50'
DRAWN BY	MCU	PROJECT NO.	040631
CHECKED BY	LDH	SHEET NO.	
DATE	7/07/04		
			5 OF 11

F.A. ROUTE NO.	SECTION	COUNTY	TOTAL SHEETS	SHEET NO.
1622	03-00066-01-RP	COOK	11	6
ILLINOIS PROJECT:				
CONTRACT NUMBER: 83778				

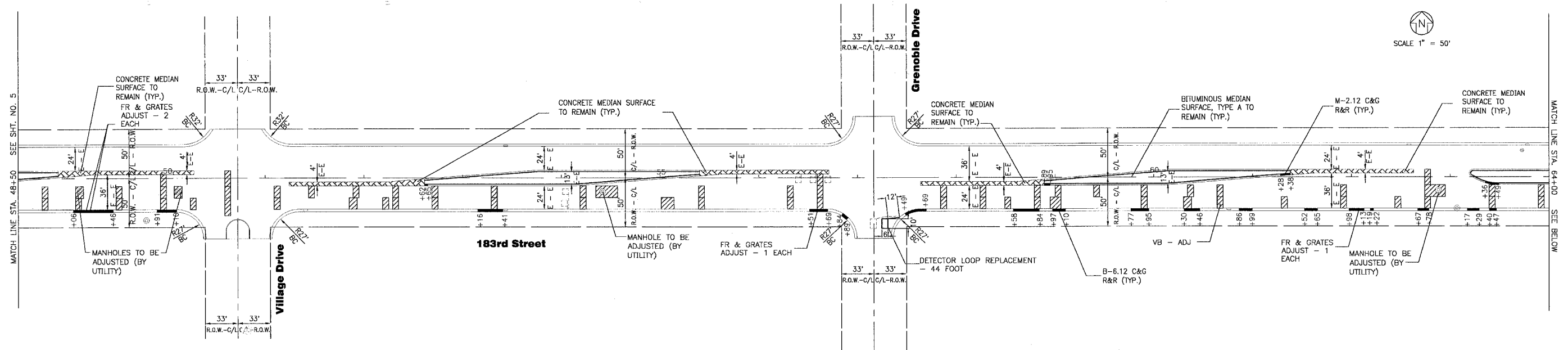

CURB REMOVAL AND PATCH STATIONS ARE APPROXIMATE. FINAL QUANTITIES WILL BE MARKED IN THE FIELD AND MEASURED BY THE ENGINEER.

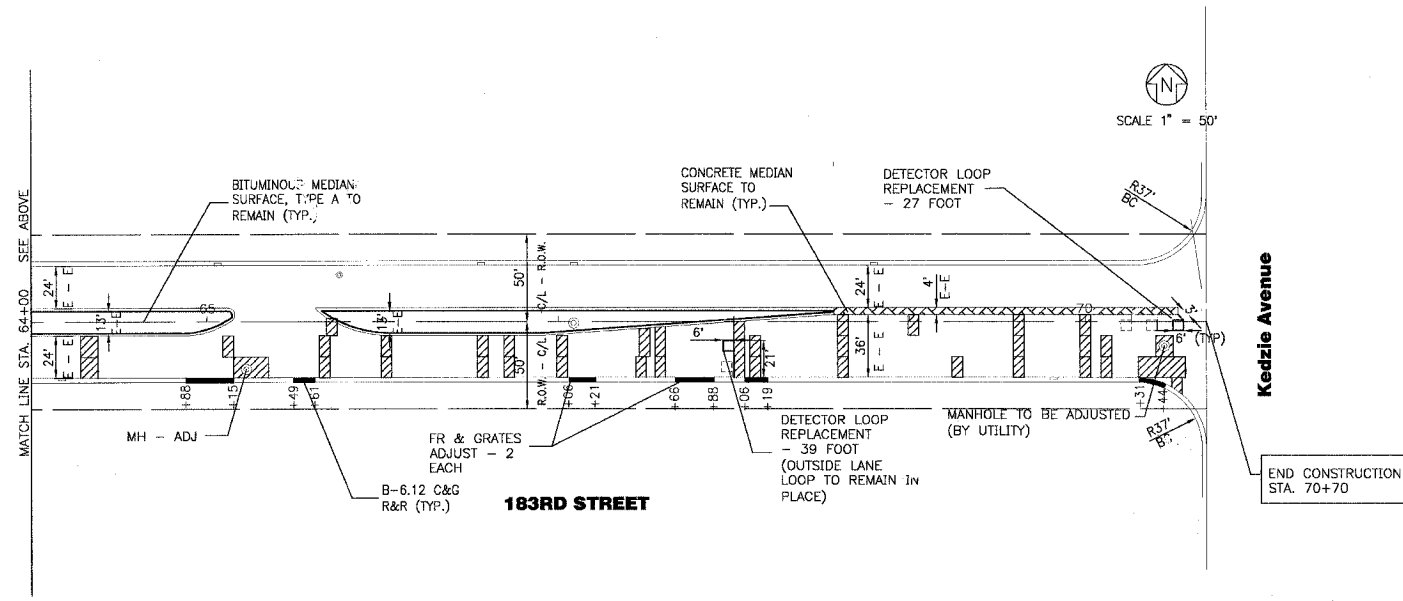

COPYRIGHT © 2005 BY BAXTER & WOODMAN, INC.
 ALL RIGHTS RESERVED. PROJECT NO. 03-00066-01-RP
 DRAWING NO. 183RD-HAZEL-PATCH-B-REV1

CONSULTANTS	REV. NO.	DATE	DESCRIPTION
	1	01/27/05	PER IDOT REVIEW
	2	02/22/05	PER IDOT REVIEW

DRAWING FILE: 183RD-HAZEL-PATCH-B-REV1 PLOTTED BY: MCM 22/FEB/05 08:29



Baxter & Woodman
 Crystal Lake, Illinois 815.459.1260
 Burlington, Wisconsin 262.763.7834
 Mokena, Illinois 708.478.2090
 DeKalb, Illinois 815.787.3111
 Crayslake, Illinois 847.223.5088

VILLAGE OF HAZEL CREST, ILLINOIS
183RD STREET PAVEMENT REHABILITATION
EASTBOUND LANES
SECTION NO.: 03-00066-01-RP

183RD STREET
STA. 48+50 TO STA. 70+70
GEOMETRIC PLAN

DESIGNED BY	SCALE
MCM	1"=50'
DRAWN BY	PROJECT NO.
MCM	040631
CHECKED BY	SHEET NO.
LDH	6 OF 11
DATE	
7/07/04	

F.A. ROUTE NO.	SECTION	COUNTY	TOTAL SHEETS	SHEET NO.
1622	03-00066-01-RP	COOK	11	7

ILLINOIS PROJECT:
CONTRACT NUMBER: 83778

F.A. ROUTE NO.	SECTION	COUNTY	SHEET NO.
1622	03-00066-01-RP	COOK	11
STA.		TO STA.	
1622-000	000	1622-000	000

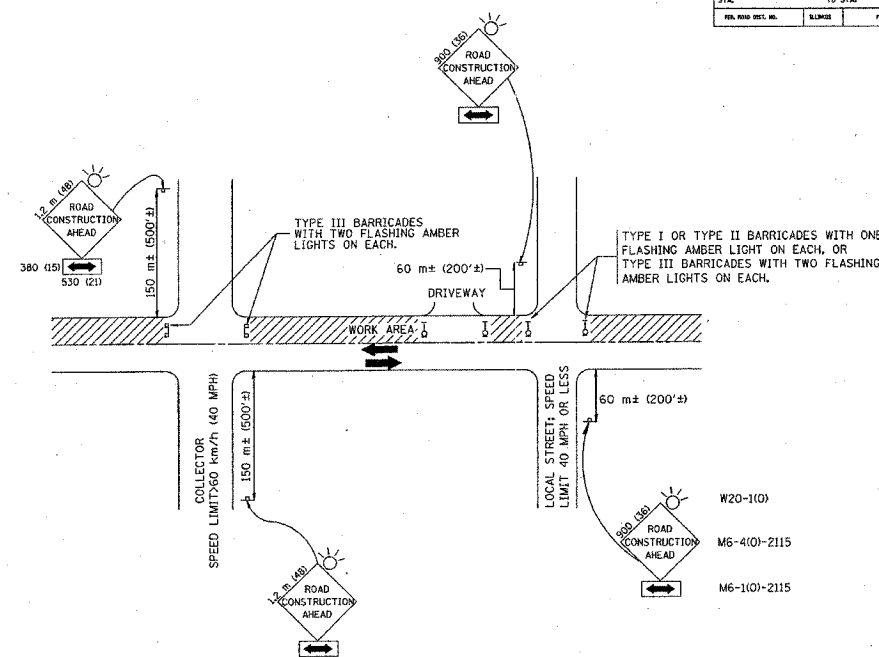

TRAFFIC CONTROL AND PROTECTION FOR SIDE ROADS, INTERSECTIONS, AND DRIVEWAYS

NOTES:

- A. FOR NO LANE RESTRICTION ON THE SIDE ROAD OR DRIVEWAYS**
1. SIDE ROAD WITH A SPEED LIMIT OF 60 km/h (40 MPH) OR LESS AS SHOWN ON THE DRAWING AND AS DIRECTED BY THE ENGINEER:
 - a) ONE ROAD CONSTRUCTION AHEAD SIGN 900x900 (36x36) WITH A FLASHER AND FLAG MOUNTED ON IT APPROXIMATELY 60 m (200') IN ADVANCE OF THE MAIN ROUTE.
 - b) THE CLOSED PORTION OF THE MAIN ROUTE SHALL BE PROTECTED BY BLOCKING WITH TYPE I, TYPE II OR TYPE III BARRICADES, 1/3 OF THE CROSS SECTION OF THE CLOSED PORTION.
 2. SIDE ROAD WITH A SPEED LIMIT GREATER THAN 60 km/h (40 MPH) AS SHOWN ON THE DRAWING AND AS DIRECTED BY THE ENGINEER:
 - a) ONE ROAD CONSTRUCTION AHEAD SIGN 1.2 m x 1.2 m (48x48) WITH A FLASHER MOUNTED ON IT APPROXIMATELY 150 m (500') IN ADVANCE OF THE MAIN ROUTE.
 - b) THE CLOSED PORTION OF THE MAIN ROUTE SHALL BE PROTECTED BY BLOCKING WITH TYPE III BARRICADES, 1/2 OF THE CROSS SECTION OF THE CLOSED PORTION.
 3. WHEN THE SIDE ROAD LIES BETWEEN THE BEGINNING OF THE MAINLINE STOPPING AND THE WORK ZONE, A SINGLE HEADED ARROW (M6-1) SHALL BE USED IN LIEU OF THE DOUBLE HEADED ARROW (M6-4).
- B. FOR A LANE CLOSURE ON A SIDE ROAD OR DRIVEWAY**
- USE APPLICABLE PORTIONS OF THE TYPICAL APPLICATION OF TRAFFIC CONTROL DEVICES (STD. 70150), STD. 70160 OR THE APPROPRIATE STANDARD. THE SPACING OF SIGNS AND BARRICADES SHALL BE ADJUSTED FOR FIELD CONDITIONS AS DIRECTED BY THE ENGINEER. THE DIRECTIONAL ARROW SHALL BE COVERED OR REMOVED WHEN NO LONGER CONSISTENT WITH THE SIDE ROAD LANE CLOSURE.
- C. ADVANCE WARNING SIGNS ARE TO BE OMITTED ON DRIVEWAY UNLESS OTHERWISE NOTED.**
- D. THE TRAFFIC CONTROL AND PROTECTION FOR SIDE ROADS, INTERSECTIONS, AND DRIVEWAYS SHALL BE INCIDENTAL TO THE COST OF SPECIFIED TRAFFIC CONTROL STANDARDS OR ITEMS.**

All dimensions are in millimeters (inches) unless otherwise shown.

ILLINOIS DEPARTMENT OF TRANSPORTATION
TRAFFIC CONTROL AND PROTECTION
FOR
SIDE ROADS, INTERSECTIONS, AND
DRIVEWAYS

REVISIONS	
NAME	DATE
LHA	6/78
T. RAMMACHER	09/08/94
J. GERLE	10/18/95
A. HOUSEH	03/06/96
A. HOUSEH	10/15/96
T. RAMMACHER	01/06/02

SCALE: NONE
DATE: 3/25/02
DRAWN BY:
CHECKED BY:

TC-10

Mon Mar 25 10:08:59 2002
\\dotprod\projects\dotatd\dot18.dgn LV:95
VET:LO

w:\proj\enlish\10.mck: 10:02:21 03/25/2002

COPYRIGHT © 2002 BY DEXTER A. WOODMAN, INC.
STATE OF ILLINOIS - PROFESSIONAL ENGINEERING
REGISTERED PROFESSIONAL ENGINEER No. 120175
EXPIRES 12/31/2008

CONSULTANTS	REV. NO.	DATE	DESCRIPTION
	1	01/27/05	PER IDOT REVIEW
	2	02/22/05	PER IDOT REVIEW

* REFER TO EQUIPMENT MANUFACTURER'S SHOP DRAWINGS DRAWING FILE: TC10EB.DWG PLOTTED BY: MCU 22/FEB/05 08:30



Baxter & Woodman
Crystal Lake, Illinois 815.459.1280
Burlington, Wisconsin 262.763.7834
Mokena, Illinois 708.478.2090
DeKalb, Illinois 815.787.3111
Craylake, Illinois 847.223.5088

VILLAGE OF HAZEL CREST, ILLINOIS
183RD STREET PAVEMENT REHABILITATION
EASTBOUND LANES
SECTION NO.: 03-00066-01-RP

183RD STREET
TRAFFIC CONTROL AND
PROTECTION

DESIGNED BY	SCALE
MCU	NONE
DRAWN BY	PROJECT NO.
MCU	040631
CHECKED BY	SHEET NO.
LDH	
DATE	
7/07/04	7 OF 11

ROUTE NO.	SECTION	COUNTY	TOTAL SHEETS	SHEET NO.
162P	03-00066-01-RP	COOK	11	8
ILLINOIS PROJECT:				
CONTRACT NUMBER - 03778				
F.A. NO.	SECTION	COUNTY	TOTAL SHEETS	SHEET NO.
STA.		TO STA.		
FED. ROAD DIST. NO.	ILLINOIS	FED. AID PROJECT		

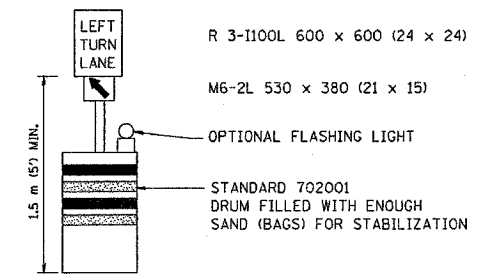
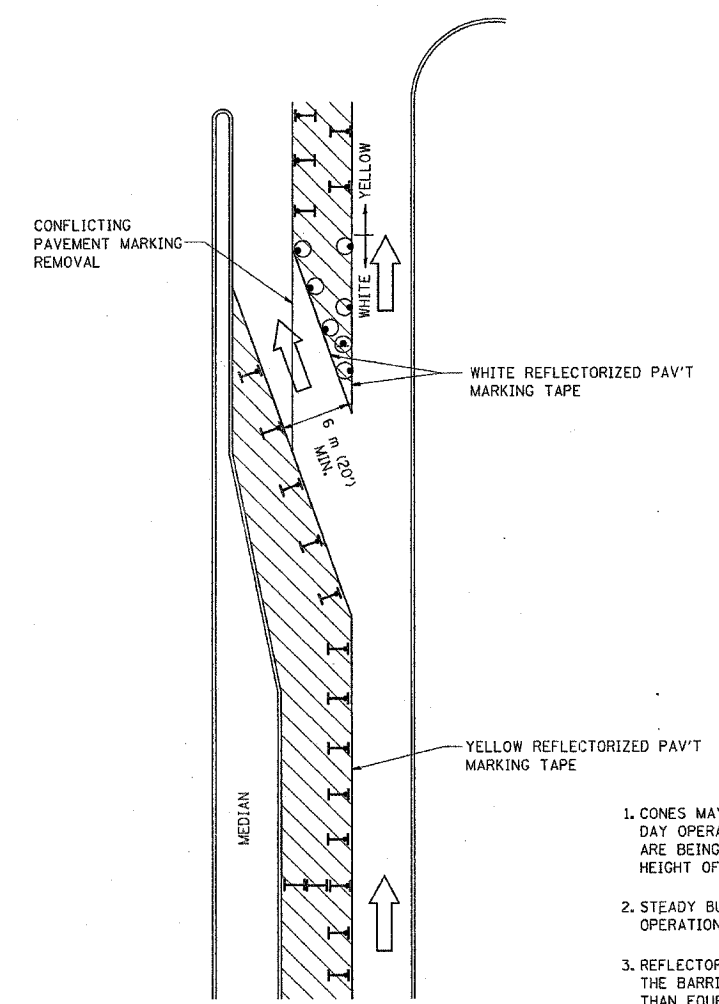

GENERAL NOTES

1. CONES MAY BE SUBSTITUTED FOR BARRICADES OR DRUMS AT HALF THE SPACING DURING DAY OPERATIONS. CONES SHALL BE A MINIMUM OF 710 (28) IN HEIGHT. WHEN CONES ARE BEING USED, THE "LEFT TURN LANE" SIGN MAY BE SKID MOUNTED AT A MINIMUM HEIGHT OF 1.5 m (5').
2. STEADY BURNING LIGHTS WILL NOT BE REQUIRED ON BARRICADES OR DRUMS FOR DAY OPERATIONS. ALL LIGHTS SHALL BE MONODIRECTIONAL.
3. REFLECTORIZED TEMPORARY PAVEMENT MARKING TAPE SHALL BE PLACED THROUGHOUT THE BARRICADED AREA OF EACH TURN BAY WHERE THE CLOSURE TIME IS GREATER THAN FOURTEEN DAYS.
4. THIS APPLICATION ALSO APPLIES WHEN WORK IS BEING PERFORMED IN THE RIGHT LANE(S) AND THE RIGHT TURN BAY IS TO REMAIN OPEN. UNDER THIS CONDITION, "RIGHT TURN LANE" R3-100 600 x 600 (24 x 24) AND M6-2R 530 x 380 (21 x 15) SHALL BE USED.
5. THESE CONTROLS SHALL SUPPLEMENT MAINLINE TRAFFIC CONTROL FOR LANE CLOSURES.
6. LONGITUDINAL DIMENSIONS MAY BE ADJUSTED TO FIT FIELD CONDITIONS.
7. FORM BT 725 IS REQUIRED.
8. TRAFFIC CONTROL AND PROTECTION AT TURN BAYS (TO REMAIN OPEN TO TRAFFIC) SHALL BE INCLUDED IN THE COST SPECIFIED TRAFFIC CONTROL STANDARDS OR ITEMS.

LEGEND

- WORK AREA
- LANE OPEN TO TRAFFIC
- TYPE I OR II BARRICADE WITH STEADY BURN LIGHT
- DRUM WITH STEADY BURN LIGHT
- DRUM WITH SIGN (WITH OPTIONAL FLASHING LIGHT) SEE DETAIL
- TYPE I OR II CHECK BARRICADE WITH FLASHING LIGHT

All dimensions are in millimeters (inches) unless otherwise shown.

ILLINOIS DEPARTMENT OF TRANSPORTATION

TRAFFIC CONTROL AND PROTECTION AT TURN BAYS (TO REMAIN OPEN TO TRAFFIC)

SCALE: NONE
DATE: 11/20/01

DRAWN BY: LHA
CHECKED BY: LHA

REVISIONS	
NAME	DATE
T. RAMMACHER	09/08/94
A. HOUSEH	11/07/95
A. HOUSEH	10/12/96
T. RAMMACHER	01/06/00

COPYRIGHT © 2005 BY BAXTER & WOODMAN, INC.
 STATE OF ILLINOIS - PROFESSIONAL ENGINEERING
 LICENSE NO. 124-00171 EXPIRES 4/30/2008

Tue Nov 20 16:08:53 2001
 \\jcd\ddl\projects\diststd\tcl4.dgn LV=35
 V1=TC14

CONSULTANTS	REV. NO.	DATE	DESCRIPTION
	1	01/27/05	PER IDOT REVIEW
	2	02/22/05	PER IDOT REVIEW

DRAWING FILE: TC14EB.DWG PLOTTED BY: MCU 22/FEB/05 08:30

BAXTER & WOODMAN
 Consulting Engineers

Baxter & Woodman
 Crystal Lake, Illinois 815.459.1280
 Burlington, Wisconsin 262.763.7834
 Mokena, Illinois 708.478.2090
 DeKalb, Illinois 815.787.3111
 Grayslake, Illinois 847.223.6088

VILLAGE OF HAZEL CREST, ILLINOIS
183RD STREET PAVEMENT REHABILITATION
EASTBOUND LANES
SECTION NO.: 03-00066-01-RP

183RD STREET
TRAFFIC CONTROL
AND PROTECTION

DESIGNED BY	SCALE
MCU	NONE
DRAWN BY	PROJECT NO.
MCU	040631
CHECKED BY	SHEET NO.
LDH	
DATE	
7/07/04	8 OF 11

TC-14

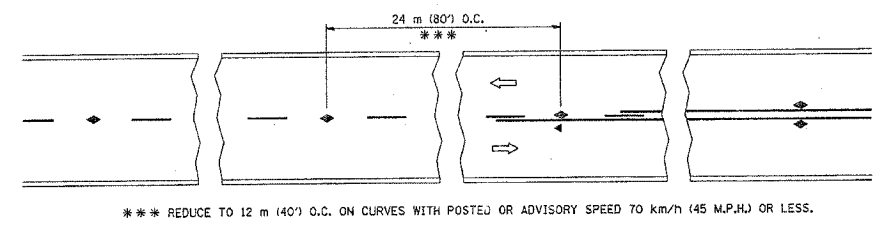

TWO-LANE/TWO-WAY

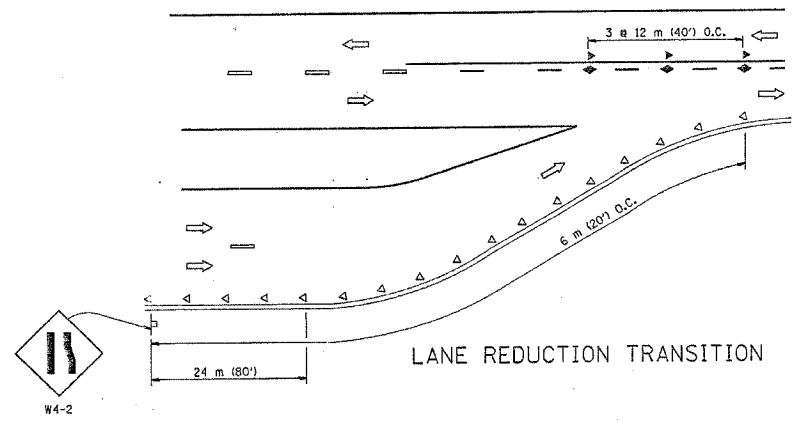

LANE REDUCTION TRANSITION

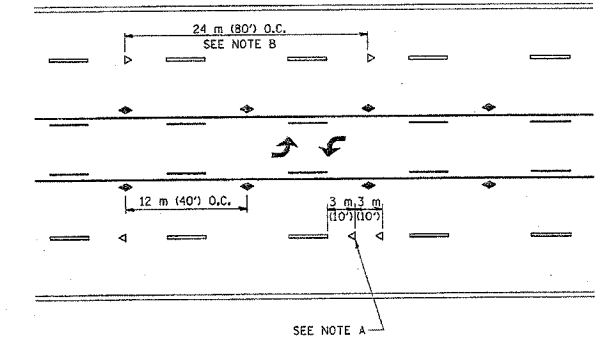

TWO-WAY LEFT TURN

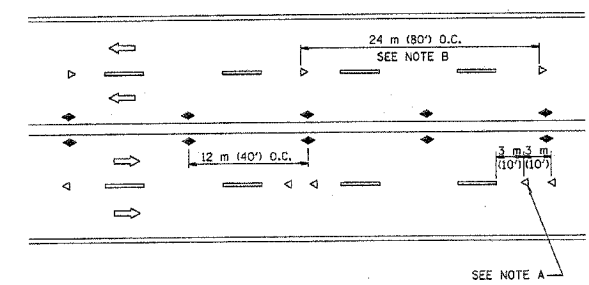

MULTI-LANE/UNDIVIDED

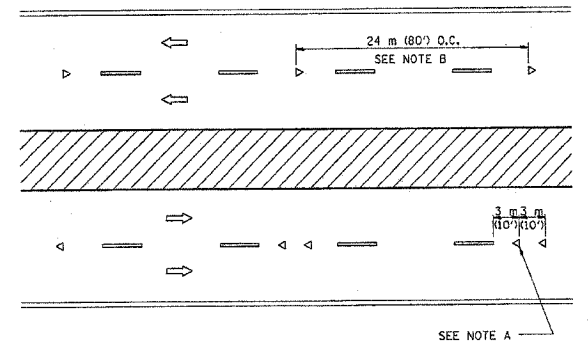

MULTI-LANE/DIVIDED

GENERAL NOTES

1. MARKERS USED WITH DASHED LINES SHALL BE CENTERED IN THE GAP BETWEEN SEGMENTS.
2. MARKERS USED ADJACENT TO SOLID LINES SHALL BE OFFSET 50 TO 75 (2 TO 3) TOWARD TRAFFIC AS SHOWN.
3. MARKERS THROUGH TANGENTS LESS THAN 150 m (500') IN LENGTH BETWEEN CURVES SHALL BE INSTALLED AT THE LESSER OF THE TWO CURVE SPACINGS.

SYMBOLS

- YELLOW STRIPE
- WHITE STRIPE
- ◀ ONE-WAY AMBER MARKER
- ◁ ONE-WAY CRYSTAL MARKER (W/O)
- ◄ TWO-WAY AMBER MARKER

LANE MARKER NOTES

- B. REDUCE TO 12 m (40') O.C. ON CURVES WHERE ADVISORY SPEEDS ARE 20 km/h (10 M.P.H.) LOWER THAN POSTED SPEEDS.
- A. USE DOUBLE LANE LINE MARKERS SPACED AS SHOWN.

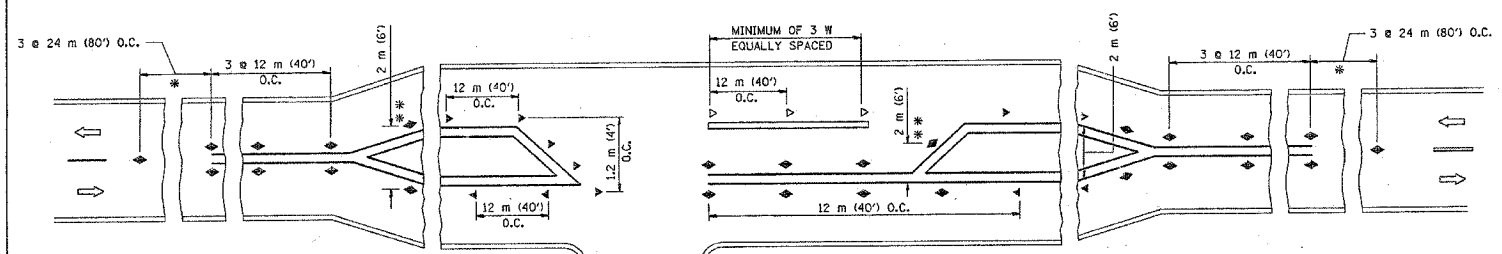

LEFT TURN

* SEE TWO-LANE/TWO-WAY WHERE MARKERS CONTINUE
** WHERE THE MEDIAN WIDTH IS 2 m (6') OR LESS USE TWO-WAY MARKERS.

All dimensions are in millimeters (inches) unless otherwise shown.

ILLINOIS DEPARTMENT OF TRANSPORTATION

TYPICAL APPLICATIONS
RAISED REFLECTIVE PAVEMENT MARKERS
(SNOW-PLOW RESISTANT)

REVISIONS	NAME	DATE
1	T. RAMMACHER	09-19-94
2	T. RAMMACHER	03-12-99
3	T. RAMMACHER	01-06-00

SCALE: NONE
DATE: 10/18/00
DESIGNED BY: MCU
DRAWN BY: MCU
CHECKED BY: LDH
DATE: 7/07/04

Wed Oct 18 13:56:36 2000
\\cadd\dl\project\atlas\atlas\atlas\tc11.dgn LV=2,3,22,35,43,63
VI=TC1

COPYRIGHT © 2004 BY BAXTER & WOODMAN, INC.
 STATE OF ILLINOIS PROFESSIONAL ENGINEERING
 LICENSE NO. 134-011111 EXPIRES 4/30/2004

CONSULTANTS	REV. NO.	DATE	DESCRIPTION
	1	01/27/05	PER IDOT REVIEW
	2	02/22/05	PER IDOT REVIEW

DRAWING FILE: TC11EB.DWG
PLOTTED BY: MCU 22/FEB/05 08:34

BAXTER & WOODMAN
Consulting Engineers

Baxter & Woodman
Crystal Lake, Illinois 815.459.1280
Burlington, Wisconsin 262.763.7834
Mokena, Illinois 708.478.2090
DeKalb, Illinois 815.787.3111
Crawfordsville, Illinois 847.223.5088

VILLAGE OF HAZEL CREST, ILLINOIS
183RD STREET PAVEMENT REHABILITATION
EASTBOUND LANES
SECTION NO.: 03-00066-01-RP

183RD STREET
TYPICAL APPLICATIONS
RAISED REFLECTIVE PAVEMENT MARKERS

DESIGNED BY	SCALE
MCU	NONE
DRAWN BY	PROJECT NO.
MCU	040631
CHECKED BY	SHEET NO.
LDH	9 OF 11
DATE	
7/07/04	

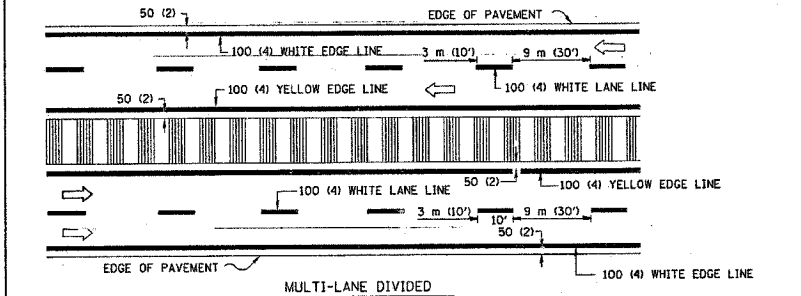
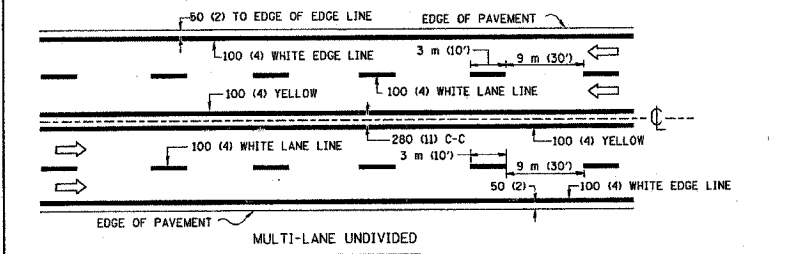
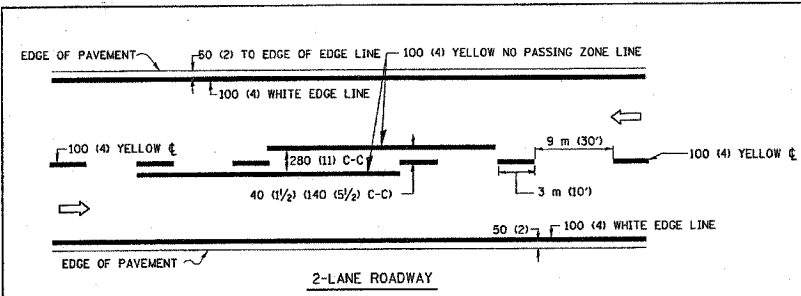

NOTE: MEDIANS WITH BARRIER CURB DO NOT REQUIRE AN EDGE LINE

TYPICAL LANE AND EDGE LINE MARKING

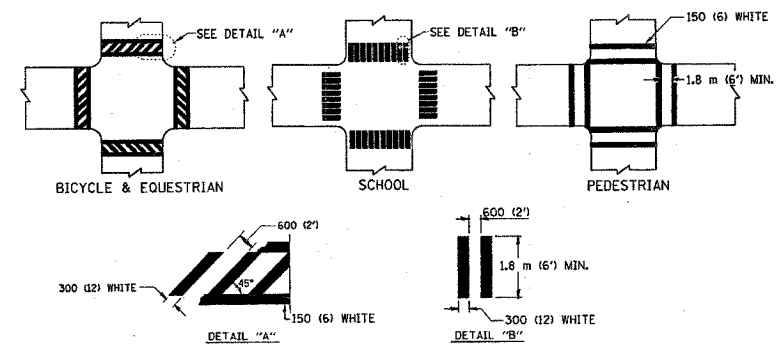

TYPICAL CROSSWALK MARKING

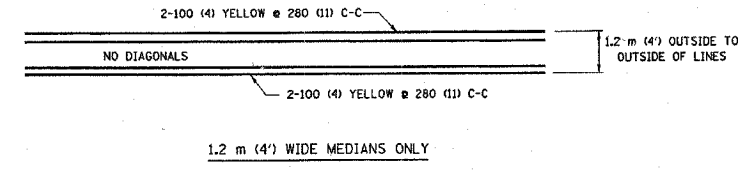

1.2 m (4') WIDE MEDIANS ONLY

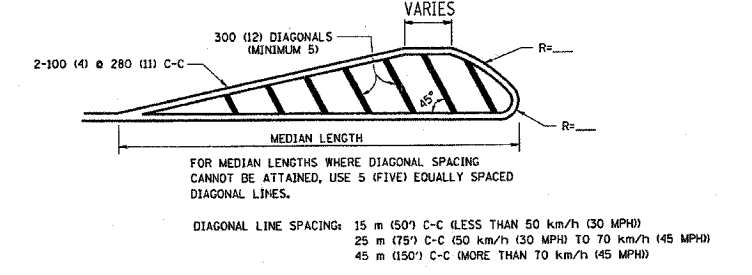

MEDIANS OVER 1.2 m (4') WIDE

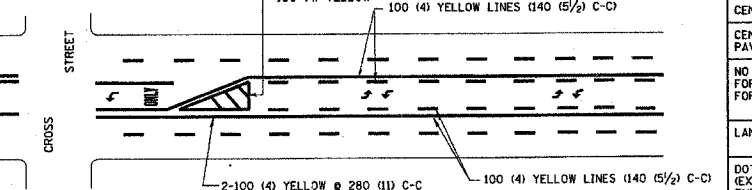

A MINIMUM OF TWO PAIRS OF TURN ARROWS SHALL BE USED, WHITE IN COLOR. ADDITIONAL PAIRS SHALL BE PLACED AT 60 m (200') TO 90 m (300') INTERVALS.

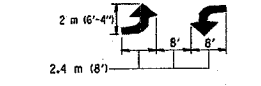

MEDIAN WITH TWO-WAY LEFT TURN LANE

TYPICAL PAINTED MEDIAN MARKING

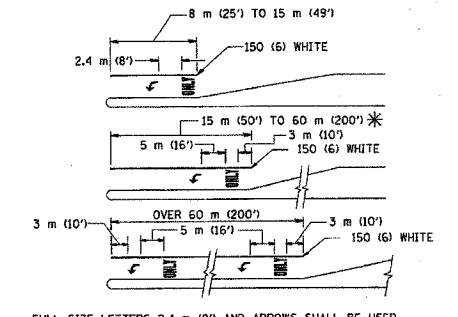

FULL SIZE LETTERS 2.4 m (8') AND ARROWS SHALL BE USED. AREA = 1.5 m² (15.6 SQ. FT.) ONLY AREA = 1.9 m² (20.8 SQ. FT.)

* TURN LANES IN EXCESS OF 120 m (400') IN LENGTH MAY HAVE AN ADDITIONAL SET OF ARROW - "ONLY" INSTALLED MIDWAY BETWEEN THE OTHER TWO SETS OF ARROW - "ONLY".

TYPICAL LEFT (OR RIGHT) TURN LANE

TYPICAL TURN LANE MARKING

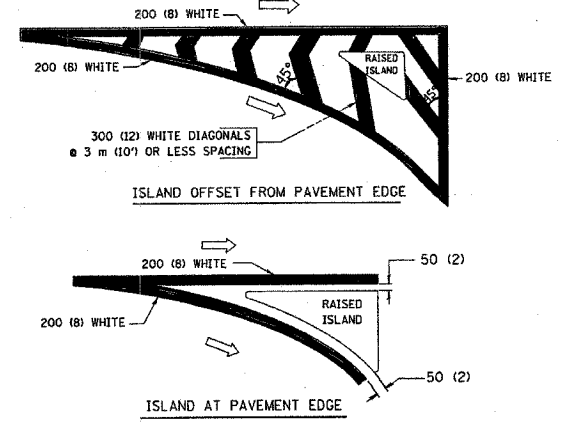

TYPICAL ISLAND MARKING

TYPE OF MARKING	WIDTH OF LINE	PATTERN	COLOR	SPACING / REMARKS
CENTERLINE ON 2 LANE PAVEMENT	100 (4)	SKIP-DASH	YELLOW	3 m (10') LINE WITH 9 m (30') SPACE
CENTERLINE ON MULTI-LANE UNDIVIDED PAVEMENT	2 @ 100 (4)	SOLID	YELLOW	280 (11) C-C
NO PASSING ZONE LINES FOR ONE DIRECTION FOR BOTH DIRECTIONS	100 (4) 2 @ 100 (4)	SOLID SOLID	YELLOW YELLOW	140 (5 1/2) C-C FROM SKIP-DASH CENTERLINE 280 (11) C-C OMIT SKIP-DASH CENTERLINE BETWEEN
LANE LINES	100 (4) 125 (5) ON FREEWAYS	SKIP-DASH SKIP-DASH	WHITE WHITE	3 m (10') LINE WITH 9 m (30') SPACE
DOTTED LINES (EXTENSIONS OF CENTER, LANE OR TURN LANE MARKINGS)	SAME AS LINE BEING EXTENDED	SKIP-DASH	SAME AS LINE BEING EXTENDED	600 (2') LINE WITH 1.8 m (6') SPACE
EDGE LINES	100 (4)	SOLID	YELLOW-LEFT WHITE-RIGHT	OUTLINE MOUNTABLE MEDIANS IN YELLOW; EDGE LINES ARE NOT USED NEXT TO BARRIER CURB
TURN LANE MARKINGS	150 (6) LINE; FULL SIZE LETTERS & SYMBOLS (2.4 m (8'))	SOLID	WHITE	SEE TYPICAL TURN LANE MARKING DETAIL
TWO WAY LEFT TURN MARKING	2 @ 100 (4) EACH DIRECTION 2.4 m (8') LEFT ARROW	SKIP-DASH AND SOLID IN PAIRS	YELLOW WHITE	3 m (10') LINE WITH 9 m (30') SPACE FOR SKIP-DASH; 140 (5 1/2) C-C BETWEEN SOLID LINE AND SKIP-DASH LINE SEE TYPICAL TWO-WAY LEFT TURN MARKING DETAIL
CROSSWALK LINES (PEDESTRIAN) A. DIAGONALS (BIKE & EQUESTRIAN) B. LONGITUDINAL BARS (SCHOOL)	2 @ 150 (6) 300 (12) @ 45° 300 (12) @ 90°	SOLID SOLID SOLID	WHITE WHITE WHITE	NOT LESS THAN 1.8 m (6') APART 600 (2') APART 600 (2') APART SEE TYPICAL CROSSWALK MARKING DETAILS.
STOP LINES	600 (24)	SOLID	WHITE	PLACE 1.2 m (4') IN ADVANCE OF AND PARALLEL TO CROSSWALK, IF PRESENT. OTHERWISE, PLACE AT DESIRED STOPPING POINT, PARALLEL TO CROSSROAD CENTERLINE, WHERE POSSIBLE
PAINTED MEDIANS	2 @ 100 (4) WITH 300 (12) DIAGONALS @ 45° NO DIAGONALS USED FOR 1.2 m (4') WIDE MEDIANS	SOLID	YELLOW; TWO WAY TRAFFIC WHITE; ONE WAY TRAFFIC	280 (11) C-C FOR THE DOUBLE LINE SEE TYPICAL PAINTED MEDIAN MARKING.
GORE MARKING AND CHANNELIZING LINES	200 (8) WITH 300 (12) DIAGONALS @ 45°	SOLID	WHITE	DIAGONALS: 4.5 m (15') C-C (LESS THAN 50 km/h (30 MPH)) 6 m (20') C-C (50 km/h (30 MPH) TO 70 km/h (45 MPH)) 9 m (30') C-C (OVER 70 km/h (45 MPH))
RAILROAD CROSSING	600 (24) TRANSVERSE LINES; "RR" 15 1.8 m (6') LETTERS; 400 (16) LINE FOR "X"	SOLID	WHITE	SEE STATE STANDARD 780001 AREA OF: "R"=0.33m ² (3.6 SQ. FT.) EACH "X"=5.0 m ² (54.0 SQ. FT.)
SHOULDER DIAGONALS	300 (12) @ 45°	SOLID	WHITE - RIGHT YELLOW - LEFT	15 m (50') C-C (LESS THAN 50 km/h (30 MPH)) 25 m (75') C-C (50 km/h (30 MPH) TO 70 km/h (45 MPH)) 45 m (150') C-C (OVER 70 km/h (45 MPH))

FOR FURTHER DETAILS ON PAVEMENT MARKING REFER TO STANDARD SPECIFICATIONS FOR ROAD AND BRIDGE CONSTRUCTION AND STATE STANDARD 780001.

All dimensions are in millimeters (inches) unless otherwise shown.

ILLINOIS DEPARTMENT OF TRANSPORTATION
DISTRICT ONE
TYPICAL PAVEMENT MARKINGS

REVISIONS	
NAME	DATE
EVERS	03-13-90
T. RAMMACHER	10-27-94
ALEX HOUSEH	10-09-96
ALEX HOUSEH	10-17-96
T. RAMMACHER	01-06-00

SCALE: NONE
DATE: 3/25/02
DRAWN BY: CADD
CHECKED BY:

TC-13

Mon Mar 25 10:07:59 2002
\\lceddl\projects\diststd\td13.dgn LV:35
VI:TC13

w:\work\enclish\td13.prk: 10:01:25 03/25/2002

CONSULTANTS	REV. NO.	DATE	DESCRIPTION
	1	01/27/05	PER IDOT REVIEW
	2	02/22/05	PER IDOT REVIEW

DRAWING FILE: TC13EB.DWG
PLOTTED BY: MCU 22/FEB/05 08:35



Baxter & Woodman
Crystal Lake, Illinois 815.459.1260
Burlington, Wisconsin 262.763.7834
Mokena, Illinois 708.478.2090
DeKalb, Illinois 815.787.3111
Grayslake, Illinois 847.223.5888

VILLAGE OF HAZEL CREST, ILLINOIS
183RD STREET PAVEMENT REHABILITATION
EASTBOUND LANES
SECTION NO.: 03-00066-01-RP

183RD STREET
TYPICAL PAVEMENT MARKINGS

DESIGNED BY	SCALE
MCU	NONE
DRAWN BY	PROJECT NO.
MCU	040631
CHECKED BY	SHEET NO.
LDH	
DATE	
7/07/04	10 OF 11

COPYRIGHT © 2002 BY BAXTER & WOODMAN, INC. STATE OF ILLINOIS PROFESSIONAL DESIGNER LICENSE NO. 03-00066-01-RP-03/25/2002

F.A. ROUTE NO.	SECTION	COUNTY	TOTAL SHEETS	SHEET NO.
1622	03-00066-01-RP	COOK	11	11
ILLINOIS PROJECT:				
CONTRACT NUMBER	SECTION	COUNTY	TOTAL SHEETS	SHEET NO.
03-00066-01-RP		COOK	11	11
STA.	TO STA.			
FED. ROAD DIST. NO.	ILLINOIS	FED. AID PROJECT		

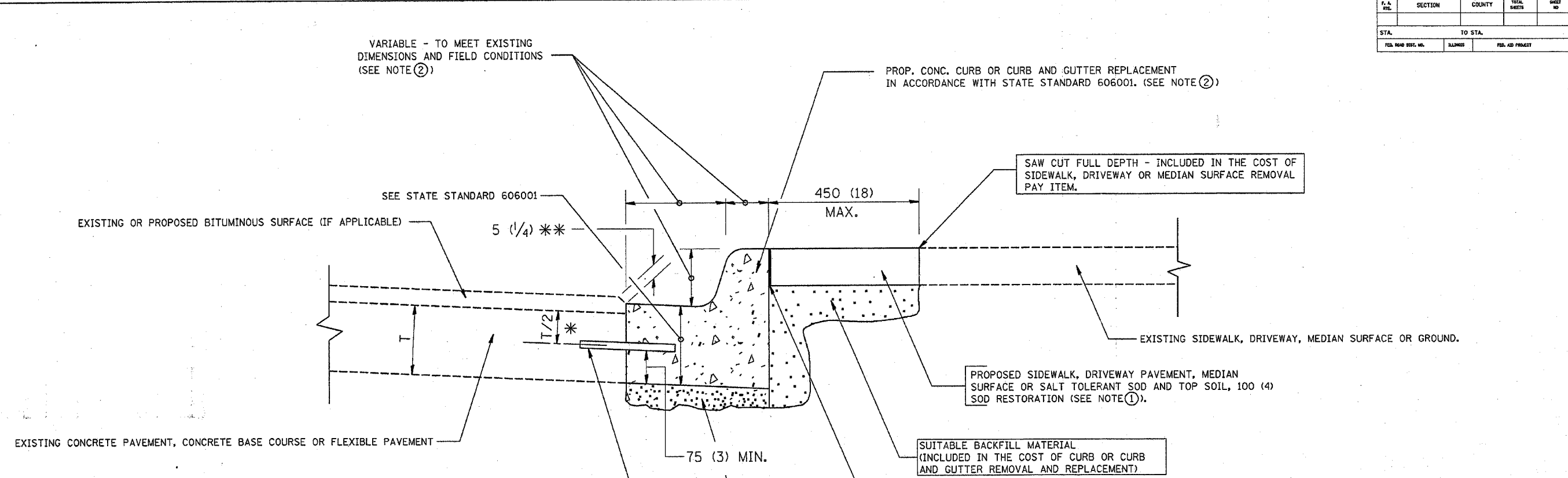

- * 75 (3) MINIMUM FROM TOP AND BOTTOM OF THE CONCRETE PAVEMENT OR BASE COURSE.
- * * IF THE FINAL SURFACE OF THE PAVEMENT IS CONCRETE, THE GUTTER IS TO BE FLUSH WITH THE PAVEMENT.

- NOTE:
- ① SIDEWALK, DRIVEWAY PAVEMENT OR MEDIAN SURFACE SHALL BE SIMILAR TO THE MATERIAL BEING REMOVED AND WILL BE PAID FOR SEPARATELY.
 - ② CURB OR CURB AND GUTTER REPLACEMENT SHALL MATCH THE SHAPE OF THE EXISTING CURB OR CURB AND GUTTER UNLESS OTHERWISE SPECIFIED.
 - ③ FOR CURB OR CURB AND GUTTER REMOVAL AND REPLACEMENT ADJACENT TO FLEXIBLE PAVEMENT DELETE EPOXY COATED TIE BARS.
 - ④ LONGITUDINAL BARS, IF ENCOUNTERED IN THE EXISTING CURB OR CURB AND GUTTER, ARE NOT TO BE REPLACED. CUTTING AND REMOVING LONGITUDINAL BARS SHALL BE INCLUDED IN THE COST OF CURB OR CURB AND GUTTER REMOVAL AND REPLACEMENT.
 - ⑤ THE COST OF BITUMINOUS SURFACE REMOVAL IN THE EXISTING GUTTER FLAG SHALL BE INCLUDED IN THE COST OF THE CURB AND GUTTER REMOVAL AND REPLACEMENT.
 - ⑥ THE REMOVAL AND REPLACEMENT OF THE EXISTING CURB OR CURB AND GUTTER SHALL BE DONE IN ACCORDANCE WITH THE APPLICABLE PORTIONS OF SECTION 440 AND 606 OF THE STANDARD SPECIFICATIONS.
 - ⑦ THE LOCATIONS OF REMOVAL AND REPLACEMENT OF EXISTING CURB OR CURB AND GUTTER SHALL BE DETERMINED BY THE RESIDENT ENGINEER AT THE TIME OF CONSTRUCTION.

SALT TOLERANT SOD AND TOP SOIL, 100 (4) RESTORATION WILL NOT BE PAID FOR SEPARATELY, BUT SHALL BE INCLUDED IN THE COST OF CURB OR CURB AND GUTTER REMOVAL AND REPLACEMENT.

UNSUITABLE SUB-BASE MATERIAL TO BE REMOVED, IF DIRECTED BY THE ENGINEER, SHALL BE REPLACED WITH EITHER SUB-BASE GRANULAR MATERIAL, TYPE B OR ADDITIONAL THICKNESS OF CONCRETE.

REMOVAL AND REPLACEMENT 100 (4) OR LESS IS INCLUDED IN THE COST OF CURB OR CURB AND GUTTER REMOVAL AND REPLACEMENT.

REMOVAL AND REPLACEMENT IN EXCESS OF 100 (4) WILL BE PAID FOR IN ACCORDANCE WITH ARTICLE 109.04 OF THE STANDARD SPECIFICATIONS.

PROPOSED NO. 20 (NO. 6) EPOXY COATED TIE BARS 600 (24) LONG AT 600 (24) CENTERS WILL NOT BE PAID FOR SEPARATELY. DELETE EPOXY COATED TIE BARS IF EXISTING TIE BARS ARE USUABLE AS DETERMINED BY THE ENGINEER. (SEE NOTE 3).

BASIS OF PAYMENT:
THIS WORK WILL BE PAID FOR AT THE CONTRACT UNIT PRICE PER METER (FOOT) FOR "CURB REMOVAL AND REPLACEMENT" OR "COMBINATION CONCRETE CURB AND GUTTER REMOVAL AND REPLACEMENT".

ALL DIMENSIONS ARE IN MILLIMETERS (INCHES) UNLESS OTHERWISE SHOWN.

CURB OR CURB AND GUTTER REMOVAL AND REPLACEMENT

REVISIONS	
NAME	DATE
M. DE YONG	05/28/91
A. HOUSEH	03/11/94
R. SHAH	02/24/95
R. SHAH	03/02/95
R. SHAH	08/19/96
R. SHAH	09/12/96
R. SHAH	09/19/96
R. SHAH	10/03/96
A. ABBAS	03/21/97
M. GOMEZ	01/22/01

ILLINOIS DEPARTMENT OF TRANSPORTATION
CURB OR CURB AND GUTTER REMOVAL AND REPLACEMENT

SCALE: NONE
DATE: 12/04/2002

DRAWN BY: _____
CHECKED BY: _____
DATE: 12/04/2002

REVISION DATE: 12/06/88

REV. NO.	DATE	DESCRIPTION
1	01/27/05	PER IDOT REVIEW
2	02/22/05	PER IDOT REVIEW

CONSULTANTS: _____

DRAWING FILE: BD24EB.DWG PLOTTED BY: MCU 22/FEB/05 08:29

BAXTER & WOODMAN
Consulting Engineers

Baxter & Woodman
Crystal Lake, Illinois 815.459.1280
Burlington, Wisconsin 262.783.7834
Mokena, Illinois 708.478.2090
DeKalb, Illinois 815.787.3111
Crestwood, Illinois 847.223.5088

VILLAGE OF HAZEL CREST, ILLINOIS
183RD STREET PAVEMENT REHABILITATION
EASTBOUND LANES
SECTION NO.: 03-00066-01-RP

183RD STREET
CURB OR CURB AND GUTTER
REMOVAL AND REPLACEMENT

DESIGNED BY	SCALE
MCU	NONE
DRAWN BY	PROJECT NO.
MCU	040631
CHECKED BY	SHEET NO.
IDH	
DATE	
7/07/04	11 OF 11

12/04/2002
whf12101/bt24.dwg
VH-BD24