

ROUTE NO.	SECTION	COUNTY	TOTAL SHEETS	SHEET NO.
162P	03-00066-01-RP	COOK	11	8
ILLINOIS PROJECT:				
CONTRACT NUMBER - 03778				
F.A. NO.	SECTION	COUNTY	TOTAL SHEETS	SHEET NO.
STA.		TO STA.		
FED. ROAD DIST. NO.	ILLINOIS	FED. AID PROJECT		

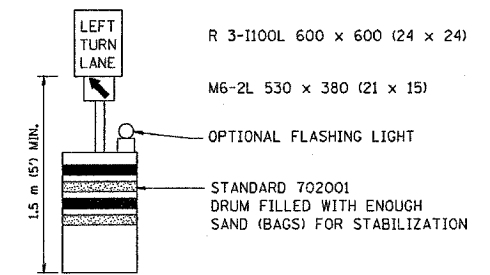
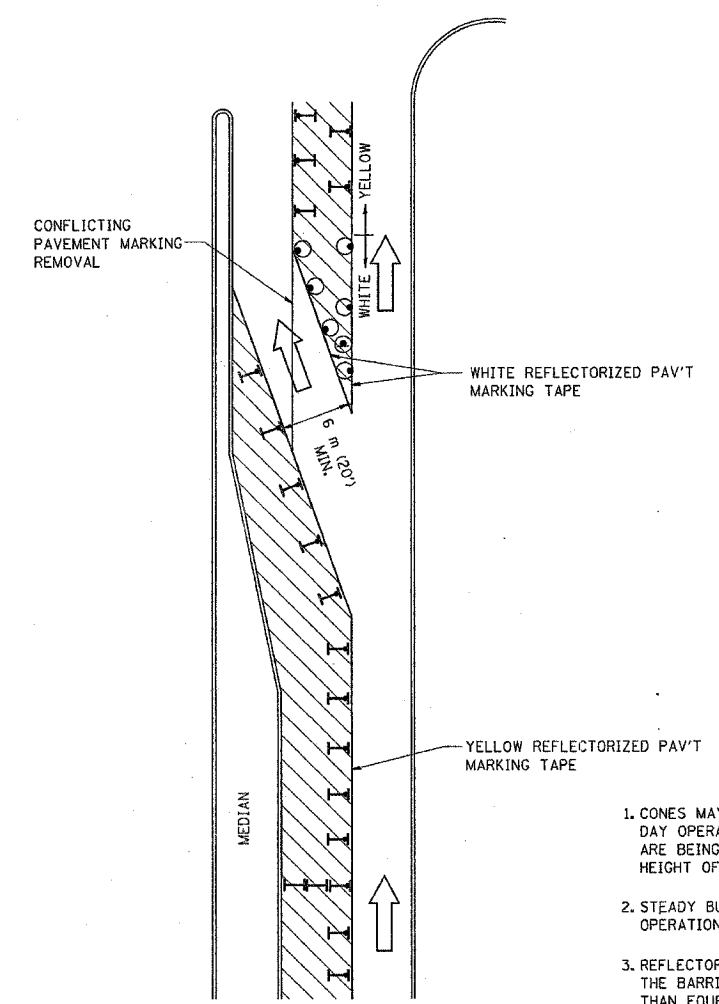

**GENERAL NOTES**

1. CONES MAY BE SUBSTITUTED FOR BARRICADES OR DRUMS AT HALF THE SPACING DURING DAY OPERATIONS. CONES SHALL BE A MINIMUM OF 710 (28) IN HEIGHT. WHEN CONES ARE BEING USED, THE "LEFT TURN LANE" SIGN MAY BE SKID MOUNTED AT A MINIMUM HEIGHT OF 1.5 m (5').
2. STEADY BURNING LIGHTS WILL NOT BE REQUIRED ON BARRICADES OR DRUMS FOR DAY OPERATIONS. ALL LIGHTS SHALL BE MONODIRECTIONAL.
3. REFLECTORIZED TEMPORARY PAVEMENT MARKING TAPE SHALL BE PLACED THROUGHOUT THE BARRICADED AREA OF EACH TURN BAY WHERE THE CLOSURE TIME IS GREATER THAN FOURTEEN DAYS.
4. THIS APPLICATION ALSO APPLIES WHEN WORK IS BEING PERFORMED IN THE RIGHT LANE(S) AND THE RIGHT TURN BAY IS TO REMAIN OPEN. UNDER THIS CONDITION, "RIGHT TURN LANE" R3-100 600 x 600 (24 x 24) AND M6-2R 530 x 380 (21 x 15) SHALL BE USED.
5. THESE CONTROLS SHALL SUPPLEMENT MAINLINE TRAFFIC CONTROL FOR LANE CLOSURES.
6. LONGITUDINAL DIMENSIONS MAY BE ADJUSTED TO FIT FIELD CONDITIONS.
7. FORM BT 725 IS REQUIRED.
8. TRAFFIC CONTROL AND PROTECTION AT TURN BAYS (TO REMAIN OPEN TO TRAFFIC) SHALL BE INCLUDED IN THE COST SPECIFIED TRAFFIC CONTROL STANDARDS OR ITEMS.

**LEGEND**

- WORK AREA
- LANE OPEN TO TRAFFIC
- TYPE I OR II BARRICADE WITH STEADY BURN LIGHT
- DRUM WITH STEADY BURN LIGHT
- DRUM WITH SIGN (WITH OPTIONAL FLASHING LIGHT) SEE DETAIL
- TYPE I OR II CHECK BARRICADE WITH FLASHING LIGHT

All dimensions are in millimeters (inches) unless otherwise shown.

ILLINOIS DEPARTMENT OF TRANSPORTATION

**TRAFFIC CONTROL AND PROTECTION AT TURN BAYS (TO REMAIN OPEN TO TRAFFIC)**

SCALE: NONE  
DATE: 11/20/01

DRAWN BY: LHA  
CHECKED BY: LHA

REVISIONS	
NAME	DATE
T. RAMMACHER	09/08/94
A. HOUSEH	11/07/95
A. HOUSEH	10/12/96
T. RAMMACHER	01/06/00

TC-14

COPYRIGHT © 2005 BY BAXTER & WOODMAN, INC.  
 STATE OF ILLINOIS - PROFESSIONAL ENGINEERING  
 LICENSE NO. 128-00171 EXPIRES 4/30/2008

Tue Nov 20 16:08:53 2001  
 \\jicadd1\projects\diststd\tcl4.dgn LV=35  
 V1=TC14

CONSULTANTS	REV. NO.	DATE	DESCRIPTION
	1	01/27/05	PER IDOT REVIEW
	2	02/22/05	PER IDOT REVIEW

DRAWING FILE: TC14EB.DWG PLOTTED BY: MCU 22/FEB/05 08:30



**Baxter & Woodman**  
 Crystal Lake, Illinois 815.459.1280  
 Burlington, Wisconsin 262.763.7834  
 Mokena, Illinois 708.478.2090  
 DeKalb, Illinois 815.787.3111  
 Grayslake, Illinois 847.223.6088

**VILLAGE OF HAZEL CREST, ILLINOIS**  
**183RD STREET PAVEMENT REHABILITATION**  
**EASTBOUND LANES**  
**SECTION NO.: 03-00066-01-RP**

**183RD STREET**  
**TRAFFIC CONTROL**  
**AND PROTECTION**

DESIGNED BY	SCALE
MCU	NONE
DRAWN BY	PROJECT NO.
MCU	040631
CHECKED BY	SHEET NO.
LDH	
DATE	
7/07/04	<b>8 OF 11</b>