

FA ROUTE NO.	SECTION	COUNTY	TOTAL SHEETS	SHEET NO.
1622	03-00066-01-RP	COOK	11	5
ILLINOIS PROJECT:				
CONTRACT NUMBER: 83778				

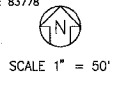

SCALE 1" = 50'

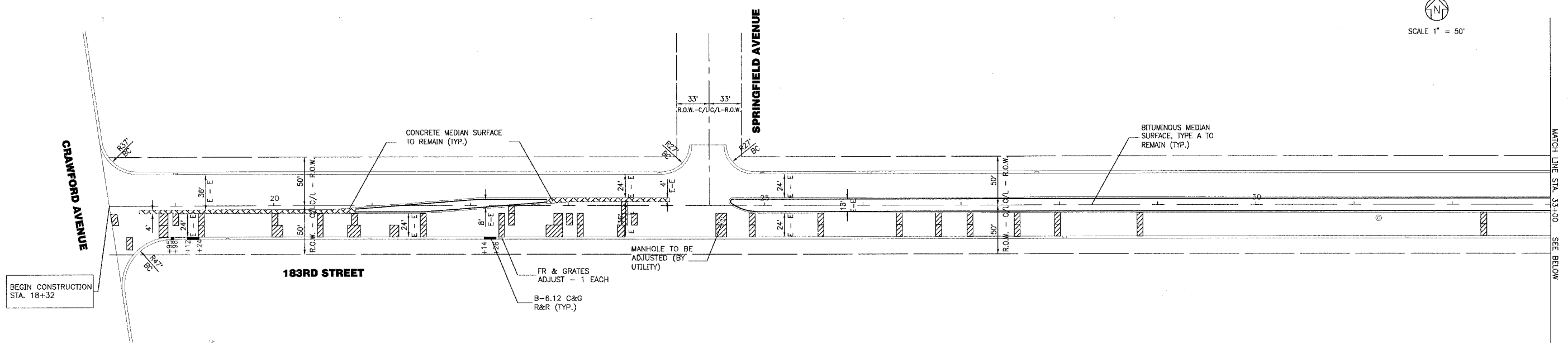

CURB REMOVAL AND PATCH STATIONS ARE APPROXIMATE. FINAL QUANTITIES WILL BE MARKED IN THE FIELD AND MEASURED BY THE ENGINEER.

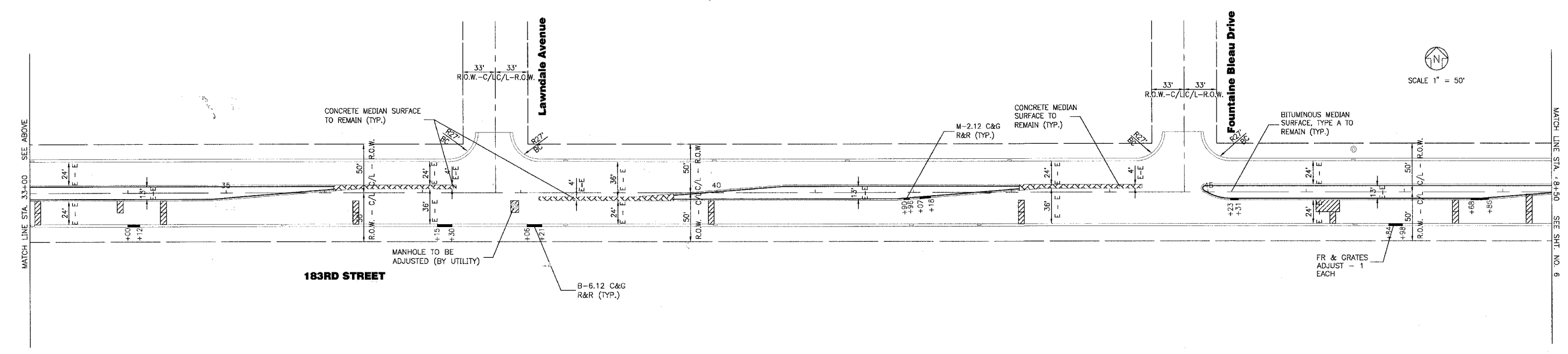

COPYRIGHT © 2005, BY DEXTER & WOODMAN, INC.
 STATE OF ILLINOIS - PROFESSIONAL ENGINEERING
 LICENSE NO. 130-0712 EXP. 01/30/2008

CONSULTANTS	REV. NO.	DATE	DESCRIPTION
	1	01/27/05	PER IDOT REVIEW
	2	02/22/05	PER IDOT REVIEW

DRAWING FILE: 183RDHAZELPATCHED-REV1 PLOTTED BY: MCU 22/FEB/05 08:26

BAXTER & WOODMAN
 Consulting Engineers

Baxter & Woodman
 Crystal Lake, Illinois 815.459.1280
 Burlington, Wisconsin 262.783.7834
 Mokena, Illinois 708.478.2090
 DeKalb, Illinois 815.787.3111
 Grayslake, Illinois 847.223.5088

VILLAGE OF HAZEL CREST, ILLINOIS
183RD STREET PAVEMENT REHABILITATION
EASTBOUND LANES
SECTION NO.: 03-00066-01-RP

183RD STREET
STA. 18+32 TO STA. 48+50
GEOMETRIC PLAN

DESIGNED BY	SCALE
MCU	1"=50'
DRAWN BY	PROJECT NO.
MCU	040631
CHECKED BY	SHEET NO.
LDH	
DATE	
7/07/04	5 OF 11