

F.A. RTE.	SECTION	COUNTY	TOTAL SHEETS	SHEET NO.
600	5IRS-3	•	347	302

STA.	TO STA.
137	136
136	135
135	134

CONTRACT : 76563 ILLINOIS FED. AID PROJECT

FINAL SURVEY	DATE
BY	
REVIEWED	
PLOTTED	
NOTE BOOK	
AREAS CHECKED	

ORIGINAL SURVEY	DATE
BY	
REVIEWED	
PLOTTED	
NOTE BOOK	
AREAS CHECKED	

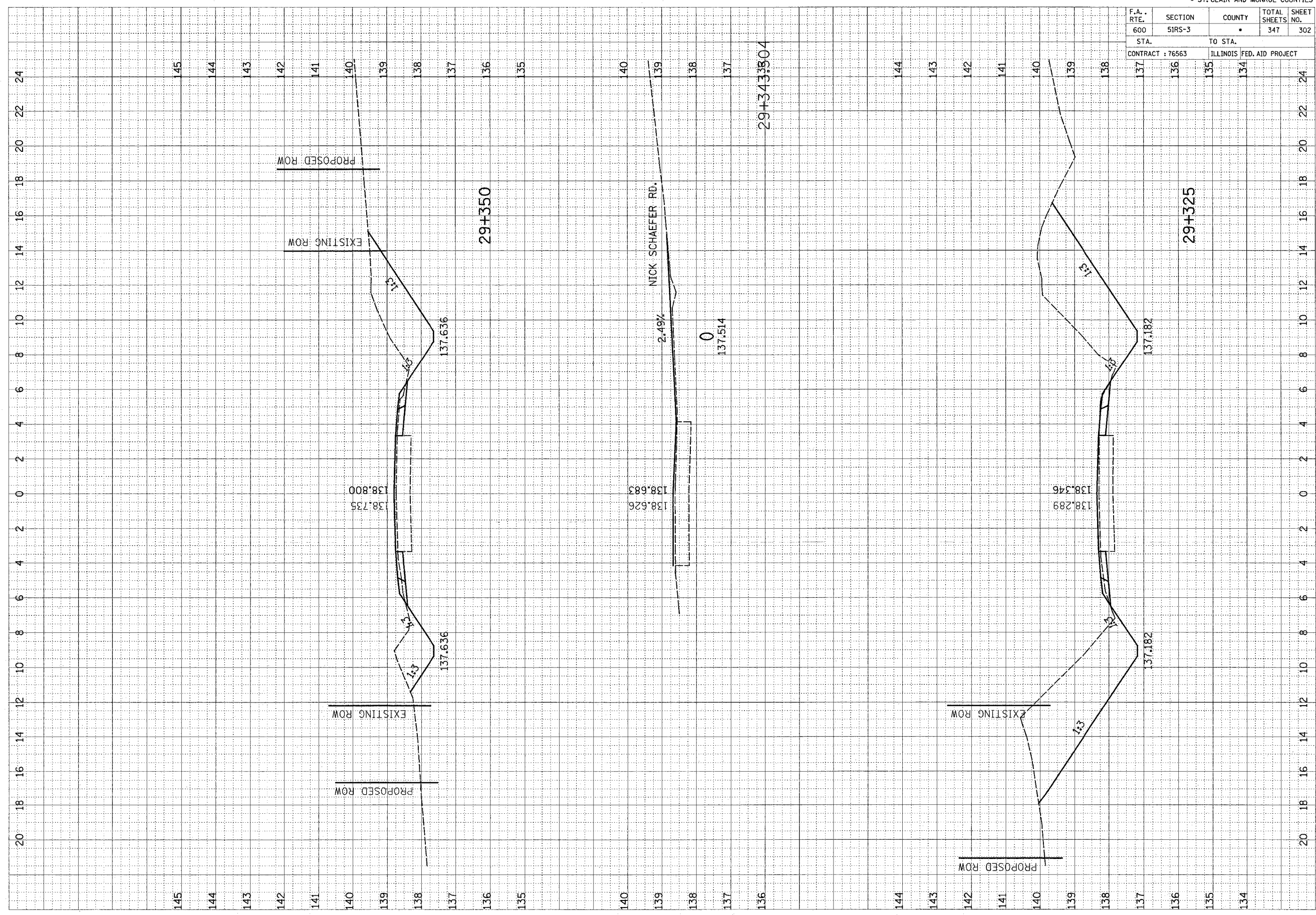

29+3433504

0
137.514

29+325

PROPOSED ROW

PROPOSED ROW

EXISTING ROW

PROPOSED ROW

EXISTING ROW

NICK SCHAEFER RD.

2.49%

29+350

137.636

137.636

138.735
138.800

138.626
138.683

138.289
138.346

137.182

137.182

143

143

143

143

143

143

145

145

144

144

143

143

142

142

141

141

140

140

139

139

138

138

137

137

136

136

135

135

140

140

139

139

138

138

137

137

136

136

144

144

143

143

142

142

141

141

140

140

139

139

138

138

137

137

136

136

135

135

134

134

20

24

18

16

14

12

10

8

6

4

2

0

2

4

6

8

10

12

14

16

18

20

22

24