

teasleyck  
2/7/2005  
ct:\projects\74049d\03004pa.dgn

74049

FAP RTE.	SECTION	COUNTY	TOTAL SHEETS	SHEET NO.
781	(1Z,17Z)RS-2	CRAWFORD	14	1

SEE SHEET 2 FOR INDEX OF SHEETS

STATE OF ILLINOIS  
DEPARTMENT OF TRANSPORTATION  
DIVISION OF HIGHWAYS

PLANS FOR PROPOSED  
FEDERAL HIGHWAY PROJECT

FAP ROUTE 781 (IL 33)  
SECTION (1Z, 17Z)RS-2  
PROJECT NO. F-0781-(026)  
CRAWFORD COUNTY

D-97-030-04

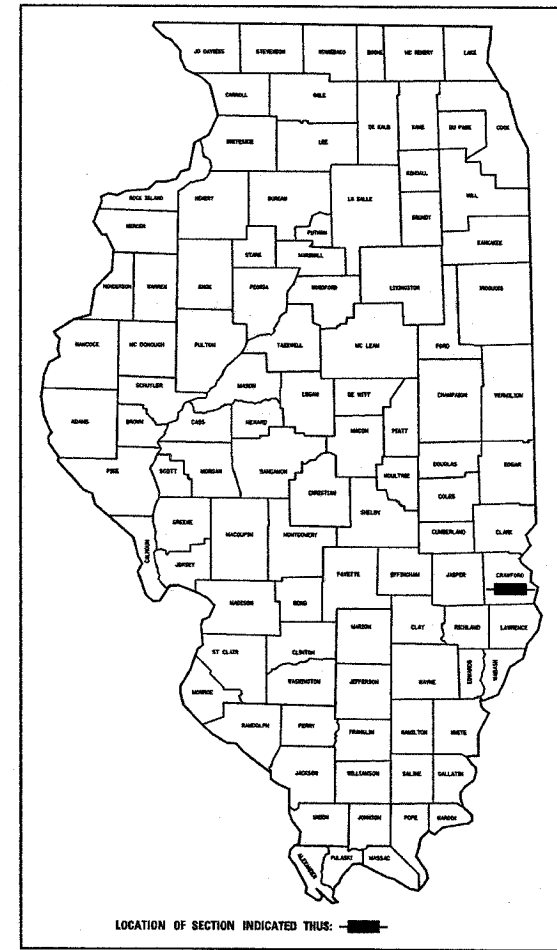

LOCATION OF SECTION INDICATED THUS: [shaded box]

STATION EQUATIONS  
STA. 1191+01.00 (BK) = STA. 0+00.00 (AH)

C-97-067-04

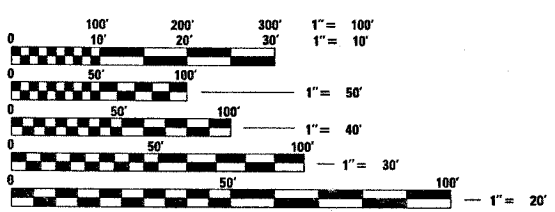

FULL SIZE PLANS HAVE BEEN PREPARED USING STANDARD ENGINEERING SCALES, REDUCED SIZED PLANS WILL NOT CONFORM TO STANDARD SCALES, IN MAKING MEASUREMENTS ON REDUCED PLANS, THE ABOVE SCALES MAY BE USED.

J.U.L.I.E.  
JOINT UTILITY LOCATION INFORMATION FOR EXCAVATION  
1-800-892-0123

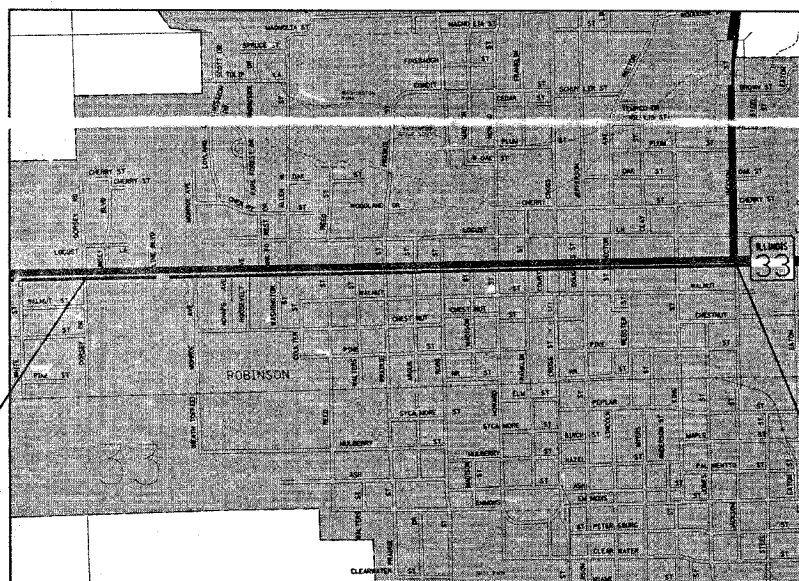

FAP ROUTE 781 (IL 33)  
SECTION (1Z, 17Z)RS-2  
CRAWFORD COUNTY  
PROJECT BEGINS  
STA. 1164+40



FAP ROUTE 781 (IL 33)  
SECTION (1Z, 17Z)RS-2  
CRAWFORD COUNTY  
PROJECT ENDS  
STA. 19+47

STATE OF ILLINOIS  
DEPARTMENT OF TRANSPORTATION  
DIVISION OF HIGHWAYS

SUBMITTED Feb 8 20 05  
Christ H. Reed  
DISTRICT ENGINEER

ENGINEER OF PROJECT DEVELOPMENT AND IMPLEMENTATION  
March 25, 2005  
Mike Line  
ENGINEER OF DESIGN AND ENVIRONMENT

March 25, 2005  
Victor Maden  
DIRECTOR, DIVISION OF HIGHWAYS

CONTRACT NO. 74049

ADT (2003) - 12000

TOWNSHIP : ROBINSON

GROSS LENGTH = 4608.0 FEET = 0.87 MILES  
NET LENGTH = 4608.0 FEET = 0.87 MILES

SEAL

PRINTED BY THE AUTHORITY OF  
THE STATE OF ILLINOIS

Rev-

PROJECT ENGINEER : BILL STANLEY  
SQUAD LEADER : JENNIFER WENTHE  
DESIGNER : JENNIFER WENTHE  
TELEPHONE : 217/342-3951 EX 361

-USERNAME-  
5/6/2005  
c:\projects\74049d\c03004pa.dgn

FAP NO.	SECTION	COUNTY	TOTAL SHEETS	SHEET NO.
781	(12,17)RS-2	CRAWFORD	14	2

CONTRACT NO. 14049

**GENERAL NOTES**

THIS SECTION SHALL BE CONSTRUCTED IN ACCORDANCE WITH THE PLANS, THE "STANDARD SPECIFICATIONS FOR ROAD AND BRIDGE CONSTRUCTION", ADOPTED JANUARY 1, 2002; THE "SUPPLEMENTAL SPECIFICATIONS AND RECURRING SPECIAL PROVISIONS" ADOPTED MARCH 1, 2005, AND THE "SPECIAL PROVISIONS" INCLUDED IN THE PROPOSAL.

THIS PROJECT IS LOCATED ON ILLINOIS ROUTE 33 IN CRAWFORD COUNTY, FROM DORSEY DRIVE TO HOWARD STREET IN ROBINSON. THE WORK INCLUDED IN SECTION (12,17)RS-2 CONSISTS OF PAVEMENT PATCHING, MILLING, BITUMINOUS RESURFACING, PAVEMENT MARKING, AND ANY OTHER WORK NECESSARY TO COMPLETE THE JOB.

THE PERMANENT SURVEY MARKERS AT STATIONS 1167+00 AND 1178+00 SHALL BE PROTECTED AND PRESERVED. IF THE EXISTING SURVEY MARKERS ARE DISTURBED IT IS THE CONTRACTORS RESPONSIBILITY TO HAVE THEM RESET BY A REGISTERED PROFESSIONAL LAND SURVEYOR WITH NO ADDITIONAL COMPENSATION.

THE REMOVAL OF THE EXISTING RESURFACING IN THE GUTTER FLAG SHALL BE (PAID FOR AS) INCLUDED IN THE COST OF BITUMINOUS SURFACE REMOVAL 1 1/2".

PAVEMENT MARKING SHALL BE APPLIED IN ACCORDANCE WITH SECTION 780 OF THE STANDARD SPECIFICATIONS. SHORT TERM PAVEMENT MARKING SHALL BE APPLIED TO THE MILLED SURFACE, BITUMINOUS MATERIALS (PRIME COAT), LEVEL BINDER, AND BITUMINOUS SURFACE COURSE AS SPECIFIED IN SECTION 703 OF THE STANDARD SPECIFICATIONS. TEMPORARY TAPE SHALL BE USED ON THE SURFACE COURSE AND PAINT SHALL BE USED ON MILLED SURFACES.

THE TOTAL QUANTITY OF THERMOPLASTIC PAVEMENT MARKING - LINE 4" CONSISTS OF 11783 FEET OF YELLOW.

THE TOTAL QUANTITY OF THERMOPLASTIC PAVEMENT MARKING - LINE 6" CONSISTS OF 740 FEET OF WHITE.

THE TOTAL QUANTITY OF THERMOPLASTIC PAVEMENT MARKING - LINE 12" CONSISTS OF 168 FEET OF YELLOW.

THE TOTAL QUANTITY OF THERMOPLASTIC PAVEMENT MARKING - LINE 24" CONSISTS OF 59 FEET OF WHITE.

THE TOTAL QUANTITY OF THERMOPLASTIC PAVEMENT MARKING - LETTERS AND SYMBOLS CONSISTS OF 352 SQ FT OF WHITE.

EXISTING PAVEMENT SHALL BE PATCHED IN ACCORDANCE WITH SECTION 442 OF THE STANDARD SPECIFICATIONS AND THE SPECIAL PROVISIONS. THE QUANTITY OF PATCHING SHOWN ON THE PLANS IS AN ESTIMATE ONLY. THE FINAL LOCATIONS AND QUANTITY SHALL BE DETERMINED BY THE ENGINEER IN THE FIELD.

THE CONTRACTOR SHALL PROVIDE INTERNET ACCESSIBILITY TO THE BITUMINOUS PLANT QUALITY CONTROL LAB SO THAT BITUMINOUS PLANT REPORTS CAN BE E-MAILED TO THE DISTRICT HEADQUARTERS. THIS WORK SHALL BE INCLUDED IN THE COST OF ALL BITUMINOUS ITEMS.

THE CONTRACTOR SHALL USE EITHER RC-70 OR AN EMULSIFIED POLYMER PRIME SS-1HP FOR THE PAY ITEM BITUMINOUS MATERIALS (PRIME COAT).

A UNIFORMLY STRAIGHT SAW CUT SHALL BE MADE AT LOCATIONS WHERE PROPOSED NEW CONSTRUCTION WILL ABUT EXISTING BITUMINOUS CONCRETE SURFACES. THE SAW CUT SHALL BE MADE FULL DEPTH THROUGH THE EXISTING SURFACE. THIS WORK WILL BE CONSIDERED INCLUDED IN THE COST OF THE CONTRACT ITEMS INVOLVED AND NO EXTRA COMPENSATION WILL BE ALLOWED.

THE PAY ITEM TEMPORARY RAMP HAS BEEN INCLUDED FOR THE CONSTRUCTION OF TEMPORARY RAMPS IN ACCORDANCE WITH ARTICLE 406.18 OF THE STANDARD SPECIFICATIONS. THE COST SHALL INCLUDE BOTH THE INSTALLATION AND THE REMOVAL OF THE TEMPORARY RAMPS.

THE FOLLOWING MIXTURE REQUIREMENTS ARE APPLICABLE FOR THIS PROJECT:

MIXTURE USE:	SURFACE COURSE	CLASS D PATCHING
PG GRADE:	PG 64-22	PG 64-22
RAP%:	10%	25%
DESIGN AIR VOIDS:	4% @ NDESIGN = 90	4% @ NDESIGN = 70
MIXTURE COMPOSITION:	IL-9.5	IL-19.0
FRICTION AGGREGATE:	MIXTURE D	N/A

THE FOLLOWING RATES OF APPLICATION HAVE BEEN USED IN THE CALCULATION OF PLAN QUANTITIES:

BITUMINOUS MATERIALS (PRIME COAT)	0.10 GAL/SQ YD
AGGREGATE (PRIME COAT)	4 LBS/SQ YD
BITUMINOUS CONCRETE	112 LBS/SQ YD/INCH

**INDEX OF SHEETS**

SHEET NO.	ITEM
1	COVER SHEET
2	INDEX OF SHEETS AND GENERAL NOTES
3	SUMMARY OF QUANTITIES
4	TYPICAL SECTIONS
5	SCHEDULES
6-14	PLAN SHEETS
14	PAVEMENT MARKING DETAIL

THE FOLLOWING STANDARDS ARE A PART OF THESE PLANS AND ARE INCLUDED AFTER SHEET NO. 14:

STD. NO.	DESCRIPTION
000001-04	STANDARD SYMBOLS, ABBREVIATIONS AND PATTERNS
442201-01	CLASS C AND D PATCHES
701311-02	LANE CLOSURE 2L, 2W MOVING OPERATIONS - DAY ONLY
701501-03	URBAN LANE CLOSURE 2L, 2W UNDIVIDED
701502-01	URBAN LANE CLOSURE 2L, 2W WITH BIDIRECTIONAL LEFT TURN LANE
702001-05	TRAFFIC CONTROL DEVICES
780001-01	TYPICAL PAVEMENT MARKINGS
781001-02	TYPICAL APPLICATIONS RAISED REFLECTIVE PAVEMENT MARKERS

REVISIONS	
NAME	DATE

ILLINOIS DEPARTMENT OF TRANSPORTATION  
**GENERAL NOTES  
&  
INDEX OF SHEETS**

SCALE: VERT. \_\_\_\_\_  
HORIZ. \_\_\_\_\_  
DATE \_\_\_\_\_ DRAWN BY \_\_\_\_\_  
CHECKED BY \_\_\_\_\_

Revised 5-9-05

-USERNAME -  
5/6/2005  
c:\projects\74049d\403004pa.dgn

FAP SITE	SECTION	COUNTY	TOTAL SHEETS	SHEET NO.
781	(12,17Z)RS-2	CRAWFORD	14	3
FED. ROAD DIST. NO. 7	ILLINOIS	FED. AID PROJECT NO.		
CONTRACT NO. 74049				

SUMMARY OF QUANTITIES			80% FED / 20% STATE CONSTRUCTION TYPE CODE			
CODE NO	ITEM	UNIT	TOTAL QUANTITIES	_URBAN_ _1000_	-----	-----
40600100	BITUMINOUS MATERIALS (PRIME COAT)	GALLON	2114	2114		
40600300	AGGREGATE (PRIME COAT)	TON	42	42		
40600990	TEMPORARY RAMP	SQ YD	40	40		
44000006	BITUMINOUS SURFACE REMOVAL 1 1/2"	SQ YD	21137	21137		
44201771	CLASS D PATCHES, TYPE IV, 10 INCH	SQ YD	92	92		
67000500	ENGINEER'S FIELD OFFICE, TYPE B	CAL MO	3	3		
67100100	MOBILIZATION	L SUM	1	1		
70102620	TRAFFIC CONTROL AND PROTECTION, STANDARD 701501	L SUM	1	1		
70102622	TRAFFIC CONTROL AND PROTECTION, STANDARD 701502	L SUM	1	1		
70300100	SHORT-TERM PAVEMENT MARKING	FOOT	2096	2096		
70300210	TEMPORARY PAVEMENT MARKING - LETTERS AND SYMBOLS	SQ FT	352	352		
70300220	TEMPORARY PAVEMENT MARKING - LINE 4"	FOOT	11783	11783		
70300240	TEMPORARY PAVEMENT MARKING - LINE 6"	FOOT	740	740		
70300260	TEMPORARY PAVEMENT MARKING - LINE 12"	FOOT	168	168		
70300280	TEMPORARY PAVEMENT MARKING - LINE 24"	FOOT	59	59		
70301000	WORK ZONE PAVEMENT MARKING REMOVAL	SQ FT	349	349		
* 78000100	THERMOPLASTIC PAVEMENT MARKING - LETTERS AND SYMBOLS	SQ FT	352	352		
* 78000200	THERMOPLASTIC PAVEMENT MARKING - LINE 4"	FOOT	11783	11783		
* 78000400	THERMOPLASTIC PAVEMENT MARKING - LINE 6"	FOOT	740	740		
* 78000600	THERMOPLASTIC PAVEMENT MARKING - LINE 12"	FOOT	168	168		
* 78000650	THERMOPLASTIC PAVEMENT MARKING - LINE 24"	FOOT	59	59		
* 78100100	RAISED REFLECTIVE PAVEMENT MARKER	EACH	248	248		
X4066428	BITUMINOUS CONCRETE SURFACE COURSE, SUPERPAVE, MIX "D", N90	TON	1776	1776		

\* SPECIALTY ITEMS

REVISIONS	
NAME	DATE

ILLINOIS DEPARTMENT OF TRANSPORTATION

**SUMMARY  
OF  
QUANTITIES**

SCALE: VERT.  
HORIZ.  
DATE

DRAWN BY  
CHECKED BY

-USERNAME-  
5/6/2005  
c:\projects\74049d\403004pa.dgn

TYP

FAP NO.	SECTION	COUNTY	TOTAL SHEETS	SHEET NO.
781	(12,172)RS-2	CRAWFORD	14	4
FED. ROAD DIST. NO. 7	ILLINOIS	FED. AID PROJECT NO.		
CONTRACT NO. 74049				

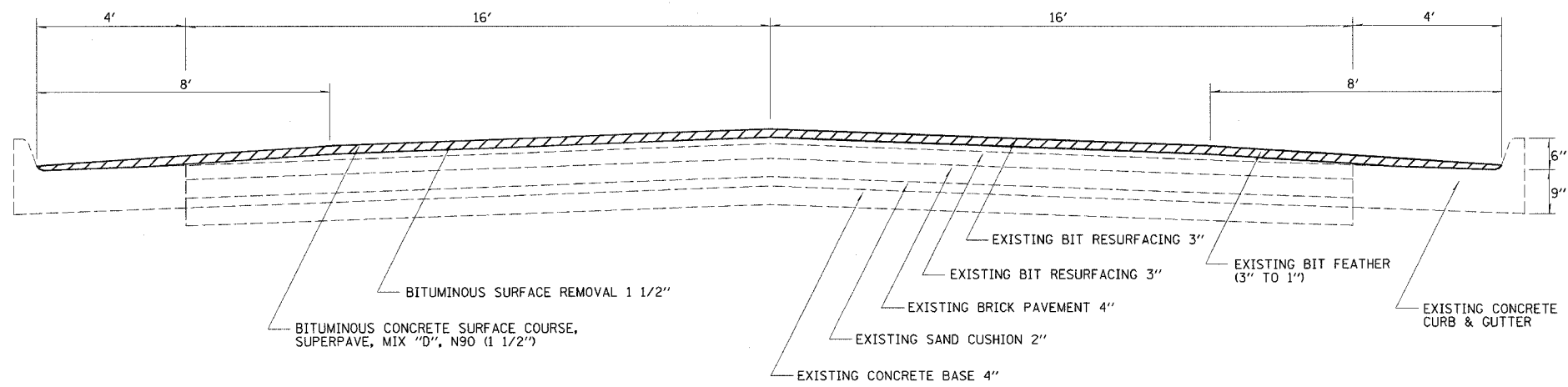
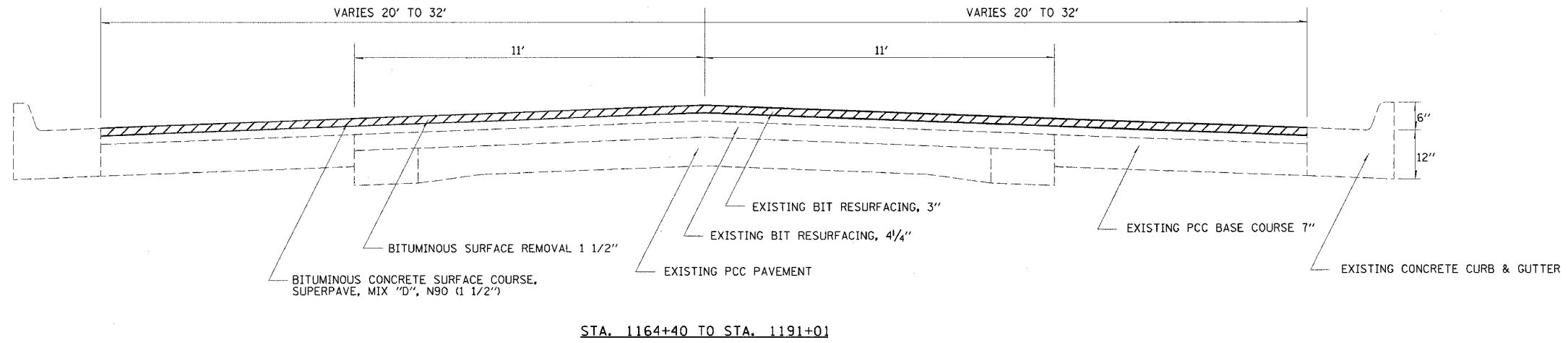

REVISIONS	
NAME	DATE

ILLINOIS DEPARTMENT OF TRANSPORTATION

**TYPICAL SECTIONS**

SCALE: VERT. DATE  
HORIZ. DRAWN BY  
CHECKED BY

REVISED 5-9-05

USERNAME: 5/6/2005  
 c:\projects\74049d\03004pa.dgn

SCHE

FAP RTE.	SECTION	COUNTY	TOTAL SHEETS	SHEET NO.
781	(12,17Z)RS-2	CRAWFORD	14	5
FED. ROAD DIST. NO. 7	ILLINOIS	FED. AID PROJECT NO.		

CONTRACT NO. 14049

RESURFACING SCHEDULE

STATION TO STATION	LENGTH	AVERAGE PAVEMENT WIDTH	AREA	BITUMINOUS MATERIALS (PRIME COAT)	AGGREGATE (PRIME COAT)	BITUMINOUS CONCRETE SURFACE COURSE, SUPERPAVE MIX "D", N90	BITUMINOUS SURFACE REMOVAL, 1 1/2"	TEMPORARY RAMP
	FOOT	FOOT	SQ YD	GALLON	TON	TON	SQ YD	SQ YD
1164+40.00 TO 1166+35.00	195.0	40.0	866.7	86.7	1.7	72.8	866.7	22.2
1166+35.00 TO 1170+90.00	455.0	45.5	2300.3	230.0	4.6	193.2	2300.3	
1170+90.00 TO 1173+15.00	225.0	51.0	1275.0	127.5	2.6	107.1	1275.0	
1173+15.00 TO 1175+15.00	200.0	57.0	1266.7	126.7	2.5	106.4	1266.7	
1175+15.00 TO 1175+82.00	67.0	63.0	469.0	46.9	0.9	39.4	469.0	
1175+82.00 TO 1176+72.00	90.0	57.0	570.0	57.0	1.1	47.9	570.0	
1176+72.00 TO 1180+10.00	338.0	51.0	1915.3	191.5	3.8	160.9	1915.3	
1180+10.00 TO 1183+96.00	386.0	43.5	1865.7	186.6	3.7	156.7	1865.7	
1183+96.00 TO 1191+01.00	705.0	36.0	2820.0	282.0	5.6	236.9	2820.0	
1191+01.00 BK=0+00.00 AH 0+00.00 TO 19+47.00	1947.0	36.0	7788.0	778.8	15.6	654.2	7788.0	17.8
TOTALS	4608.0		21137.0	2114.0	42.0	1776.0	21137.0	40.0

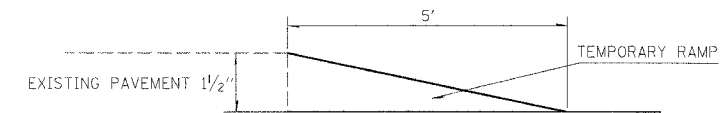

TEMPORARY RAMP DETAIL  
 STA 1164+40 TO STA 1164+45  
 STA 19+42 TO STA 19+47

PAVEMENT MARKING SCHEDULE

STATION TO STATION	LENGTH	THERMOPLASTIC PAVEMENT MARKING - LETTERS AND SYMBOLS		THERMOPLASTIC PAVEMENT MARKING - LINE 4"		THERMOPLASTIC PAVEMENT MARKING - LINE 6"		THERMOPLASTIC PAVEMENT MARKING - LINE 12"		THERMOPLASTIC PAVEMENT MARKING - LINE 24"		TEMPORARY PAVEMENT MARKING - LETTERS AND SYMBOLS		TEMPORARY PAVEMENT MARKING - LINE 4"		TEMPORARY PAVEMENT MARKING - LINE 6"		TEMPORARY PAVEMENT MARKING - LINE 12"		TEMPORARY PAVEMENT MARKING - LINE 24"		SHORT-TERM PAVEMENT MARKING	WORK ZONE PAVEMENT MARKING REMOVAL	RAISED REFLECTIVE PAVEMENT MARKER	
		FOOT	SQ FT	FOOT	FOOT	FOOT	FOOT	SQ FT	FOOT	FOOT	FOOT	FOOT	FOOT	FOOT	FOOT	FOOT	FOOT	FOOT	FOOT	FOOT	FOOT	FOOT	FOOT	SQ FT	EACH
1164+40.00 TO 1170+90.00	650.0	52.8	1625.0					52.8	1625.0														256.0	42.7	32.0
1170+90.00 TO 1173+50.00	260.0	17.6	650.0	65.0				17.6	650.0	65.0													168.0	28.0	17.0
1173+50.00 TO 1175+15.00	165.0		412.5	82.5					412.5	82.5													128.0	21.3	10.0
1175+15.00 TO 1175+80.00	65.0	35.2	162.5	81.3				35.2	162.5	81.3													64.0	10.7	7.0
1175+80.00 TO 1180+10.00	430.0	17.6	1075.0	107.5				17.6	1075.0	107.5													264.0	44.0	27.0
1180+10.00 TO 1183+96.00	386.0	35.2	965.0					35.2	965.0														160.0	26.7	20.0
1183+96.00 TO 1185+55.00	159.0		664.0		62.0				664.0		62.0												64.0	10.7	8.0
1185+55.00 TO 1185+65.00	10.0		20.0						20.0																
1185+65.00 TO 1186+40.00	75.0	17.6	150.0	75.0		25.0		17.6	150.0	75.0		25.0											32.0	5.3	6.0
1186+40.00 TO 1187+37.00	97.0			73.0		11.0				73.0		11.0											32.0	5.3	
1187+37.00 TO 1188+18.00	81.0		364.0		47.0				364.0		47.0												64.0	10.7	12.0
1188+18.00 TO 1188+92.00	74.0	17.6	148.0					17.6	148.0																
1188+92.00 TO 1190+51.00	159.0		397.5						397.5														64.0	10.7	8.0
1190+51.00 TO 1191+01.00	50.0	17.6	125.0					17.6	125.0														16.0	2.7	2.0
1191+01.00 BK=0+00.00 AH 0+00.00 TO 16+71.00	1671.0	123.2	4177.5	86.0				123.2	4177.5	86.0													672.0	112.0	84.0
16+71.00 TO 18+20.00	149.0		627.0		59.0				627.0		59.0												64.0	10.7	8.0
18+20.00 TO 18+30.00	10.0		20.0						20.0																
18+30.00 TO 19+30.00	100.0	17.6	200.0	100.0		23.0		17.6	200.0	100.0		23.0											48.0	8.0	9.0
19+30.00 TO 19+47.00	17.0			70.0						70.0															
TOTALS		352.0	11783.0	740.0	168.0	59.0	352.0	11783.0	740.0	168.0	59.0	2096.0	349.0	248.0											

CLASS D PATCHING SCHEDULE

LOCATION	LANE	LENGTH	WIDTH	CLASS D PATCHES, TYPE IV, 10 INCH
		FOOT	FOOT	
1188+55	EB	110.0	7.5	91.7
TOTAL =				92.0

REVISIONS	
NAME	DATE

ILLINOIS DEPARTMENT OF TRANSPORTATION

SCHEDULES

SCALE: VERT. HORIZ.  
 DATE DRAWN BY CHECKED BY

\_USERNAME -  
 5/6/2005  
 c:\projects\74049d\03004pa.dgn  
 PS 5

FAP ATE	SECTION	COUNTY	TOTAL SHEETS	SHEET NO.
781	(12,17)RS-2	CRAWFORD	14	6
FED. ROAD DIST. NO. 7	ILLINOIS	FED. AID PROJECT NO.	CONTRACT NO. 14049	

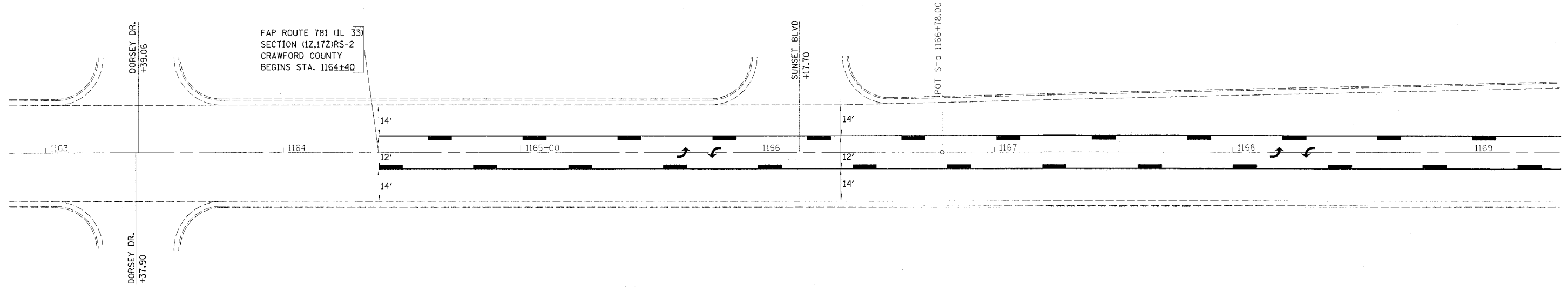

REVISIONS	
NAME	DATE

ILLINOIS DEPARTMENT OF TRANSPORTATION  
**STA 1163+00 TO  
 STA 1169+00**  
 SCALE: VERT.  
 HORIZ.  
 DATE  
 DRAWN BY  
 CHECKED BY

REVISED 5-9-05

-USERNAME-  
5/6/2005  
c:\projects\74049d\03004pa.dgn

PS 6



FAP RTE.	SECTION	COUNTY	TOTAL SHEETS	SHEET NO.
781	(12,17Z)RS-2	CRAWFORD	14	7
FED. ROAD DIST. NO. 7	ILLINOIS	FED. AID PROJECT NO.	CONTRACT NO. 74049	

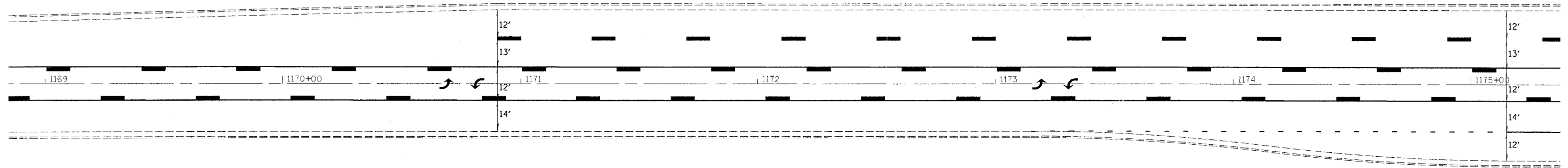

REVISIONS	
NAME	DATE

ILLINOIS DEPARTMENT OF TRANSPORTATION

**STA 1169 + 00 TO  
STA 1175 + 00**

SCALE: VERT.  
HORIZ.  
DATE

DRAWN BY  
CHECKED BY

REVISED 5-9-05

-USERNAME-  
 5/6/2005  
 c:\projects\74049d\403004pa.dgn  
 PS 7

FAP RTE.	SECTION	COUNTY	TOTAL SHEETS	SHEET NO.
781	(1Z,17Z)RS-2	CRAWFORD	14	8
FED. ROAD DIST. NO. 7	ILLINOIS	FED. AID PROJECT NO.		

CONTRACT NO. 74049

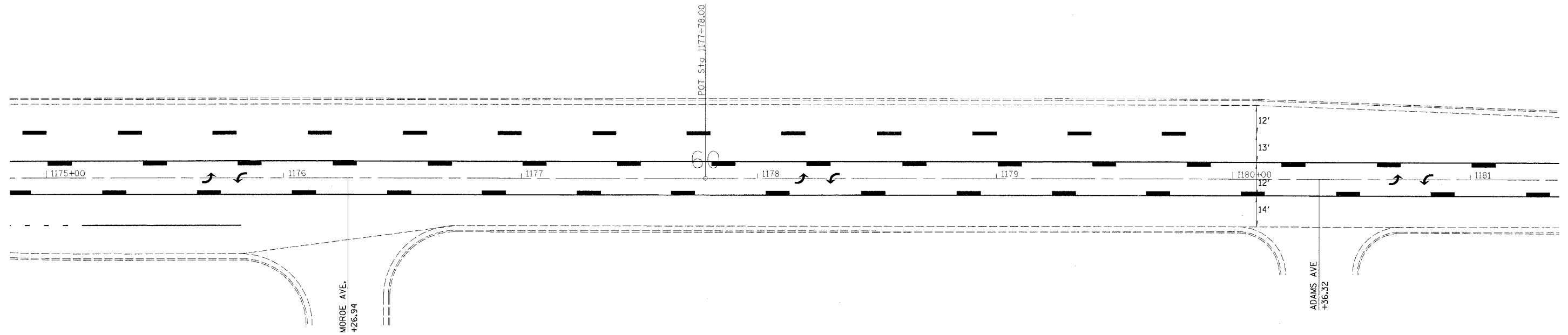

REVISIONS	
NAME	DATE

ILLINOIS DEPARTMENT OF TRANSPORTATION

**STA 1175+00 TO  
STA 1181+00**

SCALE: VERT.  
HORIZ.

DATE

DRAWN BY  
CHECKED BY

REVISED 5-9-05



-USERNAME-  
 5/6/2005  
 ct:\projects\74049d\403004pa.dgn  
 PS 8



FAP NO.	SECTION	COUNTY	TOTAL SHEETS	SHEET NO.
781	(12,17Z)RS-2	CRAWFORD	14	9
FED. ROAD DIST. NO. 7		ILLINOIS	FED. AID PROJECT NO.	
CONTRACT NO. 74049				

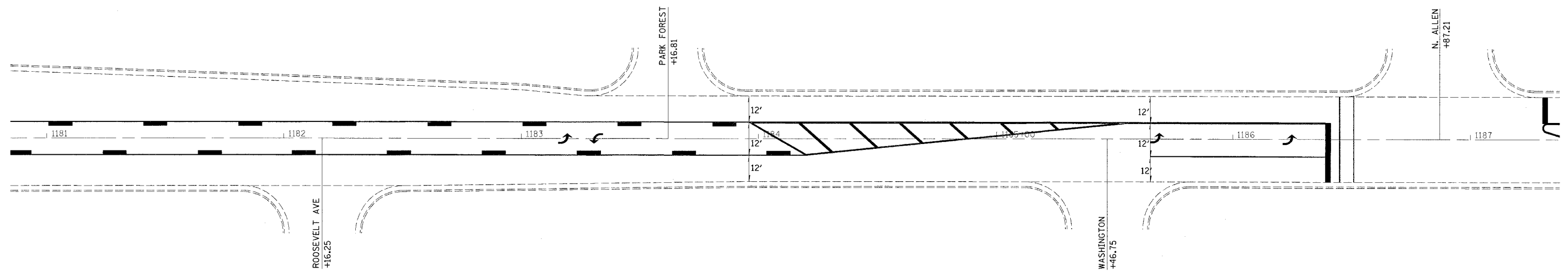

REVISIONS	
NAME	DATE

ILLINOIS DEPARTMENT OF TRANSPORTATION  
**STA 1181+00 TO  
 STA 1187+00**  
 SCALE: VERT. \_\_\_\_\_  
 HORIZ. \_\_\_\_\_  
 DATE \_\_\_\_\_ DRAWN BY \_\_\_\_\_  
 CHECKED BY \_\_\_\_\_

REVISED 5-9-05

-USERNAME-  
 5/6/2005  
 c:\projects\74049d\403004pa.dgn  
 P S 9

FAP REF.	SECTION	COUNTY	TOTAL SHEETS	SHEET NO.
781	(1Z,1Z)RS-2	CRAWFORD	14	10
FED. ROAD DIST. NO. 7	ILLINOIS	FED. AID PROJECT NO.		

CONTRACT NO. 14Q49

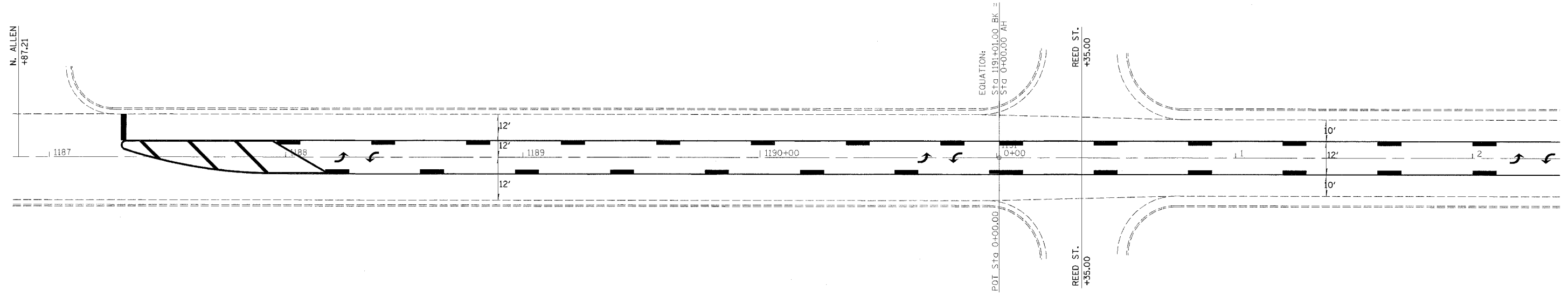

REVISIONS	
NAME	DATE

ILLINOIS DEPARTMENT OF TRANSPORTATION

**STA 1187+00 TO  
STA 2+00**

SCALE: VERT.  
HORIZ.  
DATE

DRAWN BY  
CHECKED BY

REVISED 5-9-05

-USERNAME-  
 5/6/2005  
 c:\projects\74049d\03004.psdgn

PS 10



FAP RTE.	SECTION	COUNTY	TOTAL SHEETS	SHEET NO.
781	(12,17Z)RS-2	CRAWFORD	14	11
FED. ROAD DIST. NO. 1	ILLINOIS	FED. AID PROJECT NO.		

CONTRACT NO. 74049

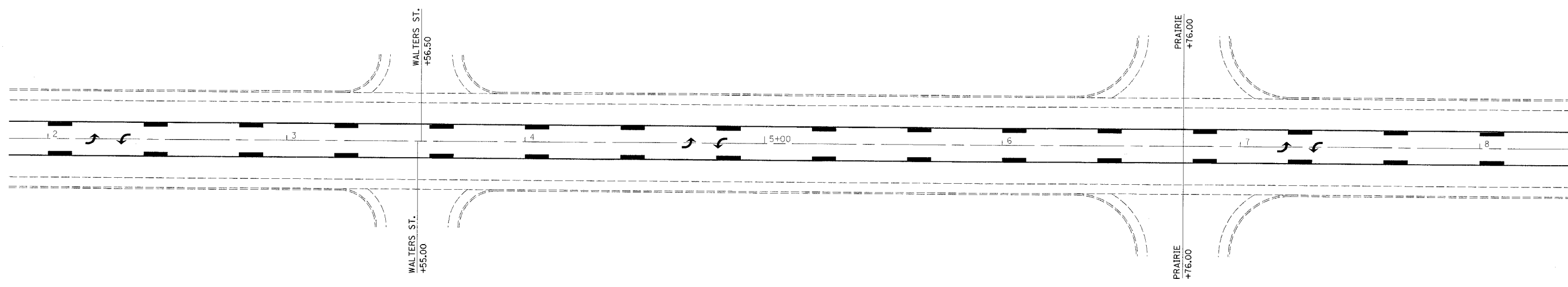

REVISIONS	
NAME	DATE

ILLINOIS DEPARTMENT OF TRANSPORTATION

**STA 2+00 TO  
STA 8+00**

SCALE: VERT. \_\_\_\_\_  
HORIZ. \_\_\_\_\_

DATE \_\_\_\_\_ DRAWN BY \_\_\_\_\_  
CHECKED BY \_\_\_\_\_

REVISED 5-9-05

-USERNAME-  
 5/6/2005  
 c:\projects\74049d\03004pa.dgn

PS 11



FAP RTE.	SECTION	COUNTY	TOTAL SHEETS	SHEET NO.
781	(1Z,17Z)RS-2	CRAWFORD	14	12
FED. ROAD DIST. NO. 7	ILLINOIS	FED. AID PROJECT NO.		

CONTRACT NO. 74049

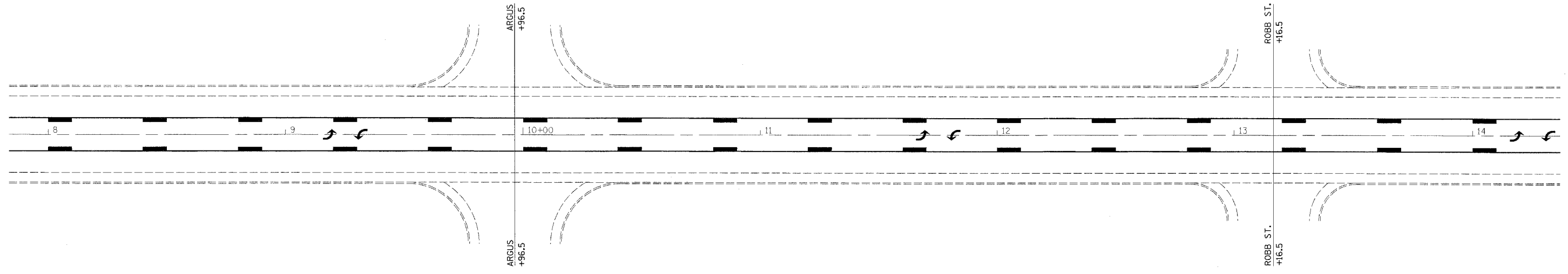

REVISIONS	
NAME	DATE

ILLINOIS DEPARTMENT OF TRANSPORTATION

**STA 8+00 TO  
 STA 14+00**

SCALE: VERT.  
 HORIZ.  
 DATE

DRAWN BY  
 CHECKED BY

Revised 5-9-05

-USERNAME-  
5/6/2005  
c:\projects\74049d\03004ps.dgn  
PS 12



FAP RTE.	SECTION	COUNTY	TOTAL SHEETS	SHEET NO.
781	(1Z,17Z)RS-2	CRAWFORD	14	13
FED. ROAD DIST. NO. 7		ILLINOIS	FED. AID PROJECT NO.	

CONTRACT NO. 74049

FAP ROUTE 781 (IL 33)  
SECTION (1Z,17Z)RS-2  
CRAWFORD COUNTY  
ENDS STA. 19+47

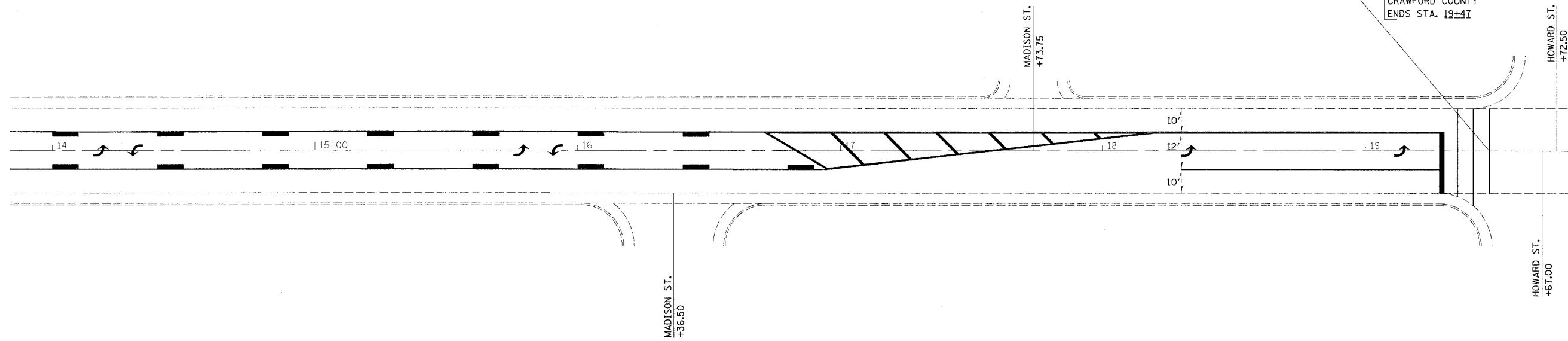

REVISIONS	
NAME	DATE

ILLINOIS DEPARTMENT OF TRANSPORTATION

**STA 14+00 TO  
STA 19+78**

SCALE: VERT.  
HORIZ.  
DATE

DRAWN BY  
CHECKED BY

REVISED 5-9-05

1 2 3 4 5 6 7 8 9 5/6/2005  
 10 11 12 13 14 15 16 17 18 c:\projects\74049d\03004pa.dgn  
 19 20 21 22 23 24 25 26 MMO REV: 05-05-99  
 27 28 29 30 31 32 33 34 35 36  
 37 38 39 40 41 42 43 44 45  
 46 47 48 49 50 51 52 53 54  
 55 56 57 58 59 60 61 62 63  
**EPMD1**

FAP RTE.	SECTION	COUNTY	TOTAL SHEETS	SHEET NO.
781	(1Z,17Z)RS-2	CRAWFORD	14	14
FED. ROAD DIST. NO. 7	ILLINOIS	FED. AID PROJECT NO.		

CONTRACT NO. 74049

•• PLACE THE FIRST ARROW EVEN WITH THE BEGINNING OF THE TURN BAY.  
 PLACE ANOTHER ARROW 18' BACK FROM THE STOP BAR, IF REQUIRED.  
 ADD ADDITIONAL ARROWS TO MAINTAIN A MAXIMUM OF 80' SPACING.

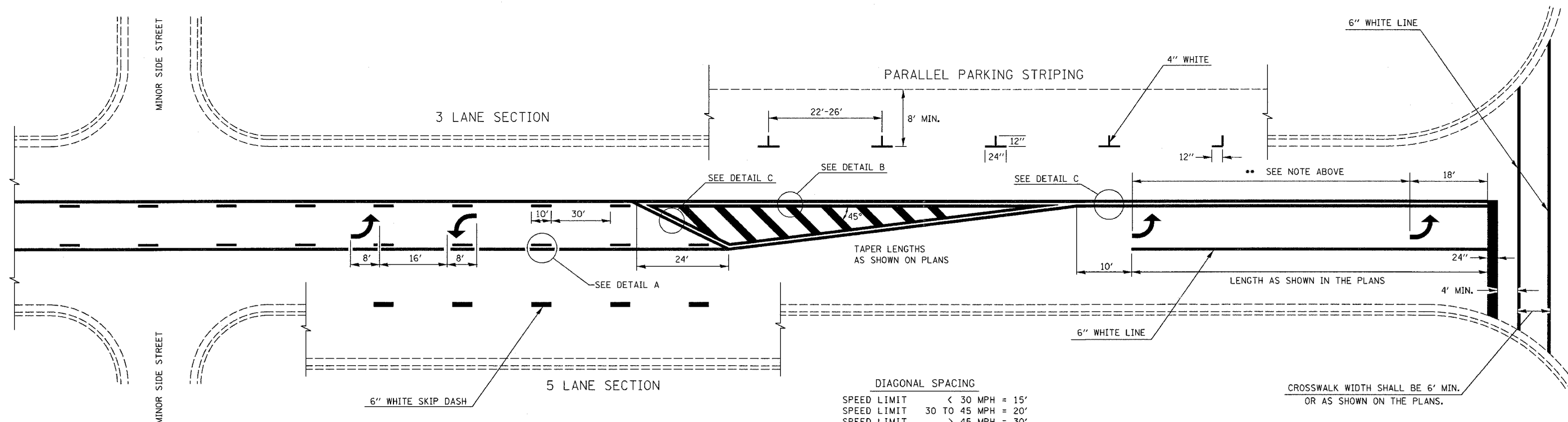

DIAGONAL SPACING

SPEED LIMIT	< 30 MPH	= 15'
SPEED LIMIT	30 TO 45 MPH	= 20'
SPEED LIMIT	> 45 MPH	= 30'

CROSSWALK WIDTH SHALL BE 6' MIN.  
 OR AS SHOWN ON THE PLANS.

**TYPICAL BI-DIRECTIONAL TURN LANE MARKINGS**  
 (SHOWING TRANSITION TO EXCLUSIVE LEFT TURN LANE)

- NOTES:
1. NO LESS THAN 2 ARROWS SHALL BE USED.
  2. TAPER RATES, LANE WIDTHS, AND STORAGE LENGTHS AS SHOWN ON THE PLANS.
  3. AVOID PLACING BI-DIRECTIONAL ARROWS IN INTERSECTIONS.
  4. BI-DIRECTIONAL ARROWS SHALL BE SPACED A MAXIMUM OF 250'.

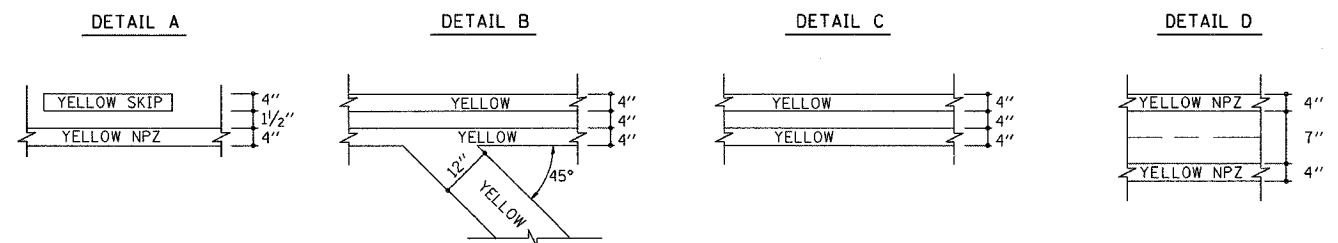

NOT TO SCALE

REVISIONS	
NAME	DATE
MMO	12-99
DRM	08-04

ILLINOIS DEPARTMENT OF TRANSPORTATION  
**TYPICAL APPLICATION OF PAVEMENT MARKINGS**  
**SHEET 2 OF 2**

SCALE: VERT. DATE  
 HORIZ. DATE

DRAWN BY  
 CHECKED BY

c:\projects\74049d\03004pa.dgn  
 DATE