

F.A.P. RTE.	SECTION	COUNTY	TOTAL SHEETS	SHEET NO.
327	(2.2)N	LAWRENCE	38	18
STA.		TO STA.		
FED. ROAD DIST. NO.		ILLINOIS FED. AID PROJECT		

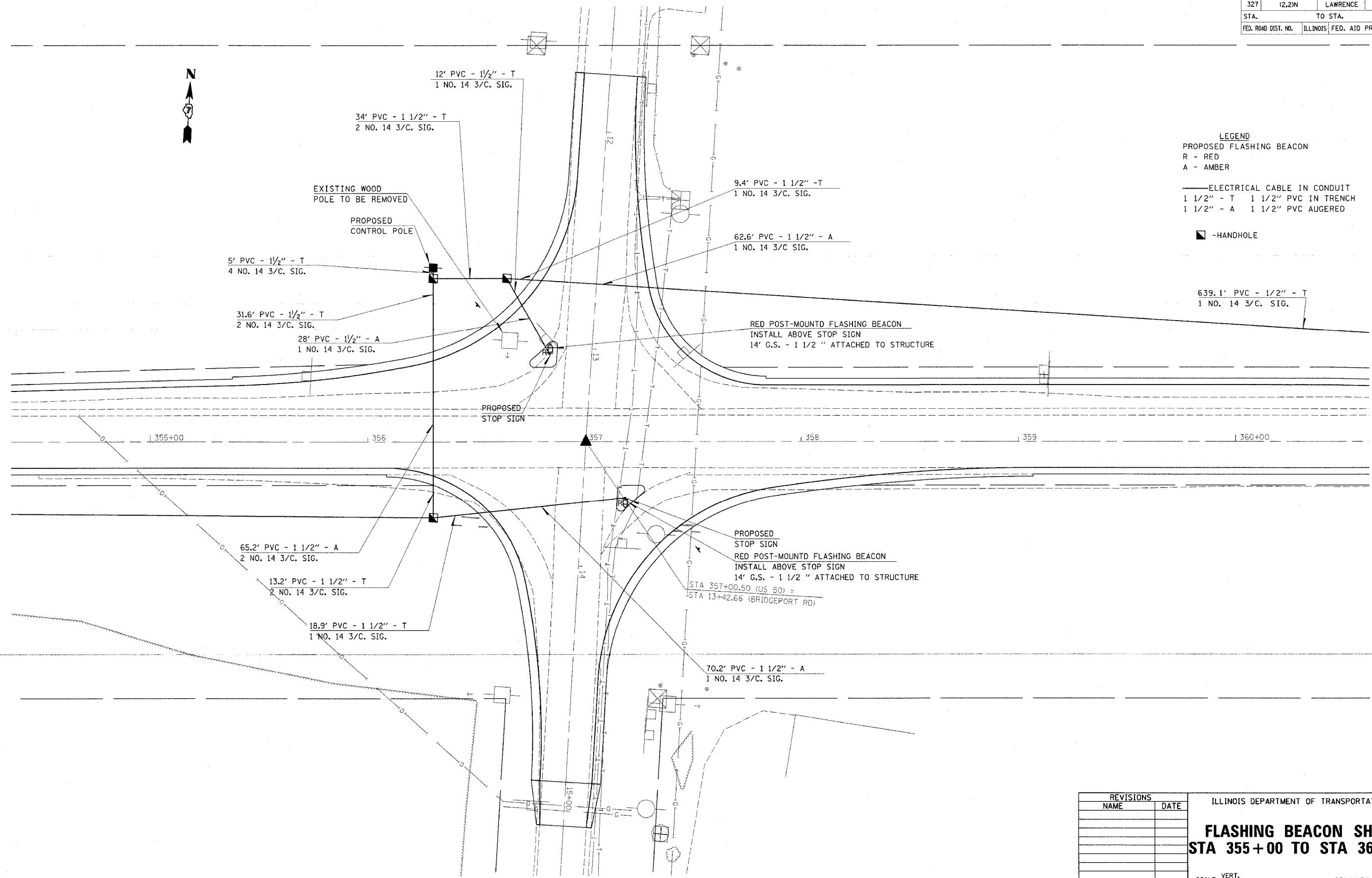

LEGEND
 PROPOSED FLASHING BEACON
 R - RED
 A - AMBER
 — ELECTRICAL CABLE IN CONDUIT
 1 1/2" - T 1 1/2" PVC IN TRENCH
 1 1/2" - A 1 1/2" PVC AUGERED
 ■ - HANDHOLE



639.1' PVC - 1 1/2" - T
 1 NO. 14 3/C. SIG.

RED POST-MOUNTD FLASHING BEACON
 INSTALL ABOVE STOP SIGN
 14" G.S. - 1 1/2" ATTACHED TO STRUCTURE

PROPOSED STOP SIGN

PROPOSED STOP SIGN
 RED POST-MOUNTD FLASHING BEACON
 INSTALL ABOVE STOP SIGN
 14" G.S. - 1 1/2" ATTACHED TO STRUCTURE

STA 357+00.50 (US 50) =
 STA 13+42.66 (BRIDGEPORT RD)

70.2' PVC - 1 1/2" - A
 1 NO. 14 3/C. SIG.

REVISIONS	
NAME	DATE

ILLINOIS DEPARTMENT OF TRANSPORTATION
FLASHING BEACON SHEET
STA 355+00 TO STA 360+00
 SCALE: VERT. _____
 HORIZ. _____
 DATE _____
 DRAWN BY _____
 CHECKED BY _____

teasleyck
 3/31/2005
 c:\projects\74035d\02004p.dgn
FB 2

PLOT DATE = 3/31/2005
 PLOT NAME = FB2.dwg
 PLOT SCALE = AS SHOWN
 REFERENCE = #REF#