

F.A.U. RTE.	SECTION	COUNTY	TOTAL SHEETS	SHEET NO.
8027	12RS-4,TS-1	SANGAMON	31	14
STA.		TO STA.		
FED. ROAD DIST. NO.		ILLINOIS	FED. AID PROJECT	

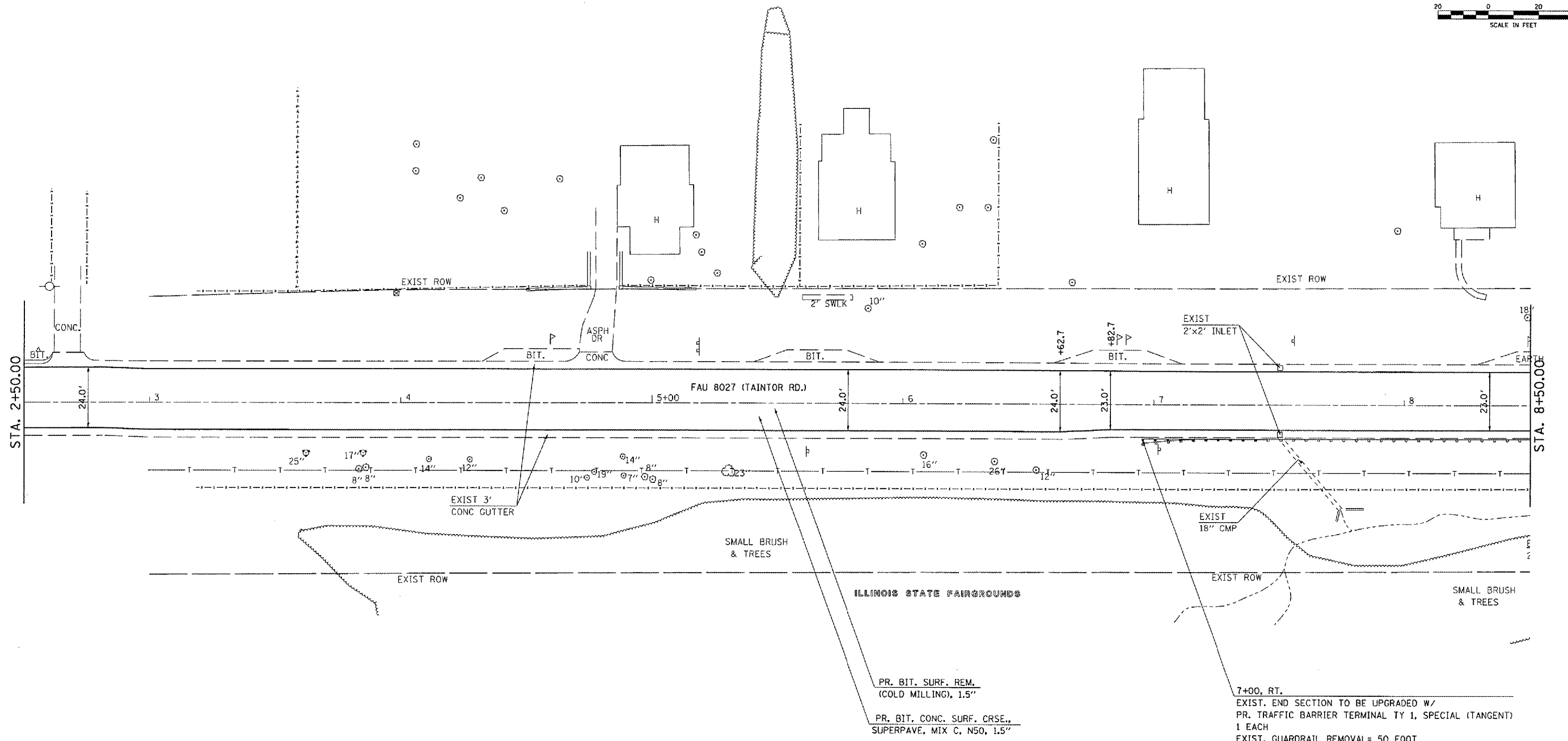
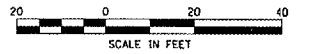

PR. BIT. SURF. REM.
(COLD MILLING), 1.5"

PR. BIT. CONC. SURF. CRSE.,
SUPERPAVE, MIX C, N50, 1.5"

7+00, RT.
EXIST. END SECTION TO BE UPGRADED W/
PR. TRAFFIC BARRIER TERMINAL TY 1, SPECIAL (TANGENT)
1 EACH
EXIST. GUARDRAIL REMOVAL= 50 FOOT
FURNISHED EXCAVATION= 1 CU YD

PLOT DATE = 4/1/2005
FILE NAME = c:\projects\72985\ahpland.dgn
PLOT SCALE = 43.3734' / IN.
REFERENCE = #REF#

REVISIONS	
NAME	DATE

ILLINOIS DEPARTMENT OF TRANSPORTATION
PLAN SHEET

FAU 8027 (TAINTOR RD.)
SECTION 12RS-4,TS-1
SANGAMON COUNTY

SCALE: VERT.
HORIZ.
DATE 02-14-05
DRAWN BY TMJ
CHECKED BY MEB