

FINAL SURVEY
 SURVEYED PLOTTED
 NOTE BOOK TEMPLATE
 NO. AREAS CHECKED

BY DATE

ORIGINAL SURVEY
 SURVEYED PLOTTED
 NOTE BOOK TEMPLATE
 NO. AREAS CHECKED

BY DATE

G:\proj\beta\beta\0653004\woolpert\0653004\XSTS\2\2/28/05

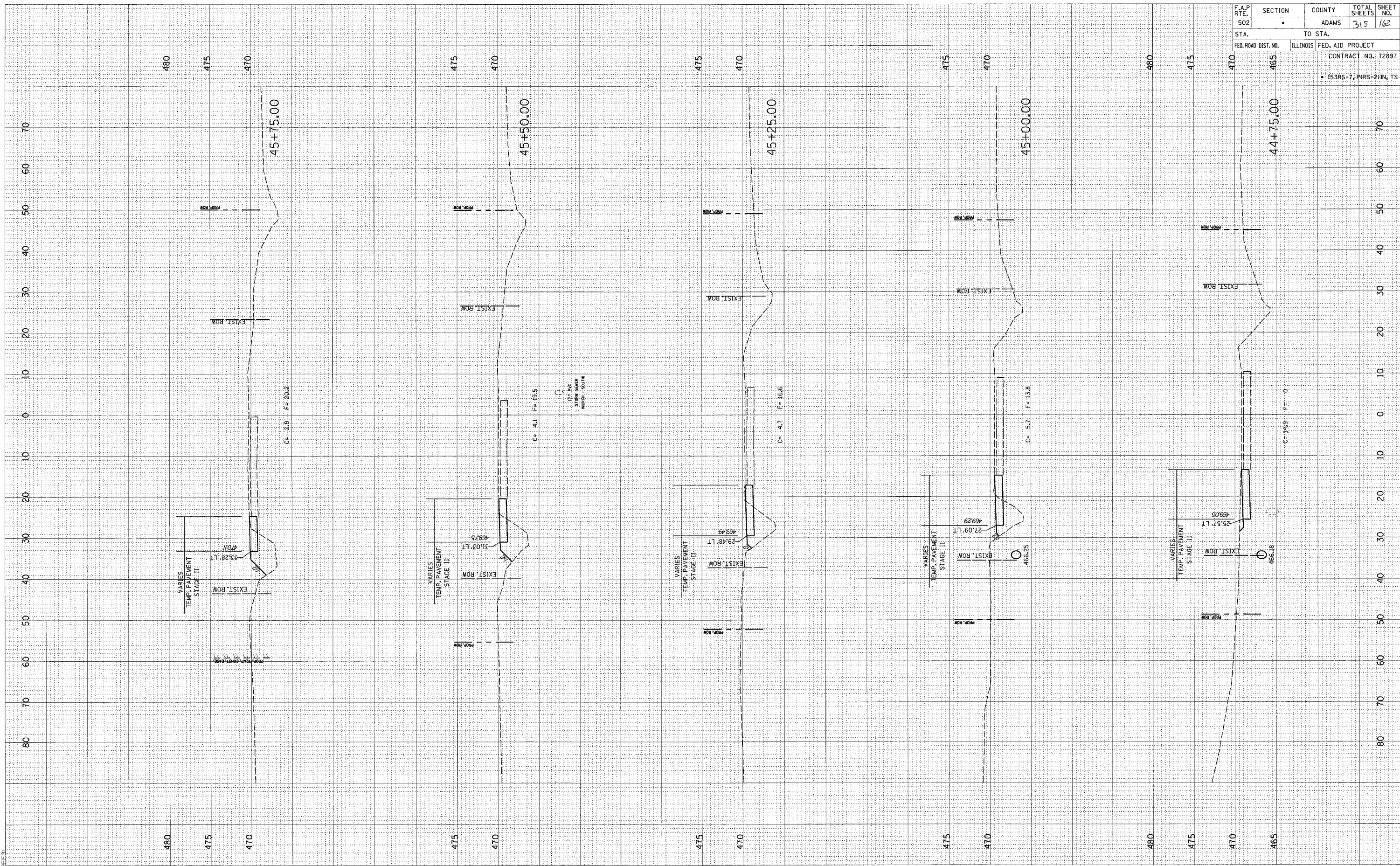

F.A.P. RTE.	SECTION	COUNTY	TOTAL SHEETS	SHEET NO.
502		ADAMS	315	162
STA. TO STA.				
FED. ROAD DIST. NO. ILLINOIS FED. AID PROJECT				
CONTRACT NO. 72897				
• (53RS-7, PARS-2)N, TS				