

F.A.P. RTE.	SECTION	COUNTY	TOTAL SHEETS	SHEET NO.
502		ADAMS	315	00

STA. TO STA.  
FED. ROAD DIST. NO. ILLINOIS FED. AID PROJECT

• (53RS-7, PIRS-2)IN, TS  
CONTRACT NO. T2897

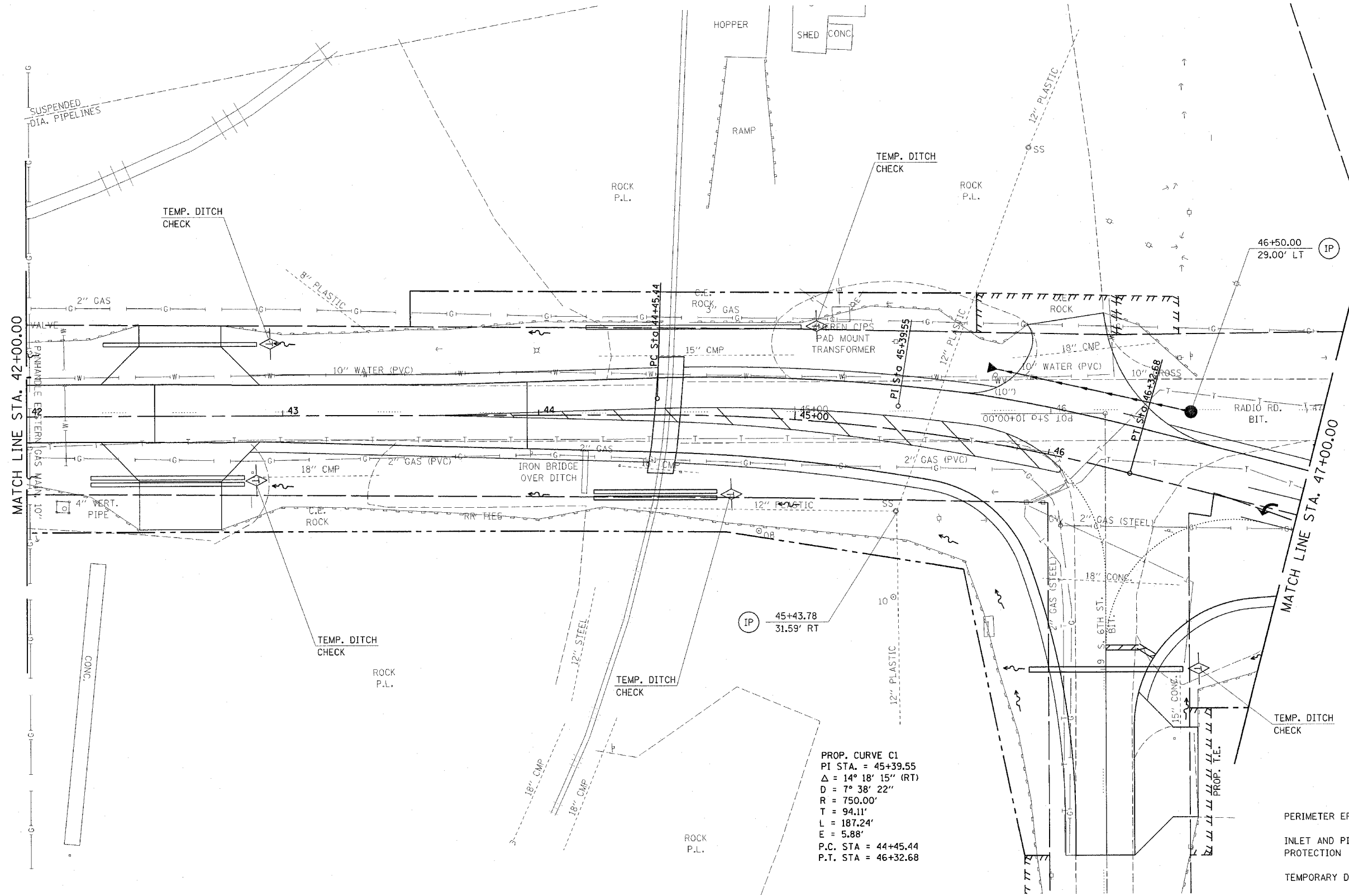
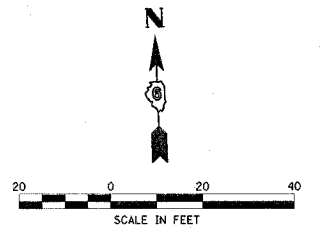

PROP. CURVE C1  
 PI STA. = 45+39.55  
 $\Delta = 14^\circ 18' 15''$  (RT)  
 $D = 7^\circ 38' 22''$   
 $R = 750.00'$   
 $T = 94.11'$   
 $L = 187.24'$   
 $E = 5.88'$   
 P.C. STA = 44+45.44  
 P.T. STA = 46+32.68

**LEGEND**

- PERIMETER EROSION BARRIER
- INLET AND PIPE PROTECTION
- TEMPORARY DITCH CHECK

REVISIONS	
NAME	DATE

ILLINOIS DEPARTMENT OF TRANSPORTATION  
**EROSION CONTROL**  
 F.A.P. 502 (IL 57) & RADIO RD.  
 ADAMS COUNTY  
 QUINCY, IL.

SCALE: VERT. \_\_\_\_\_  
 HORIZ. \_\_\_\_\_  
 DATE 04-13-04  
 DRAWN BY TMJ  
 CHECKED BY MEB

c:\projects\0653004\ersnctl.dgn  
 2/3/2005  
 \*REF01