

| | | | | |
|---------------------|----------|------------------|--------------|-----------|
| F.A.P. RTE. | SECTION | COUNTY | TOTAL SHEETS | SHEET NO. |
| 502 | | ADAMS | 315 | 97 |
| STA. | TO STA. | | | |
| FED. ROAD DIST. NO. | ILLINOIS | FED. AID PROJECT | | |

• (53RS-7, P(RS-2)N, TS
CONTRACT NO. 72897

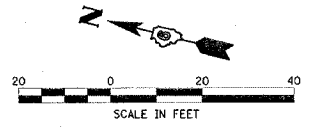

EXIST. CURVE 56
PI STA. = 73+55.99
 $\Delta = 1^\circ 16' 08''$ (LT)
 $D = 0^\circ 09' 31''$
 $R = 36,121.14'$
 $T = 400.00'$
 $L = 799.97'$
 $E = 2.21'$
 $e =$
T.R. =
S.E. RUN =
P.C. STA. = 69+55.99
P.T. STA. = 77+55.96

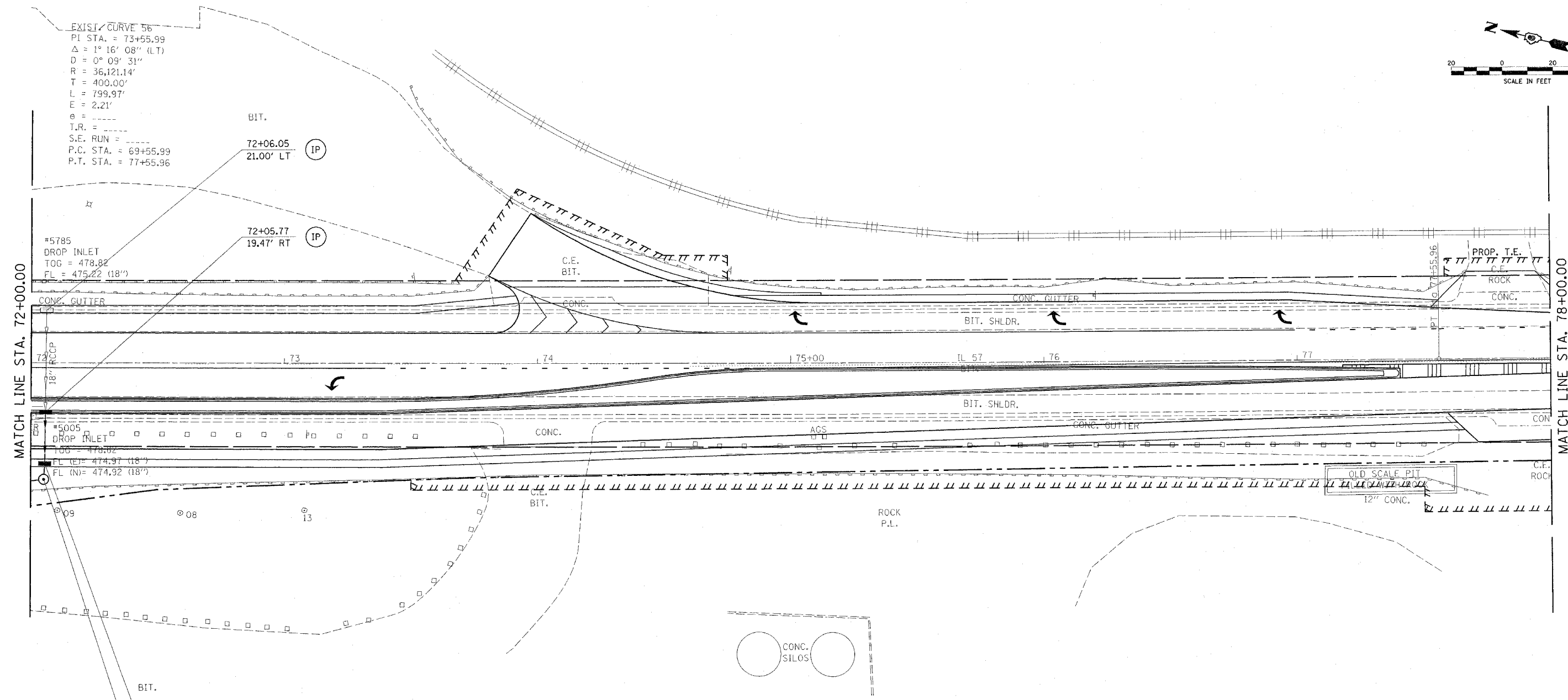

LEGEND

- PERIMETER EROSION BARRIER
- INLET AND PIPE PROTECTION
- TEMPORARY DITCH CHECK

| REVISIONS | |
|-----------|------|
| NAME | DATE |
| | |
| | |
| | |
| | |
| | |
| | |
| | |
| | |
| | |
| | |

ILLINOIS DEPARTMENT OF TRANSPORTATION
EROSION CONTROL
F.A.P. 502 (IL 57) & RADIO RD.
ADAMS COUNTY
QUINCY, IL.

SCALE: VERT. _____
HORIZ. _____
DATE 04-13-04
DRAWN BY TMJ
CHECKED BY MEB

c:\projects\d653004\ersnctl.dgn
 2/3/2005
 *REF 01