

F.A.P. RTE.	SECTION	COUNTY	TOTAL SHEETS	SHEET NO.
502		ADAMS	315	91
STA.		TO STA.		
FED. ROAD DIST. NO.		ILLINOIS FED. AID PROJECT		
• (53RS-7, PIRS-2)IN, TS				
CONTRACT NO. 72897				

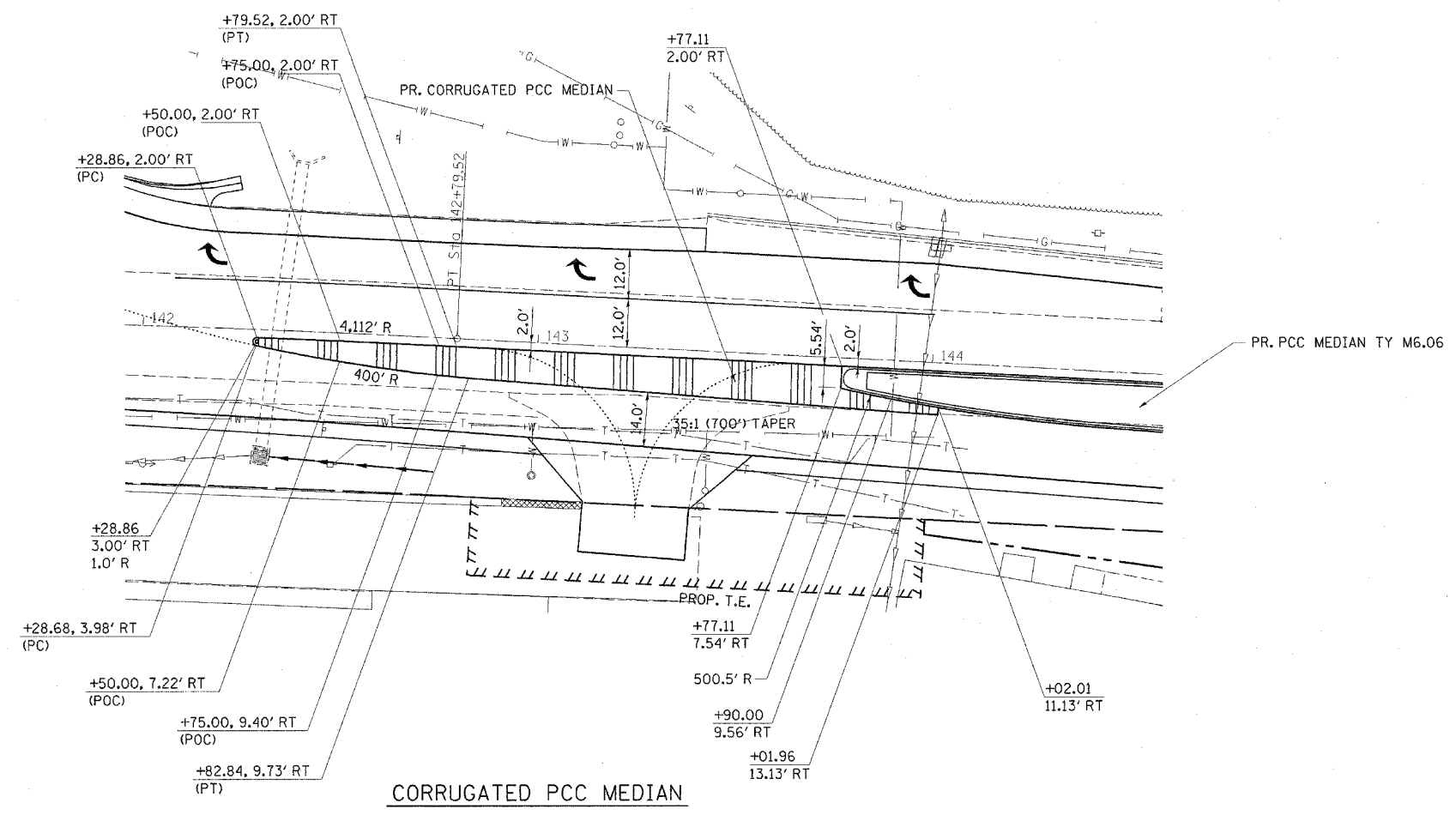

CORRUGATED PCC MEDIAN

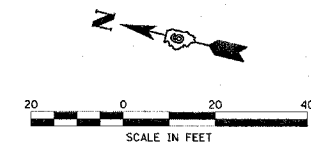
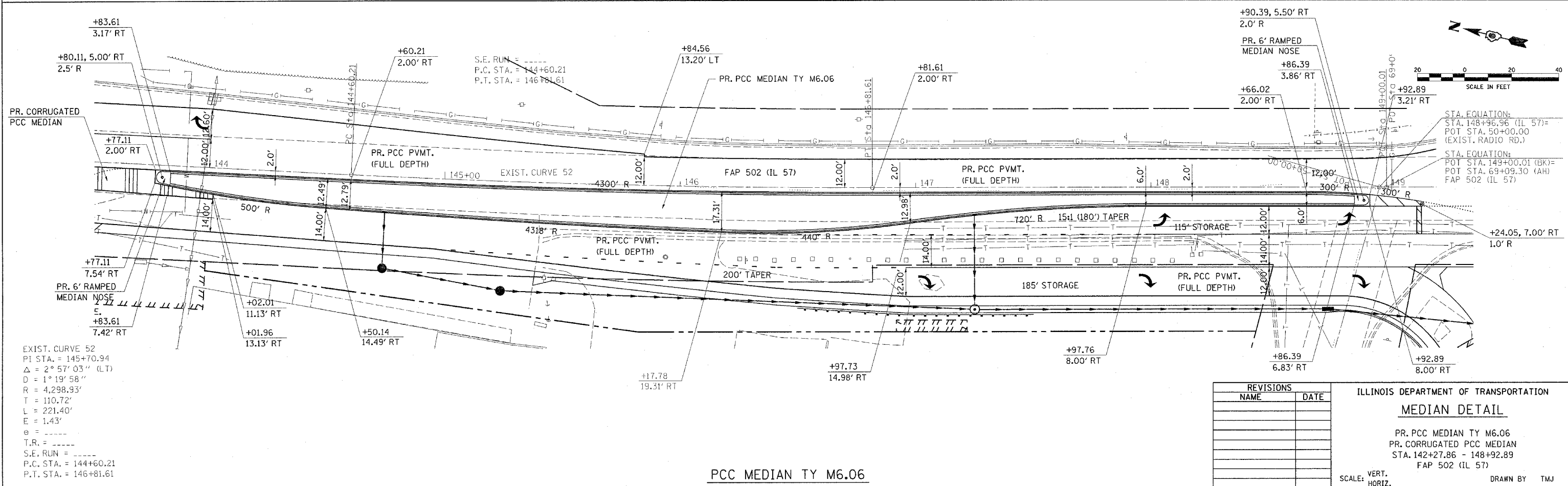

PCC MEDIAN TY M6.06

EXIST. CURVE 52
 PI STA. = 145+70.94
 $\Delta = 2^\circ 57' 03''$ (LT)
 $D = 1^\circ 19' 58''$
 $R = 4,298.93'$
 $T = 110.72'$
 $L = 221.40'$
 $E = 1.43'$
 $e =$
 $T.R. =$
 S.E. RUN =
 P.C. STA. = 144+60.21
 P.T. STA. = 146+81.61

REVISIONS	
NAME	DATE

ILLINOIS DEPARTMENT OF TRANSPORTATION
MEDIAN DETAIL
 PR. PCC MEDIAN TY M6.06
 PR. CORRUGATED PCC MEDIAN
 STA. 142+27.86 - 148+92.89
 FAP 502 (IL 57)
 SCALE: VERT. _____
 HORIZ. _____
 DATE 07-27-04
 DRAWN BY TMJ
 CHECKED BY MEB

ci:\projects\653004\ppsheets.dgn
 2/2/2005
 *REF01