

F.A.P. RTE.	SECTION	COUNTY	TOTAL SHEETS	SHEET NO.
502		ADAMS	315	30
STA.		TO STA.		
FED. ROAD DIST. NO.		ILLINOIS FED. AID PROJECT		
• (S3RS-7, PIRS-21)N, TS CONTRACT NO. 72897				

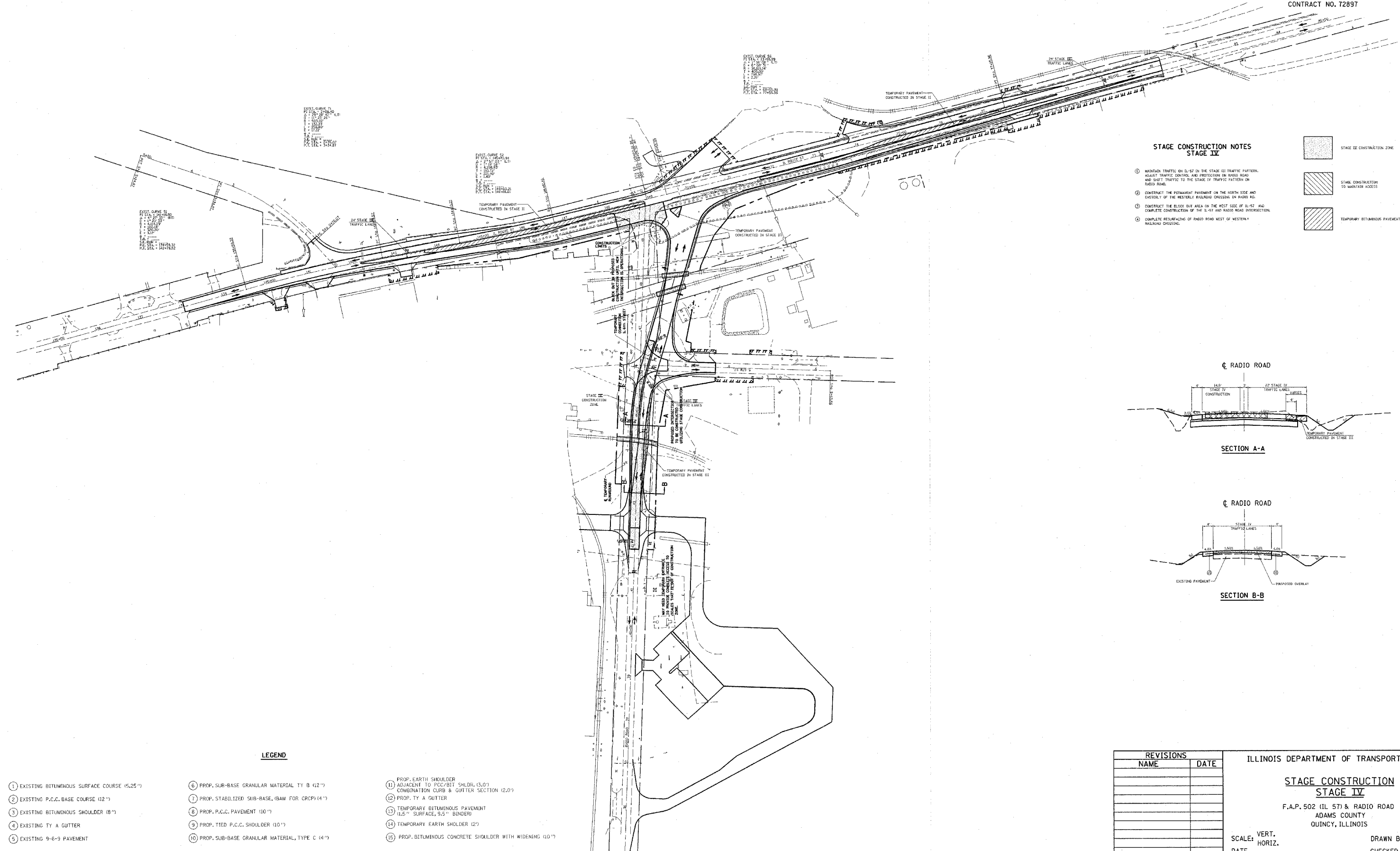

**STAGE CONSTRUCTION NOTES  
STAGE IV**

1. MAINTAIN TRAFFIC ON IL-57 ON THE STAGE III TRAFFIC PATTERNS. ADJUST TRAFFIC CONTROL AND PROTECTION ON RADIO ROAD AND SHUT TRAFFIC TO THE STAGE IV TRAFFIC PATTERNS ON RADIO ROAD.
2. CONSTRUCT THE PERMANENT PAVEMENT ON THE NORTH SIDE AND EASTERNLY OF THE WESTERLY RAILROAD CROSSING ON RADIO ROAD.
3. CONSTRUCT THE BLOCK OUT AREA ON THE WEST SIDE OF IL-57 AND COMPLETE CONSTRUCTION OF THE IL-57 AND RADIO ROAD INTERSECTION.
4. COMPLETE RESURFACING OF RADIO ROAD WEST OF WESTERLY RAILROAD CROSSING.

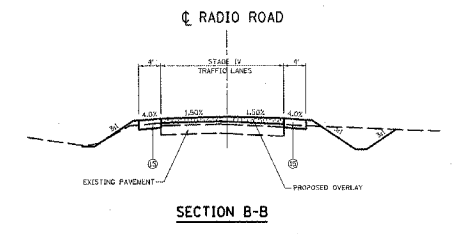
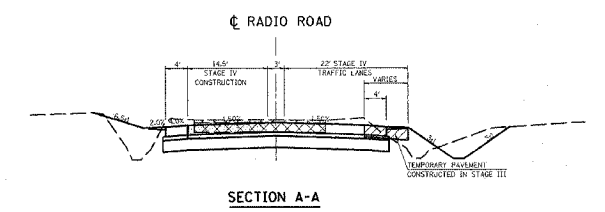
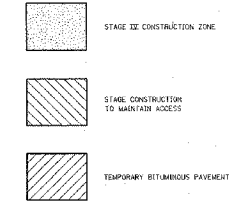

**LEGEND**

- |   |   |   |
|---|---|---|
| 1. EXISTING BITUMINOUS SURFACE COURSE (5.25") | 6. PROP. SUB-BASE GRANULAR MATERIAL TY B (12")    | 11. PROP. EARTH SHOULDER ADJACENT TO PCC/BIT SHLDR. (3.0') COMBINATION CURB & GUTTER SECTION (2.0') |
| 2. EXISTING P.C.C. BASE COURSE (12")          | 7. PROP. STABILIZED SUB-BASE, (BAM FOR CRCP) (4") | 12. PROP. TY A GUTTER   |
| 3. EXISTING BITUMINOUS SHOULDER (6")          | 8. PROP. P.C.C. PAVEMENT (10")                    | 13. TEMPORARY BITUMINOUS PAVEMENT (1.5" SURFACE, 9.5" BINDER)                                       |
| 4. EXISTING TY A GUTTER                       | 9. PROP. TIED P.C.C. SHOULDER (10")               | 14. TEMPORARY EARTH SHOULDER (2')   |
| 5. EXISTING 9-6-9 PAVEMENT                    | 10. PROP. SUB-BASE GRANULAR MATERIAL, TYPE C (4") | 15. PROP. BITUMINOUS CONCRETE SHOULDER WITH WIDENING (10")  |

REVISIONS	
NAME	DATE

ILLINOIS DEPARTMENT OF TRANSPORTATION

**STAGE CONSTRUCTION  
STAGE IV**

F.A.P. 502 (IL 57) & RADIO ROAD  
ADAMS COUNTY  
QUINCY, ILLINOIS

SCALE: VERT. \_\_\_\_\_  
HORIZ. \_\_\_\_\_

DATE \_\_\_\_\_ DRAWN BY \_\_\_\_\_  
CHECKED BY \_\_\_\_\_

c:\projects\d653004\woolpert-080204\radio rd stage 4.dgn  
2/2/2005  
\*REF01