

F.A.P. RTE.	SECTION	COUNTY	TOTAL SHEETS	SHEET NO.
502		ADAMS	315	28
STA.		TO STA.		
FED. ROAD DIST. NO.	ILLINOIS	FED. AID PROJECT		

• [53RS-7, PIRS-2]N, TS
CONTRACT NO. 72897

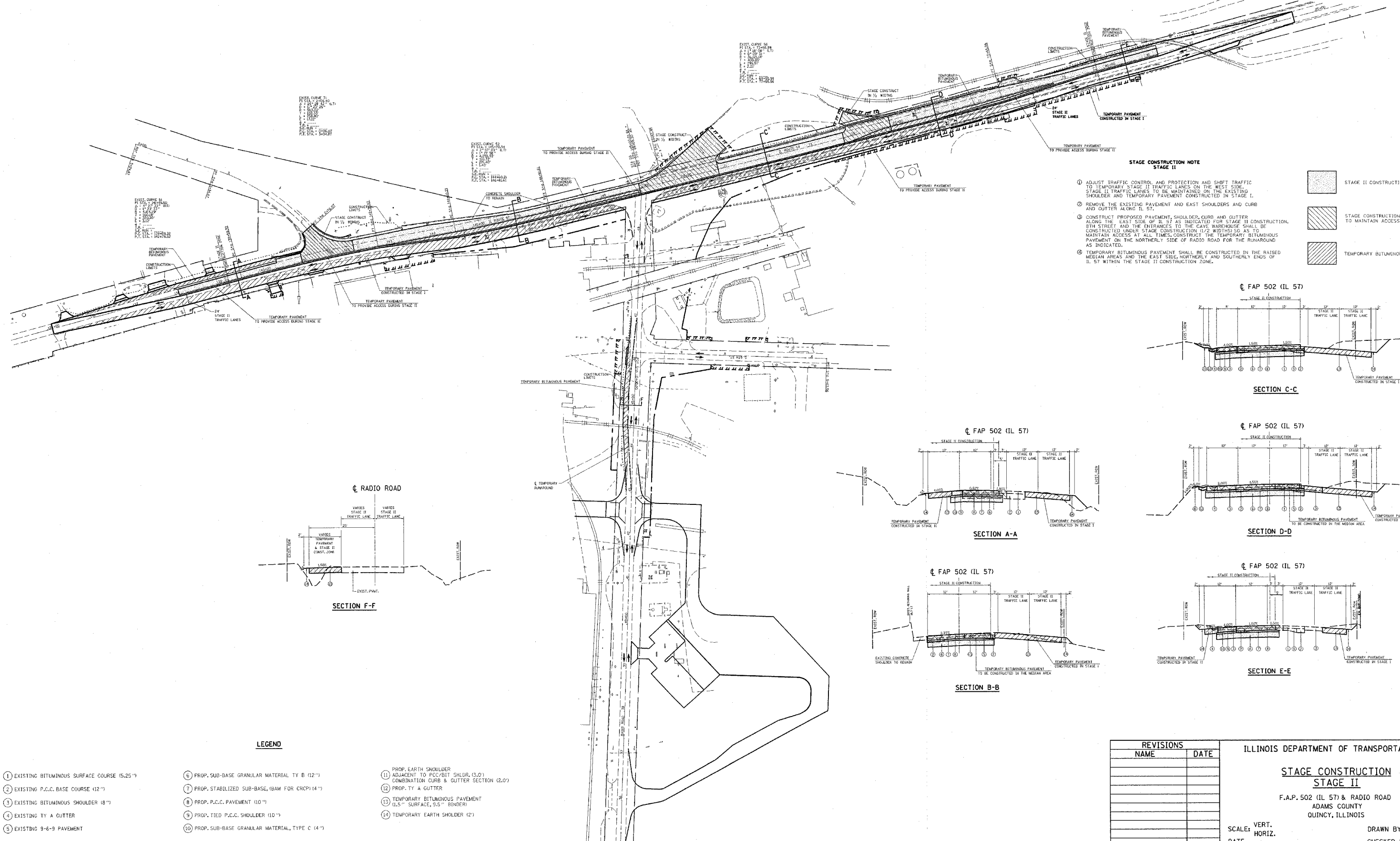

- STAGE CONSTRUCTION NOTE
STAGE II**
- ADJUST TRAFFIC CONTROL AND PROTECTION AND SHIFT TRAFFIC TO TEMPORARY STAGE II TRAFFIC LANES ON THE WEST SIDE. STAGE II TRAFFIC LANES TO BE MAINTAINED ON THE EXISTING SHOULDER AND TEMPORARY PAVEMENT CONSTRUCTED IN STAGE I.
 - REMOVE THE EXISTING PAVEMENT AND EAST SHOULDERS AND CURB AND GUTTER ALONG IL 57.
 - CONSTRUCT PROPOSED PAVEMENT, SHOULDER, CURB AND GUTTER ALONG THE EAST SIDE OF IL 57 AS INDICATED FOR STAGE II CONSTRUCTION. 8TH STREET AND THE ENTRANCES TO THE GAVE WAREHOUSE SHALL BE CONSTRUCTED UNDER STAGE CONSTRUCTION (1/2 WIDTH) SO AS TO MAINTAIN ACCESS AT ALL TIMES. CONSTRUCT THE TEMPORARY BITUMINOUS PAVEMENT ON THE NORTHERLY SIDE OF RADIO ROAD FOR THE RUNAROUND AS INDICATED.
 - TEMPORARY BITUMINOUS PAVEMENT SHALL BE CONSTRUCTED IN THE RAISED MEDIAN AREAS AND THE EAST SIDE, NORTHERLY AND SOUTHERLY ENDS OF IL 57 WITHIN THE STAGE II CONSTRUCTION ZONE.

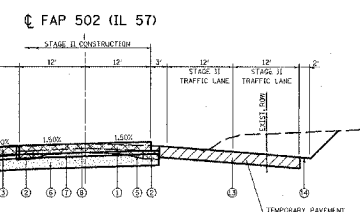
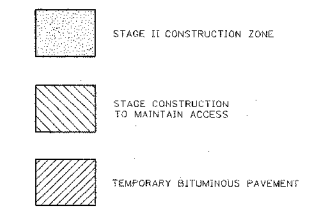

SECTION C-C

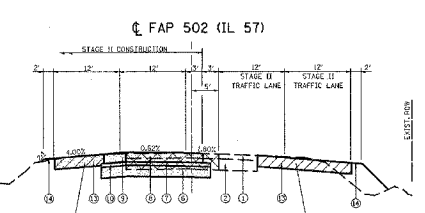

SECTION A-A

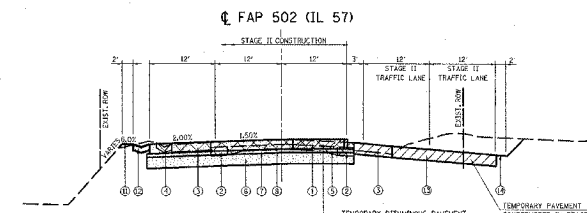

SECTION D-D

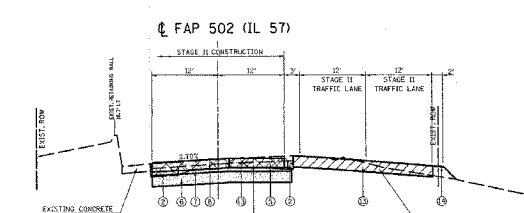

SECTION B-B

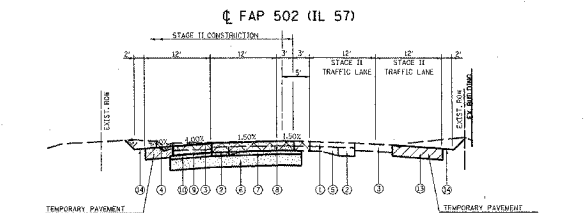

SECTION E-E

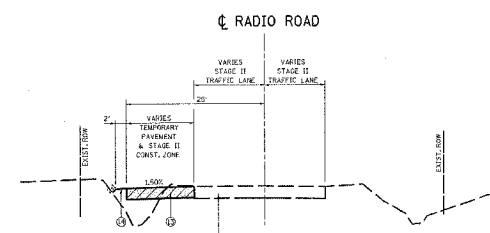

SECTION F-F

- LEGEND**
- | | | |
|--|---|--|
| 1 EXISTING BITUMINOUS SURFACE COURSE (5.25") | 6 PROP. SUB-BASE GRANULAR MATERIAL TY B (12") | 11 PROP. EARTH SHOULDER ADJACENT TO PCC/BIT SHLDR. (3.0') COMBINATION CURB & GUTTER SECTION (2.0') |
| 2 EXISTING P.C.C. BASE COURSE (12") | 7 PROP. STABILIZED SUB-BASE, (BAM FOR CRCP) (14") | 12 PROP. TY A GUTTER |
| 3 EXISTING BITUMINOUS SHOULDER (18") | 8 PROP. P.C.C. PAVEMENT (10") | 13 TEMPORARY BITUMINOUS PAVEMENT (1.5" SURFACE, 9.5" BINDER) |
| 4 EXISTING TY A GUTTER | 9 PROP. TIED P.C.C. SHOULDER (10") | 14 TEMPORARY EARTH SHOULDER (2') |
| 5 EXISTING 9'-6" PAVEMENT | 10 PROP. SUB-BASE GRANULAR MATERIAL, TYPE C (4") | |

REVISIONS		ILLINOIS DEPARTMENT OF TRANSPORTATION
NAME	DATE	
		STAGE CONSTRUCTION STAGE II F.A.P. 502 (IL 57) & RADIO ROAD ADAMS COUNTY QUINCY, ILLINOIS

SCALE: VERT. DATE HORIZ. CHECKED BY

c:\projects\d653004\woolpert_080204\radio rd stage 2.dgn
 2/2/2005
 #REF01