

STATE OF ILLINOIS  
DEPARTMENT OF TRANSPORTATION

DIVISION OF HIGHWAYS

PROPOSED  
HIGHWAY PLANS

F.A.P. ROUTE 321

(US ROUTE 54 / ILLINOIS ROUTE 106 / WASHINGTON STREET)  
GROVE STREET INTERSECTION WIDENING, RESURFACING,  
DRAINAGE IMPROVEMENTS AND EARTHWORK

SECTION 18N

PROJECT: F-0321(011)

PIKE COUNTY

C-96-529-04

PITTSFIELD TOWNSHIP  
PITTSFIELD, ILLINOIS

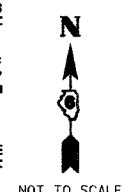
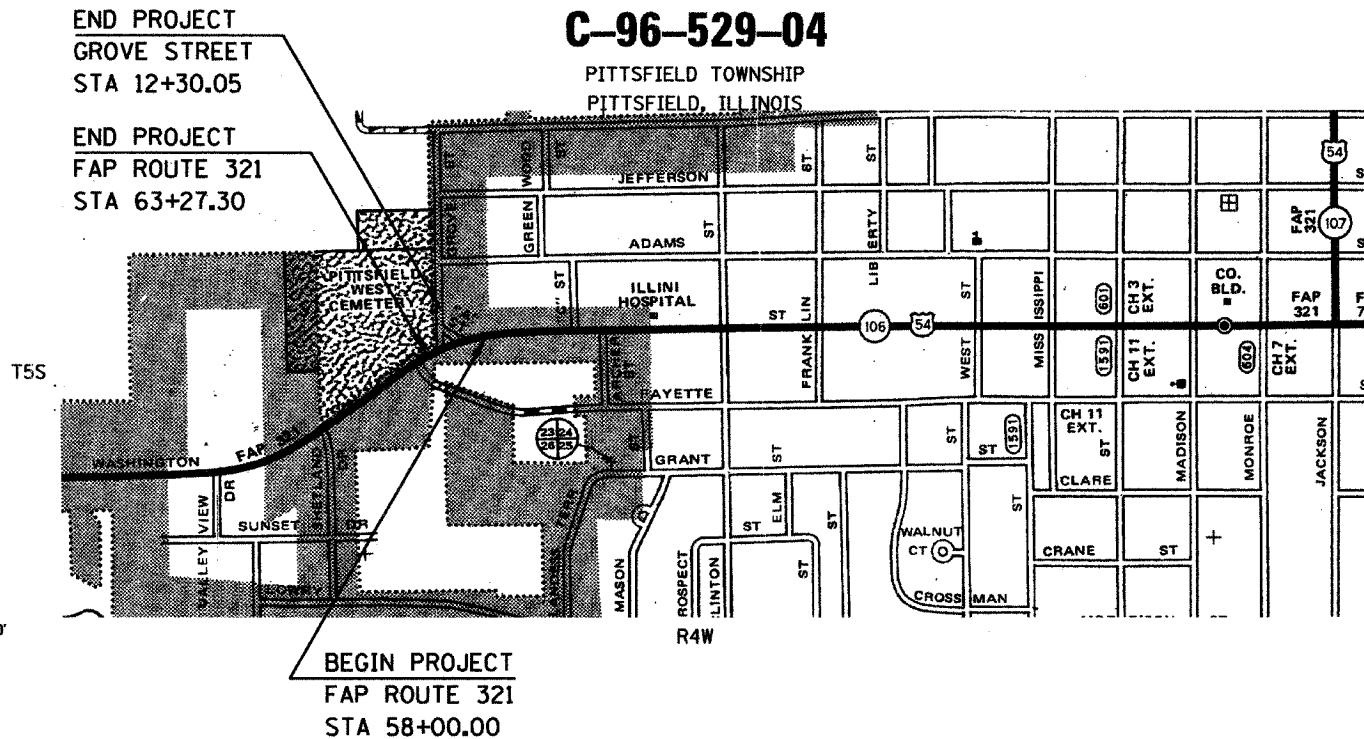

F.A.P. RTE.	SECTION	COUNTY	TOTAL SHEETS	SHEET NO.
321	18N	PIKE	26	1

STATE CONTRACT NO. 72691

D-96-563-02

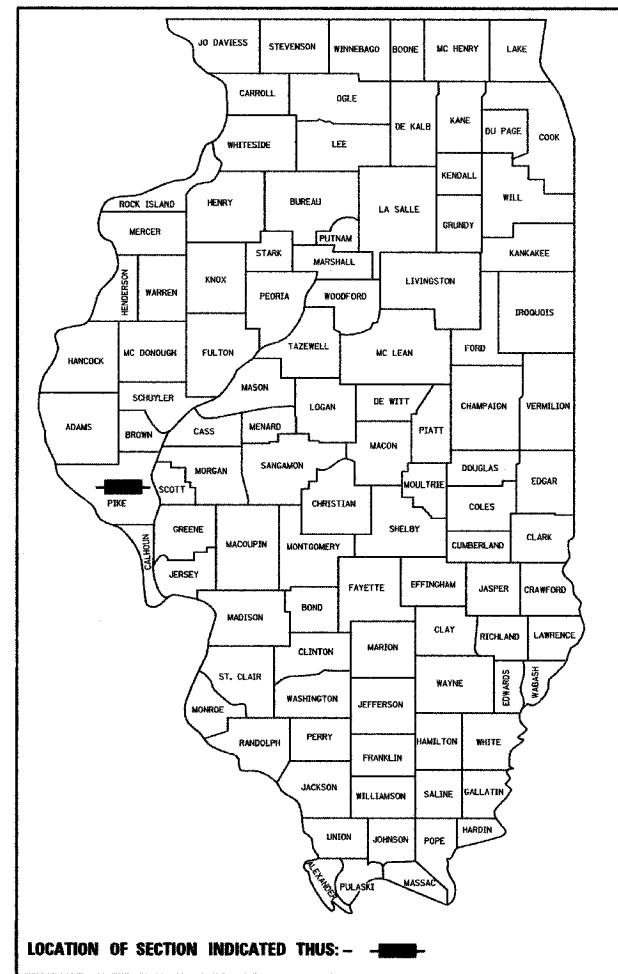

LOCATION OF SECTION INDICATED THUS: - [black rectangle] -

DESIGN DESIGNATION

FAP ROUTE 321 - OTHER PRINCIPAL ARTERIAL

2004 TRAFFIC DATA

	ADT
FAP 321 (US 54/IL 106/WASHINGTON STREET)	10300
MS 6030 (GROVE STREET)	2350

INDEX OF SHEETS

- 1 COVER
- 2 GENERAL NOTES, COMMITMENTS, ALIGNMENT TIES, MIXTURE DESIGNS, & SEQUENCE OF CONSTRUCTION
- 3 SUMMARY OF QUANTITIES
- 4-5 TYPICAL SECTIONS
- 6-9 SCHEDULE OF QUANTITIES
- 10 PLAN & PROFILE
- 11-12 INTERSECTION & PAVEMENT MARKING DETAILS
- 13 GROVE STREET STORM SEWER PROFILES
- 14 MISCELLANEOUS DETAILS
- 15-22 CROSS SECTIONS - FAP ROUTE 321
- 23-26 CROSS SECTIONS - GROVE STREET HIGHWAY STANDARDS

IDOT HIGHWAY STANDARDS

280001-02	606301-02	702001-05
602306	701301-02	780001-01
604001-02	701311-02	781001-02
604006-02	701326-02	000001-04
604036-01	701501-03	
606001-02	701502-01	

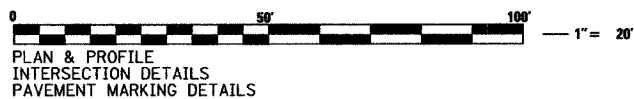

FULL SIZE PLANS HAVE BEEN PREPARED USING STANDARD ENGINEERING SCALES, REDUCED SIZED PLANS WILL NOT CONFORM TO STANDARD SCALES, IN MAKING MEASUREMENTS ON REDUCED PLANS, THE ABOVE SCALES MAY BE USED.

J.U.L.I.E.  
JOINT UTILITY LOCATION INFORMATION FOR EXCAVATION  
1-800-892-0123

CONTRACT NO. 72691

LOCATION MAP

GROSS LENGTH OF PROJECT = 527.30 FEET (0.100 MILES)  
NET LENGTH OF PROJECT = 527.30 FEET (0.100 MILES)

PLANS PREPARED BY

**HORNER & SHIFRIN, INC.**

ENGINEERS ■ ARCHITECTS ■ PLANNERS

141 MARKET PLACE SUITE 208 ■ FAIRVIEW HEIGHTS, ILLINOIS 62208

5200 OAKLAND AVENUE ■ ST. LOUIS, MISSOURI 63110

www.hornershifrinc.com



Steven R. Donahue 3/17/05  
STEVEN R. DONAHUE, P.E. Date  
License Expires 11/30/2005

STATE OF ILLINOIS  
DEPARTMENT OF TRANSPORTATION  
DIVISION OF HIGHWAYS

SUBMITTED March 21, 2005  
Chris H. Reed DISTRICT ENGINEER

May 13, 2005  
Mike Stone ENGINEER OF DESIGN AND ENVIRONMENT

May 13, 2005  
Victor Mader DIRECTOR, DIVISION OF HIGHWAYS

PRINTED BY THE AUTHORITY  
OF THE STATE OF ILLINOIS

Plot Date: 3/17/2005  
 Plot Time: 8:00:03 AM  
 Plot Path: C:\Users\ken\Documents\72691\Construction\Plans\01\_Cover.dgn  
 File Name: I:\01029\Work\01029\2\Construction\Plans\01\_Cover.dgn  
 Project Engineer: Ken Anderson (217) 782-4761  
 Squad Leader: Ken Anderson (217) 524-7546

F.A.P. RTE.	SECTION	COUNTY	TOTAL SHEETS	SHEET NO.
321	18N	PIKE	26	2
STA.		TO STA.		
FED. ROAD DIST. NO.	ILLINOIS	FED. AID PROJECT		
STATE CONTRACT NO. 72691				

### GENERAL NOTES

- THE CONTRACTOR SHALL BE RESPONSIBLE FOR PROTECTING UTILITY PROPERTY FROM CONSTRUCTION OPERATIONS AS OUTLINED IN ARTICLE 107.31 OF STANDARD SPECIFICATION. THE J.U.L.E. NUMBER IS 1-800-892-0123. A MINIMUM OF FORTY-EIGHT HOURS ADVANCE NOTICE IS REQUIRED.  
  
THE LOCATION OF ALL UTILITIES ARE BASED ON INFORMATION PROVIDED BY OTHERS AND ARE INTENDED TO BE APPROXIMATE. IT SHALL BE THE CONTRACTOR'S RESPONSIBILITY TO COORDINATE HIS/HER CONSTRUCTION ACTIVITIES WITH THE VARIOUS UTILITY OWNERS. ALL POTENTIAL CONFLICTS SHALL BE INVESTIGATED AND REMEDIAL ACTION TAKEN PRIOR TO INTERRUPTION OF THE CONTRACTOR'S PROGRESS.  
  
ALL UTILITY FACILITIES THAT REQUIRE RELOCATION WITHIN STATE R.O.W. SHALL BE COMPLETED BY THE UTILITY COMPANY UNLESS OTHERWISE SHOWN ON THE PLANS.
- IN ADDITION TO FIELD SURVEYS AND AERIAL SURVEYS, PLAN DIMENSIONS AND DETAILS RELATIVE TO EXISTING FACILITIES HAVE BEEN TAKEN FROM EXISTING PLANS AND ARE SUBJECT TO CONSTRUCTION VARIATIONS. IT SHALL BE THE CONTRACTOR'S RESPONSIBILITY TO VERIFY SUCH DIMENSIONS AND DETAILS IN THE FIELD. SUCH VARIATIONS SHALL NOT BE CAUSE FOR ADDITIONAL COMPENSATION DUE TO CHANGE IN THE SCOPE OF WORK. HOWEVER, THE CONTRACTOR WILL BE PAID FOR THE QUANTITY ACTUALLY FURNISHED AT THE UNIT PRICE BID FOR THE WORK.
- ALL STATIONS AND OFFSET REFERENCES ARE TO THE ROADWAY CENTERLINE UNLESS OTHERWISE NOTED. THE STATE PLANE COORDINATE SYSTEM HAS BEEN USED FOR THE HORIZONTAL CONTROL.
- ALL ELEVATIONS SHOWN ON THE PLANS ARE BASED ON U.S.G.S. MEAN SEA LEVEL DATUM.
- ANY REFERENCE WITHIN THESE PLANS TO A STANDARD SHALL BE INTERPRETED TO MEAN THE EDITION INDICATED BY THE SUB-NUMBER LISTED ON THE PREVIOUS SHEET OR THE COPY INCLUDED IN THESE PLANS.
- GRADING SHALL BE DONE BY HAND AROUND LIGHT POLES, UTILITY POLES, SIGN POSTS, SHRUBS, TREES OR OTHER NATURAL OR MAN-MADE OBJECTS WHERE SHALLOW FILLS OR CUTS ARE ADJACENT TO THE ITEMS. IT IS THE INTENT THAT THE LIMITS OF CONSTRUCTION BE SUCH AS TO PRESERVE IN THE ORIGINAL STATE AS MUCH AREA OF TEMPORARY EASEMENTS AS POSSIBLE. THE DECISION AS TO ITEMS TO REMAIN IN PLACE SHALL BE DIRECTED BY THE ENGINEER. THIS WORK WILL NOT BE PAID FOR SEPARATELY, BUT SHALL BE CONSIDERED INCLUDED IN THE CONTRACT UNIT PRICE PER CUBIC YARD FOR EARTH EXCAVATION, AND NO ADDITIONAL COMPENSATION WILL BE ALLOWED.
- SODDING SHALL BE DONE ON ALL AREAS THAT ARE DISTURBED BY CONSTRUCTION OPERATIONS AS DIRECTED BY THE ENGINEER. SODDING SHALL BE PAID FOR ONLY WITHIN THE PROPOSED RIGHT-OF-WAY OR EASEMENT LIMITS. ALL AREAS DISTURBED BY THE CONTRACTOR OUTSIDE THE PROPOSED CONSTRUCTIONS LIMITS SHALL BE SODDED AS DIRECTED BY THE ENGINEER, AT THE CONTRACTOR'S EXPENSE. SODDING WILL NOT BE PERMITTED AT ANY TIME WHEN THE GROUND IS FROZEN, WET OR IN UNTILLABLE CONDITION.

- FACTORS USED FOR ESTIMATING PLAN QUANTITIES ARE AS FOLLOWS AND SHALL NOT BE USED FOR THE BASIS OF FINAL QUANTITIES:  
  

BITUMINOUS CONCRETE LEVELING BINDER	0.056 TON/SQ YD IN
BITUMINOUS CONCRETE BASE COURSE	0.056 TON/SQ YD IN
BITUMINOUS CONCRETE SURFACE COURSE	0.056 TON/SQ YD IN
ALL AGGREGATE	2.05 TON/CU YD
BITUMINOUS MATERIALS:	
-ON PAVEMENT	0.00038 TON/SQ YD
-ON AGGREGATE SURFACE	0.001425 TON/SQ YD
AGGREGATE (PRIME COAT)	0.002 TON/SQ YD
AGRICULTURAL GROUND LIMESTONE	0.000046 TON/SQ YD
NITROGEN FERTILIZER NUTRIENT	0.0186 LBS/SQ YD
PHOSPHORUS FERTILIZER NUTRIENT	0.0011 LBS/SQ YD
POTASSIUM FERTILIZER NUTRIENT	0.0074 LBS/SQ YD
SUPPLEMENTAL WATERING	0.009 UNITS/SQ YD
TEMPORARY SEEDING	100 LBS/ACRE

- THE QUANTITY OF SHORT TERM PAVEMENT MARKING SHOWN IN THE PLANS IS BASED ON ONE APPLICATION EACH FOR THE BINDER COURSE AND SURFACE COURSE.
- ACCESS TO ALL PRIVATE AND COMMERCIAL ENTRANCES SHALL BE MAINTAINED AT ALL TIMES. ACCESS TO COMMERCIAL AND PRIVATE ENTRANCES TO BE PAID FOR AS Z0000990 AGGREGATE FOR TEMPORARY ACCESS (PER TON). THESE QUANTITIES SHALL BE USED AS DIRECTED BY THE ENGINEER FOR MAINTAINING ACCESS.
- FOR STABILIZATION, ALL TYPE III BARRICADES SHALL REQUIRE A MINIMUM OF FOUR SAND BAGS PER BARRICADE.
- THE DISTRICT BUREAU OF OPERATIONS SHALL BE NOTIFIED AT LEAST 14 DAYS PRIOR TO PLACEMENT OF FINAL PAVEMENT MARKINGS PH: (217) 782-7314.
- STORM SEWER (WATER MAIN REQUIREMENTS) IS TO BE USED AT LOCATIONS WHERE LATERAL SEPARATION BETWEEN THE SEWER AND WATER MAIN IS LESS THAN 10 FT AND THE WATER MAIN INVERT IS LESS THAN 1.5 FT ABOVE THE STORM SEWER CROWN.
- TRENCH BACKFILL REQUIRED FOR STORM SEWER, SANITARY SEWER, OR WATER MAINS SHALL ONLY BE PLACED UP TO ONE FOOT BELOW THE FINAL GRADE IN AREAS HAVING A PROPOSED GRASS OR SOD SURFACE.

- WHERE PROPOSED CONSTRUCTION ABUTS EXISTING APPURTENANCES, A SAW CUT SHALL BE MADE TO ACHIEVE A NEAT BUTT JOINT. SAWED JOINTS FOR REMOVALS AND BUTT JOINTS SHALL BE CONSIDERED INCLUDED IN ITEM BEING REMOVED OR CONSTRUCTED.
- BEFORE ORDERING PIPE CULVERTS, PIPE DRAINS, MANHOLES, STORM SEWER OR INLETS THE CONTRACTOR SHALL CONTACT THE ENGINEER FOR EXACT LENGTHS AND QUANTITIES.
- ALL OPENINGS IN PRECAST STRUCTURES, INCLUDING BOX CULVERTS, SHALL BE PRECAST TO THE PROPER SIZE. THIS INCLUDE OPENINGS FOR PIPE STRUCTURES, MANHOLE OPENINGS. COSTS FOR THESE OPENINGS AND THE CONNECTIONS SHALL BE CONSIDERED INCLUDED IN THE VARIOUS PAY ITEM FOR THE STRUCTURES INVOLVED.
- ALL DRAINAGE STRUCTURES SHALL BE DELIVERED TO THE STATE WITHOUT SILT, DEBRIS OR OTHER SUCH OBSTRUCTIONS AT THE TIME OF FINAL INSPECTION. THE CLEANING OF THESE DRAINAGE STRUCTURES SHALL BE INCLUDED IN THE VARIOUS PAY ITEMS INVOLVED.
- WHERE SECTION OR SUBSECTION MONUMENTS ARE ENCOUNTERED, THE ENGINEER SHALL BE NOTIFIED BEFORE SUCH MONUMENTS ARE REMOVED. THE CONTRACTOR SHALL PROTECT AND CAREFULLY PRESERVE ALL PROPERTY MARKERS AND MONUMENTS UNTIL THE OWNER, AN AUTHORIZED SURVEYOR OR AGENT HAS WITNESSED OR OTHERWISE REFERENCED THEIR LOCATION. THE CONTRACTOR SHALL BE RESPONSIBLE FOR HAVING AN AUTHORIZED SURVEYOR RE-ESTABLISH ANY SECTION OR SUB-SECTION MONUMENTS AND PROPERTY MARKERS DESTROYED BY HIS/HER OPERATIONS, AT THE CONTRACTOR'S EXPENSE.
- PARKING BLOCKS REMOVED FROM HARDEE'S PARKING LOT SHALL NOT BE DISPOSED AND SHALL BE RETURNED TO HARDEE'S.

### COMMITMENTS

NONE

### MIXTURE DESIGN

LOCATION(S):	
MIXTURE USE(S):	BITUMINOUS SURFACE
PG:	PG 64-22
RAP % (MAX):	10%
DESIGN AIR VOIDS:	4.0% @ N DESIGN = 70
MIXTURE COMPOSITION: (GRADATION MIXTURE)	IL 9.5 OR 12.5
FRICITION AGGREGATE:	MIX D

LOCATION(S):	
MIXTURE USE(S):	LEVELING BINDER (MACHINE METHOD)
PG:	PG 64-22
RAP % (MAX):	15%
DESIGN AIR VOIDS:	4.0% @ N DESIGN = 70
MIXTURE COMPOSITION: (GRADATION MIXTURE)	IL 9.5
FRICITION AGGREGATE:	N/A

LOCATION(S):	
MIXTURE USE(S):	BITUMINOUS BASE COURSE
PG:	PG 58-22
RAP % (MAX):	15%
DESIGN AIR VOIDS:	2.0% @ N DESIGN = 50
MIXTURE COMPOSITION: (GRADATION MIXTURE)	IL 19.0
FRICITION AGGREGATE:	N/A

LOCATION(S):	
MIXTURE USE(S):	INCIDENTAL SURFACE
PG:	PG 64-22
RAP % (MAX):	15%
DESIGN AIR VOIDS:	4.0% @ N DESIGN = 50
MIXTURE COMPOSITION: (GRADATION MIXTURE)	IL 9.5 OR 12.5
FRICITION AGGREGATE:	MIX C

### SEQUENCE OF CONSTRUCTION

- CONSTRUCT THE DRAINAGE IMPROVEMENTS AND UTILITY RELOCATIONS ON GROVE STREET KEEPING ONE LANE OPEN AT ALL TIMES USING FLAGPERSONS.
- ON US 54, RECONSTRUCT THE EASTERNMOST HARDEE'S ENTRANCE AND CURB IN THE IMMEDIATE VICINITY OF THE ENTRANCE WHILE KEEPING THE WESTERNMOST ENTRANCE OPEN.
- ON US 54, RECONSTRUCT THE WESTERNMOST HARDEE'S ENTRANCE AND CURB IN THE IMMEDIATE VICINITY OF THE ENTRANCE WHILE KEEPING THE EASTERNMOST ENTRANCE OPEN.
- PERFORM BITUMINOUS SURFACE REMOVAL ON GROVE STREET KEEPING ONE LANE OPEN AT ALL TIMES USING FLAGPERSONS.
- CONSTRUCT WIDENING, CURBS AND PAVED MEDIAN SEPARATING THE ROADWAY FROM HARDEE'S PARKING LOT (NE QUADRANT)
- MOVE TRAFFIC TO THE NORTH BOUND LANE ON GROVE STREET AND NEWLY ADDED WIDENING. ENOUGH ROOM WILL BE AVAILABLE ON GROVE STREET FOR TWO LANES, ONE IN EACH DIRECTION ON THE RIGHT SIDE OF GROVE STREET.
- CONSTRUCT WIDENING AND CURB & GUTTER IN THE NW QUADRANT NEAR THE CEMETERY.
- PLACE BITUMINOUS BASE COURSE KEEPING ONE LANE OPEN AT ALL TIMES USING FLAGPERSONS.
- PERFORM MILLING ON US 54.
- PLACE SURFACE COURSE AND PAVEMENT MARKING ON BOTH US 54 AND GROVE STREET.

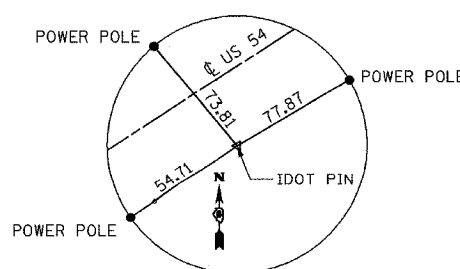

**CONTROL POINT 1**  
US 54  
STA. 62+69.12 36.45' LT  
N = 1071088.5630  
E = 2111817.3710

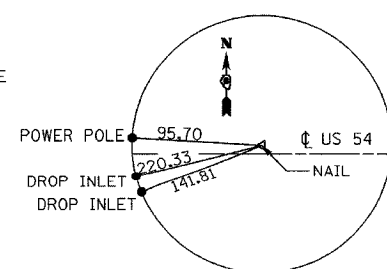

**CONTROL POINT 2**  
US 54  
STA. 54+25.08 28.86' RT  
N = 1071344.7350  
E = 2112599.5910

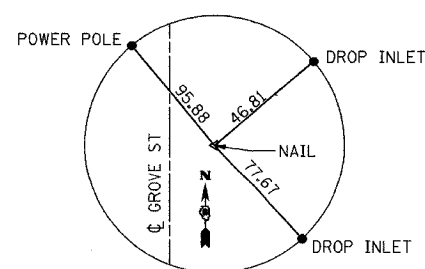

**CONTROL POINT 3**  
GROVE STREET  
STA. 10+61.86 44.47' RT  
N = 1071305.6382  
E = 2112066.8154

REVISIONS	
NAME	DATE

ILLINOIS DEPARTMENT OF TRANSPORTATION  
**GENERAL NOTES, COMMITMENTS,  
ALIGNMENT TIES,  
MIXTURE DESIGNS, &  
SEQUENCE OF CONSTRUCTION**

SCALE: NONE  
DATE 12/16/03

DRAWN BY AJP  
CHECKED BY SRD

**SUMMARY OF QUANTITIES**

CODE NUMBER	PAY ITEM	UNIT	PIKE COUNTY
			STP URBAN 80% FEDERAL 20% STATE 1000-1A TOTAL QUANTITY
20200100	EARTH EXCAVATION	CU YD	285
20201400	SUB-BASE GRANULAR MATERIAL, TYPE A	TON	187
20800150	TRENCH BACKFILL	CU YD	27
25000400	NITROGEN FERTILIZER NUTRIENT	POUND	3
25000500	PHOSPHORUS FERTILIZER NUTRIENT	POUND	1
25000600	POTASSIUM FERTILIZER NUTRIENT	POUND	1
25000700	AGRICULTURAL GROUND LIMESTONE	TON	1
25200100	SODDING	SQ YD	172
25200200	SUPPLEMENTAL WATERING	UNIT	1.5
28000250	TEMPORARY EROSION CONTROL SEEDING	POUND	4
28000500	INLET AND PIPE PROTECTION	EACH	1
35101800	AGGREGATE BASE COURSE, TYPE B 6"	SQ YD	50
40600200	BITUMINOUS MATERIALS (PRIME COAT)	TON	1.6
40600300	AGGREGATE (PRIME COAT)	TON	6.4
40600980	BITUMINOUS SURFACE REMOVAL - BUTT JOINT	SQ YD	287
40600990	TEMPORARY RAMP	SQ YD	115
42300400	PORTLAND CEMENT CONCRETE DRIVEWAY PAVEMENT, 8 INCH	SQ YD	104
44000003	BITUMINOUS SURFACE REMOVAL 3/4"	SQ YD	350
44000006	BITUMINOUS SURFACE REMOVAL 1 1/2"	SQ YD	2124
44000100	PAVEMENT REMOVAL	SQ YD	273
44000200	DRIVEWAY PAVEMENT REMOVAL	SQ YD	156
44000500	COMBINATION CURB AND GUTTER REMOVAL	FOOT	460
44200120	PAVEMENT PATCHING, TYPE II, 10 INCH	SQ YD	7
54248515	CONCRETE COLLAR	EACH	1
55100700	STORM SEWER REMOVAL 15"	FOOT	108
60240210	INLETS, TYPE B, TYPE 1 FRAME, OPEN LID	EACH	1
60240220	INLETS, TYPE B, TYPE 3 FRAME AND GRATE	EACH	3
60240301	INLETS, TYPE B, TYPE 8 GRATE	EACH	1
60500060	REMOVING INLETS	EACH	3
60603800	COMBINATION CONCRETE CURB AND GUTTER, TYPE B-6.12	FOOT	168.5
60604400	COMBINATION CONCRETE CURB AND GUTTER, TYPE B-6.18	FOOT	116.0

**SUMMARY OF QUANTITIES**

CODE NUMBER	PAY ITEM	UNIT	PIKE COUNTY
			STP URBAN 80% FEDERAL 20% STATE 1000-1A TOTAL QUANTITY
60605000	COMBINATION CONCRETE CURB AND GUTTER, TYPE B-6.24	FOOT	589.5
60618300	CONCRETE MEDIAN SURFACE, 4 INCH	SQ FT	1445
67000400	ENGINEER'S FIELD OFFICE, TYPE A	CAL MO	2
67100100	MOBILIZATION	L SUM	1
70100500	TRAFFIC CONTROL AND PROTECTION, STANDARD 701326	L SUM	1
70102620	TRAFFIC CONTROL AND PROTECTION, STANDARD 701501	L SUM	1
70102622	TRAFFIC CONTROL AND PROTECTION, STANDARD 701502	L SUM	1
70103815	TRAFFIC CONTROL SURVEILLANCE	CAL DA	5
70300100	SHORT-TERM PAVEMENT MARKING	FOOT	518
70300230	TEMPORARY PAVEMENT MARKING - LINE 5"	FOOT	1603
70300280	TEMPORARY PAVEMENT MARKING - LINE 24"	FOOT	22
70301000	WORK ZONE PAVEMENT MARKING REMOVAL	SQ FT	76
* 78000300	THERMOPLASTIC PAVEMENT MARKING - LINE 5"	FOOT	1488
* 78000400	THERMOPLASTIC PAVEMENT MARKING - LINE 6"	FOOT	115
* 78000600	THERMOPLASTIC PAVEMENT MARKING - LINE 12"	FOOT	28
78003100	PREFORMED PLASTIC PAVEMENT MARKING, TYPE B - LETTERS AND SYMBOLS	SQ FT	117
78003180	PREFORMED PLASTIC PAVEMENT MARKING, TYPE B - LINE 24"	FOOT	22
* 78100100	RAISED REFLECTIVE PAVEMENT MARKER	EACH	25
78300200	RAISED REFLECTIVE PAVEMENT MARKER REMOVAL	EACH	28
* X0322033	STORM SEWER (WATER MAIN REQUIREMENTS) 12 INCH	FOOT	4
* X0322034	STORM SEWER (WATER MAIN REQUIREMENTS) 15 INCH	FOOT	141
X3550610	BITUMINOUS BASE COURSE SUPERPAVE 9 1/2"	SQ YD	305
X4066426	BITUMINOUS CONCRETE SURFACE COURSE, SUPERPAVE, MIX "D", N70	TON	273
X4066770	LEVELING BINDER (MACHINE METHOD), SUPERPAVE N70	TON	37
X4080020	INCIDENTAL BITUMINOUS SURFACING, SUPERPAVE, N50	TON	17
Z0000990	AGGREGATE FOR TEMPORARY ACCESS	TON	35
Z0041700	PLUG EXISTING STORM SEWERS	EACH	4

\* SPECIALTY ITEMS

REVISIONS	
NAME	DATE

ILLINOIS DEPARTMENT OF TRANSPORTATION

**SUMMARY OF QUANTITIES**  
SHEET 1 OF 1

SCALE: NONE  
DATE 12/16/03

DRAWN BY AJP  
CHECKED BY SRD

F.A.P. RTE.	SECTION	COUNTY	TOTAL SHEETS	SHEET NO.
321	18N	PIKE	26	4
STA.		TO STA.		
FED. ROAD DIST. NO.	ILLINOIS	FED. AID PROJECT		
STATE CONTRACT NO. 72691				

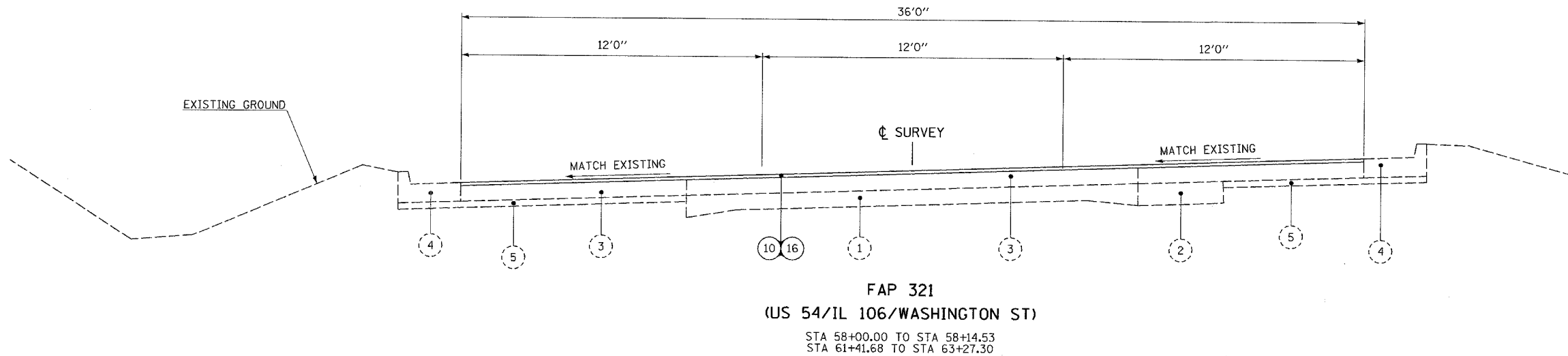
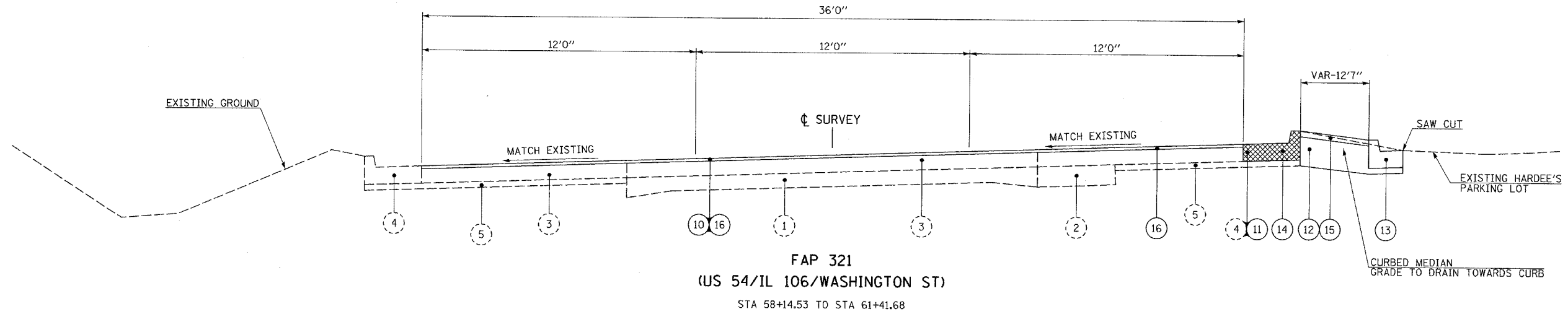

**EXISTING LEGEND**

- ① EXISTING PORTLAND CEMENT CONCRETE PAVEMENT (9"-7"-9")
- ② EXISTING PORTLAND CEMENT CONCRETE BASE COURSE WIDENING
- ③ EXISTING BITUMINOUS BASE COURSE
- ④ EXISTING COMBINATION CURB & GUTTER, TYPE B-6.24
- ⑤ EXISTING AGGREGATE BASE COURSE

**PROPOSED LEGEND**

- ⑩ PROPOSED BITUMINOUS SURFACE REMOVAL 1 1/2"
- ⑪ PROPOSED COMBINATION CURB & GUTTER REMOVAL
- ⑫ PROPOSED SUB-BASE GRANULAR MATERIAL, TYPE A
- ⑬ PROPOSED COMBINATION CONCRETE CURB & GUTTER, TYPE B-6.12
- ⑭ PROPOSED COMBINATION CONCRETE CURB & GUTTER, TYPE B-6.24
- ⑮ PROPOSED CONCRETE MEDIAN SURFACE, 4 INCH
- ⑯ PROPOSED BITUMINOUS CONCRETE SURFACE COURSE, SUPERPAVE, MIX "D", N70 1 1/2"

REVISIONS	
NAME	DATE

ILLINOIS DEPARTMENT OF TRANSPORTATION

**TYPICAL SECTIONS**  
FAP ROUTE 321

SCALE: NONE  
DATE 12/16/03

DRAWN BY AJP  
CHECKED BY SRD

Plot Date: 9/28/2004  
 Plot Time: 10:52:39 PM  
 Plot By: [unclear]  
 Pen Table: [unclear]  
 Filename: I:\01023\work\order-12\construction\plans\04-05.txd\plot.dgn

F.A.P. RTE.	SECTION	COUNTY	TOTAL SHEETS	SHEET NO.
321	18N	PIKE	26	5
STA.		TO STA.		
FED. ROAD DIST. NO.	ILLINOIS	FED. AID PROJECT		
STATE CONTRACT NO. 72691				

**EXISTING LEGEND**

- ① EXISTING PORTLAND CEMENT CONCRETE PAVEMENT (9"-7"-9")
- ② EXISTING PAVEMENT (COMPOSITION UNKNOWN)
- ③ EXISTING PORTLAND CEMENT CONCRETE BASE COURSE WIDENING
- ④ EXISTING BITUMINOUS SURFACE
- ⑤ EXISTING BITUMINOUS BASE COURSE
- ⑥ EXISTING COMBINATION CURB & GUTTER, TYPE B-6.24

**PROPOSED LEGEND**

- ⑩ PROPOSED BITUMINOUS SURFACE REMOVAL 3/4"
- ⑪ PROPOSED COMBINATION CURB & GUTTER REMOVAL
- ⑫ PROPOSED SUB-BASE GRANULAR MATERIAL, TYPE A
- ⑬ PROPOSED COMBINATION CONCRETE CURB & GUTTER, TYPE B-6.12
- ⑭ PROPOSED COMBINATION CONCRETE CURB & GUTTER, TYPE B-6.24
- ⑮ PROPOSED CONCRETE MEDIAN SURFACE, 4 INCH
- ⑯ PROPOSED BITUMINOUS BASE COURSE SUPERPAVE 9 1/2"
- ⑰ PROPOSED LEVELING BINDER (MACHINE METHOD), SUPERPAVE N70, 1"
- ⑱ PROPOSED BITUMINOUS CONCRETE SURFACE COURSE, SUPERPAVE, MIX "D", N70 1 1/2"

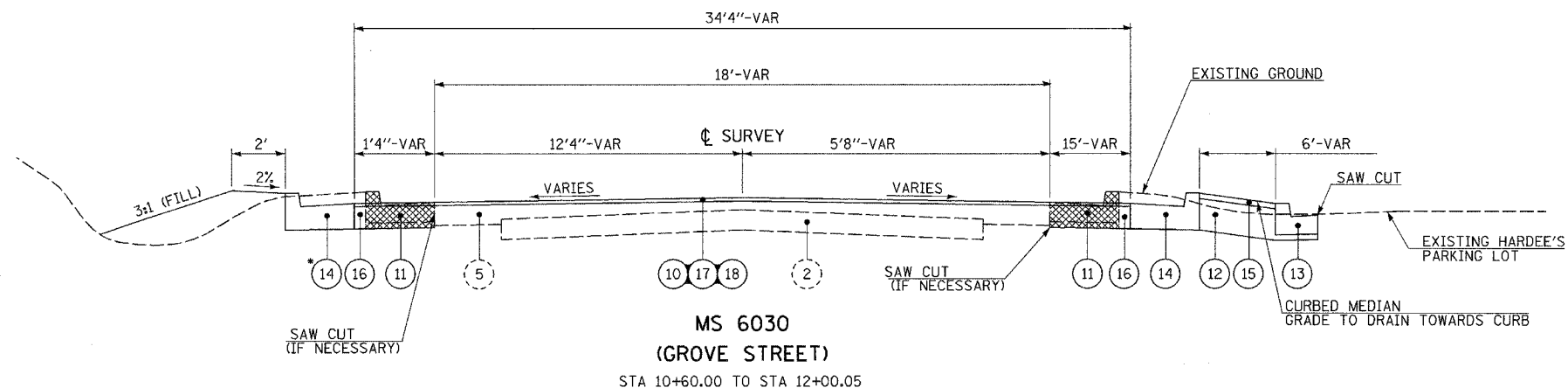

MS 6030  
(GROVE STREET)  
STA 10+60.00 TO STA 12+00.05  
\*CURB REPLACEMENT ENDS AT STA 12+22.98 LT (BEGINNING OF RETAINING WALL)  
\*CURB REPLACEMENT FROM STA 11+23.00 LT TO STA 12+22.98 LT SHALL BE TYPE B-6.18

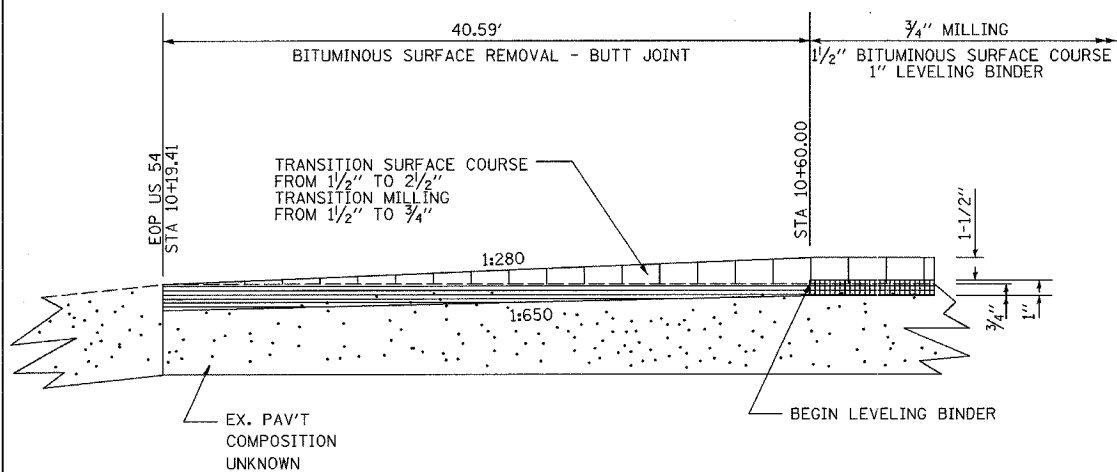

**BUTT JOINT DETAIL  
GROVE STREET AT US 54**  
STA 10+19.41 TO STA 10+60.00

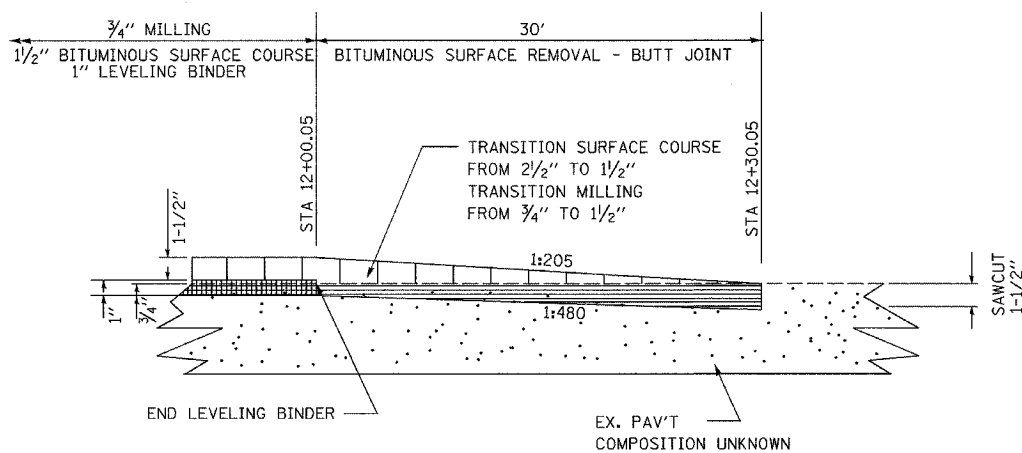

**BUTT JOINT DETAIL  
GROVE STREET**  
STA 12+00.05 TO STA 12+30.05

REVISIONS	
NAME	DATE

ILLINOIS DEPARTMENT OF TRANSPORTATION

**TYPICAL SECTIONS  
GROVE STREET**

SCALE: NONE  
DATE 12/16/03

DRAWN BY: AJP  
CHECKED BY: SRD

Plot Date: 9/28/2004  
 Plot Time: 4:55:29 PM  
 Plotted By: edonachue  
 Pen Table: 1d01.tbl  
 File Name: I:\00129\work\order\12\_Construction\Illinois\04-us-1\typical.dgn

**SURFACING**

LOCATION STATION TO STATION	ROADWAY	BITUMINOUS CONCRETE SURFACE COURSE, SUPERPAVE, MIX "D", N70	LEVELING BINDER (MACHINE METHOD), SUPERPAVE, N70	BITUMINOUS BASE COURSE SUPERPAVE 9 1/2"	BITUMINOUS MATERIALS (PRIME COAT)	AGGREGATE (PRIME COAT)	PAVEMENT REMOVAL	BITUMINOUS SURFACE REMOVAL 3/4"	BITUMINOUS SURFACE REMOVAL 1 1/2"	BITUMINOUS SURFACE REMOVAL - BUTT JOINT	TEMPORARY RAMP	COMMENTS
		TON	TON	SQ YD	TON	TON	SQ YD	SQ YD	SQ YD	SQ YD	SQ YD	
58+00.00 - 63+27.30	US 54	178			0.8	4.2			2124		40	US 54 MILLING AND RESURFACING
59+89.58 - 61+41.67	US 54	9	6	108	0.1	0.2						WIDENING ON NORTHEAST QUADRANT
10+19.41 - 10+60.00	GROVE ST	30			0.1	0.4				205	61	VARIABLE DEPTH MILLING AND RESURFACING
10+44.74 - 12+30.05	GROVE ST	17	11	197	0.1	0.4						WIDENING ON NORTHWEST QUADRANT
10+60.00 - 12+00.05	GROVE ST	29	20		0.1	0.7	273	350				GROVE STREET MILLING AND RESURFACING
12+00.05 - 12+30.05	GROVE ST	10			0.1	0.2				82	14	GROVE STREET BUTT JOINT
<b>TOTALS</b>		273	37	305	1.3	6.1	273	350	2124	287	115	

**ENTRANCES, PARKING LOT & PATCHING**

LOCATION STATION	ROADWAY	ENTRANCE TYPE (CE/PE/FE) OR SIDEROAD	SURFACE TYPE	(1)	(2)	MINIMUM RADIUS	INCIDENTAL BITUMINOUS SURFACING, SUPERPAVE, N50	BITUMINOUS MATERIALS (PRIME COAT)	AGGREGATE (PRIME COAT)	PORTLAND CEMENT CONCRETE DRIVEWAY PAVEMENT 8"	AGGREGATE FOR TEMPORARY ACCESS	DRIVEWAY PAVEMENT REMOVAL	AGGREGATE BASE COURSE, TYPE B 6"	SUB-BASE GRANULAR MATERIAL TYPE A
				WIDTH	LENGTH									
				FEET	FEET	FEET	TON	TON	TON	SQ YD	TON	SQ YD	SQ YD	TON
11+07.03	GROVE ST	CE	PCC	12.0	12.0	10.0				13	3	21		
11+98.05	GROVE ST	CE	BIT	44.0	10.0	5.0	7	0.1	0.1		11	*	50	
58+51.69	US 54	CE	PCC	29.2	16.8	5.0				45	10	81		
59+03.46	US 54	CE	PCC	34.6	16.8	5.0				46	11	54		
10+90.01-10+95.87	GROVE ST OVER PR STM SWR		BIT									*		2
HARDEES PARKING LOT OVER PR STM SWR			BIT	5.2	52.0		4	0.1	0.1					13
HARDEES PARKING LOT ADDITION			BIT				6	0.1	0.1					21
<b>TOTALS</b>							17	0.3	0.3	104	35	156	50	36

NOTES

- (1) WIDTH IS MEASURED AT THE END OF THE RADIUS OF RETURN
- (2) LENGTH IS MEASURED FROM THE EDGE OF PAVEMENT
- \* PAID FOR AS PAVEMENT REMOVAL

REVISIONS	
NAME	DATE

ILLINOIS DEPARTMENT OF TRANSPORTATION

**SCHEDULE OF QUANTITIES**  
SURFACING, ENTRANCES,  
PARKING LOT & PATCHING

SCALE: NONE  
DATE 12/16/03

DRAWN BY AJP  
CHECKED BY SRD

F.A.P. RTE.	SECTION	COUNTY	TOTAL SHEETS	SHEET NO.
321	18N	PIKE	26	7
STA.		TO STA.		
FED. ROAD DIST. NO.	ILLINOIS	FED. AID PROJECT		
STATE CONTRACT NO. 72691				

LOCATION STATION TO STATION	THERMOPLASTIC PAVEMENT MARKING				PREFORMED PLASTIC PAVEMENT MARKING TYPE B		TEMPORARY PAVEMENT MARKING- LINE 5"	TEMPORARY PAVEMENT MARKING- LINE 24"	SHORT-TERM PAVEMENT MARKING	WORK ZONE PAVEMENT MARKING REMOVAL	RAISED REFLECTIVE PAVEMENT MARKER	RAISED REFLECTIVE PAVEMENT MARKER REMOVAL
	SKIP DASH YELLOW LINE 5"	SOLID YELLOW LINE 5"	SOLID WHITE LINE 6"	SOLID YELLOW LINE 12"	LETTERS & SYMBOLS	SOLID WHITE LINE 24"						
	FOOT	FOOT	FOOT	FOOT	SQ FT	FOOT						
58+00.00 - 63+27.30 US 54	80	1019	115	28	117		1214		354	58	25	28
10+35.66 - 12+30.05 GROVE ST		389					389	22	164	18		
<b>TOTALS</b>	<b>80</b>	<b>1408</b>	<b>115</b>	<b>28</b>	<b>117</b>		<b>1603</b>	<b>22</b>	<b>518</b>	<b>76</b>	<b>25</b>	<b>28</b>

NOTE: SHORT-TERM PAVEMENT MARKING QUANTITIES ARE FOR 2 APPLICATIONS ON US 54 AND 3 APPLICATIONS ON GROVE STREET.

LOCATION STATION TO STATION	EARTH EXCAVATION	EARTH EXCAVATION ADJUSTED FOR SHRINKAGE	EMBANKMENT	EARTHWORK BALANCE WASTE (+) OR SHORTAGE (-)
	CU YD	CU YD	CU YD	CU YD
58+00.00 - 63+27.05 US 54	200	150	50	+100
10+76.02 - 12+30.05 GROVE ST	85	65	5	+60
<b>TOTALS</b>	<b>285</b>	<b>215</b>	<b>55</b>	<b>+160</b>

SHRINKAGE FACTOR IS ASSUMED TO BE 25%

LOCATION STATION TO STATION	ROADWAY	PAVEMENT PATCHING, TYPE II, 10 INCH
		SQ YD
10+90.01 - 10+95.87	GROVE ST	7
<b>TOTALS</b>		<b>7</b>

REVISIONS	
NAME	DATE

ILLINOIS DEPARTMENT OF TRANSPORTATION

**SCHEDULE OF QUANTITIES**  
PAVEMENT MARKING, EARTHWORK  
& PAVEMENT PATCHING

SCALE: NONE  
DATE 12/16/03

DRAWN BY AJP  
CHECKED BY SRD

**DRAINAGE STRUCTURES**

LOCATION STATION	OFFSET DISTANCE	INLETS, TYPE B, TYPE 3 FRAME AND GRATE	INLETS, TYPE B, TYPE 8 GRATE	INLETS, TYPE B, TYPE 1 FRAME, OPEN LID	INLET AND PIPE PROTECTION	REMOVING INLETS	STORM SEWER (WATER MAIN REQUIREMENTS) 12 INCH	STORM SEWER (WATER MAIN REQUIREMENTS) 15 INCH	CONCRETE COLLAR	PLUG EXISTING STORM SEWERS	STORM SEWER REMOVAL 15"	TRENCH BACKFILL
	FEET	EACH	EACH	EACH	EACH	EACH	FOOT	FOOT	EACH	EACH	FOOT	CU YD
10+41.91 GROVE ST	29.9 LT					1					61	
10+43.74 GROVE ST	34.1 LT		1		1			21				4
10+60.29 GROVE ST	16.4 LT	1						27				6
10+89.95 GROVE ST	14.5 LT	1					4		1			1
10+94.67 GROVE ST	14.0 LT					1						
10+99.73 GROVE ST	21.8 RT	1						36				6
59+08.67 US 54	60.7 RT			1		1		57			47	10
59+08.67 - 59+33.88 US 54										2		
59+76.52 - 60+11.59 US 54										2		
<b>TOTALS</b>		<b>3</b>	<b>1</b>	<b>1</b>	<b>1</b>	<b>3</b>	<b>4</b>	<b>141</b>	<b>1</b>	<b>4</b>	<b>108</b>	<b>27</b>

**SODDING & TEMPORARY SEEDING**

LOCATION STATION TO STATION	SODDING	SUPPLEMENTAL WATERING	NITROGEN FERTILIZER NUTRIENT	PHOSPHORUS FERTILIZER NUTRIENT	POTASSIUM FERTILIZER NUTRIENT	AGRICULTURAL GROUND LIMESTONE	TEMPORARY EROSION CONTROL SEEDING
	SQ YD	UNIT	POUND	POUND	POUND	TON	POUND
59+94.76 - 61+41.67 US 54	172	1.5	3	1	1	1	4
<b>TOTALS</b>	<b>172</b>	<b>1.5</b>	<b>3</b>	<b>1</b>	<b>1</b>	<b>1</b>	<b>4</b>

REVISIONS	
NAME	DATE

ILLINOIS DEPARTMENT OF TRANSPORTATION

**SCHEDULE OF QUANTITIES**  
DRAINAGE STRUCTURES & SODDING

SCALE: NONE  
DATE 12/16/03

DRAWN BY AJP  
CHECKED BY SRD

Plot Date: 1/3/2005  
 Plotted By: sdrachuk  
 Pen Table: ddt.tbl  
 Filename: I:\0203\Work\0-dar-12\Construction\Plans\06-03\_Schedule.dgn



F.A.P. RTE.	SECTION	COUNTY	TOTAL SHEETS	SHEET NO.
321	18N	PIKE	26	9
STA.		TO STA.		
FED. ROAD DIST. NO.	ILLINOIS	FED. AID PROJECT		
STATE CONTRACT NO. 72691				

CONCRETE CURB AND GUTTER							COMMENTS
LOCATION STATION TO STATION	COMBINATION CONCRETE CURB AND GUTTER TYPE B-6.12	COMBINATION CONCRETE CURB AND GUTTER TYPE B-6.18	COMBINATION CONCRETE CURB AND GUTTER TYPE B-6.24	COMBINATION CURB AND GUTTER REMOVAL	CONCRETE MEDIAN SURFACE (4 INCH)	SUB-BASE GRANULAR MATERIAL TYPE A	
	FOOT	FOOT	FOOT	FOOT	SQ FT	TON	
58+14.53 - 58+19.71 RT US 54			60.0				DEPRESSED CURB FOR CE STA 58+52
58+33.07 - 58+70.28 RT US 54			38.0				MEDIAN DIVIDING CE'S ON US 54
58+65.35 - 58+89.69 RT US 54					241	27	MEDIAN DIVIDING CE'S ON US 54
58+68.40 - 58+86.74 RT US 54	19.0		45.5				EX ROUNDING FOR CE STA 58+52
58+79.05 - 58+95.96 RT US 54				28			DEPRESSED CURB FOR CE STA 59+03
58+84.86 - 59+22.07 RT US 54			38.0				ROUNDING ON WEST SIDE OF CE STA 59+03
59+19.91 - 59+28.96 RT US 54			22.5				EX ROUNDING ON NORTHWEST SIDE OF CE STA 59+03
59+28.18 - 59+60.00 RT US 54				70			EX CURB ROUNDING NORTHWEST QUADRANT
60+35.00 - 61+41.68 RT US 54				109			CURB ROUNDING NORTHWEST QUADRANT
60+35.89 - 61+41.67 RT US 54			110.5				
10+11.93 - 11+02.09 LT GROVE ST				96			EX CURB ROUNDING NORTHWEST QUADRANT
10+25.77 - 11+01.36 LT GROVE ST			87.5				CURB ROUNDING NORTHWEST QUADRANT
10+38.23 - 10+75.27 RT GROVE ST				57			EX CURB ROUNDING NORTHEAST QUADRANT
10+47.12 - 11+76.03 RT GROVE ST			170.5				CURB ROUNDING NORTHEAST QUADRANT
10+61.00 - 11+79.44 RT GROVE ST					1204	124	MEDIAN DIVIDING GROVE FROM HARDEE'S PARKING
10+63.00 - 11+76.03 RT GROVE ST	149.5						CURB ALONG HARDEES PARKING
10+98.41 - 11+15.16 LT GROVE ST			17.0				DEPRESSED CURB THRU CE STA 11+07
11+13.11 - 12+22.98 LT GROVE ST		116.0					CURB ALONG LEFT SIDE OF GROVE
11+23.11 - 12+22.98 LT GROVE ST				100			EX CURB ALONG LEFT SIDE OF GROVE
TOTALS	168.5	116.0	589.5	460	1445	151	

Plot Date: 1/13/2005  
 Plot Time: 10:00 AM  
 Plotted By: edonahue  
 Pen Table: idot.tbl  
 File Name: I:\0203\Work-Or-dcr-IP\Construction\Plans\06-09\_Schedule.dgn

REVISIONS	
NAME	DATE

ILLINOIS DEPARTMENT OF TRANSPORTATION

**SCHEDULE OF QUANTITIES**

CONCRETE CURB AND GUTTER

SCALE: NONE  
DATE 12/16/03

DRAWN BY: AJP  
CHECKED BY: SRD





WEST QUADRANT

POINT	¢	STATION	OFFSET	NORTHING	EASTING	ELEVATION	COMMENT
100	US 54	61+41.67	18.38 RT	1,071,202.96	2,111,896.39	774.47	EOP
101	US 54	61+31.85	18.53 RT	1,071,208.00	2,111,905.04	774.09	EOP
102	US 54	61+22.05	18.98 RT	1,071,213.20	2,111,913.57	773.70	EOP
103	US 54	61+12.27	19.72 RT	1,071,218.57	2,111,922.01	773.32	EOP
104	US 54	61+02.52	20.76 RT	1,071,224.11	2,111,930.33	772.94	EOP
105	US 54	60+92.82	22.10 RT	1,071,229.82	2,111,938.54	772.55	EOP
106	US 54	60+83.17	23.73 RT	1,071,235.69	2,111,946.64	772.17	EOP
107	US 54	60+73.59	25.65 RT	1,071,241.72	2,111,954.62	772.07	EOP
108	US 54	60+64.09	27.86 RT	1,071,247.91	2,111,962.47	771.96	EOP
109	US 54	60+54.69	30.35 RT	1,071,254.25	2,111,970.20	771.86	EOP
110	US 54	60+45.37	33.13 RT	1,071,260.75	2,111,977.80	771.75	EOP
111	US 54	60+36.17	36.19 RT	1,071,267.40	2,111,985.27	771.37	EOP
112	GROVE ST	10+24.48	36.13 LT	1,071,268.26	2,111,986.21	771.30	EOP, POINT OF COMPOUND CURVATURE
113	GROVE ST	10+31.75	29.28 LT	1,071,275.52	2,111,993.07	770.74	EOP
114	GROVE ST	10+39.92	23.53 LT	1,071,283.70	2,111,998.82	770.18	EOP
115	GROVE ST	10+48.83	19.00 LT	1,071,292.60	2,112,003.35	769.62	EOP
116	GROVE ST	10+58.29	15.78 LT	1,071,302.06	2,112,006.56	769.06	EOP
117	GROVE ST	10+68.11	13.95 LT	1,071,311.88	2,112,008.39	768.51	EOP
118	GROVE ST	10+76.02	13.50 LT	1,071,319.79	2,112,008.84	768.25	EOP
150	GROVE ST	10+91.23	25.50 LT	1,071,335.00	2,111,996.84		RADIUS POINT
151	GROVE ST	11+23.09	24.96 LT	1,071,366.87	2,111,997.38		RADIUS POINT
152	US 54	60+55.73	103.00 RT.	1,071,319.79	2,111,938.84		RADIUS POINT - 70' - GROVE ST EOP
153	GROVE ST	13+93.78	373.20 LT	1,071,637.55	2,111,649.13		RADIUS POINT - 500' - US 54 EOP

EAST QUADRANT

POINT	¢	STATION	OFFSET	NORTHING	EASTING	ELEVATION	COMMENT
200	US 54	59+31.11	18.12 RT	1,071,288.44	2,112,092.59	765.82	EOP
201	GROVE ST	10+43.86	60.31 RT	1,071,287.64	2,112,082.65	766.18	EOP
202	GROVE ST	10+45.90	50.55 RT	1,071,289.67	2,112,072.90	766.27	EOP
203	GROVE ST	10+50.60	41.77 RT	1,071,294.37	2,112,064.11	766.34	EOP
204	GROVE ST	10+57.58	34.66 RT	1,071,301.36	2,112,057.00	766.43	EOP
205	GROVE ST	10+66.29	29.81 RT	1,071,310.06	2,112,052.15	766.49	EOP
206	GROVE ST	10+68.54	29.03 RT	1,071,312.32	2,112,051.38	766.50	EOP, POINT OF COMPOUND CURVATURE
207	GROVE ST	10+78.14	26.23 RT	1,071,321.92	2,112,048.57	766.55	EOP
208	GROVE ST	10+87.81	23.66 RT	1,071,331.58	2,112,046.00	766.70	EOP
209	GROVE ST	10+97.53	21.34 RT	1,071,341.30	2,112,043.68	766.87	EOP
210	GROVE ST	11+07.30	19.25 RT	1,071,351.07	2,112,041.60	767.04	EOP
211	GROVE ST	11+17.12	17.42 RT	1,071,360.90	2,112,039.76	767.32	EOP
212	GROVE ST	11+26.99	15.83 RT	1,071,370.77	2,112,038.17	767.53	EOP
213	GROVE ST	11+36.90	14.49 RT	1,071,380.67	2,112,036.83	767.64	EOP
214	GROVE ST	11+46.83	13.39 RT	1,071,390.60	2,112,035.73	767.73	EOP
215	GROVE ST	11+56.79	12.55 RT	1,071,400.56	2,112,034.89	767.79	EOP
216	GROVE ST	11+66.75	11.95 RT	1,071,410.53	2,112,034.29	767.80	EOP
217	GROVE ST	11+75.81	11.62 RT	1,071,419.58	2,112,033.96	767.70	EOP
250	GROVE ST	11+75.93	16.62 RT	1,071,419.70	2,112,038.96		RADIUS POINT
251	GROVE ST	10+85.27	60.58 RT	1,071,329.04	2,112,082.93		RADIUS POINT - 25' - PARKING LOT EOP
252	US 54	59+29.36	33.00 RT	1,071,303.17	2,112,089.82		RADIUS POINT - 15' - US 54 EOP
253	US 54	59+20.19	29.75 RT	1,071,302.86	2,112,099.82		RADIUS POINT
254	US 54	58+86.74	29.75 RT	1,071,312.36	2,112,132.93		RADIUS POINT
255	US 54	58+77.57	33.00 RT	1,071,317.91	2,112,141.24		RADIUS POINT
256	US 54	58+68.40	29.75 RT	1,071,317.09	2,112,151.21		RADIUS POINT
257	US 54	58+25.77	33.00 RT	1,071,329.97	2,112,193.36		RADIUS POINT
258	US 54	59+28.33	53.00 RT	1,071,322.57	2,112,084.84		RADIUS POINT - 35' - GROVE ST EOP
259	US 54	58+86.74	34.75 RT	1,071,317.18	2,112,131.63		RADIUS RETURN TIE IN
260	US 54	58+68.40	34.75 RT	1,071,321.94	2,112,150.00		RADIUS RETURN TIE IN
261	US 54	59+20.19	34.75 RT	1,071,307.65	2,112,098.36	764.26	PARKING LOT EOP
262	US 54	59+29.85	34.81 RT	1,071,304.74	2,112,088.79	766.06	PARKING LOT EOP
263	US 54	59+39.08	37.49 RT	1,071,304.37	2,112,078.87	766.00	PARKING LOT EOP
264	GROVE ST	10+65.04	45.89 RT	1,071,308.82	2,112,068.23	765.01	PARKING LOT EOP
265	GROVE ST	10+72.36	39.17 RT	1,071,316.13	2,112,061.52	764.77	PARKING LOT EOP
266	US 54	55+91.71	111.84 RT	1,071,429.56	2,112,433.84		RADIUS POINT - 400' - GROVE ST EOP
267	US 54	58+14.53	18.00 RT	1,071,317.51	2,112,207.60		US 54 EOP
268	US 54	58+21.48	53.55 RT	1,071,351.01	2,112,193.69		PARKING LOT EOP
269	US 54	58+23.59	49.09 RT	1,071,346.19	2,112,192.38		BACK OF CURB ANGLE POINT
270	US 54	58+19.42	49.62 RT	1,071,347.57	2,112,196.57		END BACK OF CURB

PAVEMENT MARKING

POINT	¢	STATION	OFFSET	NORTHING	EASTING	COMMENT
500	US 54	58+00.00	6.00 LT	1,071,296.57	2,112,226.33	BEGIN TWO WAY LEFT TURN LINE
501	US 54	58+00.00	6.00 RT	1,071,308.39	2,112,224.23	BEGIN TWO WAY LEFT TURN LINE
502	US 54	58+31.77	0.00 RT	1,071,296.43	2,112,194.10	URBAN LEFT TURN ARROW
503	US 54	58+44.34	0.00 RT	1,071,293.76	2,112,181.82	URBAN LEFT TURN ARROW
504	US 54	58+93.38	6.00 LT	1,071,276.10	2,112,135.83	BEGIN DOUBLE CENTERLINE W/ 300' R
505	US 54	58+93.38	6.00 RT	1,071,287.66	2,112,132.64	BEGIN DOUBLE CENTERLINE
506	US 54	59+53.56	4.00 RT	1,071,267.93	2,112,075.45	RADIUS POINT
507	US 54	60+39.81	6.00 LT	1,071,227.28	2,111,998.85	BEGIN SOLID WHITE LINE
508	US 54	60+39.81	6.00 RT	1,071,238.26	2,111,994.01	BEGIN DOUBLE CENTERLINE
509	US 54	60+53.15	0.00 RT	1,071,227.31	2,111,984.26	URBAN LEFT TURN ARROW
510	US 54	61+45.27	0.00 RT	1,071,185.20	2,111,902.36	URBAN LEFT TURN ARROW
511	US 54	61+55.50	6.00 LT	1,071,174.90	2,111,896.55	END SOLID WHITE LINE
512	US 54	62+63.76	6.00 LT	1,071,117.05	2,111,805.35	BEGIN TWO WAY LEFT TURN LINE
513	US 54	62+73.76	6.00 RT	1,071,121.71	2,111,790.44	END DBL CL, BEGIN TWO WAY LEFT TURN LINE
514	US 54	63+27.30	6.00 LT	1,071,082.57	2,111,751.98	END TWO WAY LEFT TURN LINE
515	US 54	63+27.30	6.00 RT	1,071,092.65	2,111,745.47	END TWO WAY LEFT TURN LINE
516	GROVE ST	10+36.66	1.50 LT	1,071,280.44	2,112,020.84	BEGIN STOP LINE, BEGIN DBL SOLID YELLOW LINE
517	GROVE ST	10+36.66	13.90 LT	1,071,280.43	2,112,008.45	STOP LINE BREAK POINT
518	GROVE ST	10+41.67	22.50 LT	1,071,285.44	2,111,999.84	END STOP LINE
519	GROVE ST	12+30.05	1.50 LT	1,071,473.83	2,112,020.84	END DBL SOLID YELLOW LINE
520	US 54	62+93.18	0.00 RT	1,071,106.13	2,111,777.38	URBAN LEFT TURN ARROW
521	US 54	62+81.98	0.00 RT	1,071,112.20	2,111,786.79	URBAN LEFT TURN ARROW
522	US 54	59+72.84	8.05 RT	1,071,265.30	2,112,055.81	POINT OF COMPOUND CURVATURE, STRIPING CURVE
523	GROVE ST	10+56.52	33.50 RT	1,071,300.30	2,112,055.84	RADIUS POINT - 35' - STRIPING CURVE
524	GROVE ST	13+21.52	33.73 RT	1,071,565.30	2,112,056.07	RADIUS POINT - 300' - STRIPING CURVE

GROVE STREET EXISTING EDGE OF PAVEMENT DETAIL

POINT	¢	STATION	OFFSET	NORTHING	EASTING	ELEVATION	COMMENT
600	US 54	59+31.12	18.06 RT	1,071,288.38	2,112,092.60	765.81	GROVE ST EX EOP
601	US 54	59+52.30	19.02 RT	1,071,282.56	2,112,071.81	766.54	GROVE ST EX EOP
602	US 54	59+70.98	28.34 RT	1,071,285.02	2,112,050.68	766.97	GROVE ST EX EOP
603	GROVE ST	10+54.92	11.91 RT	1,071,298.70	2,112,034.25	767.32	GROVE ST EX EOP
604	GROVE ST	10+75.27	5.61 RT	1,071,319.04	2,112,027.96	767.70	GROVE ST EX EOP
700	US 54	61+41.67	18.38 RT	1,071,202.96	2,111,896.39	774.47	US 54 EOP
701	US 54	61+17.12	18.38 RT	1,071,215.06	2,111,918.27	773.49	US 54 EOP
702	US 54	60+92.57	18.38 RT	1,071,226.61	2,111,940.44	772.58	US 54 EOP
703	US 54	60+68.02	18.38 RT	1,071,237.62	2,111,962.89	771.70	US 54 EOP
704	US 54	60+43.71	20.64 RT	1,071,250.05	2,111,984.46	770.76	US 54 EOP
705	GROVE ST	10+25.09	21.95 LT	1,071,268.87	2,112,000.40	770.06	GROVE ST EOP
706	GROVE ST	10+49.40	16.50 LT	1,071,293.17	2,112,005.84	769.12	GROVE ST EOP
707	GROVE ST	10+73.92	12.51 LT	1,071,317.69	2,112,009.84	768.30	GROVE ST EOP
708	GROVE ST	11+02.09	18.41 LT	1,071,345.86	2,112,003.93	768.33	GROVE ST EOP

REVISIONS	
NAME	DATE

ILLINOIS DEPARTMENT OF TRANSPORTATION

**INTERSECTION AND PAVEMENT MARKING DETAIL**

FAP ROUTE 321

SCALE: NONE  
DATE 12/16/03

DRAWN BY: AJP  
CHECKED BY: SRD

PLAN  
SUBMITTED BY: \_\_\_\_\_ DATE: \_\_\_\_\_  
NOTED BY: \_\_\_\_\_  
CHECKED BY: \_\_\_\_\_  
DATE: \_\_\_\_\_

PROFILE  
SUBMITTED BY: \_\_\_\_\_ DATE: \_\_\_\_\_  
NOTED BY: \_\_\_\_\_  
CHECKED BY: \_\_\_\_\_  
DATE: \_\_\_\_\_

F.A.P. RTE.	SECTION	COUNTY	TOTAL SHEETS	SHEET NO.
321	18N	PIKE	26	13
STA.	TO STA.			
FED. ROAD DIST. NO.	ILLINOIS	FED. AID PROJECT	STATE CONTRACT NO. 72691	

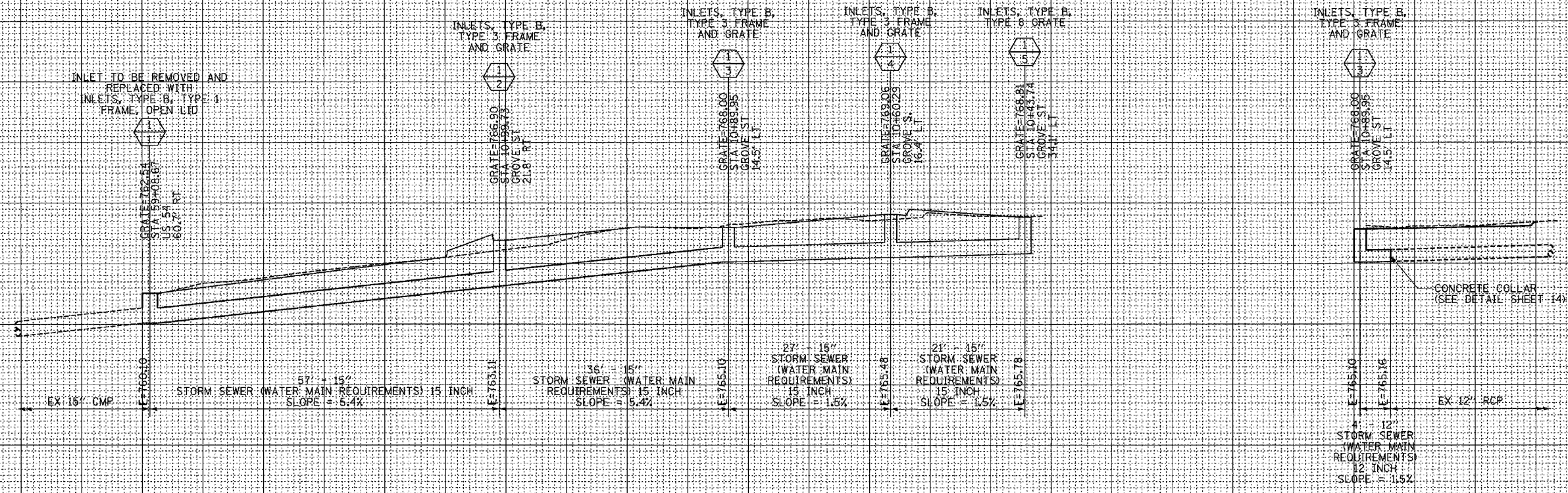

PLOTTED BY: 8600400  
 PEN TABLE: 1dot.tbl  
 FILENAME: I:\0029\Work\Order-12\Construction Plans\13 Storm Sewer Profile.dgn  
 DATE: 11/02/2011  
 AREA: 1E  
 AREAS CHECKED  
 NO.  
 DATE: 11/02/2011  
 AREA: 1E  
 AREAS CHECKED  
 NO.

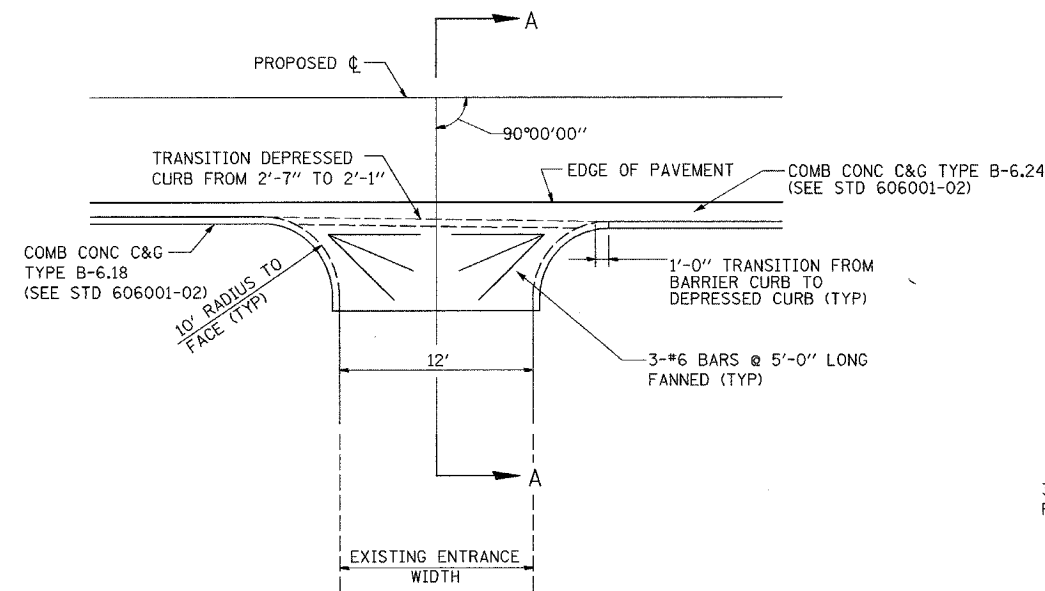

**CE DETAIL A**  
 GROVE ST STA 11+07.03 LT  
 COMMERCIAL ENTRANCE WITH COMBINATION  
 CONCRETE CURB & GUTTER TYPE B-6.24  
 CONNECTING TO CONCRETE CURB & GUTTER TYPE B-6.18

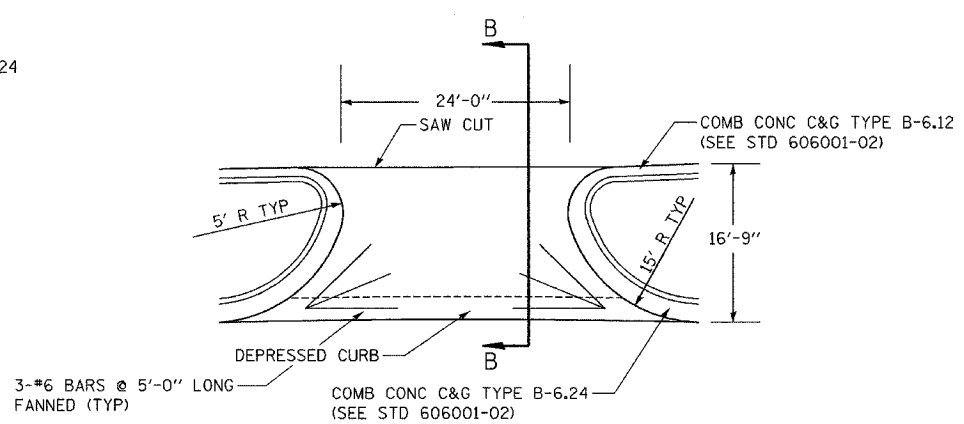

**CE DETAIL B**  
 US 54 STA 58+51.69 RT  
 US 54 STA 59+03.46 RT  
 COMMERCIAL ENTRANCE WITH COMBINATION  
 CONCRETE CURB & GUTTER TYPE B-6.24

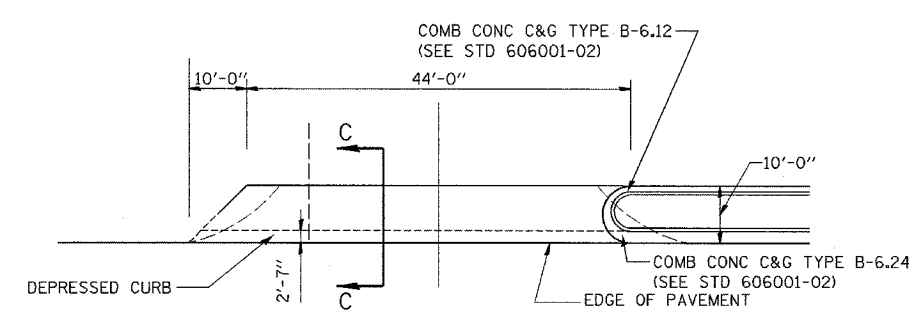

**CE DETAIL C**  
 GROVE ST STA 11+98.05 RT  
 COMMERCIAL ENTRANCE WITH COMBINATION  
 CONCRETE CURB & GUTTER TYPE B-6.24

**NOTE:**  
 THE COST OF FURNISHING AND INSTALLING  
 THE 3/4" PREFORMED EXPANSION JOINT FILLER  
 AND REINFORCEMENT BARS SHALL BE INCLUDED  
 IN THE COST OF THE PCC DRIVEWAY PAVEMENT

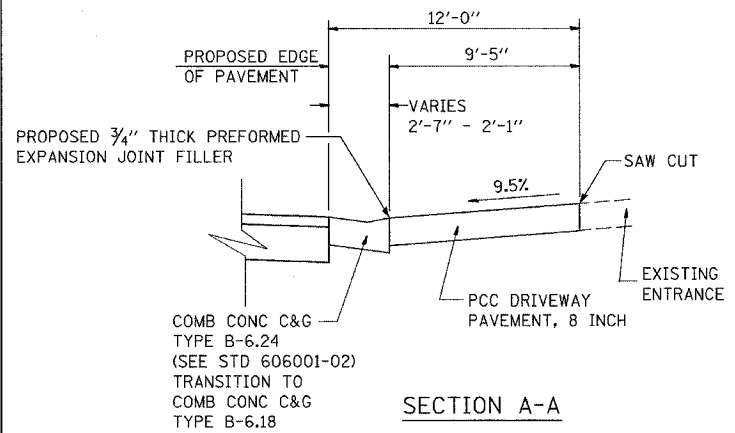

**SECTION A-A**

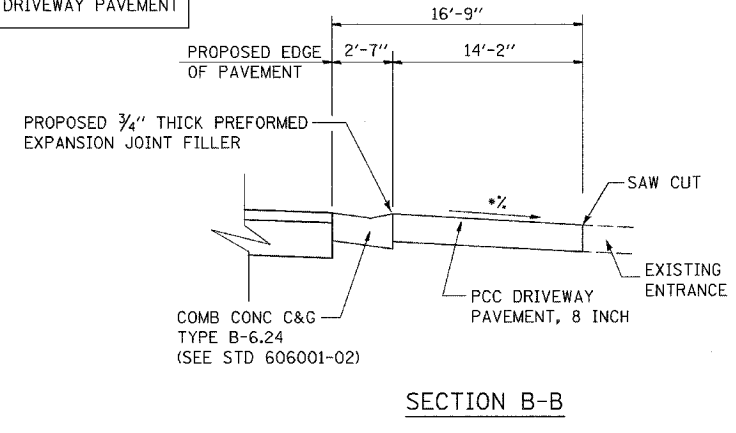

**SECTION B-B**

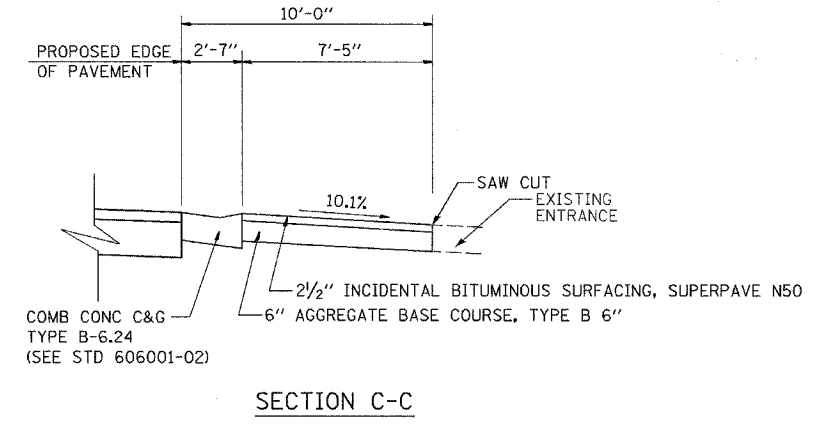

**SECTION C-C**

\* SEE CROSS SECTIONS FOR SLOPE

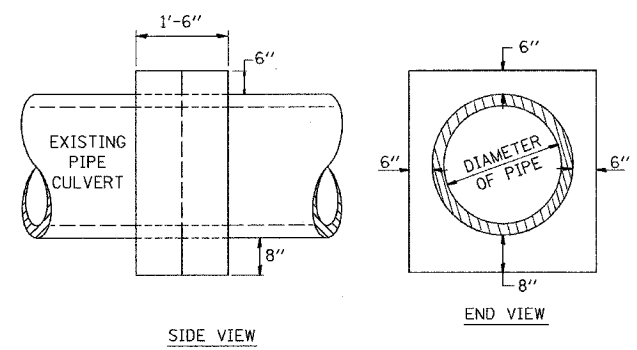

**CONCRETE COLLAR DETAIL**  
 SEE SHEET 13 FOR LOCATION

**TABULATION**

DIAMETER OF PIPE	CL. SI CONC. CU. YDS. EST.
12"	0.24
15"	0.29
18"	0.32
24"	0.44
30"	0.56
36"	0.66
42"	0.80
48"	0.93
54"	1.07
60"	1.22
72"	1.55

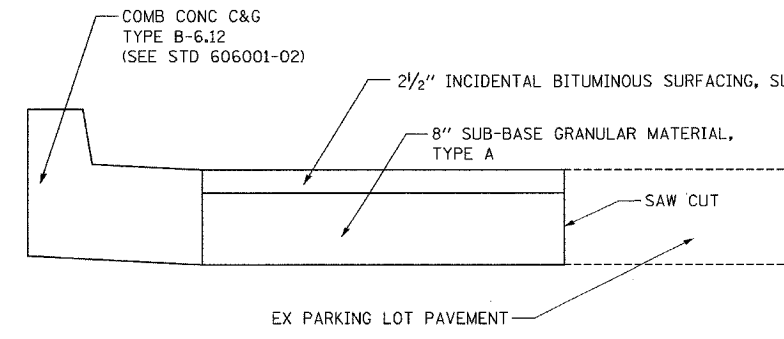

**PARKING LOT ADDITION DETAIL**  
 SEE SHEET 10 FOR LOCATION

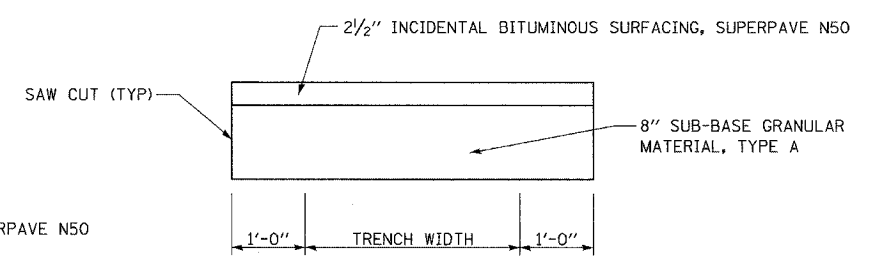

**PAVEMENT PATCH - PARKING LOT OVER STORM SEWER**  
 SEE SHEET 10 FOR LOCATION

**REVISIONS**

NAME	DATE

ILLINOIS DEPARTMENT OF TRANSPORTATION  
**MISCELLANEOUS DETAILS**  
 FAP ROUTE 321  
 SCALE: NONE  
 DATE 12/16/03  
 DRAWN BY: AJP  
 CHECKED BY: SRD

Plot Date: 9/28/2004  
 Plot Time: 15:53:34 PM  
 Plotter: E:\adonchue  
 Pen Table: 10025\work\order\12\constr\action\plans\misc\_details.dgn

THE CONCRETE COLLAR SHALL BE PAID FOR AT THE CONTRACT UNIT PRICE PER EACH FOR **CONCRETE COLLAR**, AS SHOWN ON THE PLANS, WHICH PRICE SHALL INCLUDE THE REMOVAL OF SUCH PORTIONS OF THE EXISTING HEADWALLS AS MAY BE REQUIRED.  
 CLASS SI CONCRETE SHALL BE USED THROUGHOUT.

F.A.P. RTE.	SECTION	COUNTY	TOTAL SHEETS	SHEET NO.
321	18N	PIKE	26	15
STA. 58+00.00	TO STA. 58+14.53			
FED. ROAD DIST. NO.	ILLINOIS	FED. AID PROJECT		
65	70	75	80	
STATE CONTRACT NO. 72691				

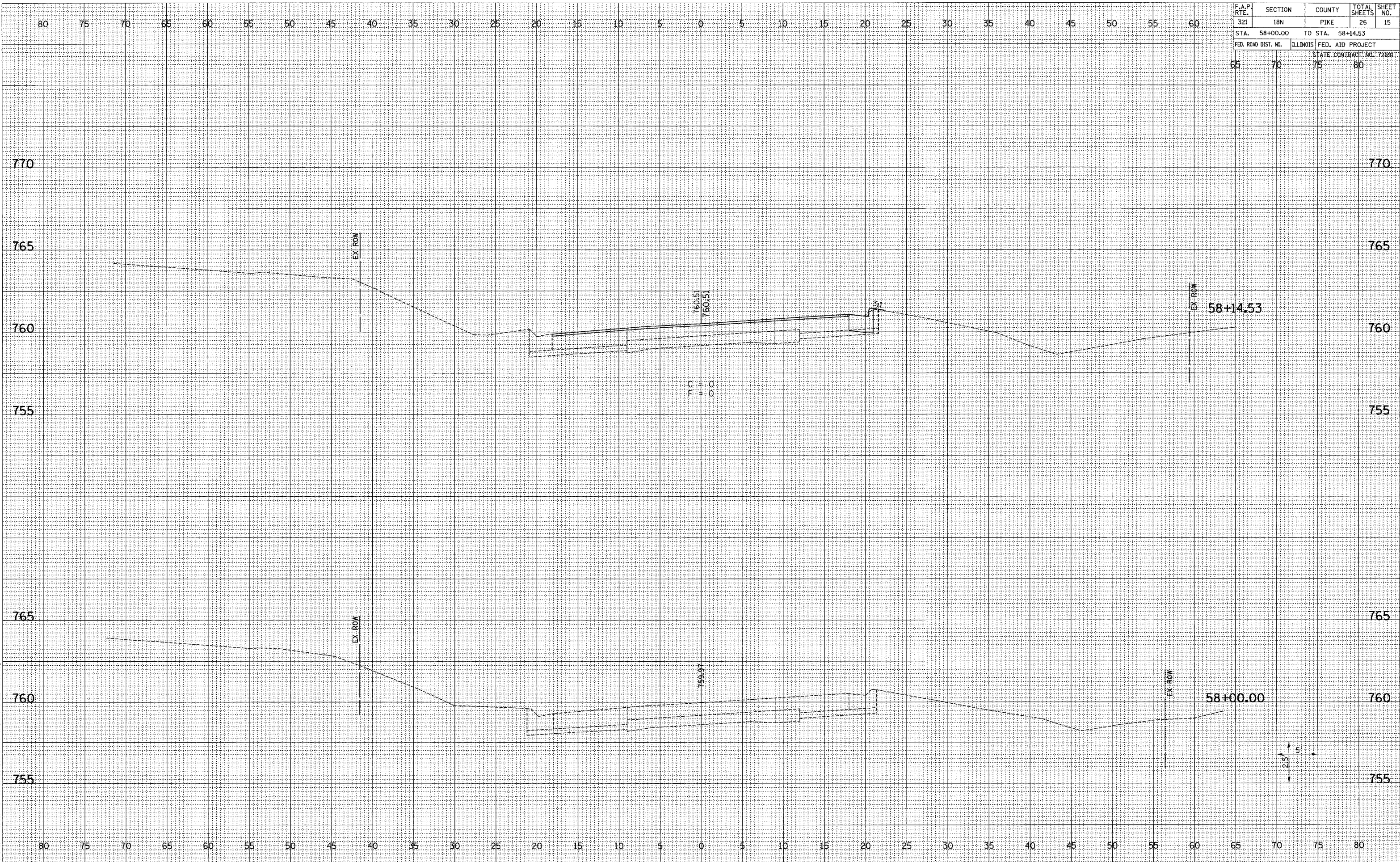

DATE	BY
FINAL SURVEY	SURVEYED
NOTE BOOK	PLOTTED
NO.	AREAS CHECKED

DATE	BY
ORIGINAL SURVEY	SURVEYED
NOTE BOOK	PLOTTED
NO.	AREAS CHECKED

Plot Date: 9/29/2014  
 Plot By: JSS/PA  
 Plot Date: 10/1/2014  
 Plot By: JSS/PA  
 File Name: I:\029\work\_order\PA\_construction\plans\18-22-x6-us54.dgn

F.A.P. RTE.	SECTION	COUNTY	TOTAL SHEETS	SHEET NO.
321	18N	PIKE	26	16
STA. 58+50.00	TO STA. 58+51.69			
FED. ROAD DIST. NO.	ILLINOIS	FED. AID PROJECT		
65	70	75	80	
STATE CONTRACT NO. Y2691				

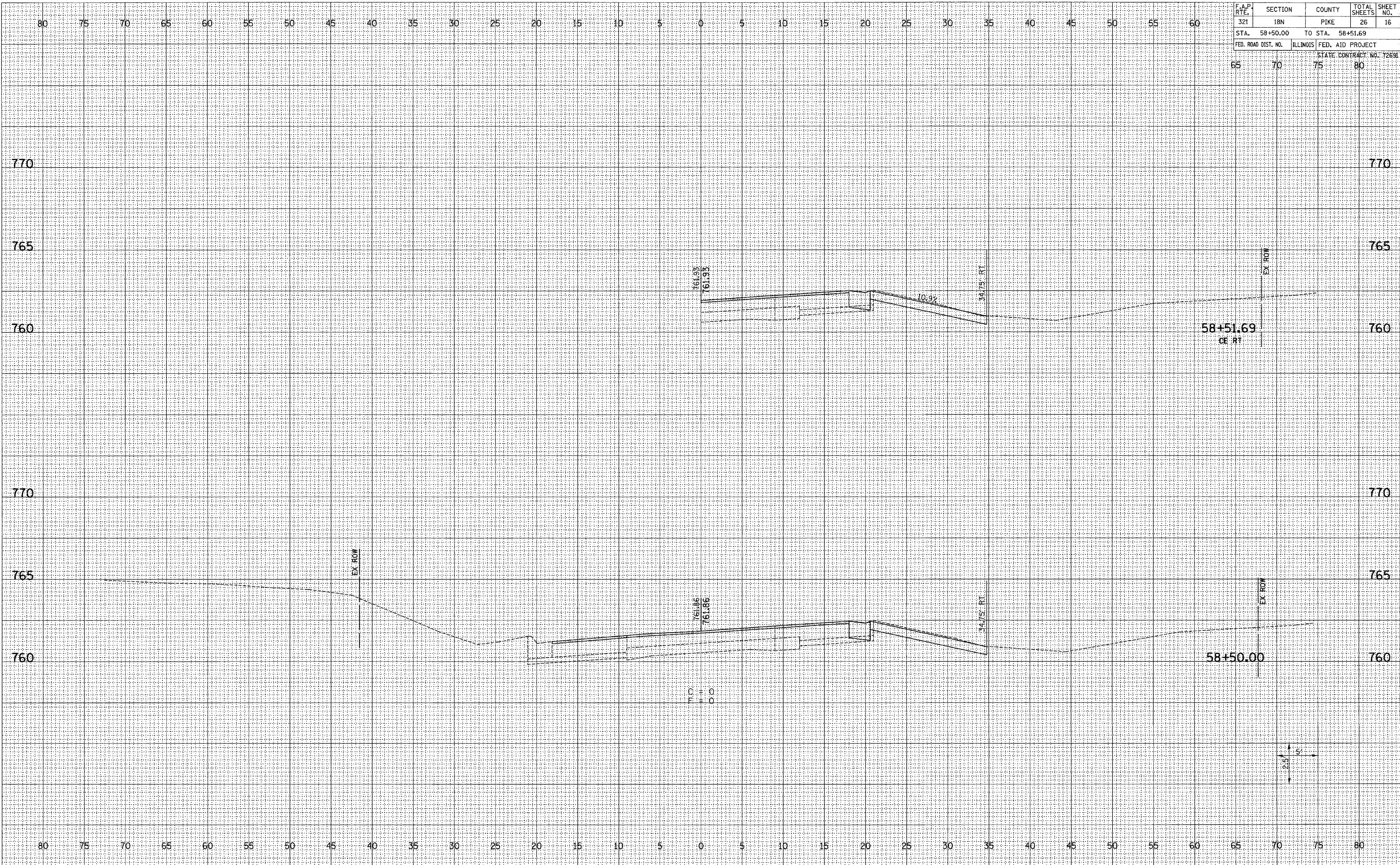

FINAL SURVEY	DATE
SURVEYED	
PLOTTED	
NOTE BOOK	
AREAS CHECKED	
NO.	

ORIGINAL SURVEY	DATE
SURVEYED	
PLOTTED	
NOTE BOOK	
AREAS CHECKED	
NO.	

Plot Date: 9/28/2004  
 Plot Time: 10:55:35 PM  
 Plotted By: sdonahue  
 Pen Table: 1dot.tbl  
 Filename: I:\0023\work\_order\2\construction\plans\15-22.xb\_lrs54.dgn





F.A.P. RTE.	SECTION	COUNTY	TOTAL SHEETS	SHEET NO.
321	18N	PIKE	26	18
STA. 59+50.00	TO STA. 60+00.00			
FED. ROAD DIST. NO.	ILLINOIS	FED. AID PROJECT		
65	70	75	STATE CONTRACT NO. 72631	

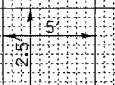
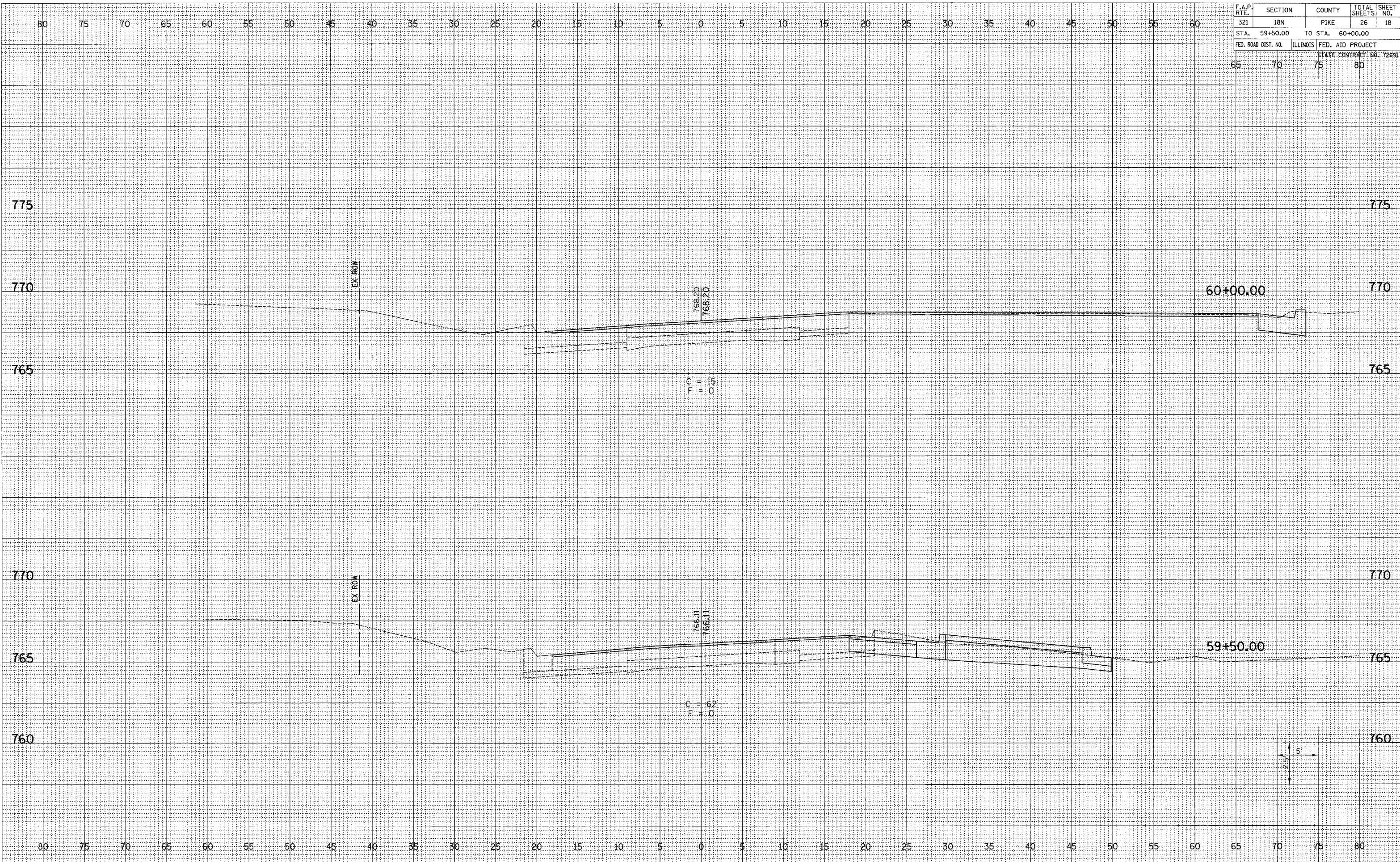

FINAL SURVEY	SURVEYED	BY	DATE
NOTE BOOK	PLOTTED		
NO.	DATE		
	AREAS CHECKED		

ORIGINAL SURVEY	SURVEYED	BY	DATE
NOTE BOOK	PLOTTED		
NO.	DATE		
	AREAS CHECKED		

Plot Date: 8/28/2004  
 Plot Time: 10:53 PM  
 Plotted By: sdonohue  
 Pen Table: 1001.tbl  
 Filename: h:\02029\work\_order\2\construction\plans\15\_22\_x8\_us54.dgn

F.A.P. RTE.	SECTION	COUNTY	TOTAL SHEETS	SHEET NO.
321	18N	PIKE	26	19
STA. 60+50.00	TO STA. 61+00.00			
FED. ROAD DIST. NO.	ILLINOIS	FED. AID PROJECT		
65	70	75	80	
STATE CONTRACT NO. 72691				

FINAL SURVEY	BY	DATE
SURVEYED		
PLOTTED		
NOTE BOOK		
AREAS CHECKED		
NO.		

ORIGINAL SURVEY	BY	DATE
SURVEYED		
PLOTTED		
NOTE BOOK		
AREAS CHECKED		
NO.		

Plot Date: 9/28/2004  
 Plot Time: 10:53:33 PM  
 Plotted By: edonahue  
 Pen Table: 1001.tbl  
 File Name: \\s0029\work\_order\12\construction\plans\15-22-x-6-us54.dgn

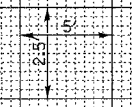
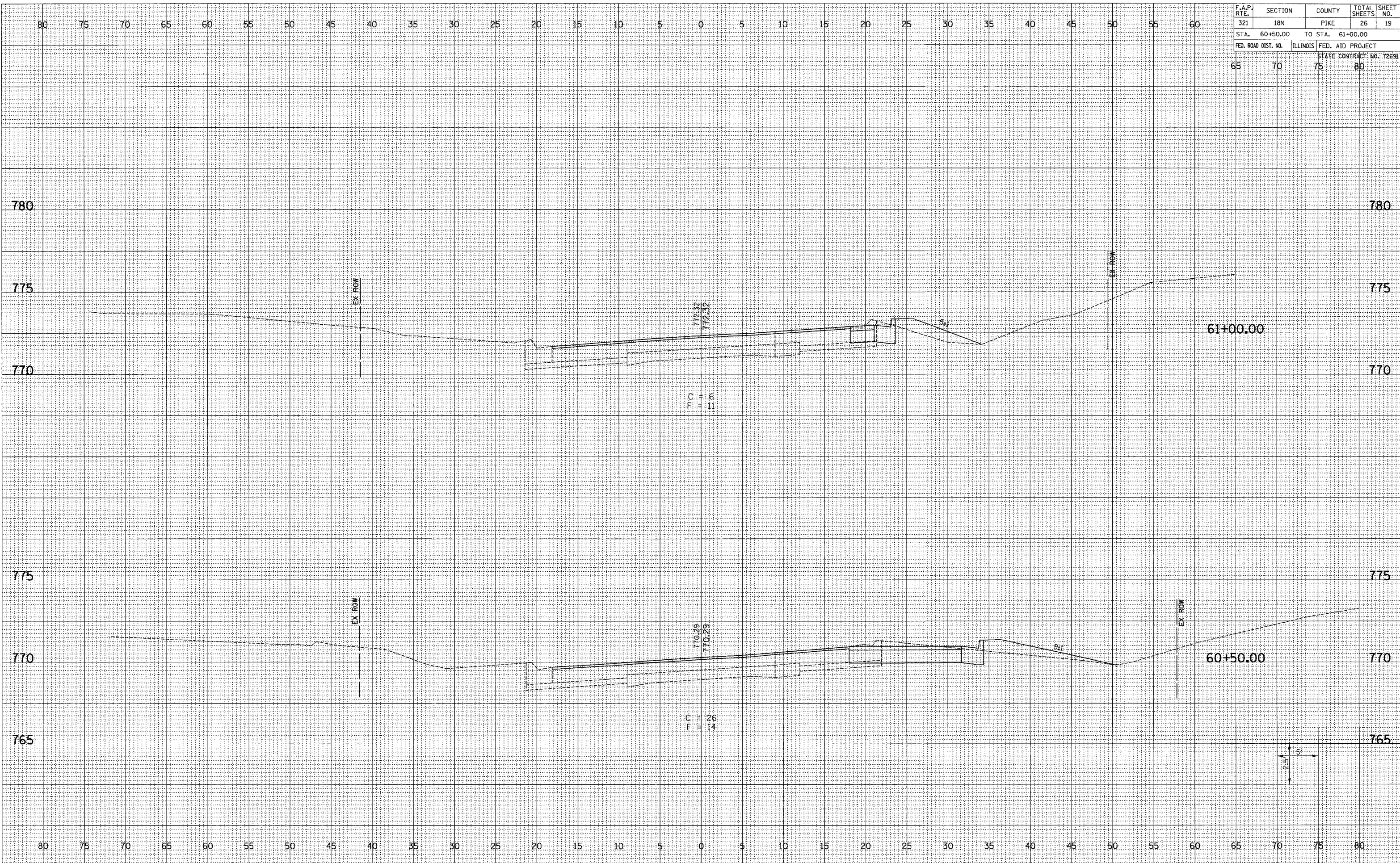

F.A.P. RTE.	SECTION	COUNTY	TOTAL SHEETS	SHEET NO.
321	18N	PIKE	26	20
STA. 61+41.68	TO STA. 61+50.00			
FED. ROAD DIST. NO.	ILLINOIS	FED. AID PROJECT		
65	70	75	80	
STATE CONTRACT NO. 72631				

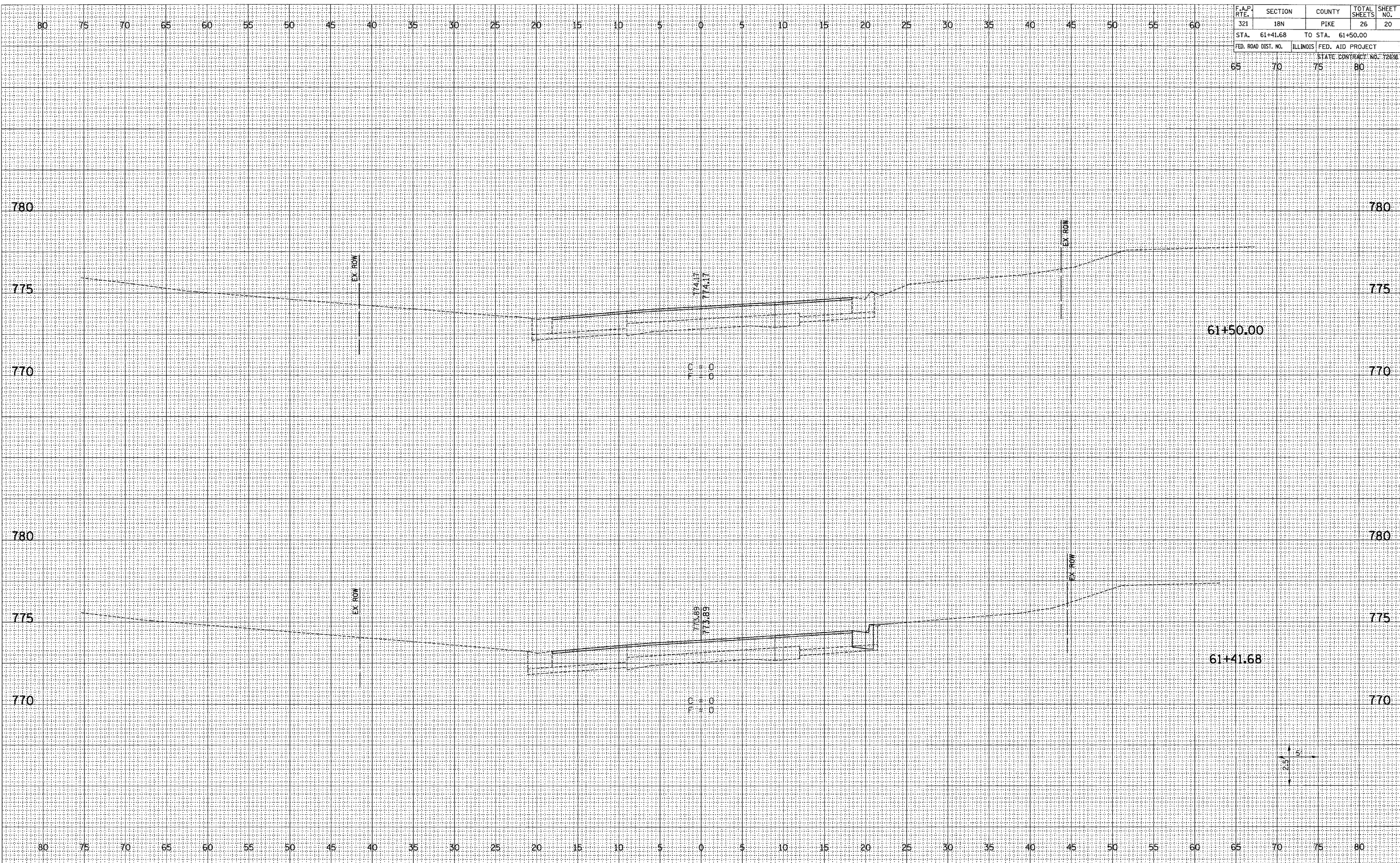

DATE	BY
SURVEYED	PLOTTED
NOTE BOOK	AREAS CHECKED
NO.	

DATE	BY
SURVEYED	PLOTTED
NOTE BOOK	AREAS CHECKED
NO.	

Plot Date: 9/28/2004  
 Plot Time: 10:53 PM  
 Plotted By: sdonohue  
 Pen Table: 1001.tbl  
 Filename: I:\01029\work\_order\_12A\_construction\plans\12A\_x8\_1053.dgn

F.A.P. RTE.	SECTION	COUNTY	TOTAL SHEETS	SHEET NO.
321	18N	PIKE	26	21
STA. 62+00.00	TO STA. 62+50.00			
FED. ROAD DIST. NO.	ILLINOIS	FED. AID PROJECT		
65	70	75	80	
STATE CONTRACT NO. 72691				

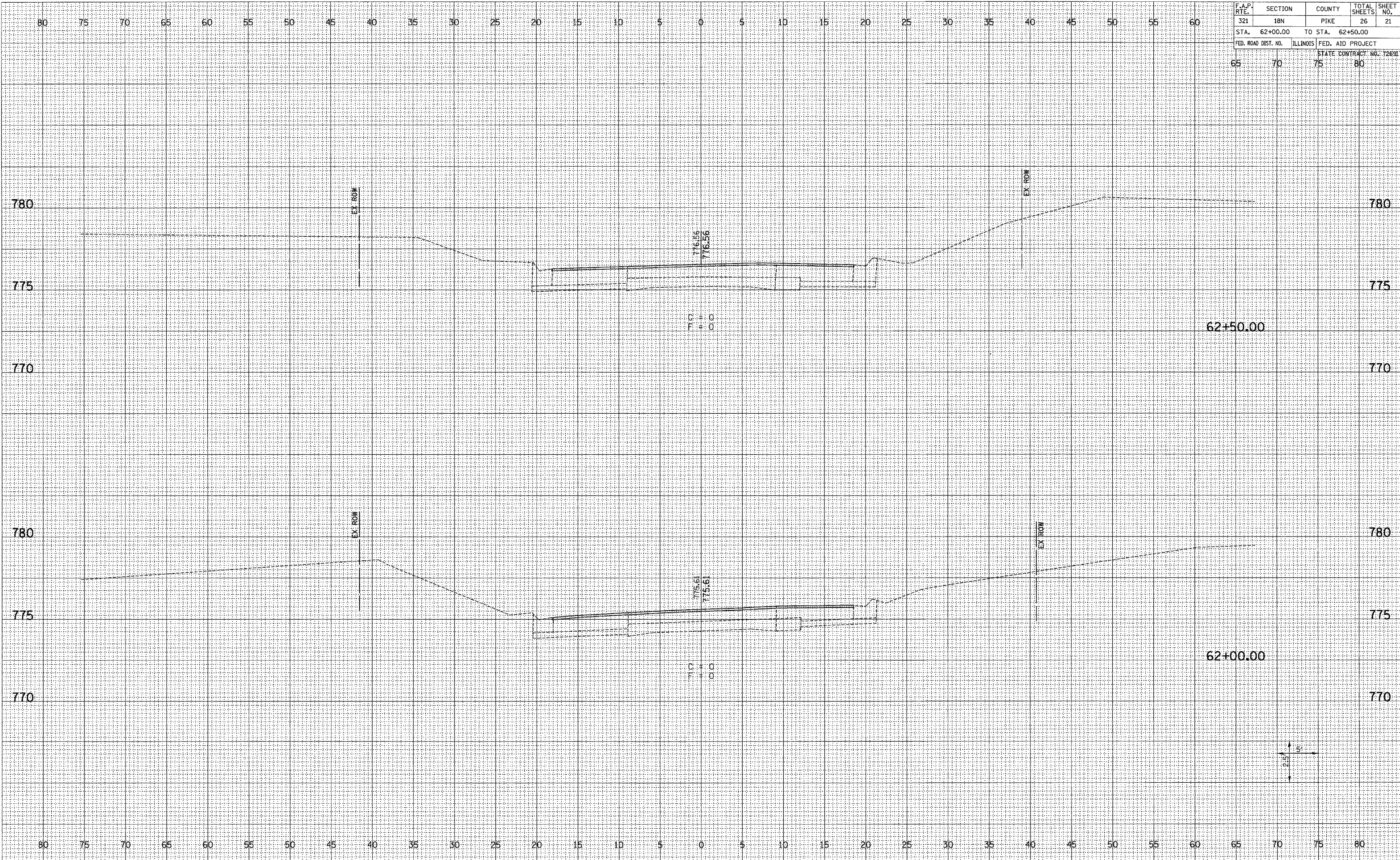

FINAL SURVEY	SURVEYED	BY	DATE
NOTE BOOK	PLOTTED		
NO.	AREAS CHECKED		

ORIGINAL SURVEY	SURVEYED	BY	DATE
NOTE BOOK	PLOTTED		
NO.	AREAS CHECKED		

Plot Date: 9/28/2004  
 Plot Time: 10:54:00 PM  
 Plotted By: scondra  
 Pen Table: 10pt.tbl  
 Filename: i:\02\work\_order\_12\construction\plans\18-22.xd\18-21.dgn

F.A.P. RTE.	SECTION	COUNTY	TOTAL SHEETS	SHEET NO.
321	18N	PIKE	26	22
STA. 63+00.00	TO STA. 63+27.30			
FED. ROAD DIST. NO.	ILLINOIS	FED. AID PROJECT		
65	70	75	80	
STATE CONTRACT NO. 72691				

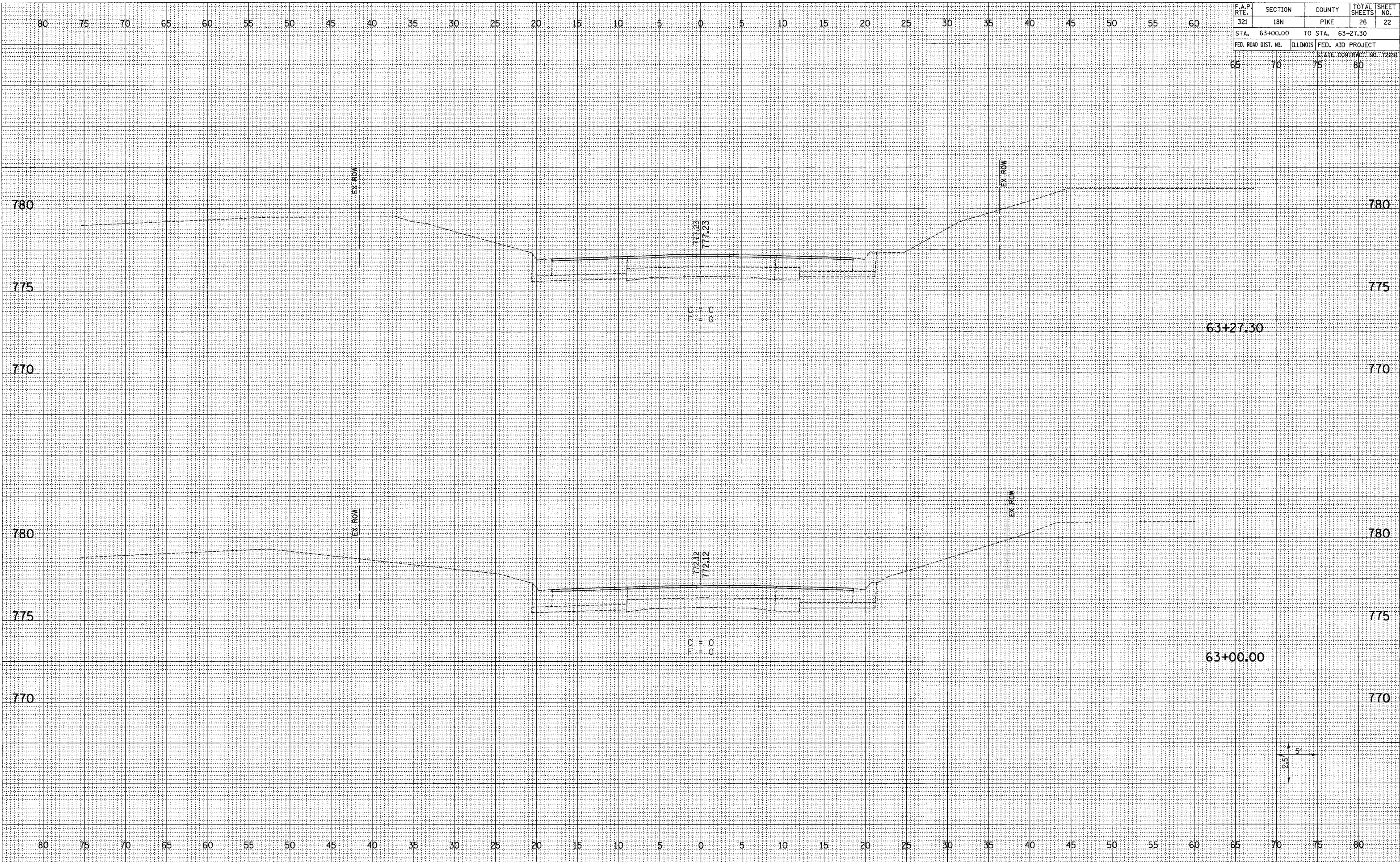

FINAL SURVEY	SURVEYED	BY	DATE
NOTE BOOK	PLOTTED		
NO.	DATE		
	AREAS CHECKED		

ORIGINAL SURVEY	SURVEYED	BY	DATE
NOTE BOOK	PLOTTED		
NO.	DATE		
	AREAS CHECKED		

Plot Date: 9/29/2004  
 Plot Time: 10:54:41 PM  
 Plotted By: edonohue  
 Pen Table: idot.tbl  
 Filename: I:\0029\work\order\2\consist\c1\on-plans\15-22-x5-jb54.dgn

F.A.P. RTE.	SECTION	COUNTY	TOTAL SHEETS	SHEET NO.
321	18N	PIKE	26	23
STA. 10+76.02	TO STA. 11+00.00			
FED. ROAD DIST. NO.	ILLINOIS	FED. AID PROJECT		
65	70	75	80	
STATE CONTRACT NO. 72E91				

FINAL SURVEY	SURVEYED	BY	DATE
NOTE BOOK	PLOTTED		
AREAS CHECKED	DATE		
NO.			

ORIGINAL SURVEY	SURVEYED	BY	DATE
NOTE BOOK	PLOTTED		
AREAS CHECKED	DATE		
NO.			

Plot Date: 9/28/2004  
 Plot Time: 05:43 PM  
 Plotted By: sctomahue  
 Pen Table: 1dot.tbl  
 Filename: I:\0029\work\_order\2A\_const\station\plans\2E\_26\_xs\_grove.dgn

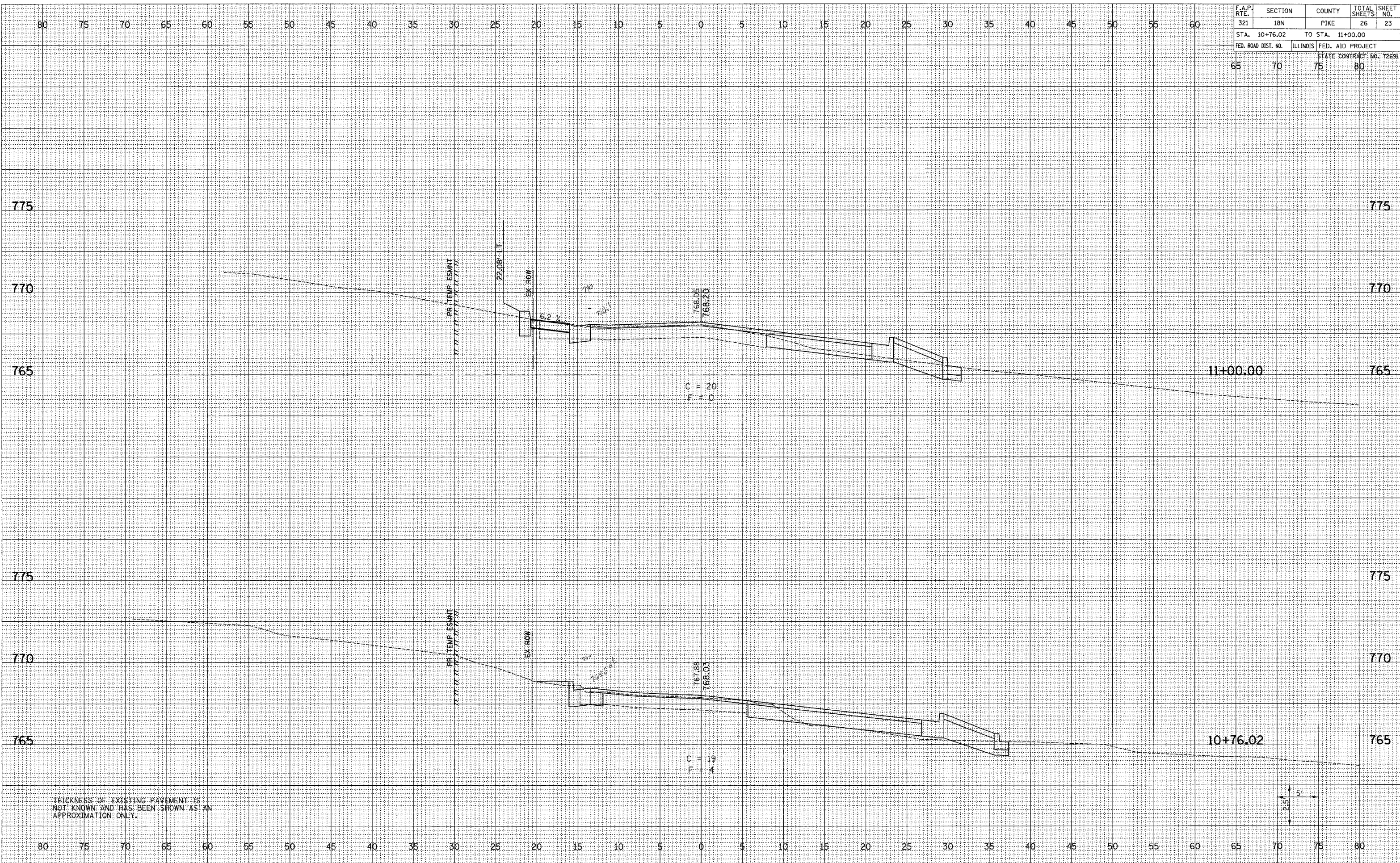

GROVE STREET CROSS SECTIONS STA 10+76.02 TO STA 11+00.00

F.A.P. RTE.	SECTION	COUNTY	TOTAL SHEETS	SHEET NO.
321	18N	PIKE	26	24
STA. 11+07.03	TO STA. 11+50.00			
FED. ROAD DIST. NO.	ILLINOIS	FED. AID PROJECT		
65	70	75	80	
STATE CONTRACT NO. 72838				

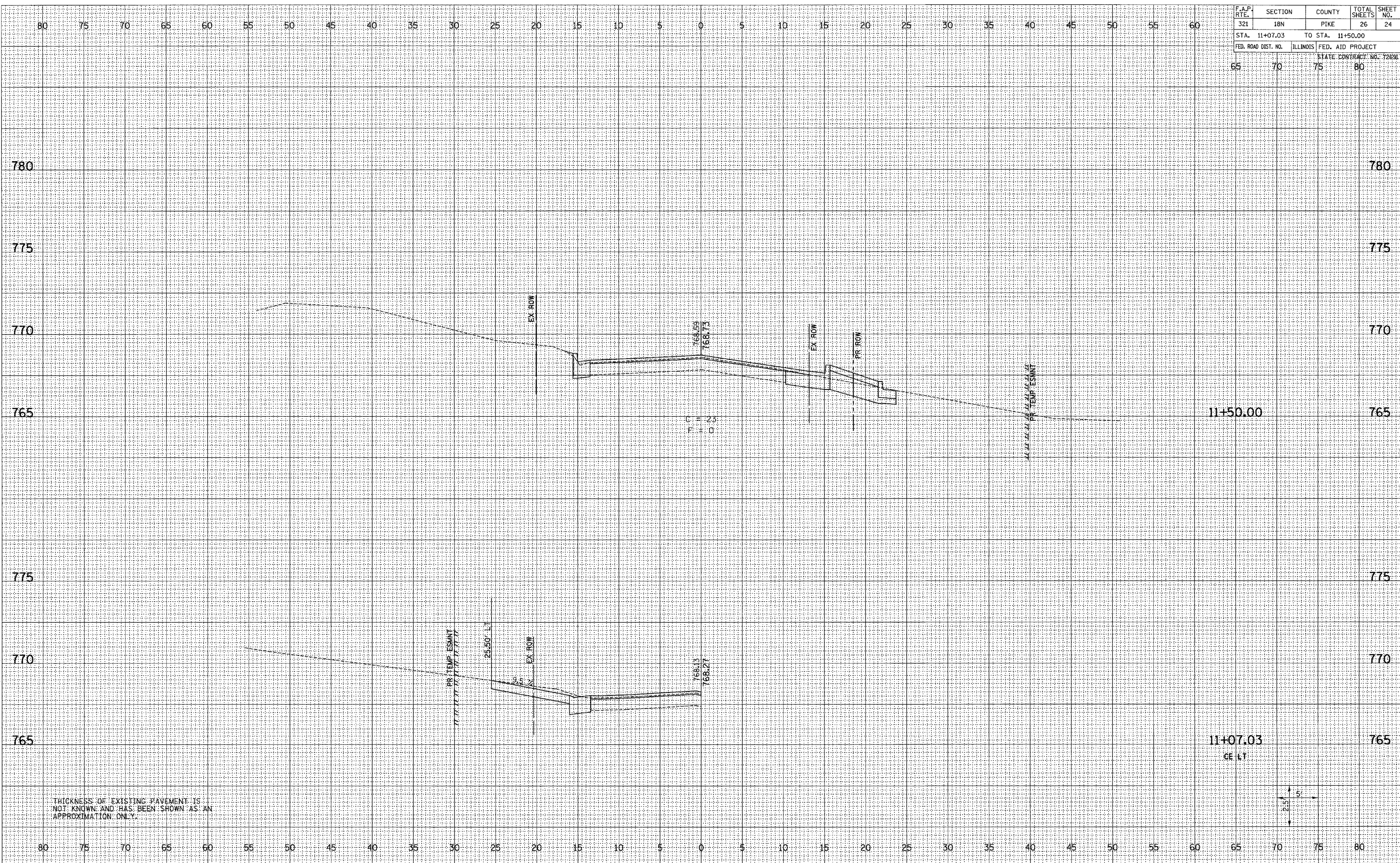

FINAL SURVEY	DATE
SURVEYED	
PLOTTED	
NOTE BOOK	
AREAS CHECKED	
NO.	

ORIGINAL SURVEY	DATE
SURVEYED	
PLOTTED	
NOTE BOOK	
AREAS CHECKED	
NO.	

Plot Date: 8/28/2004  
 Plot Time: 10:54:44 PM  
 Plotted By: sbrunhau  
 Pen Table: 1001.tbl  
 File Name: h:\0221\work\_order\_12\construction\plan\_plans\13-26\_x.s\_grove.dgn

THICKNESS OF EXISTING PAVEMENT IS NOT KNOWN AND HAS BEEN SHOWN AS AN APPROXIMATION ONLY.



F.A.P. RTE.	SECTION	COUNTY	TOTAL SHEETS	SHEET NO.
321	18N	PIKE	26	25
STA. 11+98.05	TO STA. 12+00.00			
FED. ROAD DIST. NO.	ILLINOIS	FED. AID PROJECT		
65	70	75	80	
STATE CONTRACT NO. 72691				

DATE	BY
SURVEYED	BY
PLOTTED	DATE
AREAS CHECKED	
NO.	

DATE	BY
SURVEYED	BY
PLOTTED	DATE
AREAS CHECKED	
NO.	

Plot Date: 10/28/2004  
 Plot Time: 10:54:44 PM  
 Plotted By: s00mahua  
 Pen Table: dot.tbl  
 Filename: h:\0029\work\_order\12\consist\section.plots\23-26\_xs\_grove.dgn

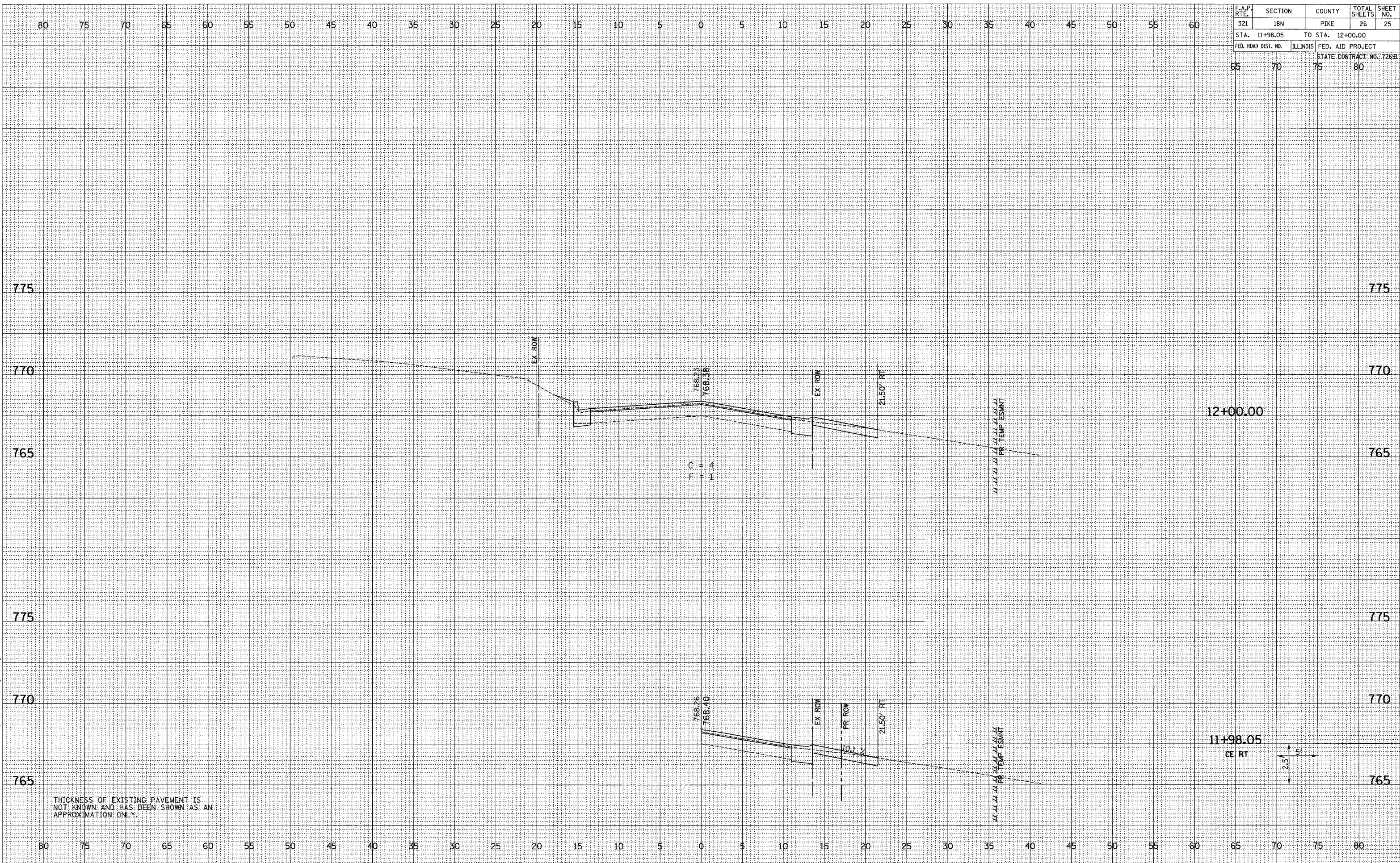

GROVE STREET CROSS SECTIONS STA 11+98.05 TO STA 12+00.00

F.A.P. R.T.E.	SECTION	COUNTY	TOTAL SHEETS	SHEET NO.
321	18N	PIKE	26	26
STA. 12+30.05	TO STA. 12+30.05			
FED. ROAD DIST. NO.	ILLINOIS	FED. AID PROJECT		
65	70	75	STATE CONTRACT NO. 72691	

FINAL SURVEY	SURVEYED	DATE
NOTE BOOK NO.	PLOTTED	
	TEMPLATE	
	AREAS CHECKED	

ORIGINAL SURVEY	SURVEYED	DATE
NOTE BOOK NO.	PLOTTED	
	TEMPLATE	
	AREAS CHECKED	

Plot Date: 3/28/2004  
 Plot Time: 6:54:46 PM  
 Plot By: Egonchus  
 Plot For: E  
 File Name: I:\0023\work\_order\_IP\_construction\plans\23-26\_sss\_grove.dgn

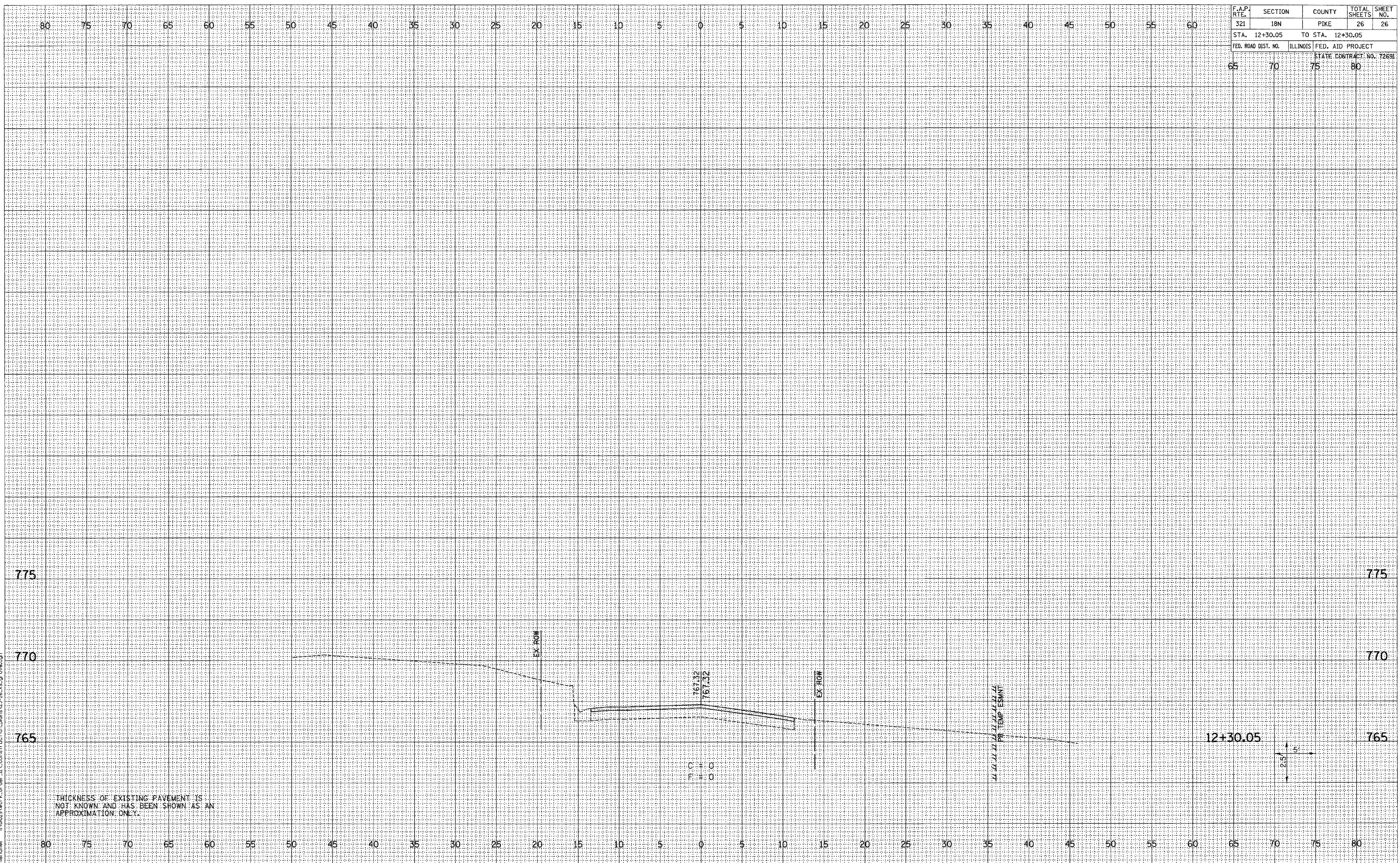

GROVE STREET CROSS SECTIONS STA 12+30.05 TO STA 12+30.05