

F.A.I. RTE.	SECTION	COUNTY	TOTAL SHEETS	SHEET NO.
74	(72-8HB-2)1	PEORIA	18	6
STA. 146+204.55		TO STA. 149+904.55		
FED. ROAD DIST. NO. 4		ILLINOIS FED. AID PROJECT		

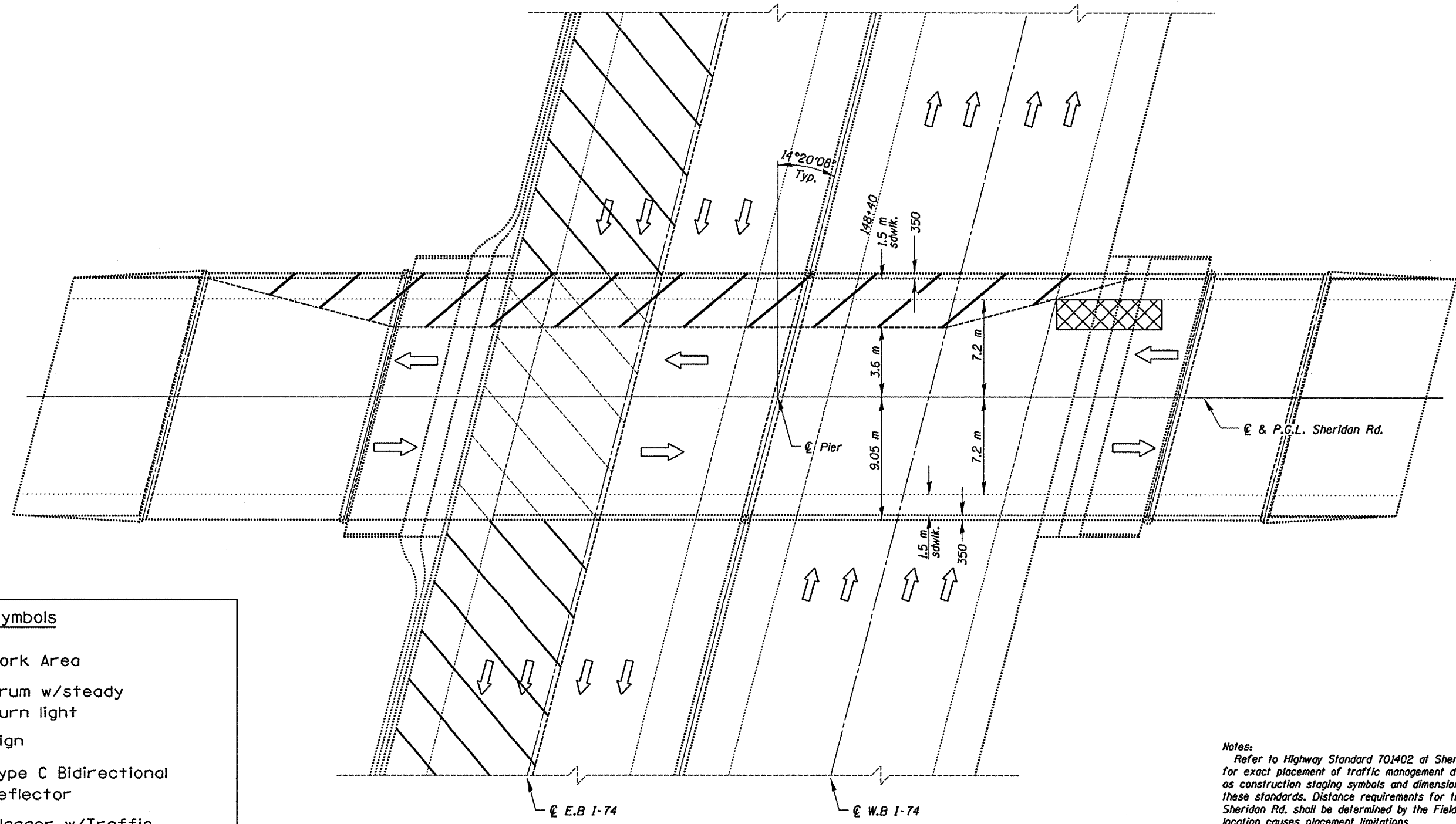

PLAN VIEW

**Symbols**

- Work Area
- Drum w/steady burn light
- Sign
- Type C Bidirectional reflector
- Flagger w/Traffic Control Sign
- Temporary Concrete Barrier
- Impact Attenuator

**Notes:**  
 Refer to Highway Standard 701402 at Sheridan Rd. and 701401 at I-74 for exact placement of traffic management devices and other clarifications as construction staging symbols and dimensioning were duplicated off of these standards. Distance requirements for traffic standard devices on Sheridan Rd. shall be determined by the Field Engineer as structure location causes placement limitations.  
 Traffic control for I-74 lane shift during overhead construction will be a mirror image of view shown about E.B. lanes centerline with devices used from Highway Standard 701401.

REVISIONS		ILLINOIS DEPARTMENT OF TRANSPORTATION
NAME	DATE	
		CONSTRUCTION AND TRAFFIC CONTROL

SCALE: VERT. \_\_\_\_\_  
 HORIZ. \_\_\_\_\_  
 DATE: 03-15-2005

DRAWN BY: CEJ  
 CHECKED BY: \_\_\_\_\_

PLOT DATE: 3/15/2005  
 FILE NAME: S:\CONTRACTS\106\148\148.dwg  
 PLOT SCALE: 1/8" = 1'-0"  
 REFERENCE: REF