

F.A.I. RTE.	SECTION	COUNTY	TOTAL SHEETS	SHEET NO.
155	Q4 DEBRIS ROL	TAZEWELL	10	6
STA. 665+90.43		TO STA. 671+40.20		
FED. ROAD DIST. NO. 4 ILLINOIS FED. AID PROJECT				

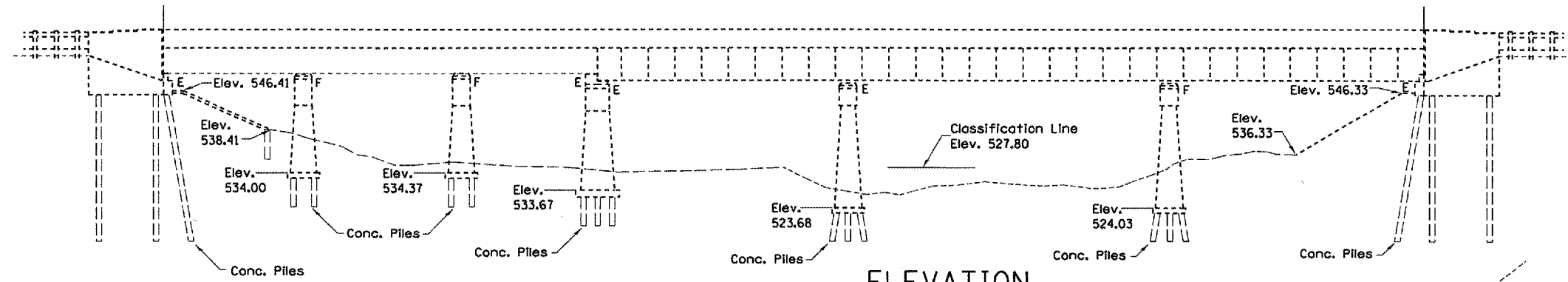

ELEVATION

NOTE
 N.Abut. = Rocker Brg.
 Pier 1 = Rocker Brg.
 Pier 2 = Bolster Brg.
 Pier 3 = Rocker Brg.
 Pier 4 = Rocker Brg.
 Pier 5 = Bolster Brg.
 S.Abut. = Rocker Brg.

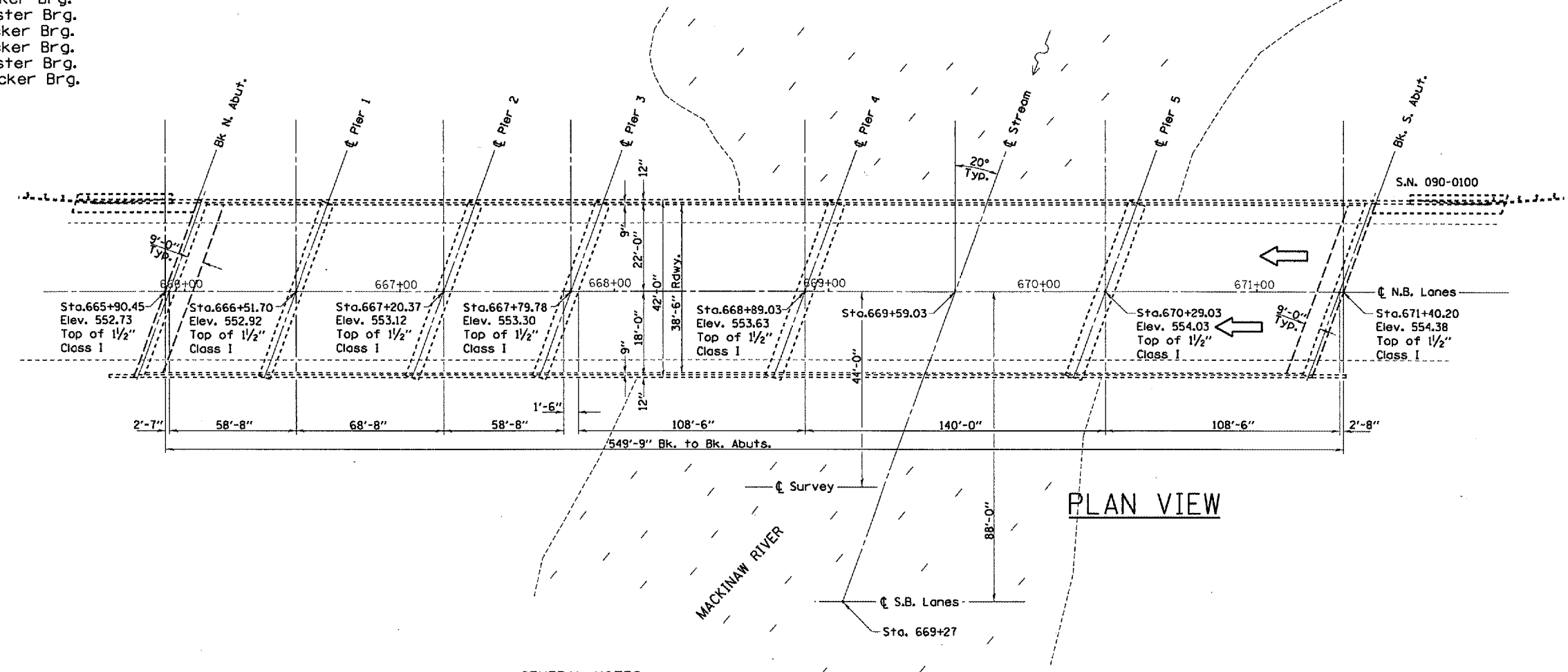

PLAN VIEW

GENERAL NOTES

PLAN DIMENSIONS AND DETAILS RELATIVE TO EXISTING STRUCTURE HAVE BEEN TAKEN FROM EXISTING PLANS AND ARE SUBJECT TO NOMINAL CONSTRUCTION VARIATIONS. IT SHALL BE THE CONTRACTOR'S RESPONSIBILITY TO VERIFY SUCH DIMENSIONS AND DETAILS IN THE FIELD AND MAKE NECESSARY APPROVED ADJUSTMENTS PRIOR TO WORK OR THE ORDERING OF MATERIALS. SUCH VARIATIONS SHALL NOT BE CAUSE FOR ADDITIONAL COMPENSATION FOR A CHANGE IN THE SCOPE OF THE WORK. HOWEVER, THE CONTRACTOR WILL BE PAID FOR THE QUANTITY ACTUALLY FURNISHED AT THE UNIT PRICE BID FOR THE PROJECT.
 DEBRIS DEFLECTION DEVICES ARE TO BE INSTALLED UPSTREAM FROM PIERS P-4 AND P-5.

TOTAL BILL OF MATERIAL

ITEM	UNIT	QUANTITY
DEBRIS DEFLECTION SYSTEM	LSUM	1.0

REVISIONS	
NAME	DATE

ILLINOIS DEPARTMENT OF TRANSPORTATION

PLAN AND ELEVATION

SCALE: VERT. _____
 HORIZ. _____
 DATE 07-19-2004

DRAWN BY CEJ
 CHECKED BY _____

DATE
 FILE NAME
 PLOT SCALE
 REFERENCE