

F.A.I. RTE.	SECTION	COUNTY	TOTAL SHEETS	SHEET NO.
412	(50-CVB)-2	LASALLE	25	4
FED. ROAD DIST. NO. ILLINOIS		STATE AID PROJECT		

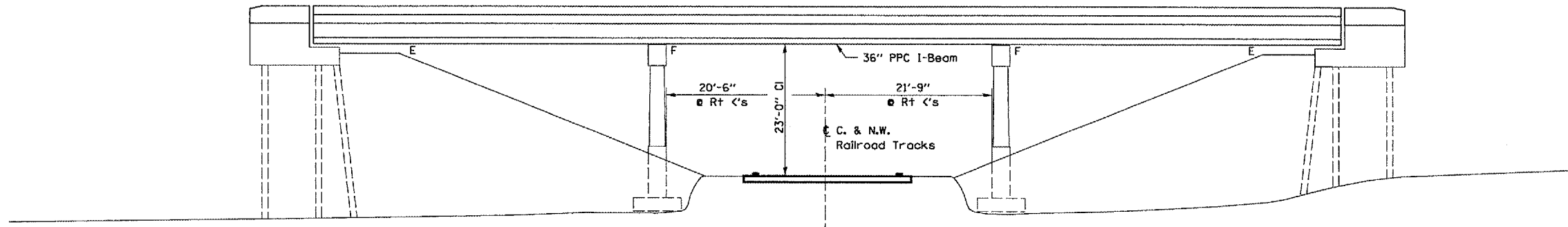

**ELEVATION**

For General Notes see Sheet 6 of 25.

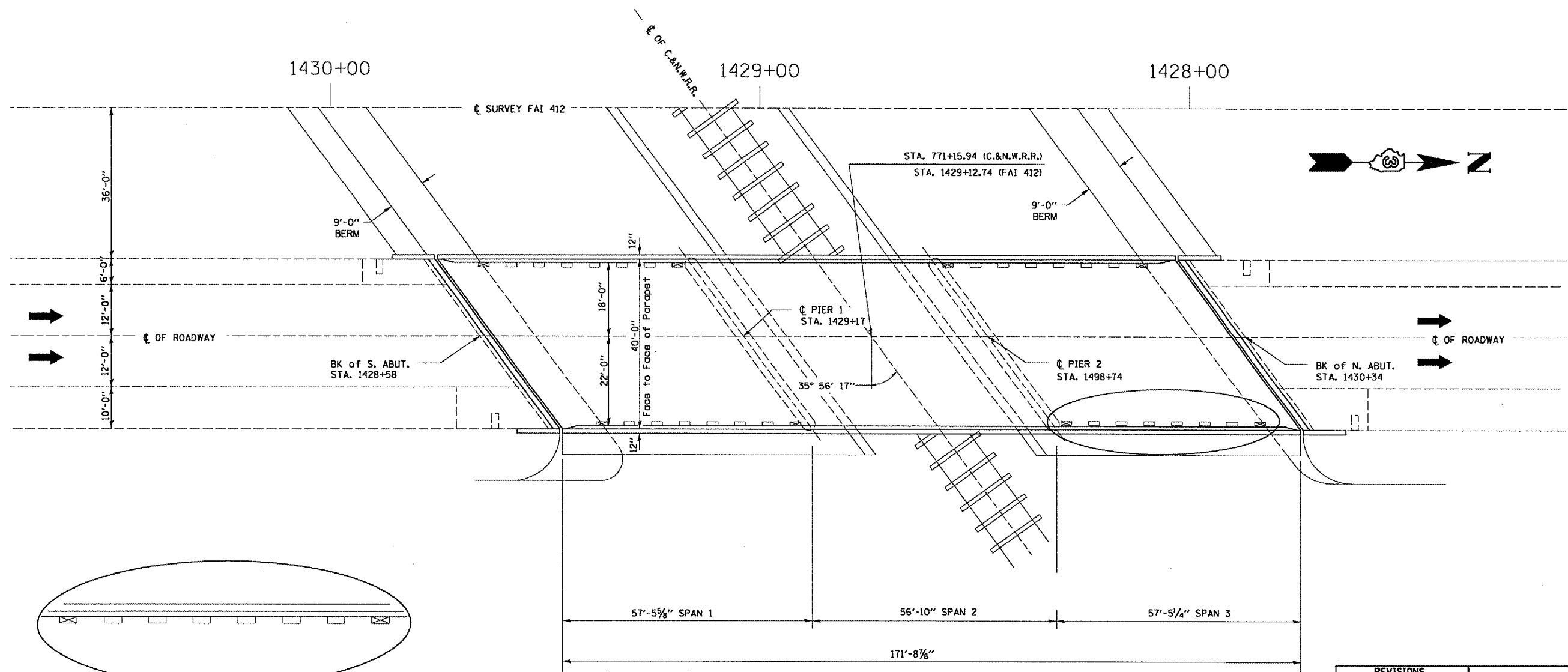

**PLAN**

S.N. 050-0168 (NB)

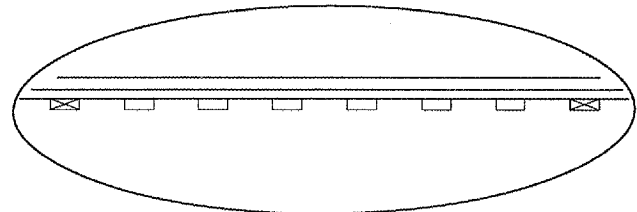

- ☒ PLUG THE FIRST DRAIN AND LAST DRAIN AT ALL LOCATIONS
- ☐ EXTEND REMAINING SIX DRAINS

**DECK DRAIN DETAIL**  
(FOR ALL DECK DRAIN LOCATIONS)

REVISIONS	
NAME	DATE

ILLINOIS DEPARTMENT OF TRANSPORTATION  
**GENERAL PLAN VIEW**  
S.N. 050-0168 (NB)  
F.A.I. 412 OVER C. & N.W. RAILROAD  
SECTION (50-6VB)-1  
STA. 1429+12.74

MARCH 5, 2005  
C:/PROJECTS/MAIN/050034/0500168/DETAILS.DGN