

STATE OF ILLINOIS
DEPARTMENT OF TRANSPORTATION

Sheet No. 1
of 16 Sheets

ROUTE NO.	SECTION	COUNTY	TOTAL SHEETS	SHEET NO.
SBI 88	103C-BR	BUREAU	51	12
FED. ROAD DIST. NO.	ILLINOIS	PROJECT	CONTRACT #64423	

Existing Structure: SN 006-0095
Single span, steel thru truss with 6" reinforced concrete deck bridge, built on timber pile supported closed abutments, 122'-8" back to back abuts and 22'± out to out of deck.

Bench Mark 1:
"D" on S.E. wingwall of bridge over Green River 15.4' Lt Sta 28+63.2 Elev 634.05

Contractor shall remove existing structure as required and replace with a 3 span PPC I-beam bridge with reinforced concrete deck on pile bent piers and integral abutments. Traffic detoured during construction.

No salvage.

640
635
630
625
620
615

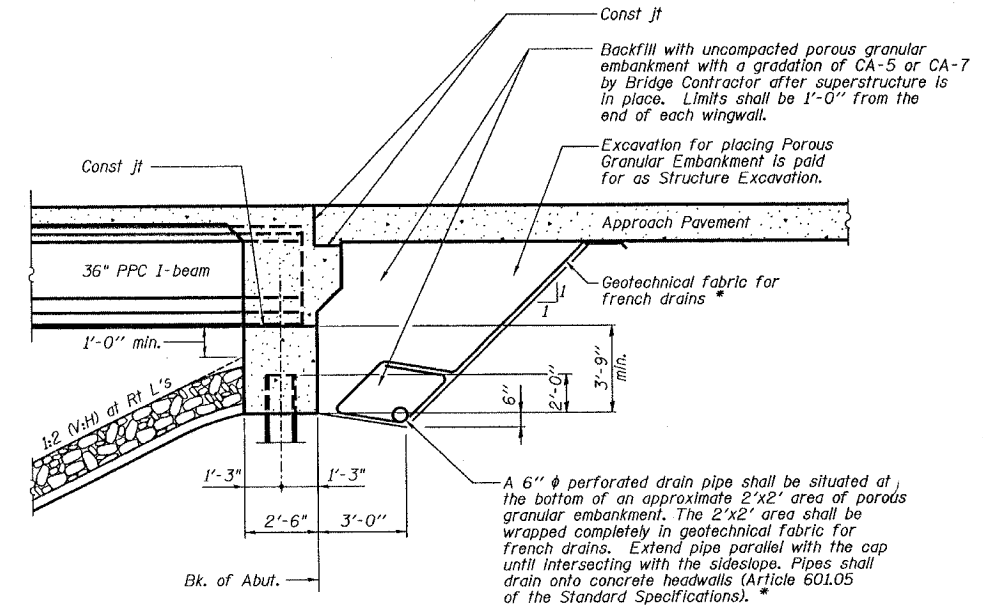
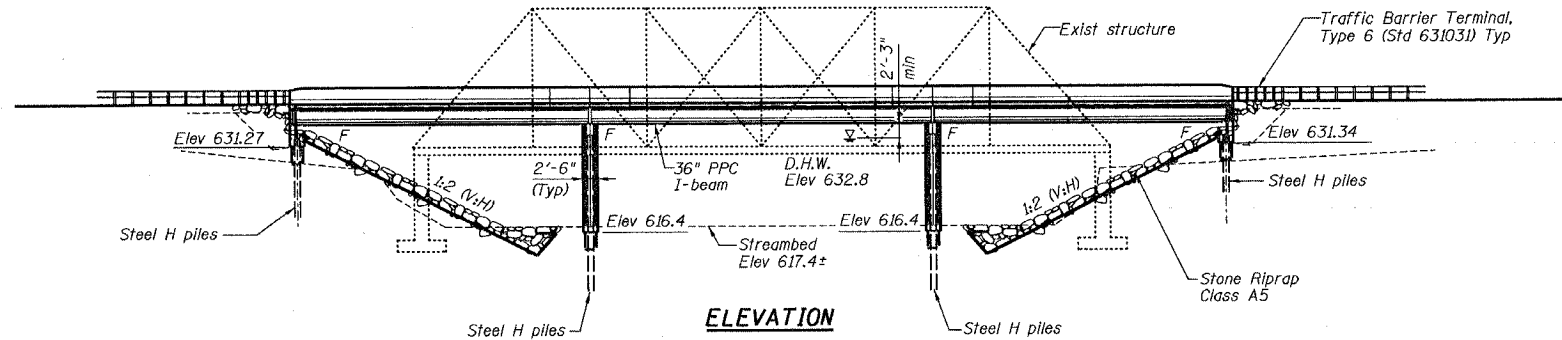

* Included in the cost of Porous Granular Embankment.

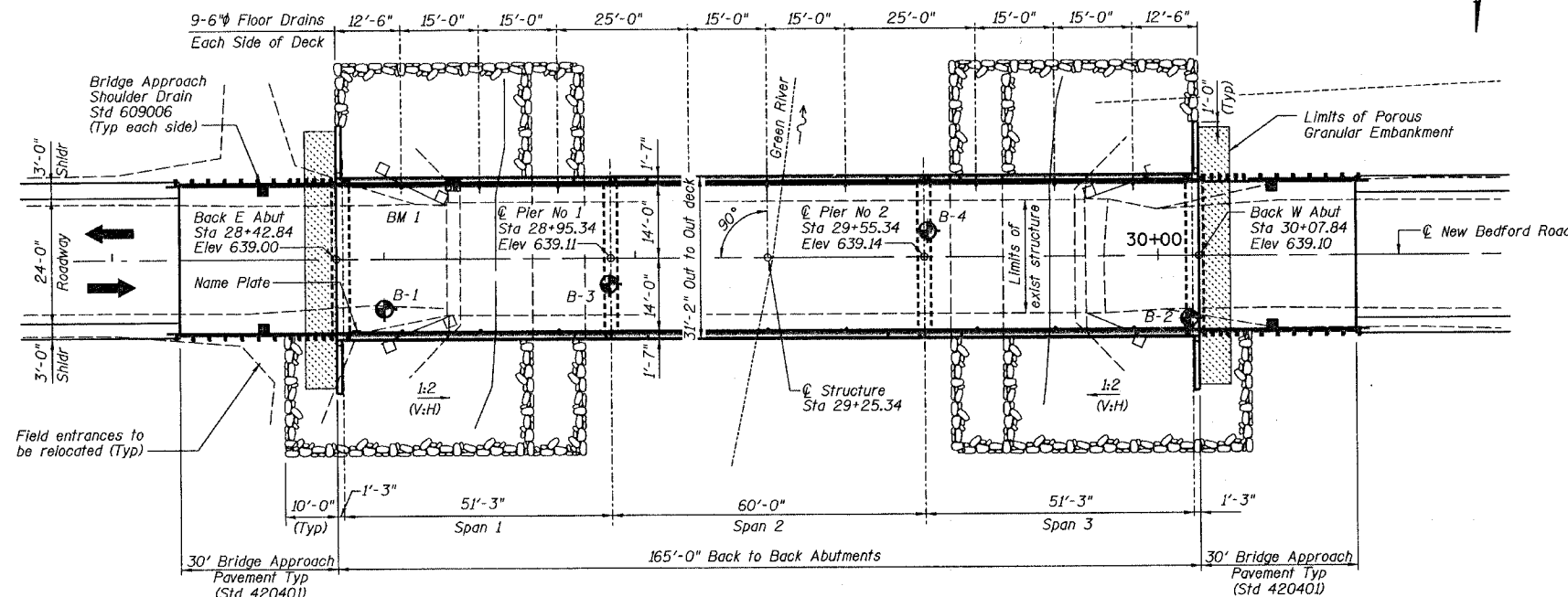

STATION 29+25.34
BUILT 20 BY
STATE OF ILLINOIS
SBI 88
SEC. 103C-BR
LOADING HS20
STR. NO. 006-0163

NAME PLATE
See Std. 515001

DESIGN SPECIFICATIONS

2002 AASHTO

LOADING HS20-44

Allow 50#/sq. ft. for future wearing surface.

DESIGN STRESSES

FIELD UNITS

$f'_c = 3,500$ psi
 $f_y = 60,000$ psi (Reinforcement)

PRECAST PRESTRESSED UNITS

$f'_c = 6,000$ psi
 $f'_{ci} = 5,000$ psi
 $f_s = 270,000$ psi ($\frac{1}{2}$ " ϕ lowlax strands)
 $f'_{si} = 201,960$ psi ($\frac{1}{2}$ " ϕ lowlax strands)

SEISMIC DATA

Seismic Performance Category (SPC) = A
Bedrock Acceleration Coefficient (A) = .036
Site Coefficient (S) = 1.5

APPROVED
FOR STRUCTURAL ADEQUACY ONLY

Ralph E. Anderson
ENGINEER OF BRIDGES AND STRUCTURES

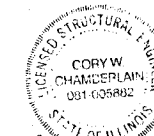

Cory W. Chambliss
08/16/04
EXPIRES 11/30/04

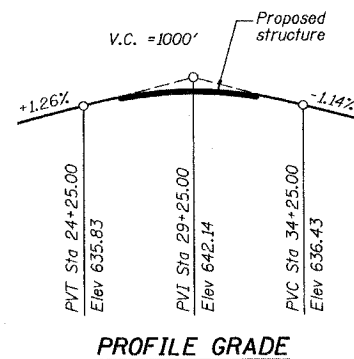

WATERWAY INFORMATION

Drainage Area = 415.35 sq mi		Exist Low Grade Elev = 633.93 @ Sta 28+25		Prop Low Grade Elev = 638.97 @ Sta 28+25		
Flood	Freq Yr	Q C.F.S.	Opening Sq Ft	Nat. H.W.E.	Head-Ft	Headwater El
					Exist	Prop
Design	50	8524	1754	1802	632.8	0.1
Base	100	9288	1754	1917	633.5	0.2
Ex Overtop	150	9500	1754	--	633.8	0.1
Max Calc	500	11191	--	2197	635.4	0.0

Levee overtopping occurs prior to roadway overtopping at 90' upstream (Elev 633.6)

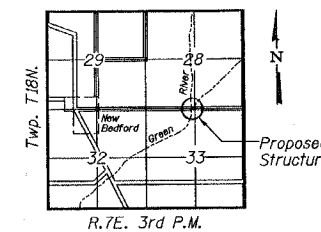
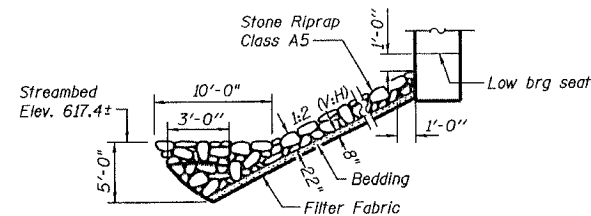

NEW BEDFORD ROAD OVER GREEN RIVER

GENERAL PLAN AND ELEVATION

STATE OF ILLINOIS DEPARTMENT OF TRANSPORTATION DIVISION OF HIGHWAYS		SECTION 103C-BR		PROJECT No. 4858-1
SBI 88 SPUR		SN 006-0163		BUREAU COUNTY
STA 29+25.34		HOMER L. CHASTAIN & ASSOCIATES, LLP CONSULTING ENGINEERS 184-001397		SHEET No.