

STATE OF ILLINOIS  
DEPARTMENT OF TRANSPORTATION

Sheet No. 4  
of 11 Sheets

|                     |          |           |                |           |
|---------------------|----------|-----------|----------------|-----------|
| ROUTE NO.           | SECTION  | COUNTY    | TOTAL SHEETS   | SHEET NO. |
| FAS 1197            | 105BR-2  | WHITESIDE | 59             | 19        |
| FED. ROAD DIST. NO. | ILLINOIS | PROJECT   | CONTRACT 64421 |           |

\*Order all (E) bars full length  
Cut to fit skew and use  
remainder in opposite end  
(See Bar Cutting Diagram)

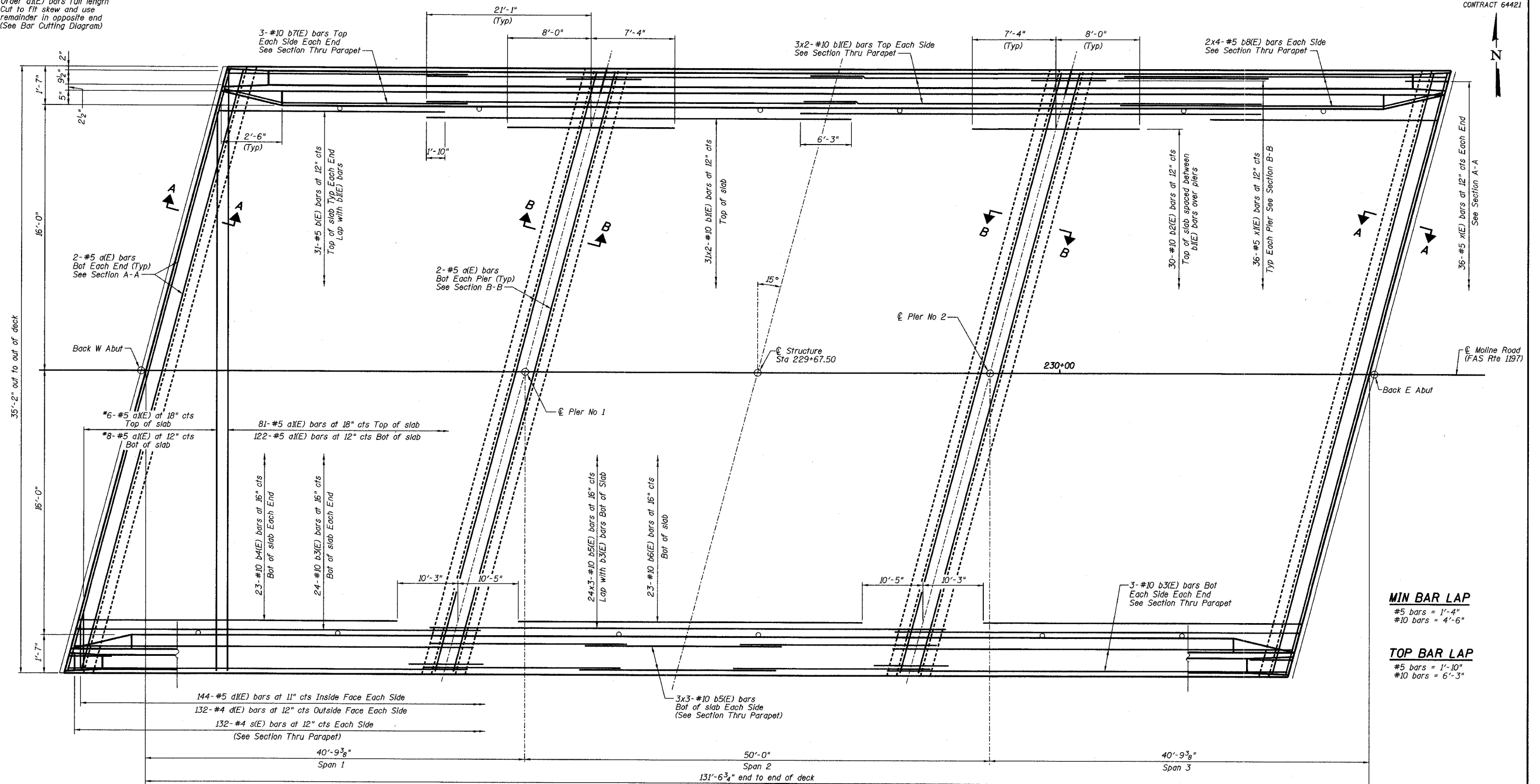

**MIN BAR LAP**  
#5 bars = 1'-4"  
#10 bars = 4'-6"

**TOP BAR LAP**  
#5 bars = 1'-10"  
#10 bars = 6'-3"

**PLAN**

**NOTES:**

- See Sheet No. 6 of 11 for Superstructure Details, parapet reinforcing and Bill of Material.
- Reinforcement bars designated (E) shall be epoxy coated.
- Bars indicated thus 6x3-#5 etc indicates 6 lines of bars with 3 lengths per line.
- See Sheet No. 1 of 11 for floor drain spacing.
- Space reinforcement bars to clear floor drains.

| REVISIONS |      |          | SUPERSTRUCTURE PLAN                              |  | DRAWN BY DATE   |  |
|-----------|------|----------|--|--|-----------------|--|
| No.       | DATE | INITIALS | MOLINE ROAD OVER UNNAMED TRIBUTARY TO ROCK RIVER |  | R King 8/04     |  |
| 1         |      |          | FAS ROUTE 1197 SECTION 105BR-2                   |  | CHECKED BY DATE |  |
| 2         |      |          | SN 098-0110                                      |  | CMW 8/04        |  |
| 3         |      |          | STA 229+67.50 WHITESIDE COUNTY                   |  | DATE BY DATE    |  |
| 4         |      |          | HOMER L. CHASTAIN & ASSOCIATES, LLP              |  | CWC 8/04        |  |
| 5         |      |          | 184-001397                                       |  | BOOK NUMBER     |  |
| 6         |      |          |  |  | PROJECT No.     |  |
| 7         |      |          |  |  | 4858-3          |  |
| 8         |      |          |  |  | SHEET No.       |  |
| 9         |      |          |  |  |                 |  |
| 10        |      |          |  |  |                 |  |
| 11        |      |          |  |  |                 |  |
| 12        |      |          |  |  |                 |  |