

F.A.P. RTE.	SECTION	COUNTY	TOTAL SHEETS	SHEET NO.
549	116RS-1	OGLE	593	131
STA.		TO STA.		
FED. ROAD DIST. NO.		ILLINOIS	FED. AID PROJECT	

REMOVAL ITEMS

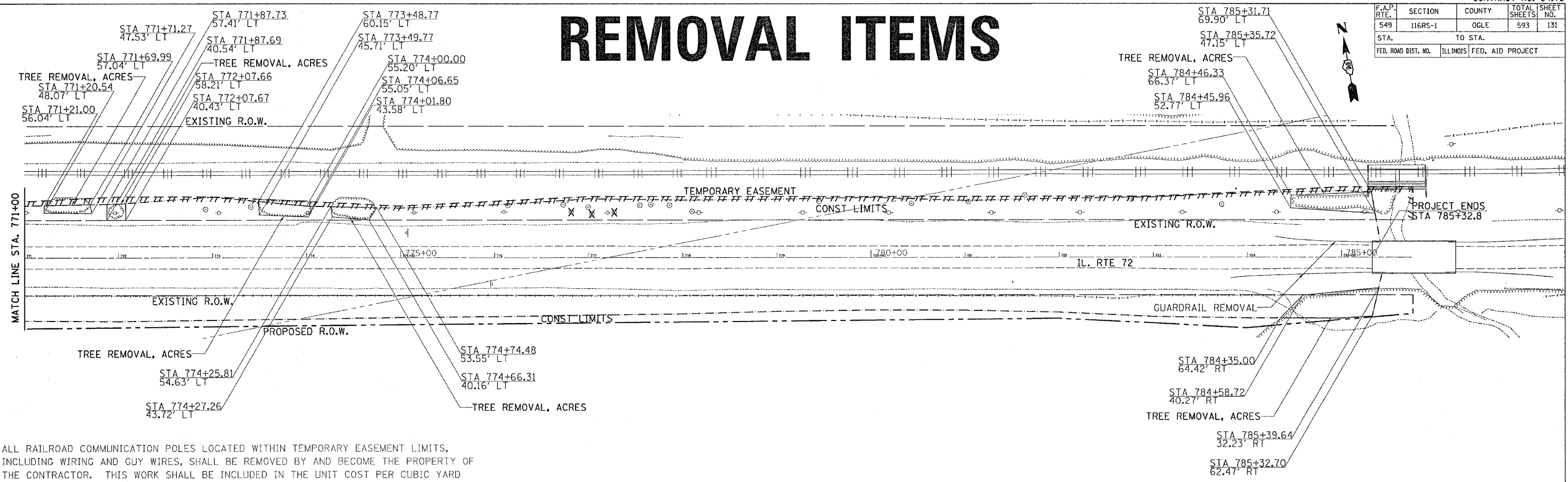

ALL RAILROAD COMMUNICATION POLES LOCATED WITHIN TEMPORARY EASEMENT LIMITS, INCLUDING WIRING AND GUY WIRES, SHALL BE REMOVED BY AND BECOME THE PROPERTY OF THE CONTRACTOR. THIS WORK SHALL BE INCLUDED IN THE UNIT COST PER CUBIC YARD FOR EARTH EXCAVATION. LT. STA. 697+00 TO THE END OF THE PROJECT.

LEGEND	
	= REMOVE DRIVEWAY
	= TREE REMOVAL